

# HILLEL AT UNIVERSITY OF MARYLAND

Detailed Site Plan

DSP-17052

Staff Recommendation: APPROVAL with conditions

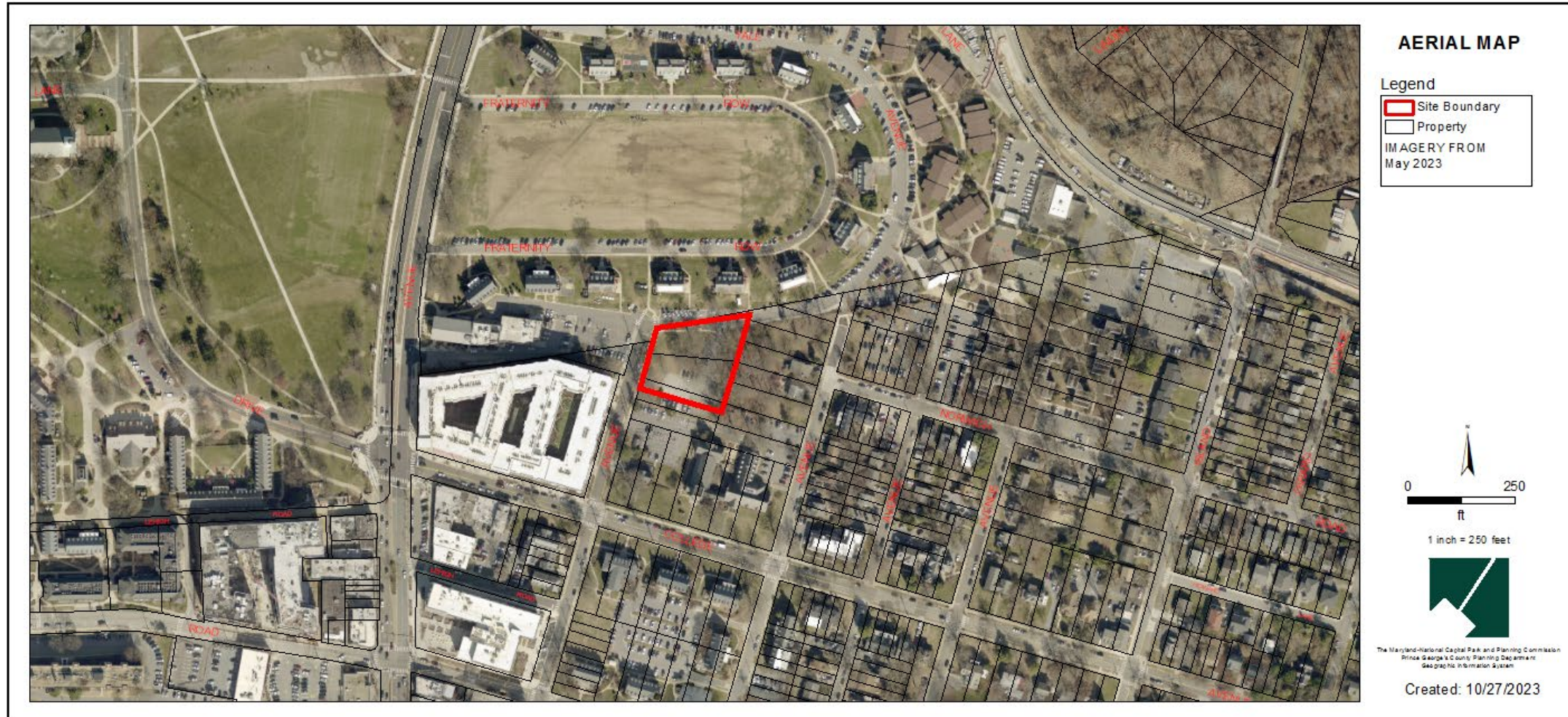

# GENERAL LOCATION MAP

Council District: 03

Planning Area: 066

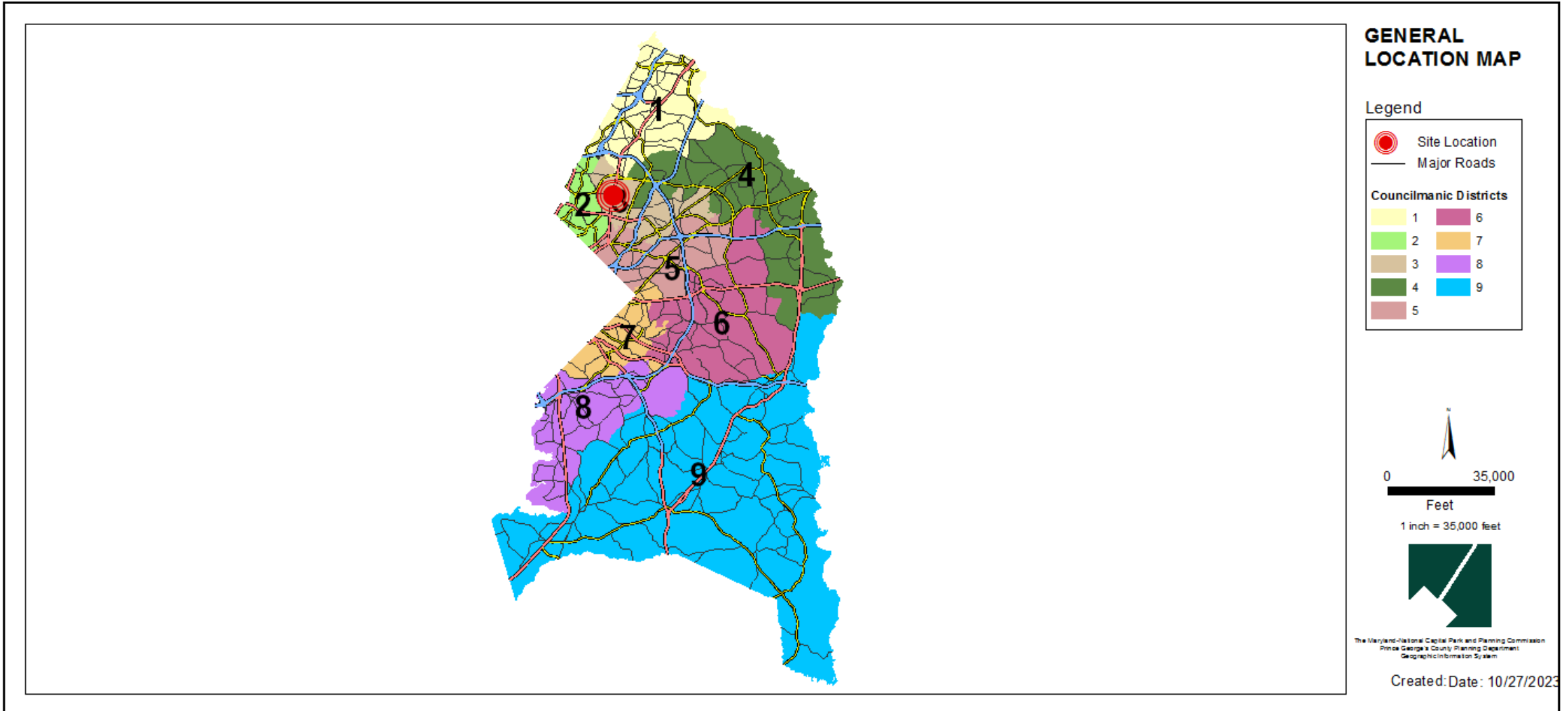



# SITE VICINITY MAP

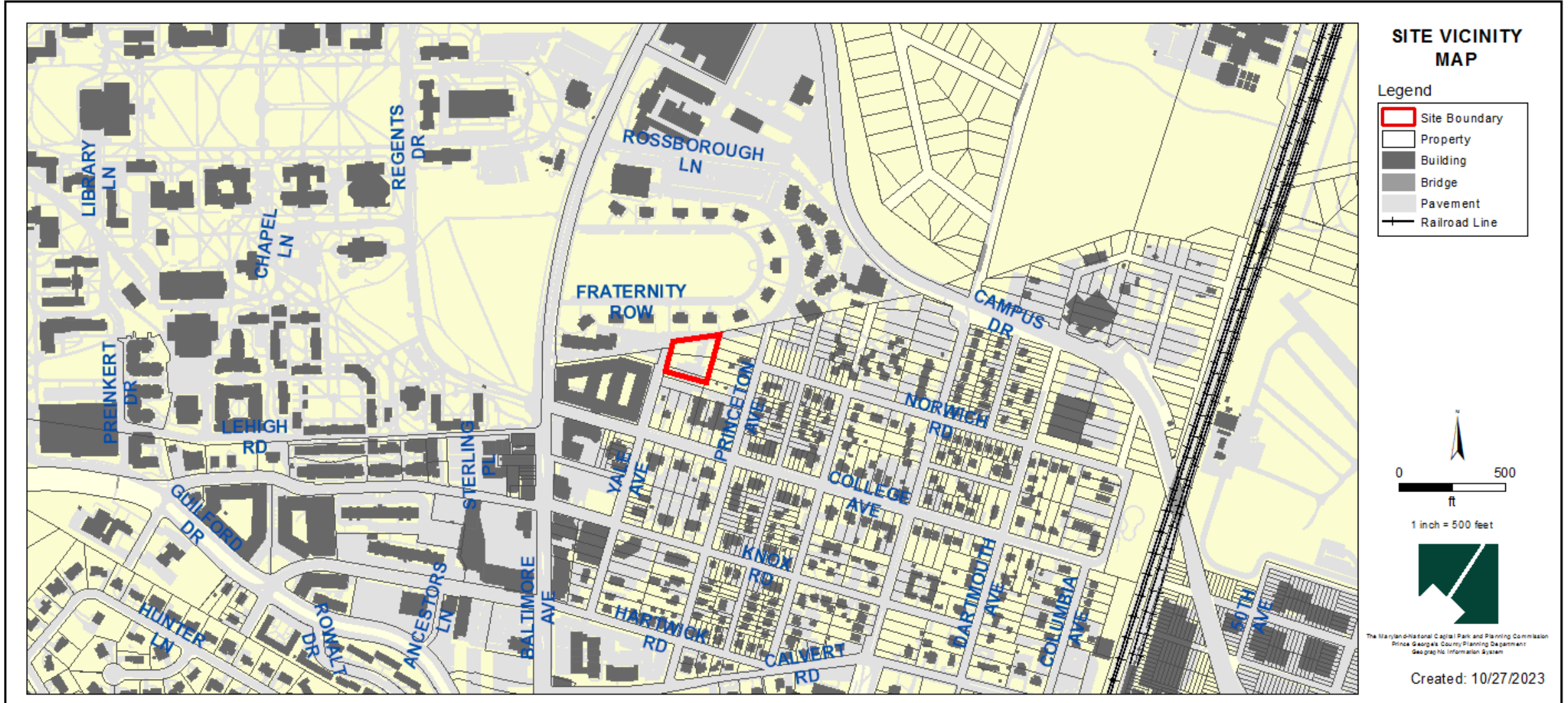

# ZONING MAP (PRIOR AND CURRENT)

Property Zone: M-U-I/D-D-O  
(Prior) / NAC (Current)

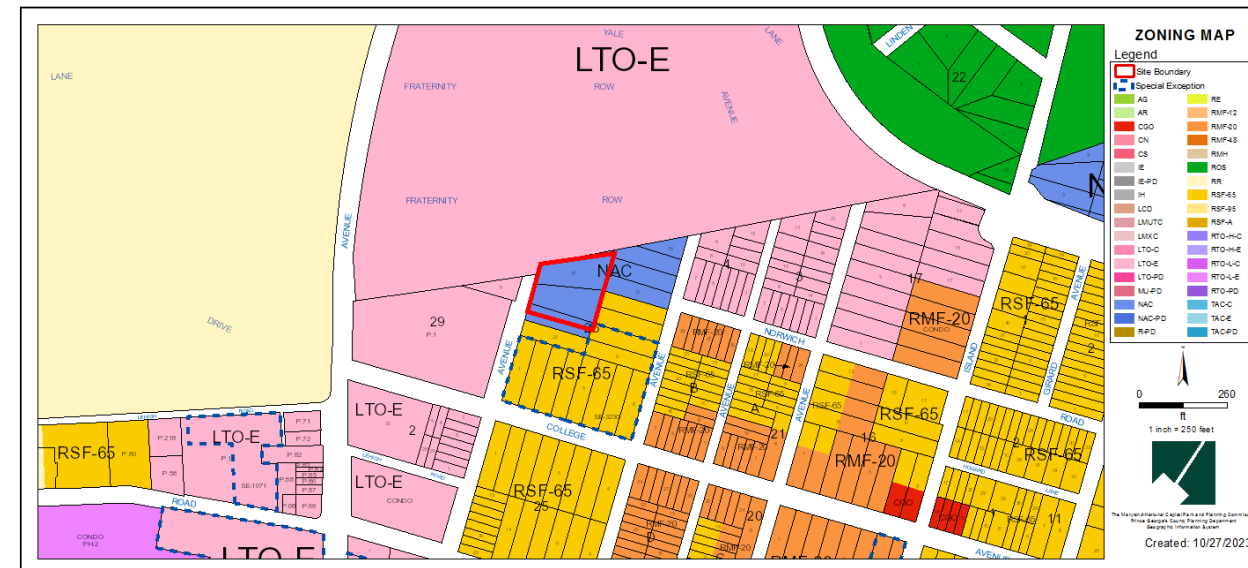
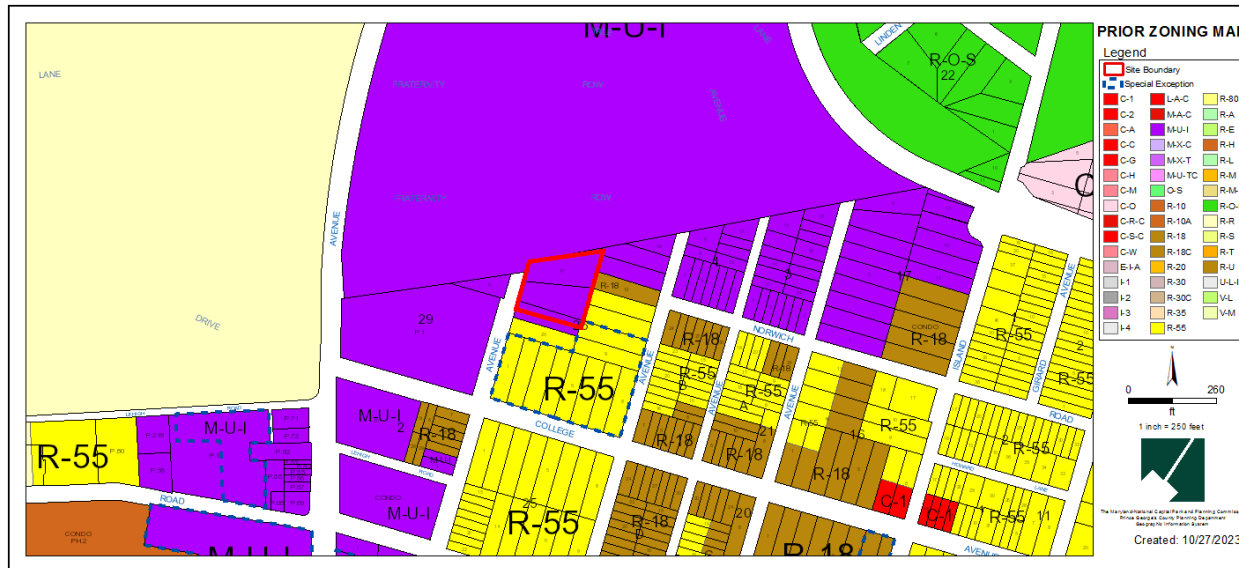

# OVERLAY MAP (PRIOR AND CURRENT)

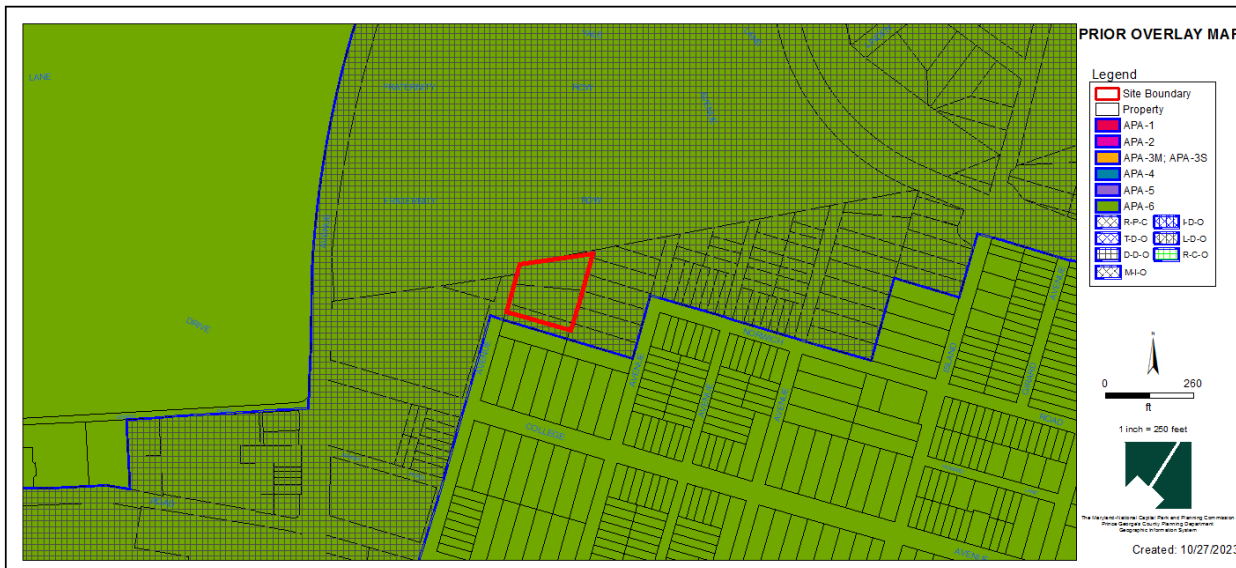



# AERIAL MAP



## AERIAL MAP

### Legend

Site Boundary

Property

IMAGERY FROM  
May 2023

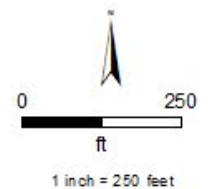

The Maryland-National Capital Park and Planning Commission  
Prince George's County Planning Department  
Geographic Information System

Created: 10/27/2023



# SITE MAP

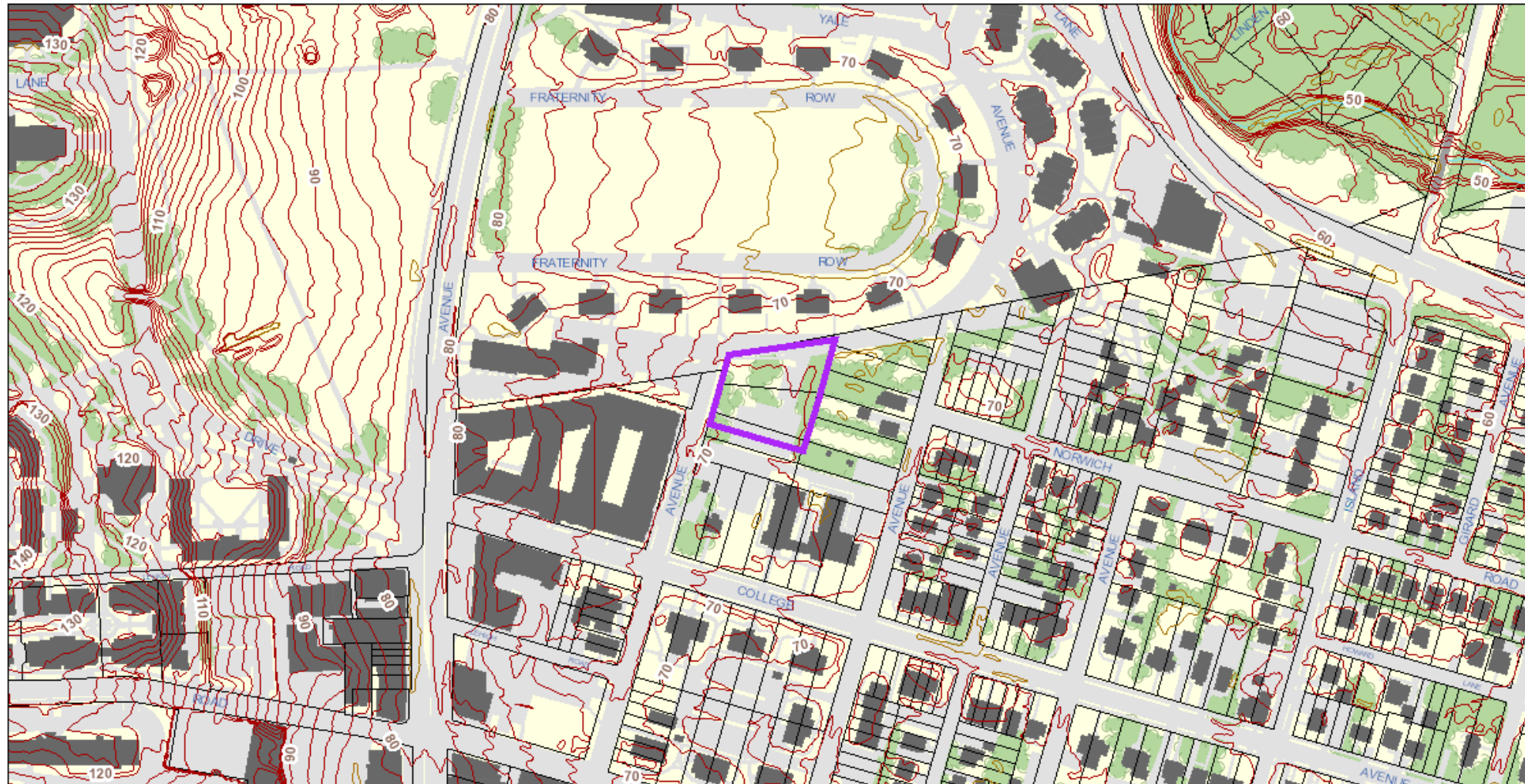

## SITE MAP

### Legend

- Site Boundary
- Building
- Bridge
- Pavement
- Water
- Vegetation
- Property
- Contour Line
- Depression Line
- Railroad Line

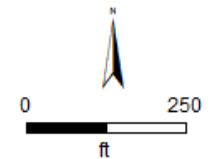

The Maryland-National Capital Park and Planning Commission  
Prince George's County Planning Department  
Geographic Information System

Created: 10/27/2023

# MASTER PLAN RIGHT-OF-WAY MAP





# DETAILED SITE PLAN

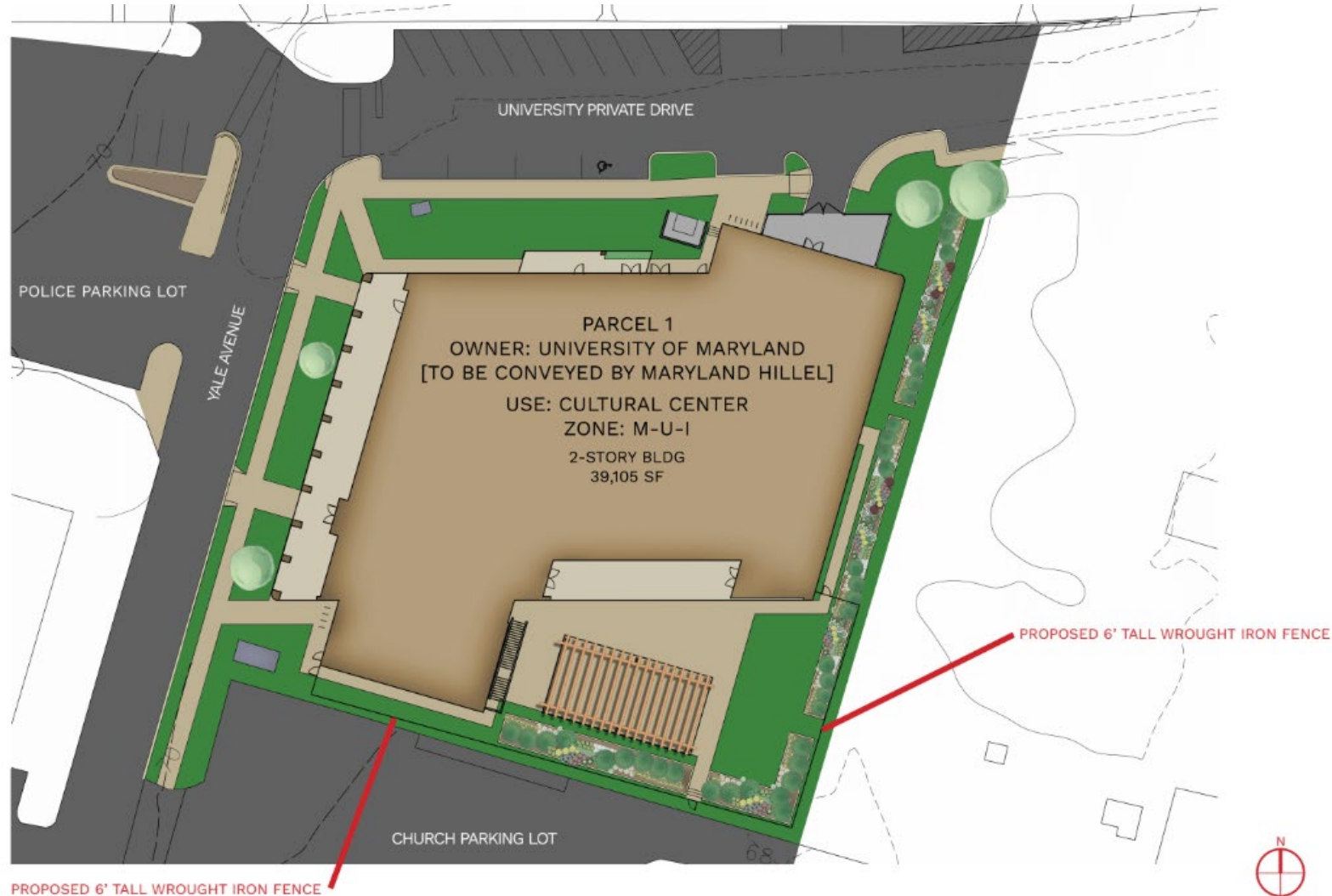

# LANDSCAPE PLAN

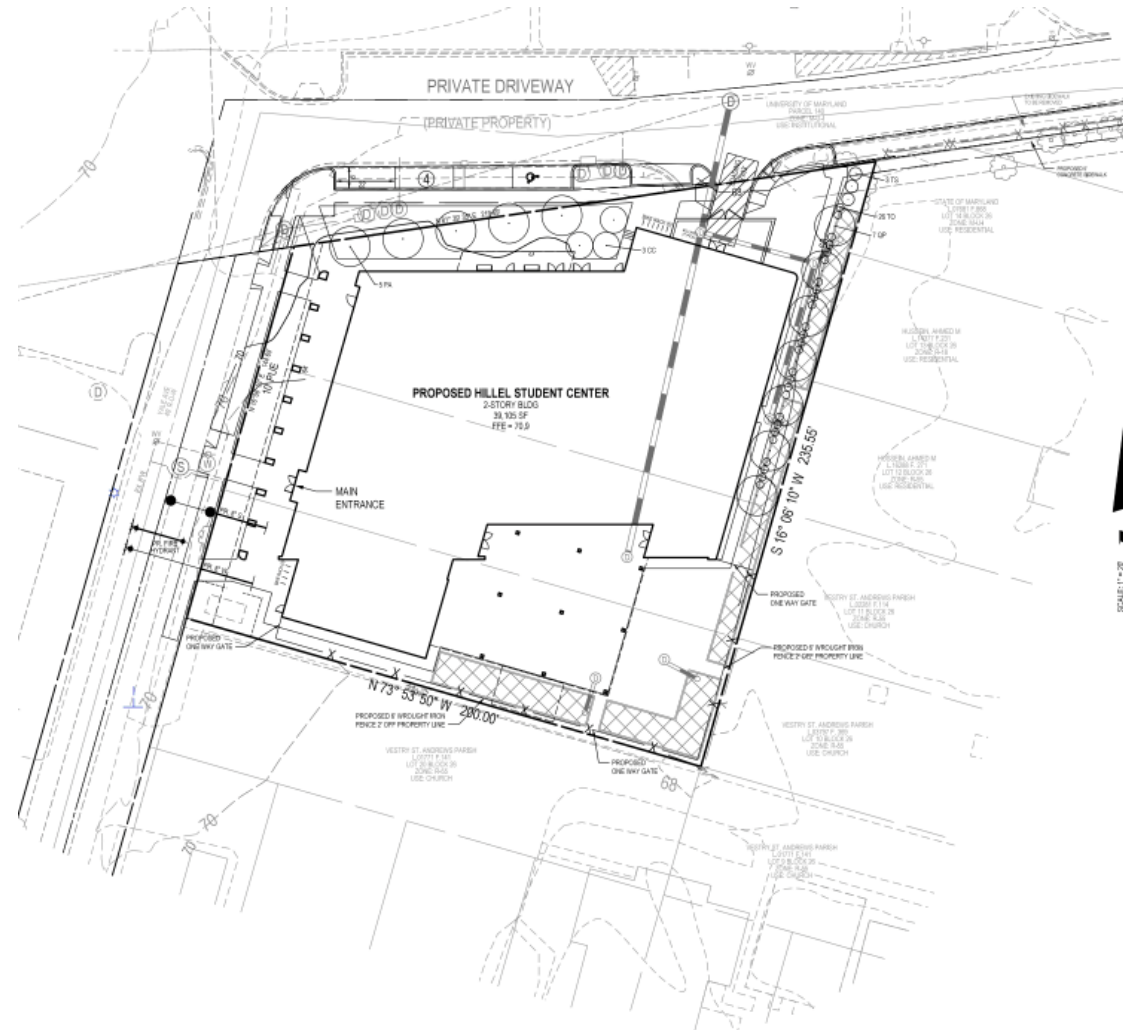









# RENDERING



VERTICAL  
ARCHITECTURE ENTERPRISES

MARYLAND HILLEL  
Hillel @ Yale Avenue | Schematic Design

VIEW @ YALE AVE, FRONT APPROACH  
Date February 2, 2022 Scale

A001

# RENDERING



VERTICAL  
ARCHITECTURE ENTERPRISES

MARYLAND HILLEL  
Hillel @ Yale Avenue | Schematic Design

VIEW FROM COLLEGE AVENUE  
Date February 2, 2022 Scale

A002



# ELEVATIONS



① YALE AVENUE ELEVATION / WEST  
3/64" = 1'-0"



② SOUTH ELEVATION  
3/64" = 1'-0"

VERTICAL  
ARCHITECTURE ENTERPRISES

MARYLAND HILLEL  
Hillel @ Yale Avenue | Schematic Design

ELEVATIONS  
Date February 2, 2022

Scale 3/64" = 1'-0"

A200

# ELEVATIONS



① NORTH ELEVATION  
3/64" = 1'-0"



② EAST ELEVATION  
3/64" = 1'-0"



# STAFF RECOMMENDATION

**APPROVAL** with conditions

**[Major/Minor] Issues:**

- None

**Applicant Required Mailings:**

- Informational Mailing: 9/14/2022
- Acceptance Mailing: 9/28/2023