

Mandatory Referral Review

Staff Recommendation: Approve Staff Recommendations

The University of Maryland, College Park

Stanley R. Zupnik Hall

For review by:

Prince George's County Planning Board

July 25, 2024

GENERAL LOCATION MAP

Council District: 3

Planning Area: 66

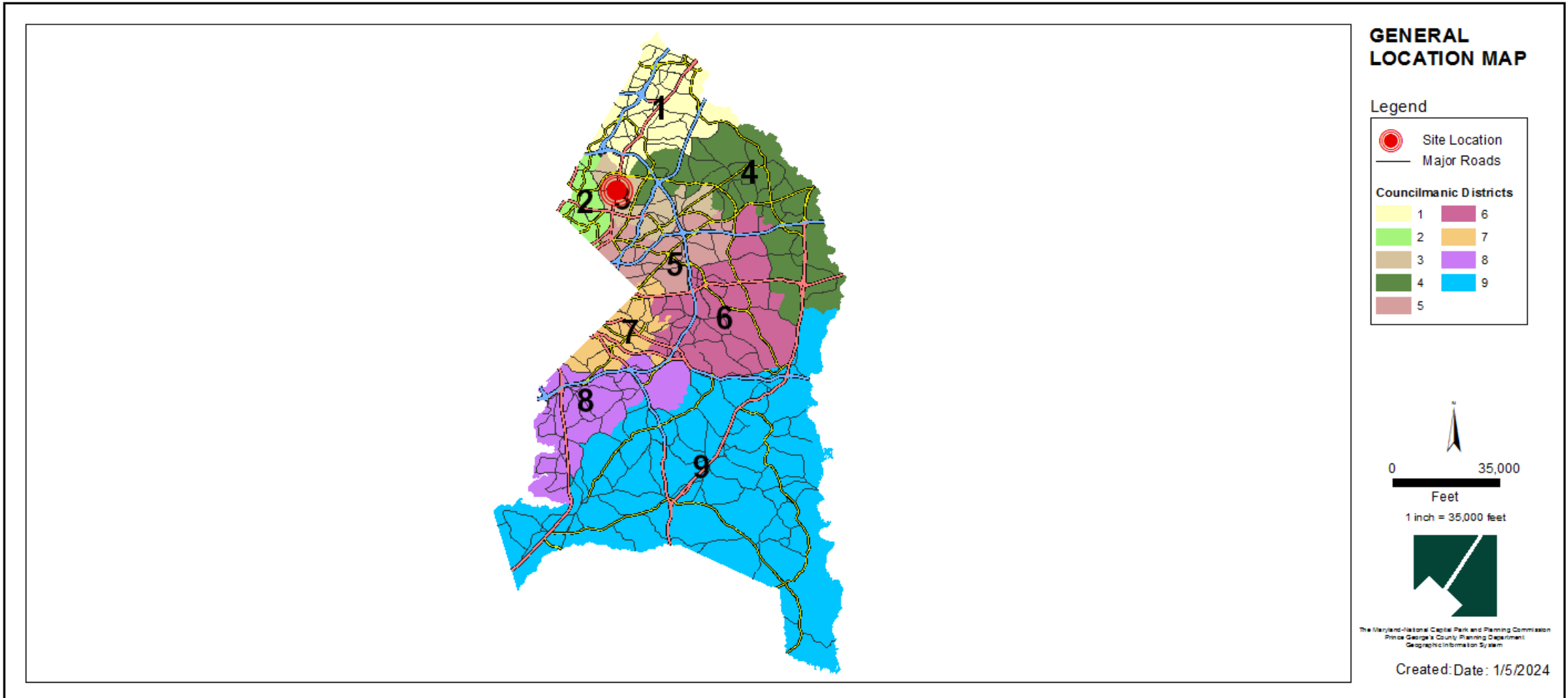

ZONING MAP

Property Zone: R-R

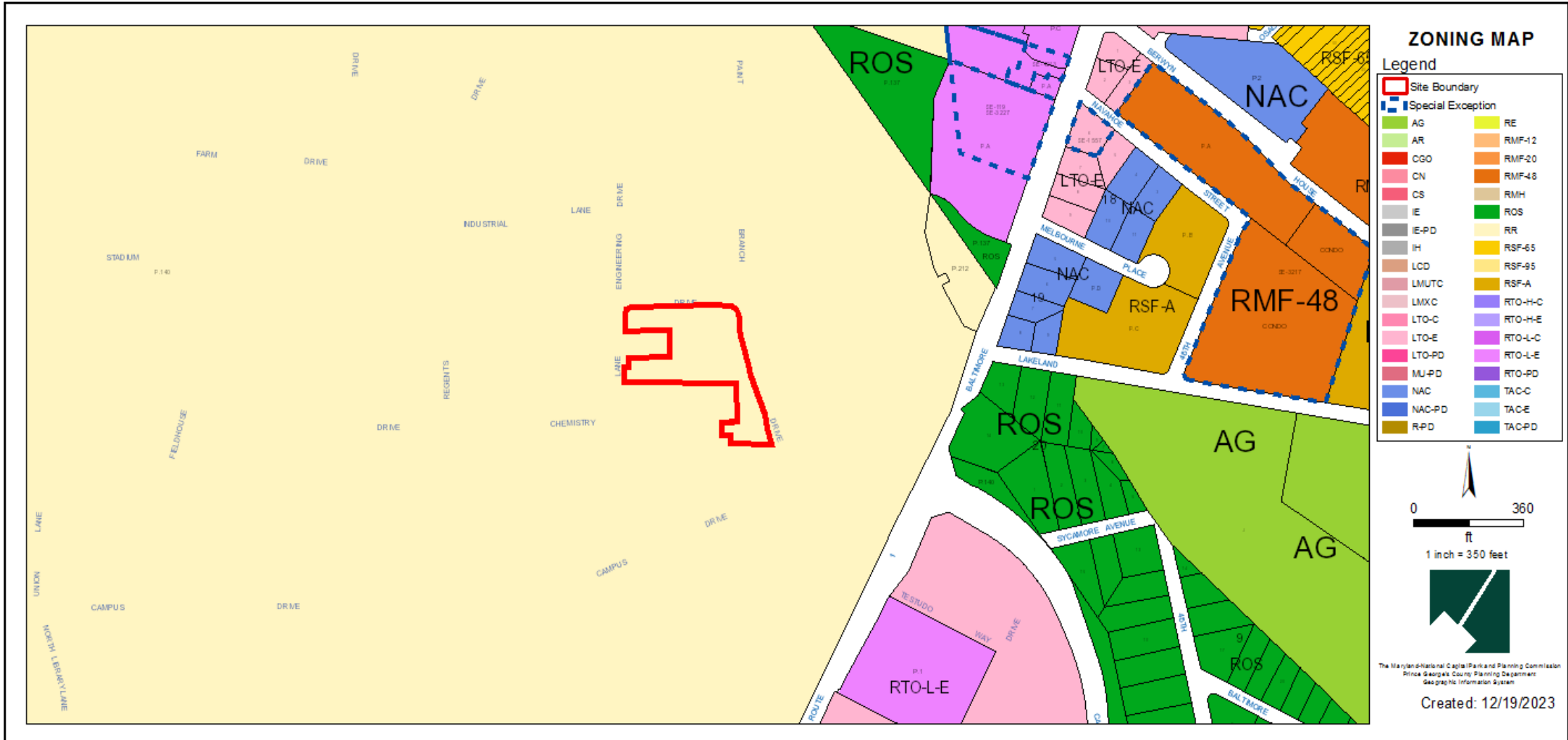

AERIAL MAP



MASTER PLAN RIGHT - OF - WAY

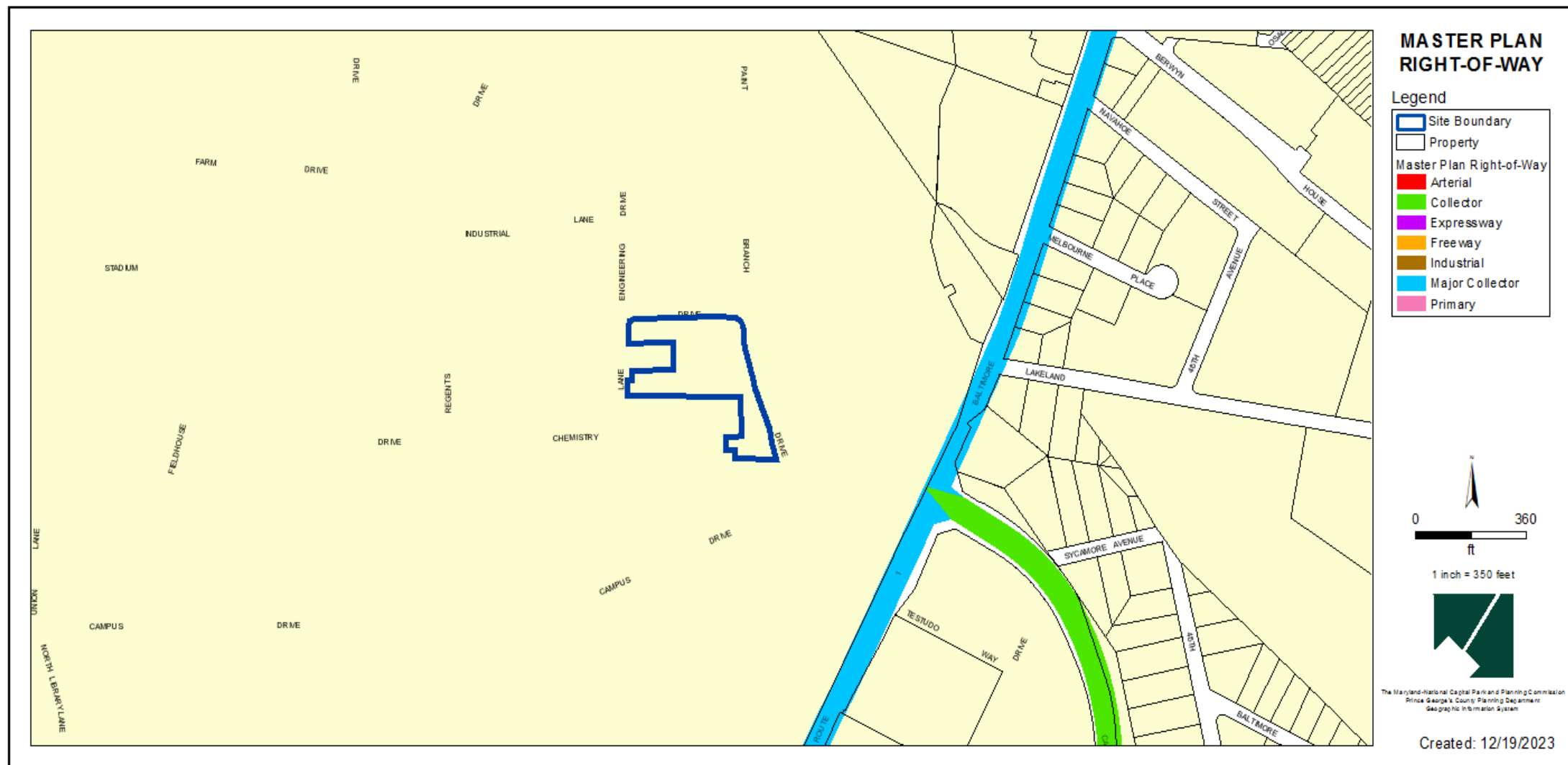

PREVIOUSLY APPROVED & PENDING APPLICATIONS

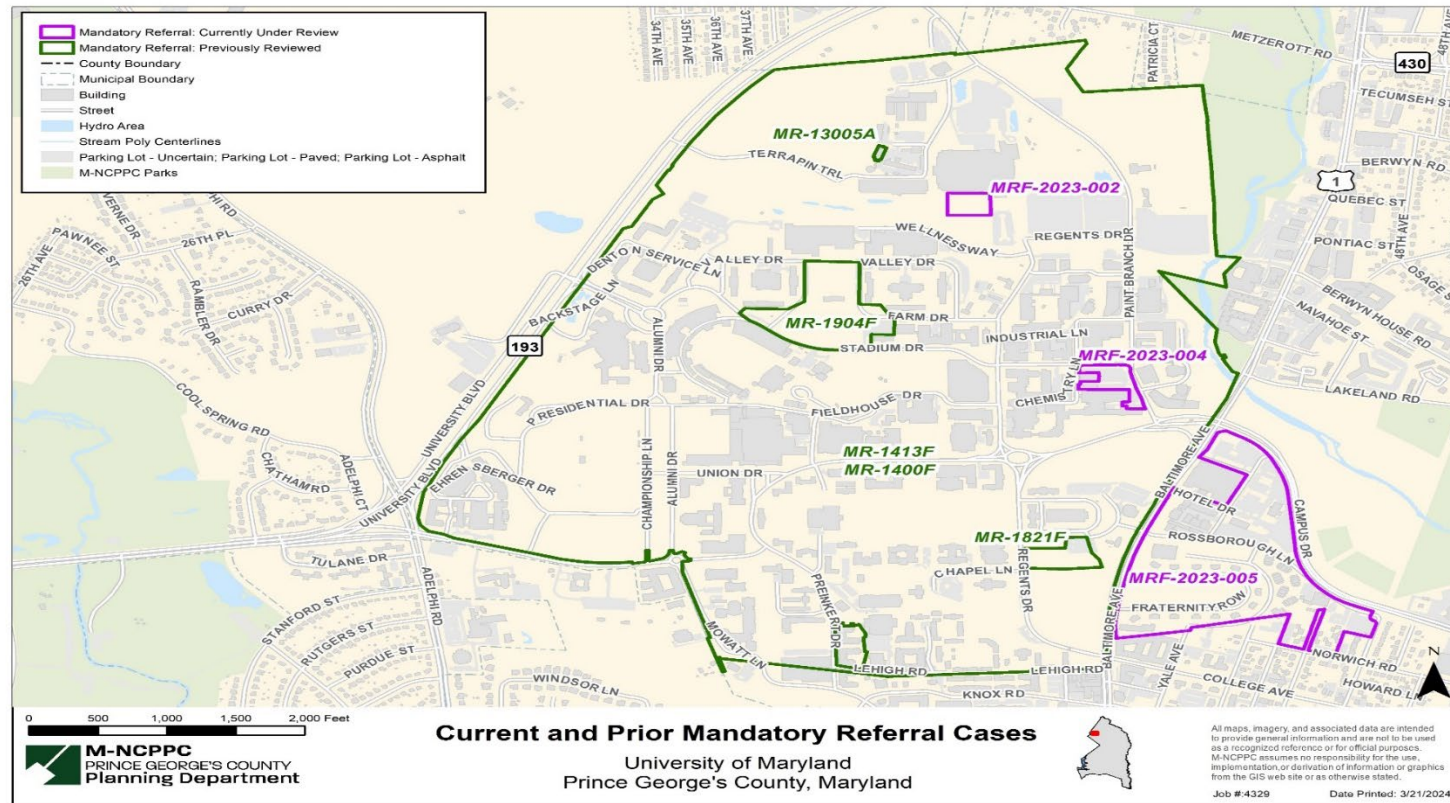

COLLEGE PARK AIRPORT OVERLAY ZONE

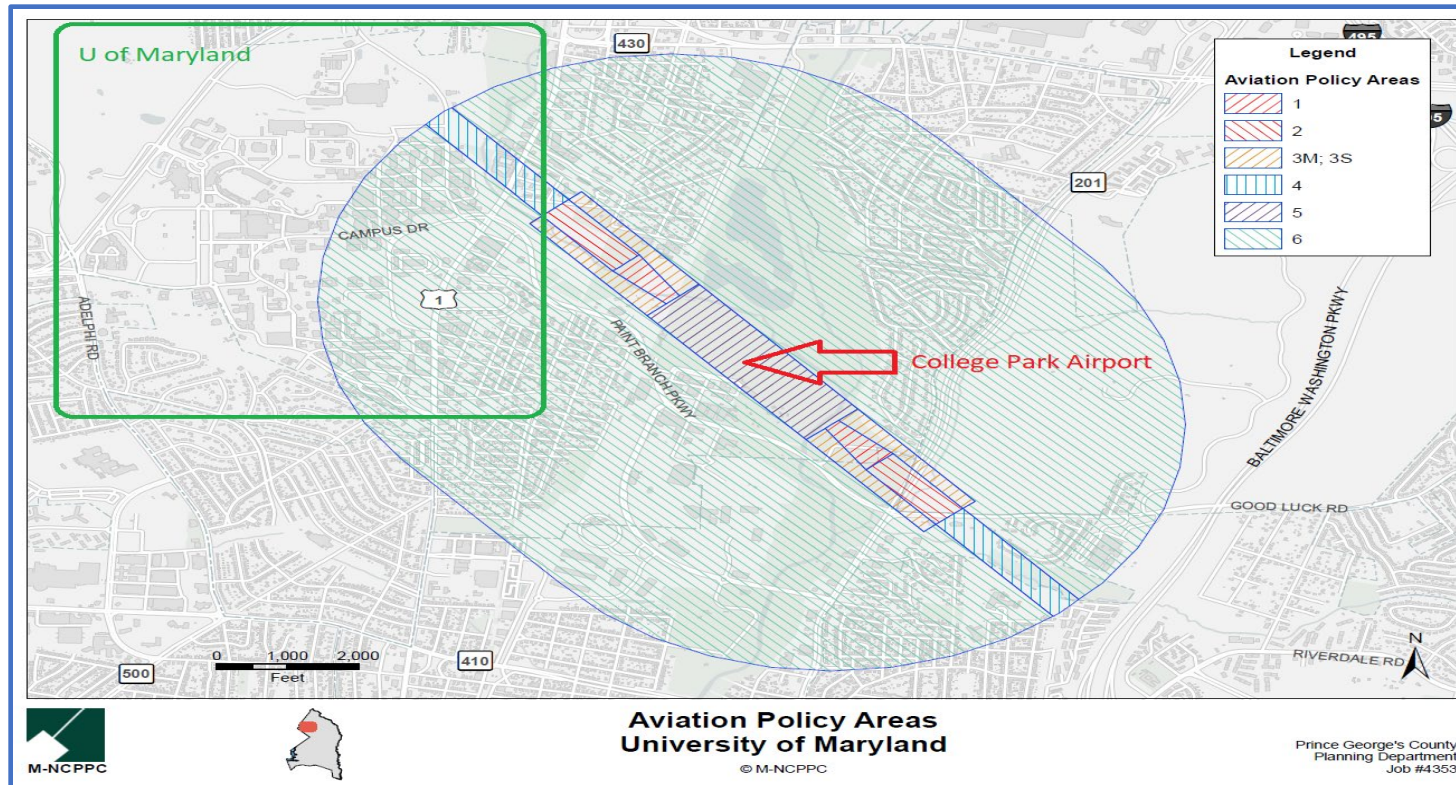

ENVIRONMENTAL SITE FEATURES

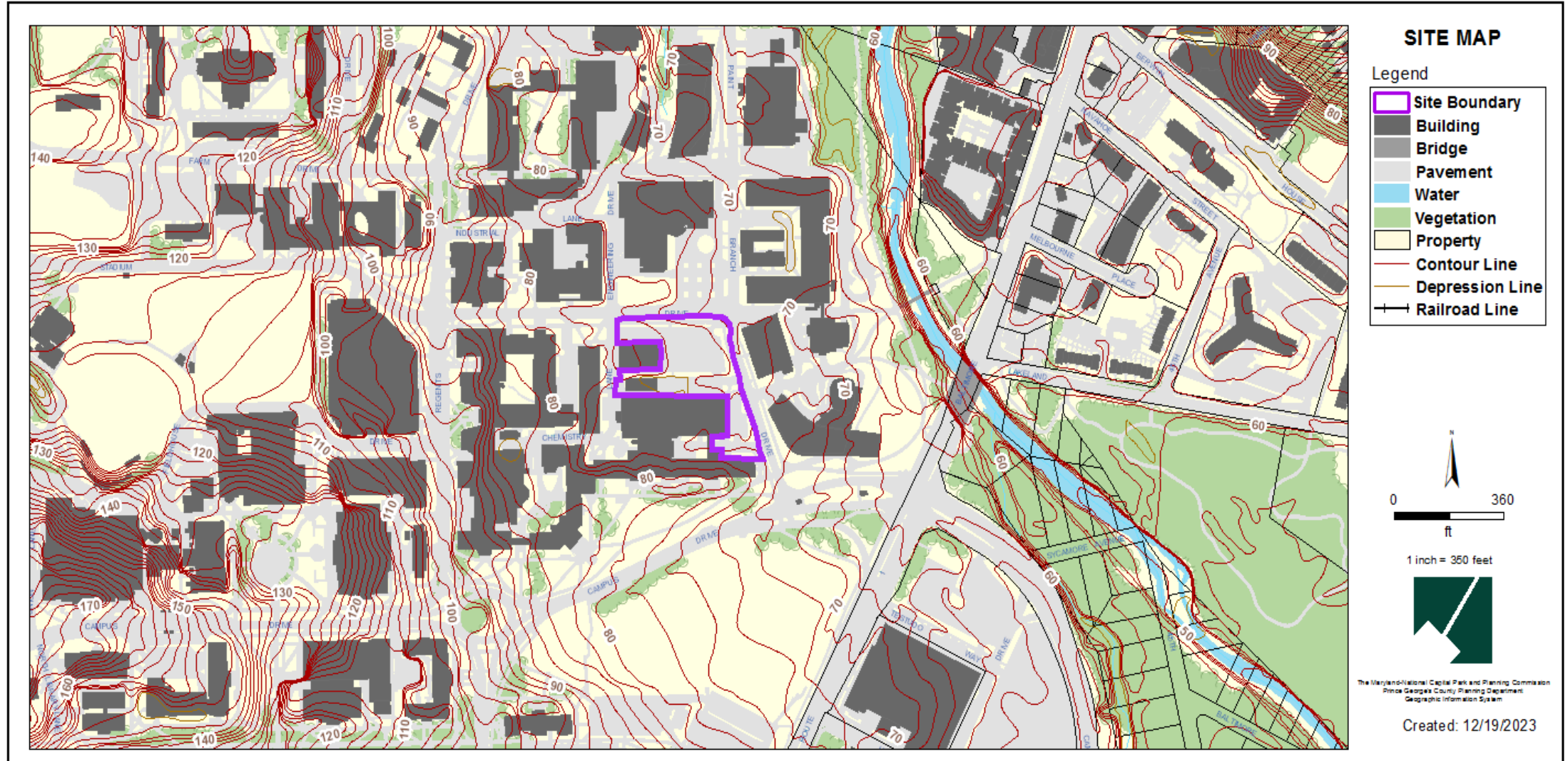

EXISTING SITE CONDITIONS

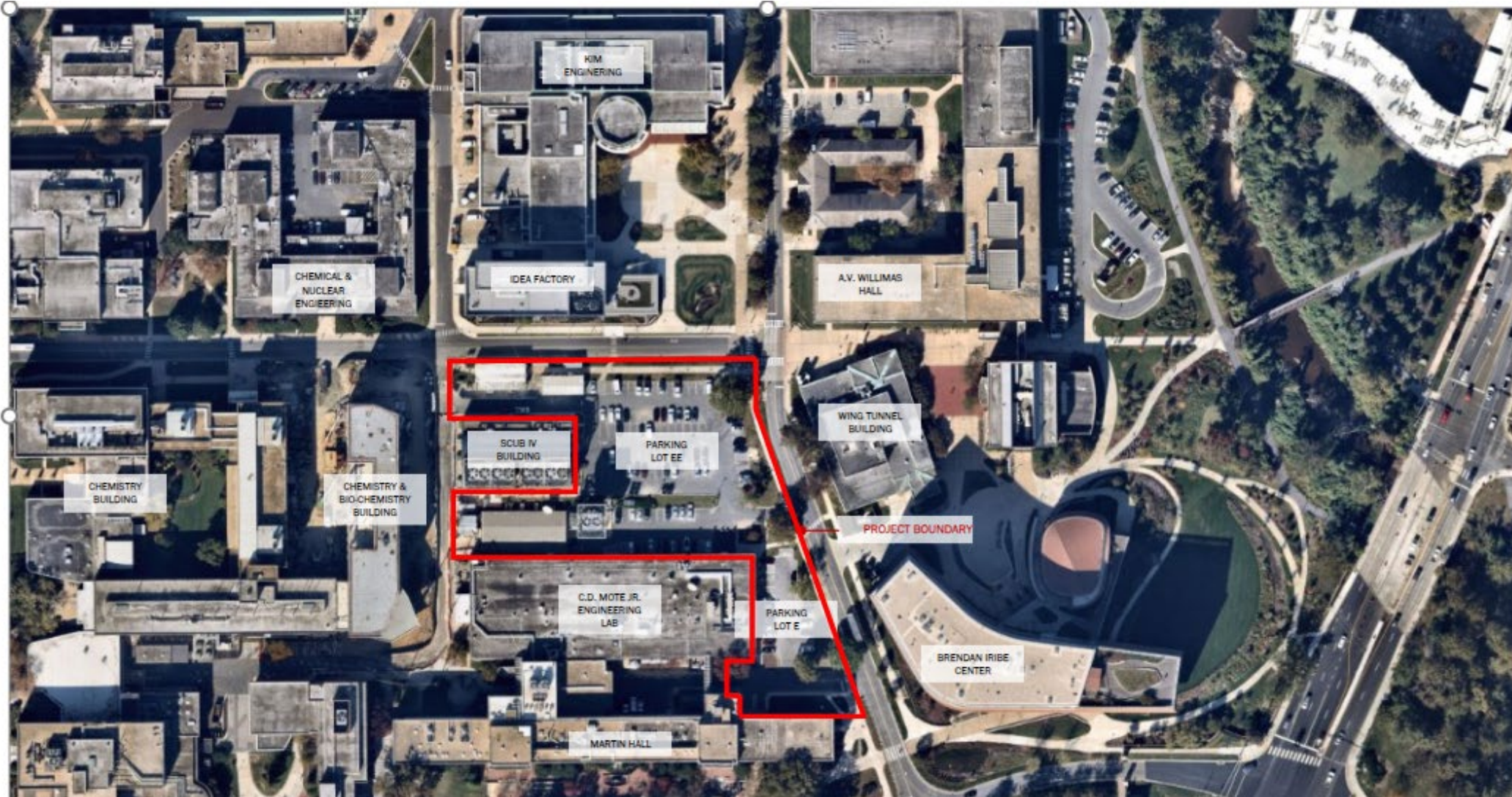

EXISTING SITE CONDITIONS

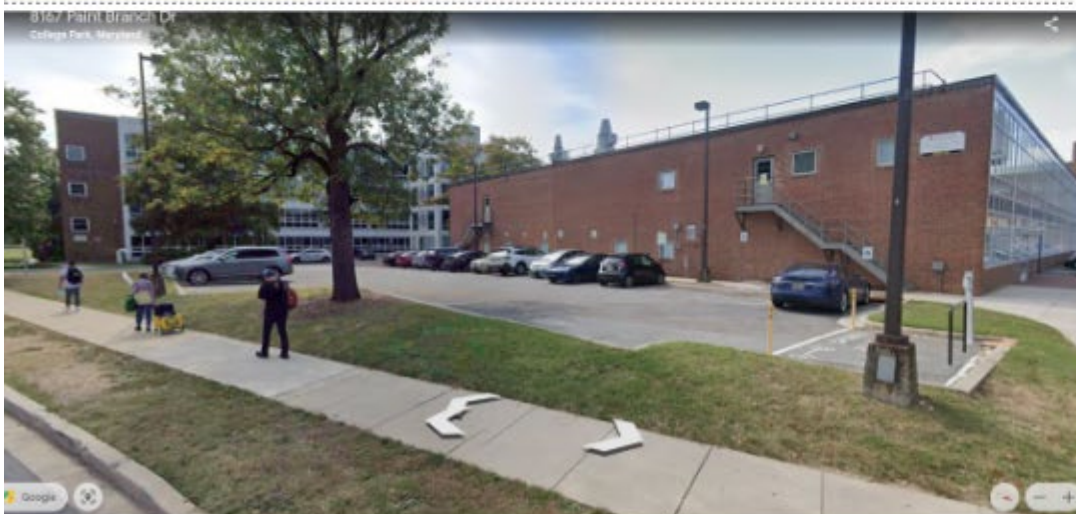

EXISTING BUILDINGS NEAR THE SITE

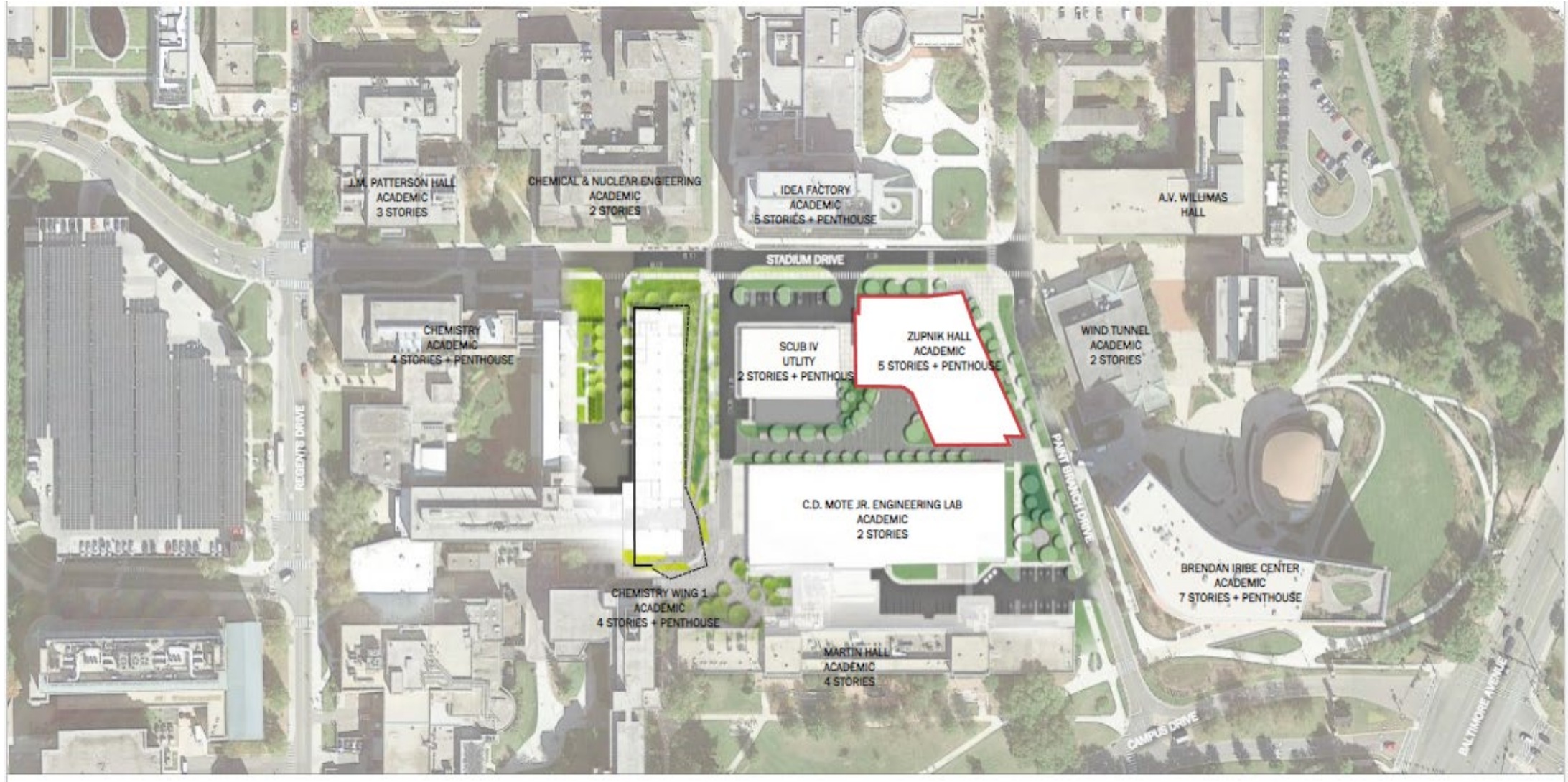

OBJECTIVE/PROJECT FEATURES

Located at 8184 Paint Branch Drive, the new 157,00 Gross Square-foot six-story facility is designed with a basement and at grade level first floor.

- To provide state-of-the-art interdisciplinary engineering building to house:
 - Department of Civil/Environmental Engineering
 - Department of Mechanical Engineering
 - Quantum Technology Center
 - Space for collaboration with partners, including the Center for Advanced Transportation Technology (CATT).
- The site will provide limited parking
- New sidewalks along Paint Branch Drive and Stadium Drive
- A public plaza between Chemistry Lane/Paint Branch Drive
- Meets the demand for increased/expanded research activity outlined in the University's Campus Master Plan.
- Promotes integration and expansion of the A. James Clark School of Engineering to achieve the University's Campus Master Plan goals

PEDESTRIAN/VEHICULAR CONNECTIONS

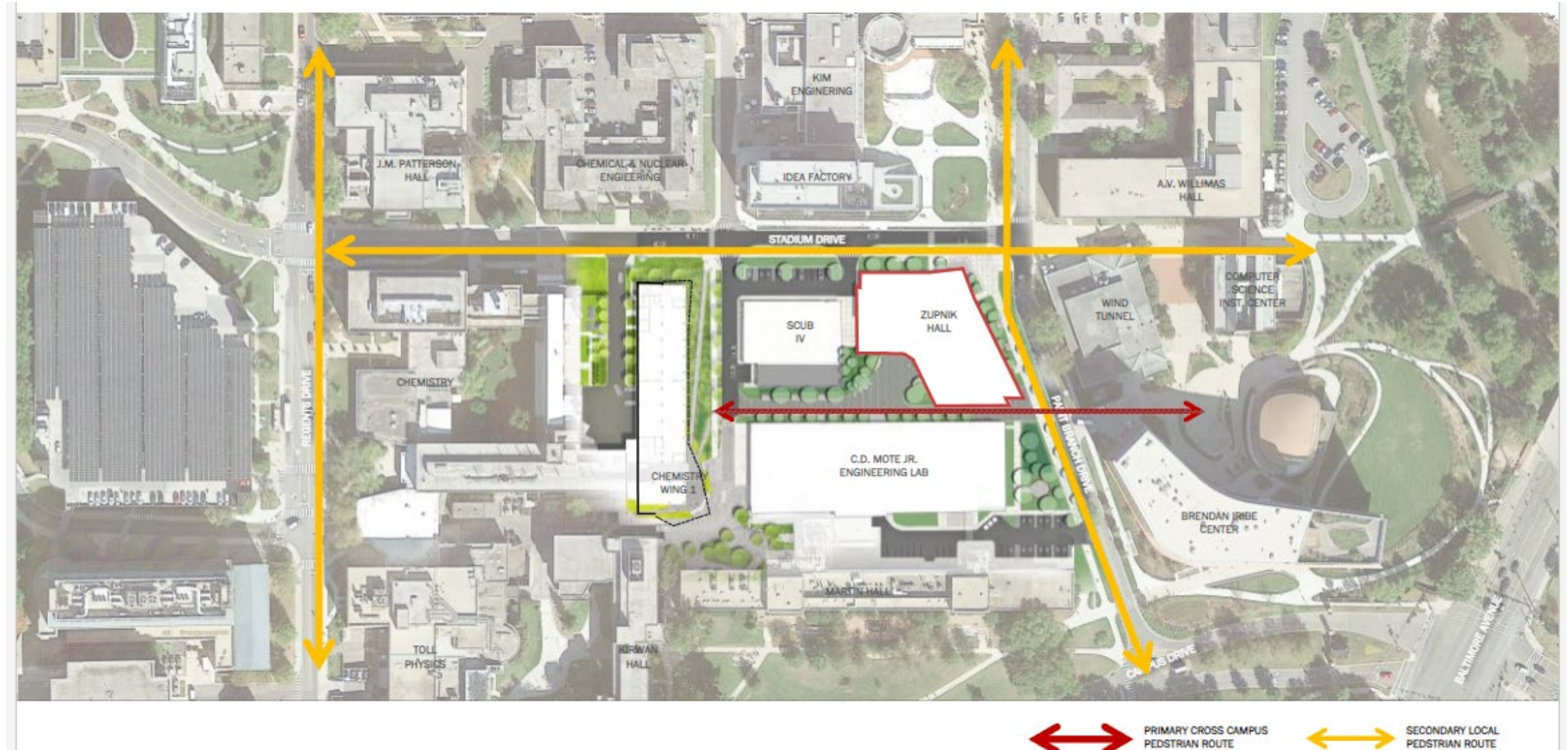

SITE PLAN

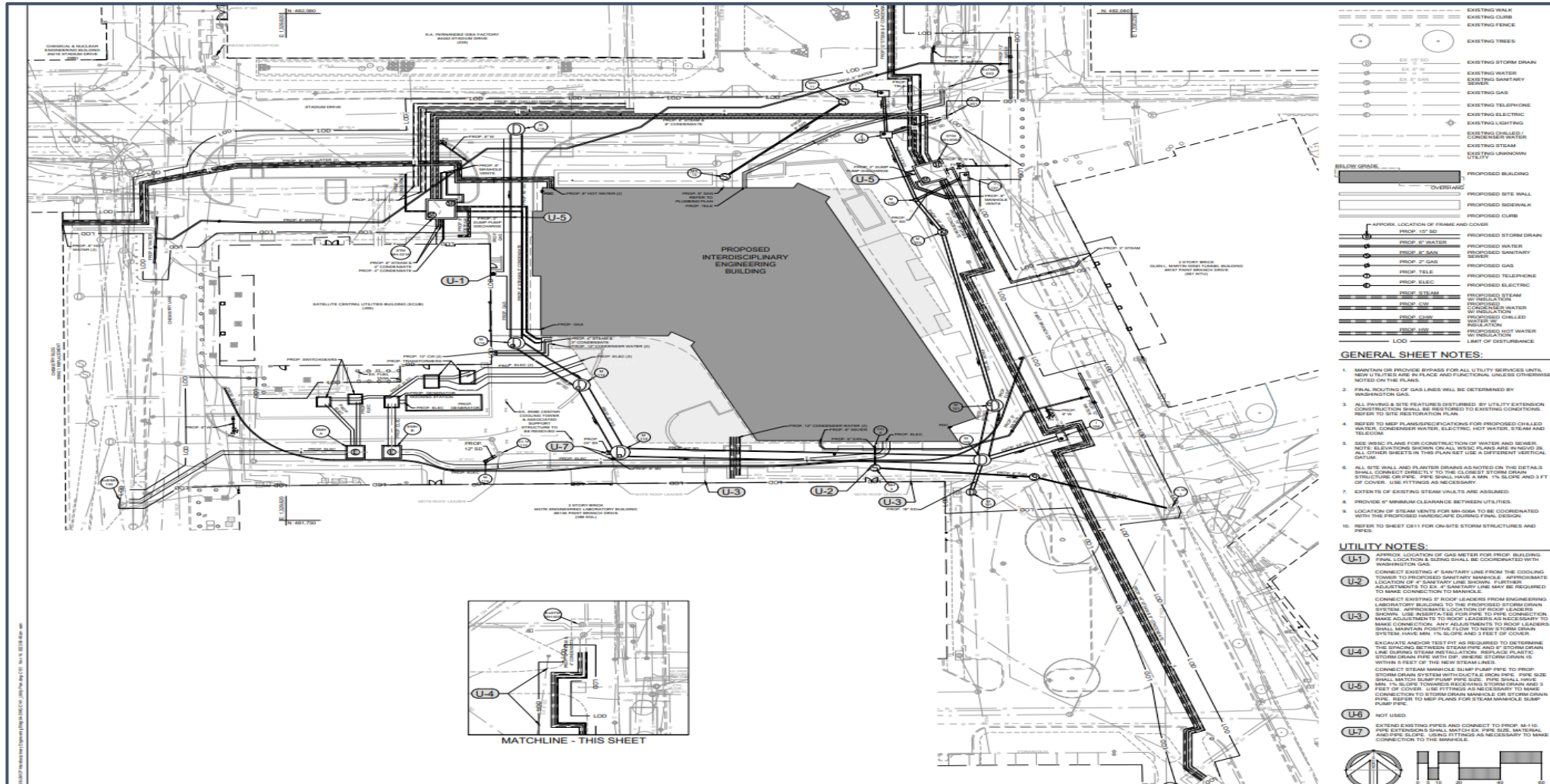

LANDSCAPE PLAN



VIEW FROM PAINT BRANCH & STADIUM DRIVES



AERIAL VIEW LOOKING SOUTH



GROUND FLOOR VIEW



BUILDING/SITE LIGHTING

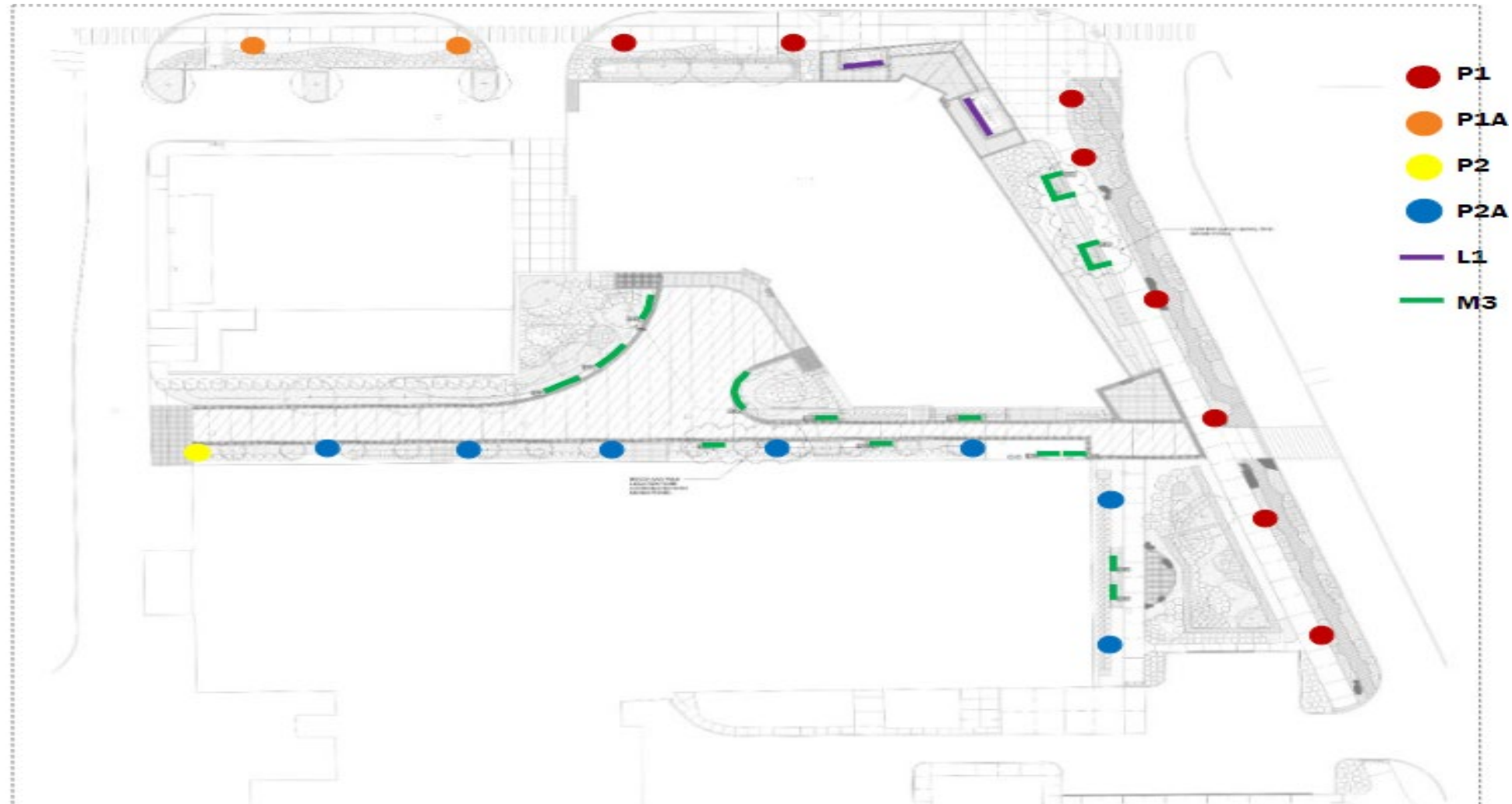

RECOMMENDATIONS

1. The applicant should adhere to the State of Maryland regulations regarding particulate matter pollution and noise during the construction phase.
2. The applicant is encouraged to provide a signage schedule compatible with the University of Maryland Campus.
3. The applicant is encouraged to provide a tree canopy coverage schedule showing an adequate amount of planting provided in conformance with the Tree Canopy Coverage Ordinance.
4. The applicant is encouraged to consider introducing public art and public realm elements that encourage social interaction in public spaces.
5. The applicant should use the recommended standard Saris Bike Corral design or similar inverted-U style bicycle racks.