

MILL BRANCH CROSSING
TREE CONSERVATION PLAN TYPE II
PRINCE GEORGES COUNTY, MARYLAND
MARCH 23, 2017

OWNER
MILL BRANCH CROSSING, LLC
150 WHITE PLAINS ROAD
TARRYTOWN, NY 10591

APPLICANT
WALMART REAL ESTATE BUSINESS TRUST
2001 SE 10TH STREET
BENTONVILLE, AR 72716

LANDSCAPE ARCHITECT
BOWMAN CONSULTING GROUP
14020 THUNDERBOLT PLACE, SUITE 300
CHANTILLY, VA 20151
ATTN: GREGG D. EBERLY
703-464-1000

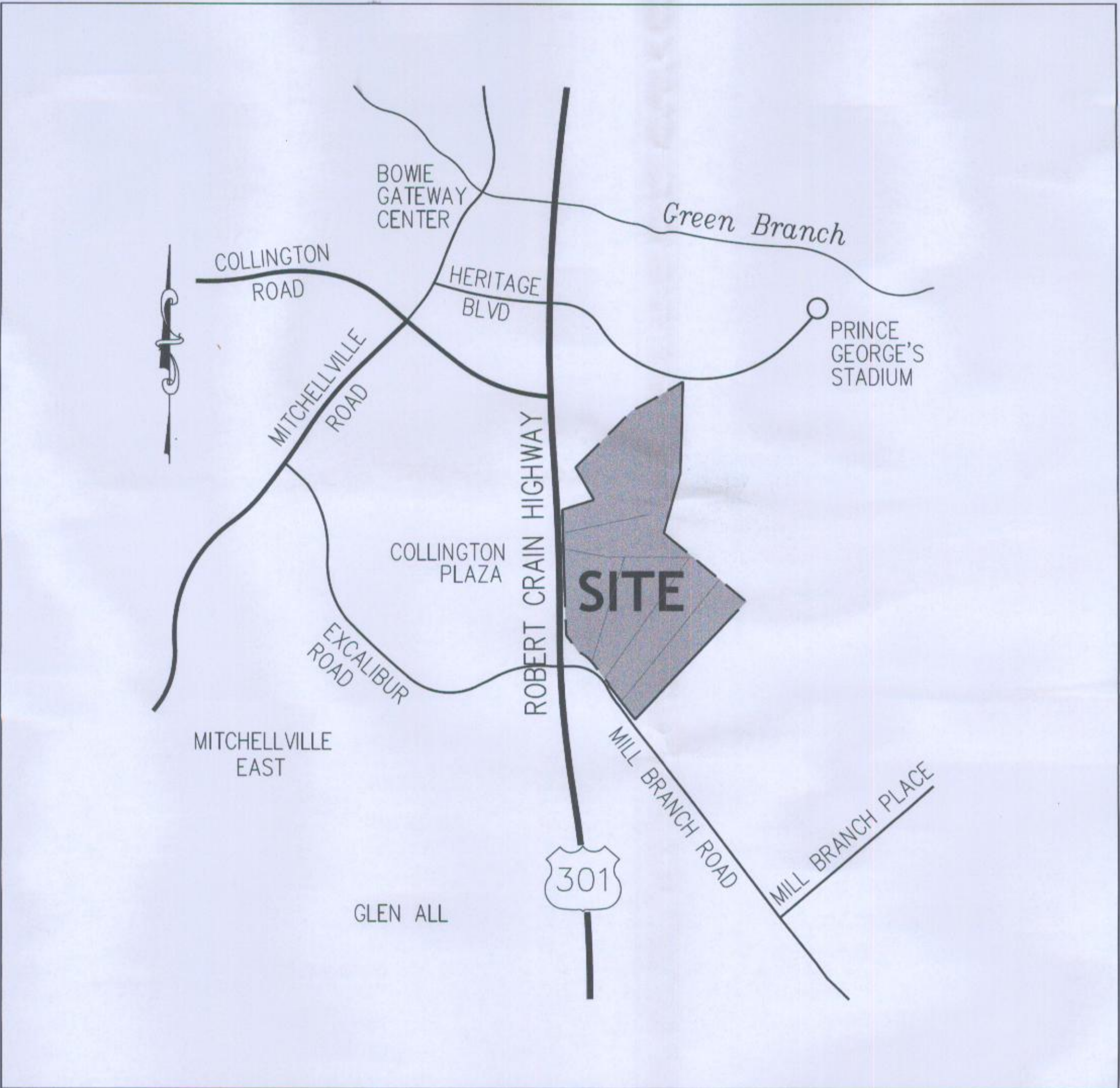

VICINITY MAP
NOT TO SCALE

SHEET INDEX

1. COVER SHEET
2. OVERALL TCP II
3. DETAILED TCP II (1 OF 4)
4. DETAILED TCP II (2 OF 4)
5. DETAILED TCP II (3 OF 4)
6. DETAILED TCP II (4 OF 4)
7. TREE CONSERVATION NOTES
8. TREE CONSERVATION DETAILS (1 OF 2)
9. TREE CONSERVATION DETAILS (2 OF 2)
10. PLANTING SCHEDULES

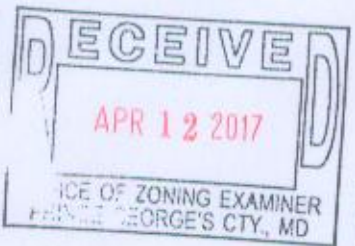

APPROVED
DATE: 4/13/17

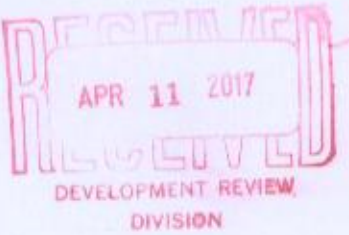

Property Owners Awareness Certificate

I, We STEVE R. DIER hereby acknowledge that we are aware of this revision to the Type 2 Tree Conservation Plan (TCP2) and that we understand the requirements as set forth in this TCP2. All future revisions to this TCP2 plan shall be included all revisions to the TCP2 approved as of the date of certification or signature.

Owner or Owners Representative _____ Date _____

I, We STEVE R. DIER hereby acknowledge that we are aware of this revision to the Type 2 Tree Conservation Plan (TCP2) and that we understand the requirements as set forth in this TCP2. All future revisions to this TCP2 plan shall be included all revisions to the TCP2 approved as of the date of certification or signature.

Contract Purchaser WAL-MART STORES, INC. Date 6/22/17

Prince Georges County Planning Department, MNCPPC			
TREE CONSERVATION PLAN APPROVAL			
TCPIL-016-10			
Approved by	Date	DRED #	Reason for Revision
00 <u>K. Eberly</u>	<u>4/12/17</u>	SE-4734	ZHE: Certification
01			
02			
03			
04			
05			
06			

COVER SHEET
MILL BRANCH CROSSING
PRINCE GEORGES COUNTY, MARYLAND

SE # 4734
DSP # 13034
PLAN NUMBER



PLAN STATUS
10/17/16 REV. PER COUNTY COMMENTS
03/23/17 REV. PER COUNTY COMMENTS

DATE	DESCRIPTION
GDE	GDE
DESIGN	DRAWN
SCALE	CHKD
	H: NO SCALE
	V:
JOB No.	4557-01-002
DATE :	12/28/15
FILE No.	4557-D-SE-001

OVERALL TCP II
MILL BRANCH CROSSING
PRINCE GEORGE'S COUNTY, MARYLAND

GENERAL NOTES

- SUBDIVISION NAME: MILL BRANCH CROSSING
- OWNER: MILL BRANCH CROSSING LLC
- APPLICANT: WALMART REAL ESTATE BUSINESS TRUST
- PREFARER: GREGG D. EBERLY, MD PLA #3609
- BOWMAN CONSULTING
- 14020 THUNDERBOLT PLACE, SUITE 300
CHANTILLY, VA 20151
- TOTAL ACRES: 73.98 AC.
- EXISTING ZONING: C-S-C
- PROPOSED USE: COMMERCIAL SHOPPING CENTER
- EXISTING PARCELS INCLUDED:
TAX MAP 55, GRID E4
PARCELS 20, 27, 28, 52, 57, 58, 59, 71
WSSC GRID ZONES 14
- AVIATION POLICY AREA: N/A
- WSSC WATER AND SEWER CODE:
EXISTING S-4, W-4
- PROPOSED S-3 W-3
- SWA CONCEPT #1284-2010-01
- NO CEMETERIES ARE LOCATED ON-SITE OR CONTIGUOUS TO THE PROPERTY.
- ARCHAEOLOGY INFORMATION WAS PREPARED BY APPLIED ARCHAEOLOGY AND HISTORY ASSOCIATION, INC. PHASE II REPORT ACCEPTED BY THE HISTORIC PRESERVATION SECTION MARCH 31, 2009. ARCHAEOLOGICAL SITES #18PR857 AND #18PR859 ARE PRESENT ON-SITE.
- THE WETLAND AND STREAM INFORMATION ON THIS PLAN IS ORIGINALLY FROM A STUDY PREPARED BY KEN WALLIS, OF WETLAND STUDIES AND SOLUTIONS, DATED OCTOBER, 2008 AND SUBSEQUENTLY REVISED AT THE REQUEST OF MDC DURING A SITE VISIT DATED APRIL 27, 2012. ON JUNE 19, 2012 KEN WALLIS RE-DELINEATED THE SITE PER THE SUPPLEMENTAL MANUAL AND THE ADDITIONAL AREAS IDENTIFIED BY MDC. THE DELINEATION WAS SENT TO MDC FOR THE CONFIRMATION AND HAS BEEN SHOWN ON ALL SUBSEQUENT PLANS.
- THIS SITE DOES NOT CONTAIN WETLANDS OF SPECIAL STATE CONCERN AS DEFINED IN COMAR 26.23.06.01.
- THIS SITE DOES NOT CONTAIN A TIER II WATERBODY AS DEFINED IN COMAR 26.08.02.04.
- THE COUNTY REGISTAR 100-YEAR FLOODPLAIN INFORMATION ON THIS PLAN IS FROM THE PRINCE GEORGES COUNTY DEPARTMENT OF ENVIRONMENTAL RESOURCES FLOODPLAIN STUDY: PPS 200623.
- THIS SITE IS NOT LOCATED WITHIN THE CHESAPEAKE BAY CRITICAL AREA.
- BOUNDARY AND TOPOGRAPHIC SURVEY BY BOWMAN CONSULTING LTD. FEBRUARY 2012.
- 10' PERMANENT UTILITY EASEMENT LOCATED ALONG ALL PROPOSED RIGHT-OF-WAY.
- IN A LETTER DATED JULY 14, 2008, THE MARYLAND DEPARTMENT OF NATURAL RESOURCES NATURAL HERITAGE PROGRAM HAS DETERMINED THAT THERE ARE NO STATE RECORDS FOR RARE, THREATENED OR ENDANGERED SPECIES WITHIN THE BOUNDARY OF THE PROJECT SITE.
- THIS SITE IS SUBJECT TO PREVIOUSLY APPROVED TCP I-022-07.
- THERE ARE THIRTY-SIX (36) SPECIMEN, CHAMPION AND/OR HISTORIC TREES LOCATED ON THE PROPERTY. THESE TREES WERE LOCATED USING GPS METHODS, SEPTEMBER 1, 2016.
- JOINT AFFORESTATION/LANDSCAPE PLANTINGS SHOWN ON THE SE SITE PLAN ARE SUBJECT TO REVISION AT TIME OF DETAILED SITE PLAN TO SATISFY/FULFILL CONDITIONS OF APPROVAL.

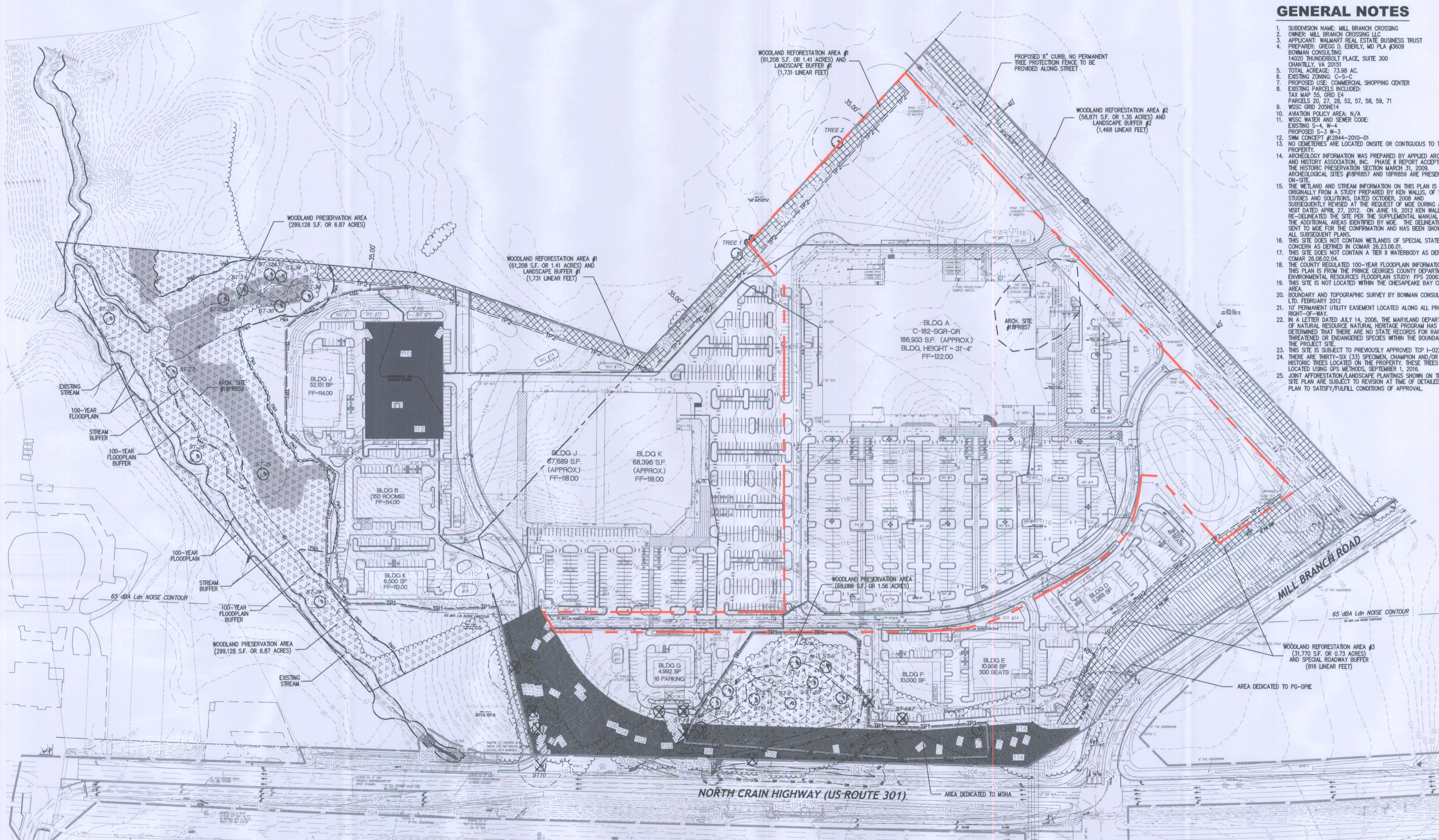

Standard Wetland Conservation Worksheet for Prince George's County				
SECTION I - Establishing Site Information (Enter acres for each zone)				
1. Zone	0.81			
2. Forest Tract	73.98			
3. Floodplain	0.91			
4. Previously Disturbed Land	0.00			
5. Wet Tract (WTA)	73.17	0.00	0.00	
SECTION II - Determining Requirements (Enter acres for each corresponding column)				
	Column A WCT/TP1	Column B WCT/TP2	Column C Floodplain Impacts (1.1)	Column D CP/BS Impacts (1.1)
16. Existing Wetland	10.68		0.00	
17. Wetland of 15 or 16	10.68			
18. Wetland above WCT	0.00		0.00	
19. Wetland cleared	0.00		0.00	
20. Wetland cleared above WCT	0.00		0.00	
21. Clearing above WCT (2.1) - replacement requirement	0.00		0.00	
22. Wetland cleared below WCT	1.71		0.00	
23. Clearing below WCT (2.1) - replacement requirement	3.54		0.00	
24. Wetland cleared	0.00		0.00	
25. Off-site WCA being provided on this property	15.00		0.00	
26. Off-site WCA being provided on this property	0.00		0.00	
27. Off-site WCA being provided on this property	0.00		0.00	
28. Off-site WCA being provided on this property	0.00		0.00	
29. Off-site WCA being provided on this property	0.00		0.00	
30. Off-site WCA being provided on this property	0.00		0.00	
31. Off-site WCA being provided on this property	0.00		0.00	
32. Off-site WCA being provided on this property	0.00		0.00	
33. Off-site WCA being provided on this property	0.00		0.00	
34. Off-site WCA being provided on this property	0.00		0.00	
35. Off-site WCA being provided on this property	0.00		0.00	
36. Off-site WCA being provided on this property	0.00		0.00	
37. Off-site WCA being provided on this property	0.00		0.00	
38. Off-site WCA being provided on this property	0.00		0.00	
39. Area of wetland not cleared	0.43		0.00	
40. Wetland not cleared related to part of requirements	0.00		0.00	
41. 100-year floodplain related	0.91		0.00	
42. On-site wetland conservation project	11.92		0.00	
43. On-site wetland related to 42	0.48		0.00	
44. Prepared by	GREGG D. EBERLY			
45. Date	03/23/17			

SITE DATA

- TOTAL SITE ACRES: 73.98 ACRES
 - FLOODPLAIN AREA: 0.81 ACRES
 - EXISTING WETLAND IN FLOODPLAIN: 0.48 ACRES
 - STEEP SLOPES 25% OR GREATER: 0.96 ACRES
 - NON-TIDAL WETLANDS: 1.18 ACRES
 - TOTAL WETLANDS: 0.00 ACRES
 - EXISTING PMA: 7.40 ACRES
 - STREAM LENGTH: 1.85 LF
 - STREAM BUFFER: 75 FEET
- NOTE:
SITE AND PLAN DATA PER NRI-029-07-(03) APPROVED 12/22/16.

SPECIMEN TREE CHART

SPECIMEN NUMBER	SPECIES	CONDITION	STATUS	SIZE (INCHES)
TREE 1	BLACK WALNUT	POOR	SAVE	38.5
TREE 2	BLACK WALNUT	POOR	SAVE	41.5
ST-1	RED MAPLE	POOR	REMOVE	39
ST-2	SWEET GUM	FAIR	SAVE	39
ST-3	RED MAPLE	POOR	REMOVE	39
ST-4	RED MAPLE	POOR	REMOVE	37.5
ST-5	RED MAPLE	GOOD	REMOVE	39
ST-6	RED MAPLE	POOR	REMOVE	39
ST-7	RED MAPLE	POOR	REMOVE	39
ST-8	RED MAPLE	POOR	REMOVE	39
ST-9	RED MAPLE	POOR	REMOVE	39
ST-10	RED MAPLE	POOR	REMOVE	39
ST-11	WHITE OAK	POOR	REMOVE	36.5
ST-12	WHITE OAK	POOR	REMOVE	36.5
ST-13	RED MAPLE	POOR	REMOVE	39
ST-14	RED MAPLE	POOR	REMOVE	39
ST-15	RED MAPLE	POOR	REMOVE	39
ST-16	RED MAPLE	POOR	REMOVE	39
ST-17	RED MAPLE	POOR	REMOVE	39
ST-18	RED MAPLE	POOR	REMOVE	39
ST-19	RED MAPLE	POOR	REMOVE	39
ST-20	RED MAPLE	POOR	REMOVE	39
ST-21	RED MAPLE	POOR	REMOVE	39
ST-22	RED MAPLE	POOR	REMOVE	39
ST-23	RED MAPLE	POOR	REMOVE	39
ST-24	RED MAPLE	POOR	REMOVE	39
ST-25	RED MAPLE	POOR	REMOVE	39
ST-26	RED MAPLE	POOR	REMOVE	39
ST-27	RED MAPLE	POOR	REMOVE	39
ST-28	RED MAPLE	POOR	REMOVE	39
ST-29	RED MAPLE	POOR	REMOVE	39
ST-30	RED MAPLE	POOR	REMOVE	39
ST-31	RED MAPLE	POOR	REMOVE	39
ST-32	RED MAPLE	POOR	REMOVE	39
ST-33	RED MAPLE	POOR	REMOVE	39
ST-34	RED MAPLE	POOR	REMOVE	39
ST-35	RED MAPLE	POOR	REMOVE	39
ST-36	RED MAPLE	POOR	REMOVE	39
ST-37	RED MAPLE	POOR	REMOVE	39
ST-38	RED MAPLE	POOR	REMOVE	39
ST-39	RED MAPLE	POOR	REMOVE	39
ST-40	RED MAPLE	POOR	REMOVE	39
ST-41	RED MAPLE	POOR	REMOVE	39
ST-42	RED MAPLE	POOR	REMOVE	39
ST-43	RED MAPLE	POOR	REMOVE	39
ST-44	RED MAPLE	POOR	REMOVE	39
ST-45	RED MAPLE	POOR	REMOVE	39
ST-46	RED MAPLE	POOR	REMOVE	39
ST-47	RED MAPLE	POOR	REMOVE	39
ST-48	RED MAPLE	POOR	REMOVE	39
ST-49	RED MAPLE	POOR	REMOVE	39
ST-50	RED MAPLE	POOR	REMOVE	39
ST-51	RED MAPLE	POOR	REMOVE	39
ST-52	RED MAPLE	POOR	REMOVE	39
ST-53	RED MAPLE	POOR	REMOVE	39
ST-54	RED MAPLE	POOR	REMOVE	39
ST-55	RED MAPLE	POOR	REMOVE	39
ST-56	RED MAPLE	POOR	REMOVE	39
ST-57	RED MAPLE	POOR	REMOVE	39
ST-58	RED MAPLE	POOR	REMOVE	39
ST-59	RED MAPLE	POOR	REMOVE	39
ST-60	RED MAPLE	POOR	REMOVE	39
ST-61	RED MAPLE	POOR	REMOVE	39
ST-62	RED MAPLE	POOR	REMOVE	39
ST-63	RED MAPLE	POOR	REMOVE	39
ST-64	RED MAPLE	POOR	REMOVE	39
ST-65	RED MAPLE	POOR	REMOVE	39
ST-66	RED MAPLE	POOR	REMOVE	39
ST-67	RED MAPLE	POOR	REMOVE	39
ST-68	RED MAPLE	POOR	REMOVE	39
ST-69	RED MAPLE	POOR	REMOVE	39
ST-70	RED MAPLE	POOR	REMOVE	39
ST-71	RED MAPLE	POOR	REMOVE	39
ST-72	RED MAPLE	POOR	REMOVE	39
ST-73	RED MAPLE	POOR	REMOVE	39
ST-74	RED MAPLE	POOR	REMOVE	39
ST-75	RED MAPLE	POOR	REMOVE	39
ST-76	RED MAPLE	POOR	REMOVE	39
ST-77	RED MAPLE	POOR	REMOVE	39
ST-78	RED MAPLE	POOR	REMOVE	39
ST-79	RED MAPLE	POOR	REMOVE	39
ST-80	RED MAPLE	POOR	REMOVE	39
ST-81	RED MAPLE	POOR	REMOVE	39
ST-82	RED MAPLE	POOR	REMOVE	39
ST-83	RED MAPLE	POOR	REMOVE	39
ST-84	RED MAPLE	POOR	REMOVE	39
ST-85	RED MAPLE	POOR	REMOVE	39
ST-86	RED MAPLE	POOR	REMOVE	39
ST-87	RED MAPLE	POOR	REMOVE	39
ST-88	RED MAPLE	POOR	REMOVE	39
ST-89	RED MAPLE	POOR	REMOVE	39
ST-90	RED MAPLE	POOR	REMOVE	39
ST-91	RED MAPLE	POOR	REMOVE	39
ST-92	RED MAPLE	POOR	REMOVE	39
ST-93	RED MAPLE	POOR	REMOVE	39
ST-94	RED MAPLE	POOR	REMOVE	39
ST-95	RED MAPLE	POOR	REMOVE	39
ST-96	RED MAPLE	POOR	REMOVE	39
ST-97	RED MAPLE	POOR	REMOVE	39
ST-98	RED MAPLE	POOR	REMOVE	39
ST-99	RED MAPLE	POOR	REMOVE	39
ST-100	RED MAPLE	POOR	REMOVE	39

LEGEND

TP1	TEMPORARY TREE PROTECTION FENCE FOR WOODLAND PRESERVATION AREAS (SEE DETAILS #4 & #5 ON SHEET 8)
TP2	PERMANENT TREE PROTECTION FENCE FOR REFORESTATION AREAS (SEE DETAIL #9 ON SHEET 8)
SB	75' STREAM BUFFER
PMA	PRIMARY MANAGEMENT AREA
WB	25' WETLAND BUFFER
ES	EXISTING STREAM
EF	EXISTING 100-YEAR FLOODPLAIN
FB	50' FLOODPLAIN BUFFER
ET	EXISTING TREELINE
PLD	PROPOSED LIMITS OF DISTURBANCE
EW	EXISTING WETLAND
AD	AREA TO BE DEDICATED TO MSHA & PG-DPE
WR	WOODLAND PRESERVATION AREA (NO CREDIT TAKEN WITHIN 100-YEAR FLOODPLAIN)
WRP	WOODLAND REFORESTATION AND LANDSCAPE AREA (AREA TO BE PLANTED TO SATISFY BOTH WOODLAND CONSERVATION AND LANDSCAPE MANUAL REQUIREMENTS AND/OR CONDITIONS OF APPROVAL)
ADP	AREA DEDICATED TO PG-DPE
SS	STEEP SLOPES (15% AND GREATER)
ST-1	SPECIMEN TREE TO BE PRESERVED (W/ CRITICAL ROOT ZONE)
ST-2	SPECIMEN TREE TO BE REMOVED (W/ CRITICAL ROOT ZONE)

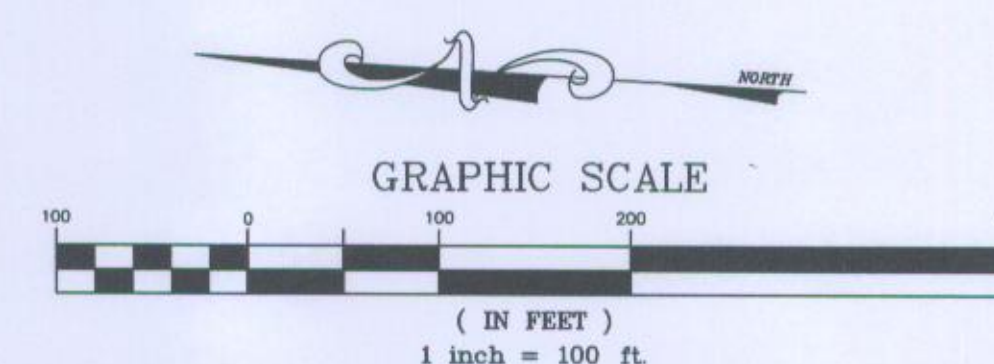

APPROVED

HEARING EXAMINER

DATE:

Prince George's County Planning Department, MNC-PPC TREE CONSERVATION PLAN APPROVAL TCPH-016-10			
Approved by	Date	Reviewed by	Reason for Revision
00 KIPm	4/12/17	SE-4734	ZHE Certification
01			
02			
03			
04			
05			
06			

APPROVED
SE # 4734
DSP # 13034
PLAN NUMBERPLAN STATUS
10/17/16 REV. PER COUNTY COMMENTS
03/23/17 REV. PER COUNTY COMMENTSDATE DESCRIPTION
GDE GDE GDE
DESIGN DRAWN CHKD
SCALE H: 1"=100'
V: 1"=100'
JOB No. 4557-01-002
DATE: 12/28/15
FILE No. 4557-D-SE-001
SHEET 2 OF 10

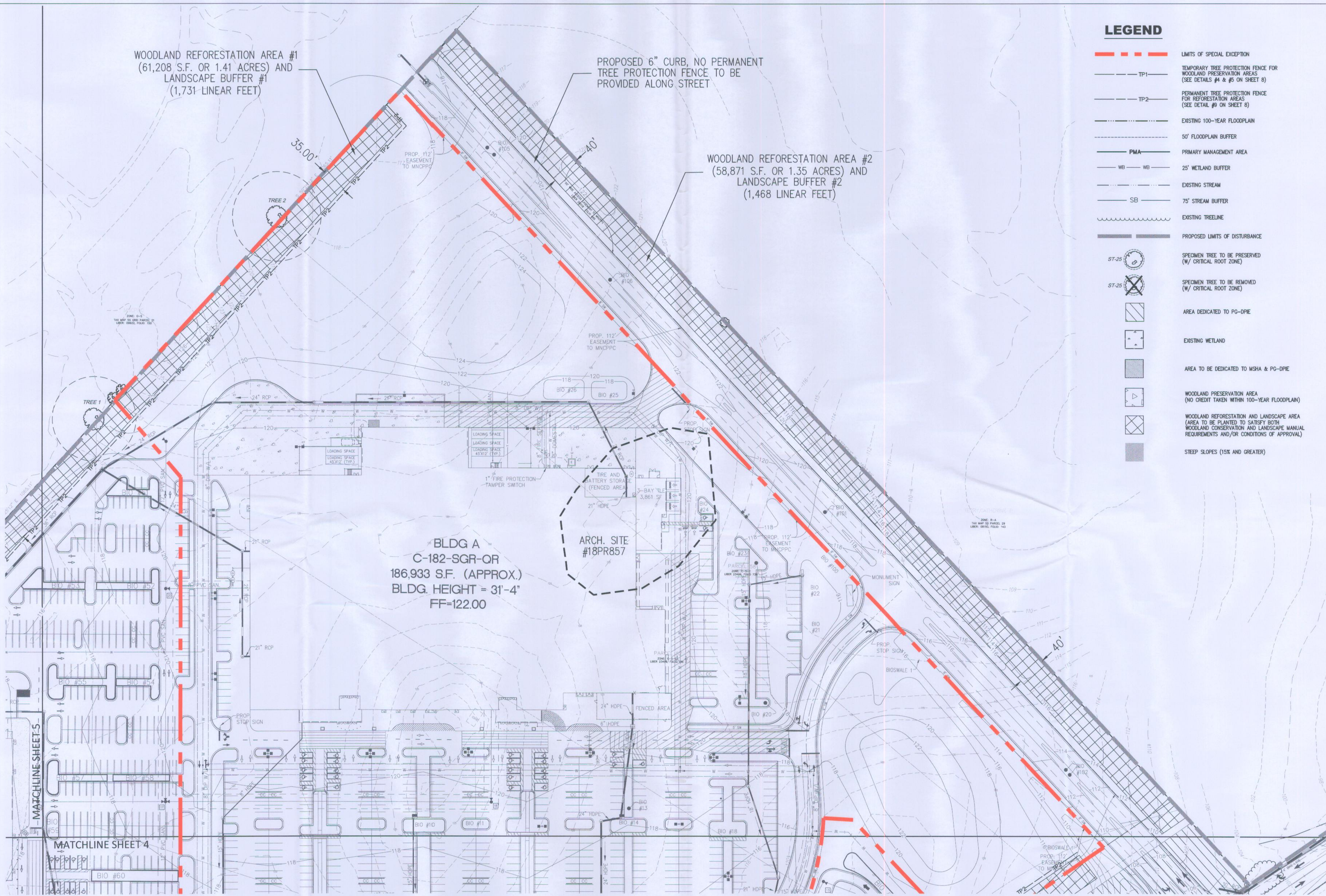

LEGEND

- LIMITS OF SPECIAL EXCEPTION
- TP1 --- TEMPORARY TREE PROTECTION FENCE FOR WOODLAND PRESERVATION AREAS (SEE DETAILS #4 & #5 ON SHEET 8)
- TP2 --- PERMANENT TREE PROTECTION FENCE FOR REFORESTATION AREAS (SEE DETAIL #9 ON SHEET 8)
- EXISTING 100-YEAR FLOODPLAIN
- 50' FLOODPLAIN BUFFER
- PMA --- PRIMARY MANAGEMENT AREA
- WB --- 25' WETLAND BUFFER
- SB --- 75' STREAM BUFFER
- EXISTING TREELINE
- PROPOSED LIMITS OF DISTURBANCE
- ST-25 (Symbol) --- SPECIMEN TREE TO BE PRESERVED (W/ CRITICAL ROOT ZONE)
- ST-25 (Symbol) --- SPECIMEN TREE TO BE REMOVED (W/ CRITICAL ROOT ZONE)
- (Symbol) --- AREA DEDICATED TO PG-DPIE
- (Symbol) --- EXISTING WETLAND
- (Symbol) --- AREA TO BE DEDICATED TO MSHA & PG-DPIE
- (Symbol) --- WOODLAND PRESERVATION AREA (NO CREDIT TAKEN WITHIN 100-YEAR FLOODPLAIN)
- (Symbol) --- WOODLAND REFORESTATION AND LANDSCAPE AREA (AREA TO BE PLANTED TO SATISFY BOTH WOODLAND CONSERVATION AND LANDSCAPE MANUAL REQUIREMENTS AND/OR CONDITIONS OF APPROVAL)
- (Symbol) --- STEEP SLOPES (15% AND GREATER)

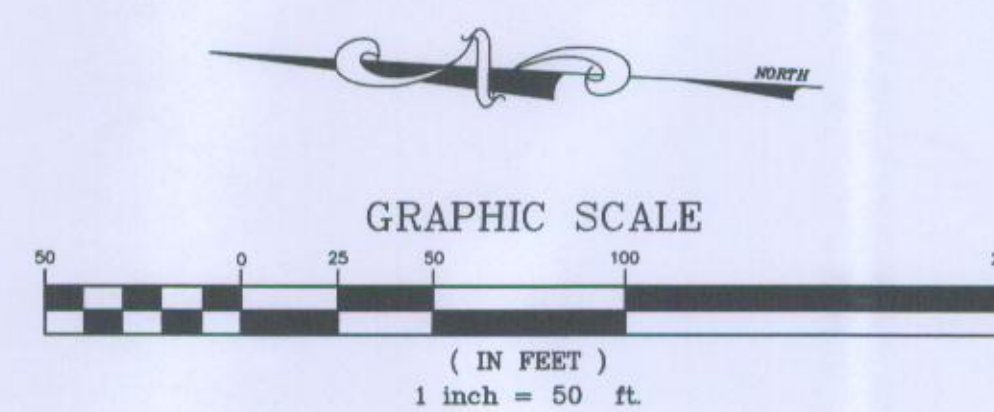

Tree Conservation Plan Approval			
01	APPROVED BY	DATE	REASON FOR REVISION
02	DRD #	SE-4734	ZRE Certification
03			
04			
05			
06			

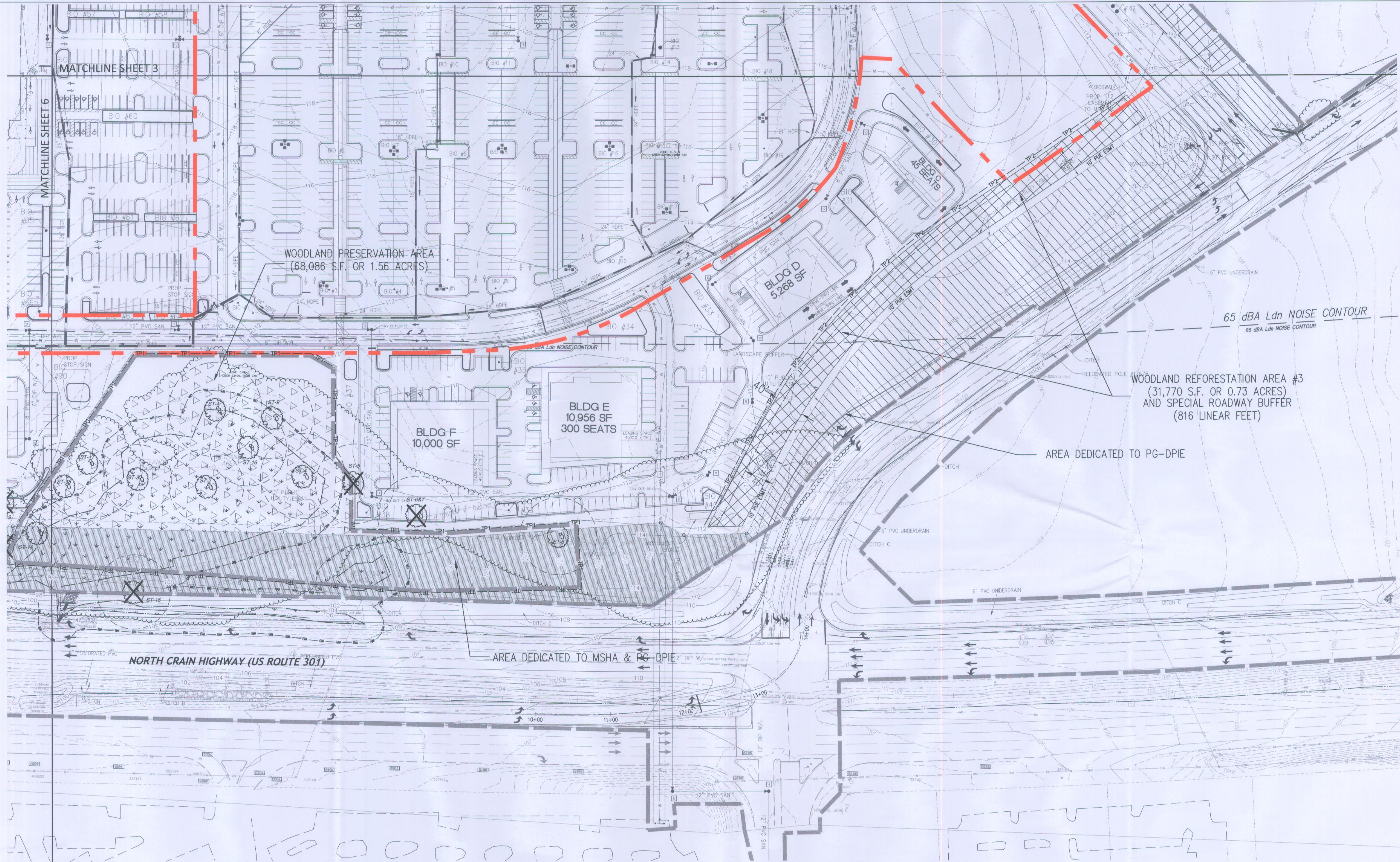

LEGEND

- | | | | | | | | | | |
|--|------------------------------|--|-----|--------------------------------|--|-------|---|--|--|
| | LIMITS OF SPECIAL EXCEPTION | | PMA | PRIMARY MANAGEMENT AREA | | ST-25 | SPECIMEN TREE TO BE REMOVED (W/ CRITICAL ROOT ZONE) | | AREA TO BE DEDICATED TO MSHA & PG-DPIE |
| | TP1 | | WB | 25' WETLAND BUFFER | | ST-25 | SPECIMEN TREE TO BE REMOVED (W/ CRITICAL ROOT ZONE) | | WOODLAND PRESERVATION AREA (NO CREDIT TAKEN WITHIN 100-YEAR FLOODPLAIN) |
| | TP2 | | SB | 75' STREAM BUFFER | | | AREA DEDICATED TO PG-DPIE | | WOODLAND REFORESTATION AND LANDSCAPE AREA (AREA TO BE PLANTED TO SATISFY BOTH WOODLAND CONSERVATION AND LANDSCAPE MANUAL REQUIREMENTS AND/OR CONDITIONS OF APPROVAL) |
| | EXISTING 100-YEAR FLOODPLAIN | | | EXISTING TREELINE | | | EXISTING WETLAND | | STEEP SLOPES (15% AND GREATER) |
| | 50' FLOODPLAIN BUFFER | | | PROPOSED LIMITS OF DISTURBANCE | | | | | |

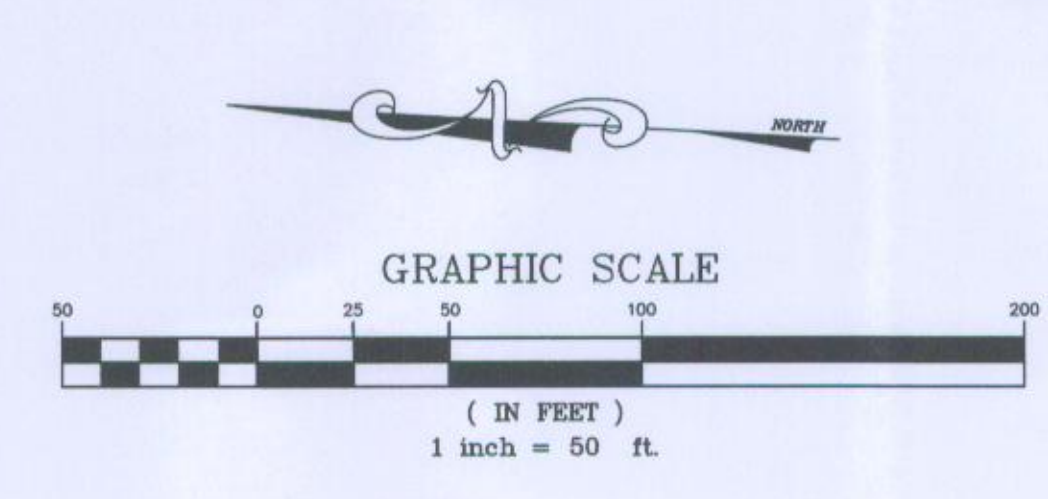

Tree Conservation Plan Approval			
Approved by	Date	DRD #	Reasons for Revision
<i>[Signature]</i>	11/11/15	SE-4734	ZBI: Certification
01			
02			
03			
04			
05			
06			

Bowman Consulting Group, Ltd.
9813 Gwynn Drive
Manassas, Virginia 20110
Phone: (703) 530-8083
Fax: (703) 530-8075
www.bowmanconsulting.com
© Bowman Consulting Group, Ltd.

DETAILED TCP II (2 OF 4)
MILL BRANCH CROSSING
PRINCE GEORGES COUNTY, MARYLAND

SE # 4734
DSP # 13034
PLAN NUMBER



PLAN STATUS
10/17/16 REV. PER COUNTY COMMENTS
03/23/17 REV. PER COUNTY COMMENTS

DATE	DESCRIPTION
	GDE
	DESIGN
	GDE
	DRAWN
	CHKD
	SCALE: H: 1"=50'
	V: 1"=50'
	JOB No. 4557-01-002
	DATE: 12/28/15
	FILE No. 4557-D-SE-001
	SHEET 4 OF 10

SE-4734

APR 11 2017

DETAILED TOP II (3 OF 4) MILL BRANCH CROSSING

PRINCE GEORGE'S COUNTY, MARYLAND

SE # 4734
DSP # 13034
PLAN NUMBER

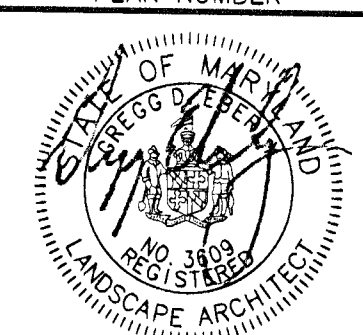

PLAN STATUS
10/17/16 REV. PER COUNTY COMMENTS
03/23/17 REV. PER COUNTY COMMENTS

DATE	DESCRIPTION
GDE	GDE
DESIGN	DRAWN
SCALE	CHKD
JOB No.	4557-01-002
DATE	12/28/15
FILE No.	4557-D-SE-001
SHEET	5 OF 10

APPROVED
- [Signature]
DATE: 1/13/17
SCALE OF 20' = 1" (1/4" = 1')

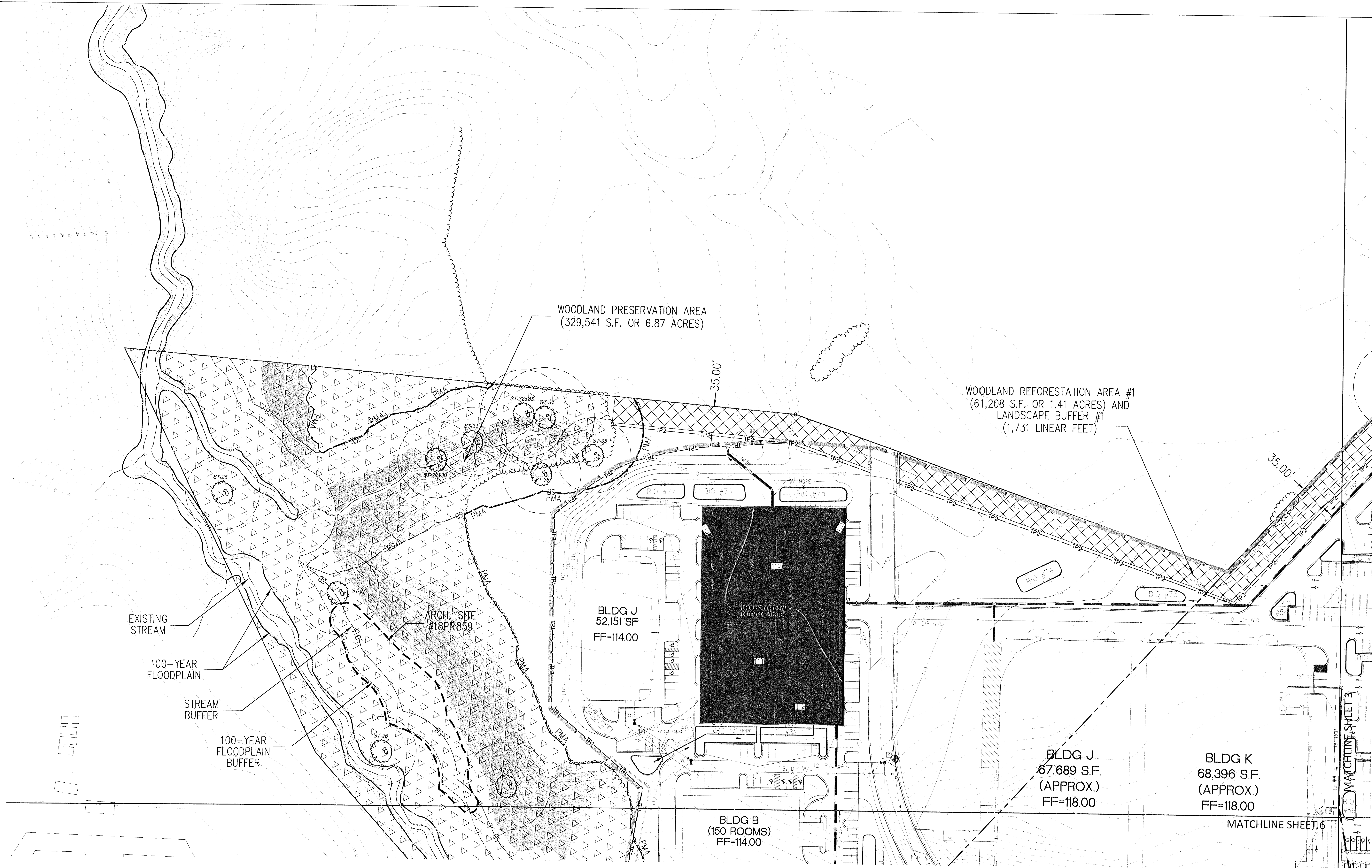

LEGEND

<p>LIMITS OF SPECIAL EXCEPTION</p> <p>TP1</p> <p>TP2</p> <p>EXISTING 100-YEAR FLOODPLAIN</p> <p>50' FLOODPLAIN BUFFER</p>	<p>PMA</p> <p>WB</p> <p>WB</p> <p>SB</p> <p>EXISTING TREELINE</p> <p>PROPOSED LIMITS OF DISTURBANCE</p>	<p>PRIMARY MANAGEMENT AREA</p> <p>25' WETLAND BUFFER</p> <p>EXISTING STREAM</p> <p>75' STREAM BUFFER</p> <p>EXISTING TREELINE</p> <p>PROPOSED LIMITS OF DISTURBANCE</p>
---	---	---

ST-25	SPECIMEN TREE TO BE PRESERVED (W/ CRITICAL ROOT ZONE)
ST-25	SPECIMEN TREE TO BE REMOVED (W/ CRITICAL ROOT ZONE)
	AREA DEDICATED TO PG-DPIE
	EXISTING WETLAND

	AREA TO BE DEDICATED TO MSHA & PG-DPIE
	WOODLAND PRESERVATION AREA (NO CREDIT TAKEN WITHIN 100-YEAR FLOODPLAIN)
	WOODLAND REFORESTATION AND LANDSCAPE AREA (AREA TO BE PLANTED TO SATISFY BOTH WOODLAND PRESERVATION AND LANDSCAPE MANUAL REQUIREMENTS AND/OR CONDITIONS OF APPROVAL)
	STEEP SLOPES (15% AND GREATER)

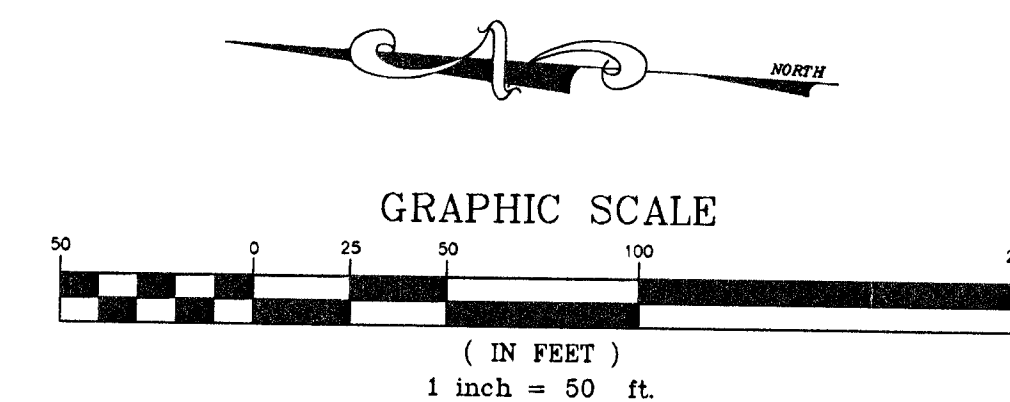

Prince George's County Planning Section, NSC-PSC
Environmental Planning Section
TREE CONSERVATION PLAN APPROVAL
ICPL-016-10

Approved by	Date	DRD #	Reason for Revision
[Signature]	12/28/15	SE-4734	ZHE Certification



LEGEND

- LIMITS OF SPECIAL EXCEPTION
- TP1 --- TEMPORARY TREE PROTECTION FENCE FOR WOODLAND PRESERVATION AREAS (SEE DETAILS #4 & #5 ON SHEET 8)
- TP2 --- PERMANENT TREE PROTECTION FENCE FOR REFORESTATION AREAS (SEE DETAIL #9 ON SHEET 8)
- EXISTING 100-YEAR FLOODPLAIN
- 50' FLOODPLAIN BUFFER
- PMA --- PRIMARY MANAGEMENT AREA
- WB --- 25' WETLAND BUFFER
- SB --- 75' STREAM BUFFER
- EXISTING STREAM
- EXISTING TREELINE
- PROPOSED LIMITS OF DISTURBANCE
- ST-25 (circle with cross) SPECIMEN TREE TO BE PRESERVED (W/ CRITICAL ROOT ZONE)
- ST-25 (circle with X) SPECIMEN TREE TO BE REMOVED (W/ CRITICAL ROOT ZONE)
- AREA DEDICATED TO PG-DPIE
- AREA DEDICATED TO PG-DPIE
- EXISTING WETLAND
- AREA TO BE DEDICATED TO MSHA & PG-DPIE
- WOODLAND PRESERVATION AREA (NO CREDIT TAKEN WITHIN 100-YEAR FLOODPLAIN)
- WOODLAND REFORESTATION AND LANDSCAPE AREA (AREA TO BE PLANTED TO SATISFY BOTH WOODLAND PRESERVATION AND LANDSCAPE MANUAL REQUIREMENTS AND/OR CONDITIONS OF APPROVAL)
- STEEP SLOPES (15% AND GREATER)

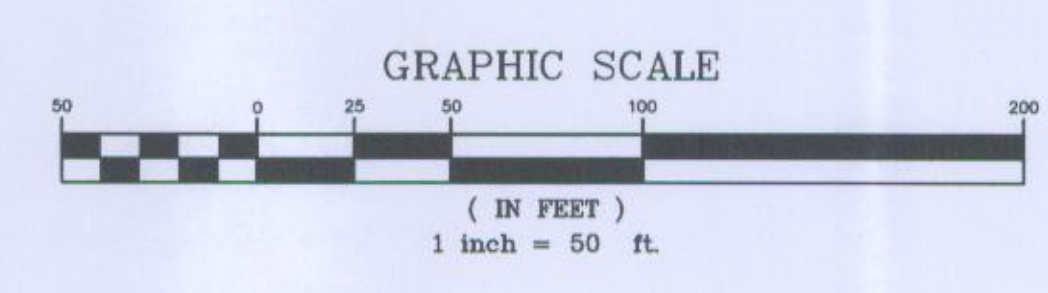

APPROVED			
DATE: 12/28/15			
FILE No. 4557-D-SE-001			
SHEET 6 OF 10			

Bowman
CONSULTING

Bowman Consulting Group, Ltd.
8611 Lee Avenue
Manassas, Virginia 20108
Phone: (703) 530-9803
Fax: (703) 530-8475
www.bowmanconsulting.com
© Bowman Consulting Group, Ltd.

DETAILED TCP II (4 OF 4)
MILL BRANCH CROSSING
PRINCE GEORGE'S COUNTY, MARYLAND

SE # 4734
DSP # 13034
PLAN NUMBER



PLAN STATUS
10/17/16 REV. PER COUNTY COMMENTS
03/23/17 REV. PER COUNTY COMMENTS

DATE	DESCRIPTION
00	DESIGN
01	DESIGN
02	DESIGN
03	DESIGN
04	DESIGN
05	DESIGN
06	DESIGN

GENERAL NOTES

1. THIS PLAN IS SUBMITTED TO FULFILL THE WOODLAND CONSERVATION REQUIREMENTS FOR SE--4734. IF SE--4734 EXPIRES, THEN THIS TOP2 ALSO EXPIRES AND IS NO LONGER VALID.
2. CUTTING OR CLEARING OF WOODLAND NOT IN CONFORMANCE WITH THIS PLAN OR WITHOUT THE EXPRESSED WRITTEN CONSENT OF THE DEPARTMENT OF PERMITS, INSPECTIONS AND ENFORCEMENT (DPIE) OR DESIGNEE SHALL BE SUBJECT TO A \$9.00 PER SQUARE FOOT MITIGATION FEE.
3. A PRE-CONSTRUCTION MEETING IS REQUIRED PRIOR TO THE ISSUANCE OF GRADING PERMITS. THE DEPARTMENT OF PERMITS, INSPECTIONS AND ENFORCEMENT (DPIE) SHALL BE CONTACTED PRIOR TO THE START OF ANY WORK ON THE SITE TO CONDUCT A PRE-CONSTRUCTION MEETING WHERE IMPLEMENTATION OF WOODLAND CONSERVATION MEASURES SHOWN ON THIS PLAN WILL BE DISCUSSED IN DETAIL.
4. THE DEVELOPER OR BUILDER OF THE LOTS OR PARCELS SHOWN ON THIS PLAN SHALL NOTIFY FUTURE BUYERS OF ANY WOODLAND CONSERVATION AREAS THROUGH THE PROVISION OF A COPY OF THIS PLAN AT TIME OF CONTRACT SIGNING. FUTURE PROPERTY OWNERS ARE ALSO SUBJECT TO THIS REQUIREMENT.
5. THE OWNERS OF THE PROPERTY SUBJECT TO THIS TREE CONSERVATION PLAN ARE SOLELY RESPONSIBLE FOR CONFORMANCE TO THE REQUIREMENTS CONTAINED HEREIN.
6. THE PROPERTY IS WITHIN THE DEVELOPING TIER AND IS ZONED C-S-C.
7. THE PROPERTY IS ADJACENT TO MILL BRANCH ROAD, A DESIGNATED HISTORIC ROAD IN THE VICINITY OF THE PROPERTY. THE HISTORIC ROAD LIMITS ARE FROM US 301 TO QUEEN ANNE BRIDGE ROAD. ITS FUNCTIONAL CLASS IS LOCAL ACCORDING TO THE HS&D PLAN IN THE 1991 BOWME-COLLINGTON MASTER PLAN.
8. THE PROPERTY IS ADJACENT TO NORTH GRAM HIGHWAY/US ROUTE 301, A MASTER PLANNED FREEWAY.
9. THIS PLAN IS GRANDFATHERED UNDER CB-27-2010, SECTION 25-117 (G).

TREE PRESERVATION & RETENTION NOTES

10. ALL WOODLANDS DESIGNATED ON THIS PLAN FOR PRESERVATION ARE THE RESPONSIBILITY OF THE PROPERTY OWNER. THE WOODLAND AREAS SHALL REMAIN IN A NATURAL STATE. THIS INCLUDES THE CANOPY TREES AND UNDERSTORY VEGETATION. A REVISED TREE CONSERVATION PLAN IS REQUIRED PRIOR TO CLEARING WOODLAND AREAS THAT ARE NOT SPECIFICALLY IDENTIFIED TO BE CLEARED ON THE APPROVED TOP2.
11. TREE AND WOODLAND CONSERVATION METHODS SUCH AS ROOT PRUNING SHALL BE CONDUCTED AS NOTED ON THIS PLAN.
12. THE LOCATION OF ALL TEMPORARY TREE PROTECTION FENCING (TPF) SHOWN ON THIS PLAN SHALL BE FLAGGED OR STAKED IN THE FIELD PRIOR TO THE PRE-CONSTRUCTION MEETING. UPON APPROVAL OF THE LOCATIONS BY THE COUNTY INSPECTOR, INSTALLATION OF THE TPFs MAY BEGIN.
13. ALL TEMPORARY TREE PROTECTION FENCING REQUIRED BY THIS PLAN SHALL BE INSTALLED PRIOR TO COMMENCEMENT OF CLEARING AND GRADING OF THE SITE AND SHALL REMAIN IN PLACE UNTIL THE BOND IS RELEASED FOR THE PROJECT. FAILURE TO INSTALL AND MAINTAIN TEMPORARY OR PERMANENT TREE PROTECTIVE DEVICES IS A VIOLATION OF THIS TOP2.
14. WOODLAND PRESERVATION AREAS SHALL BE POSTED WITH SIGNAGE AS SHOWN ON THE PLANS AT THE SAME TIME AS THE TEMPORARY TPF INSTALLATION. THESE SIGNS MUST REMAIN IN PERPETUITY.

REMOVAL OF HAZARDOUS TREES OR LIMBS BY DEVELOPERS OR BUILDERS

15. THE DEVELOPER AND/OR BUILDER IS RESPONSIBLE FOR THE COMPLETE PRESERVATION OF ALL FORESTED AREAS SHOWN ON THE APPROVED PLAN TO REMAIN UNDISTURBED. ONLY TREES OR PARTS THEREOF DESIGNATED BY THE COUNTY AS DEAD, DYING, OR HAZARDOUS MAY BE REMOVED.
16. A TREE IS CONSIDERED HAZARDOUS IF A CONDITION IS PRESENT WHICH LEADS A CERTIFIED ARBORIST OR LICENSED TREE EXPERT TO BELIEVE THAT THE TREE OR A PORTION OF THE TREE HAS A POTENTIAL TO FALL AND STRIKE A STRUCTURE, PARKING AREA, OR OTHER HIGH USE AREA AND RESULT IN PERSONAL INJURY OR PROPERTY DAMAGE.
17. DURING THE INITIAL STAGES OF CLEARING AND GRADING, IF HAZARDOUS TREES ARE PRESENT, OR TREES ARE PRESENT THAT ARE NOT HAZARDOUS BUT ARE LEANING INTO THE DISTURBED AREA, THE PERMITEE SHALL REMOVE SAID TREES USING A CHAIN SAW. CORRECTIVE MEASURES REQUIRING THE REMOVAL OF THE HAZARDOUS TREE OR PORTIONS THEREOF SHALL REQUIRE AUTHORIZATION BY THE COUNTY INSPECTOR. ONLY AFTER APPROVAL BY THE INSPECTOR MAY THE TREE BE CUT BY CHAINSAW TO NEAR THE EXISTING GROUND LEVEL. THE STUMP SHALL NOT BE REMOVED OR COVERED WITH SOIL, MULCH OR OTHER MATERIALS THAT WOULD INHIBIT SPROUTING.
18. IF A TREE OR TREES BECOME HAZARDOUS PRIOR TO BOND RELEASE FOR THE PROJECT, DUE TO STORM EVENTS OR OTHER SITUATIONS NOT RESULTING FROM AN ACTION BY THE PERMITEE, PRIOR TO REMOVAL, A CERTIFIED ARBORIST OR A LICENSED TREE EXPERT MUST CERTIFY THAT THE TREE OR THE PORTION OF THE TREE IN QUESTION HAS A POTENTIAL TO FALL AND STRIKE A STRUCTURE, PARKING AREA, OR OTHER HIGH USE AREA AND MAY RESULT IN PERSONAL INJURY OR PROPERTY DAMAGE; IF A TREE OR PORTIONS THEREOF ARE IN IMMINENT DANGER OF STRIKING A STRUCTURE, PARKING AREA, OR OTHER HIGH USE AREA AND MAY RESULT IN PERSONAL INJURY OR PROPERTY DAMAGE THEN THE CERTIFICATION IS NOT REQUIRED AND THE PERMITEE SHALL TAKE CORRECTIVE ACTION IMMEDIATELY. THE CONDITION OF THE AREA SHALL BE FULLY DOCUMENTED THROUGH PHOTOGRAPHS PRIOR TO CORRECTIVE ACTION BEING TAKEN. THE PHOTOS SHALL BE SUBMITTED TO THE INSPECTOR FOR DOCUMENTATION OF THE DAMAGE.

IF CORRECTIVE PRUNING MAY ALLEVATE A HAZARDOUS CONDITION, THE CERTIFIED ARBORIST OR A LICENSED TREE EXPERT MAY PROCEED WITHOUT FURTHER AUTHORIZATION. THE PRUNING MUST BE DONE IN ACCORDANCE WITH THE LATEST EDITION OF THE APPROPRIATE ANSI A-300 PRUNING STANDARDS. THE CONDITION OF THE AREA SHALL BE FULLY DOCUMENTED THROUGH PHOTOGRAPHS PRIOR TO CORRECTIVE ACTION BEING TAKEN. THE PHOTOS SHALL BE SUBMITTED TO THE INSPECTOR FOR DOCUMENTATION OF THE DAMAGE.

DEBRIS FROM THE TREE REMOVAL OR PRUNING THAT OCCURS WITHIN 35 FEET OF THE WOODLAND EDGE MAY BE REMOVED AND PROPERLY DISPOSED OF BY RECYCLING, CHIPPING OR OTHER ACCEPTABLE METHODS. ALL DEBRIS THAT IS MORE THAN 35 FEET FROM THE WOODLAND EDGE SHALL BE CUT UP TO ALLOW CONTACT WITH THE GROUND, THIS ENCOURAGING DECOMPOSITION. THE SMALLER MATERIALS SHALL BE PLACED INTO BRUSH PILES THAT WILL SERVE AS WILDLIFE HABITAT.

TREE WORK TO BE COMPLETED WITHIN A ROAD RIGHT-OF-WAY REQUIRES A PERMIT FROM THE MARYLAND DEPARTMENT OF NATURAL RESOURCES UNLESS THE TREE REMOVAL IS SHOWN WITHIN THE APPROVED LIMITS OF DISTURBANCE ON A TOP2. THE WORK IS REQUIRED TO BE CONDUCTED BY A LICENSED TREE EXPERT.

19. WORK ON THIS PROJECT WILL BE INITIATED IN SEVERAL PHASES. ALL TEMPORARY TPFs REQUIRED FOR A GIVEN PHASE SHALL BE INSTALLED PRIOR TO ANY DISTURBANCE WITHIN THAT PHASE OF WORK.

AFFORESTATION & REFORESTATION NOTES

20. ALL AFFORESTATION AND REFORESTATION BONDS, BASED ON SQUARE FOOTAGE, SHALL BE POSTED WITH THE COUNTY PRIOR TO THE ISSUANCE OF ANY PERMITS. THESE BONDS WILL BE RETAINED AS SURETY UNTIL ALL REQUIRED ACTIVITIES HAVE BEEN SATISFIED OR THE REQUIRED TIMEFRAME FOR MAINTENANCE HAS PASSED, WHICHEVER IS LONGER.
21. THE PLANTING OF AFFORESTATION OR REFORESTATION AREAS SHALL BE COMPLETED IN PHASE WITH DEVELOPMENT. SEEDLING PLANTING IS TO OCCUR FROM NOVEMBER THROUGH MAY ONLY. NO PLANTING SHALL BE DONE WHILE GROUND IS FROZEN. PLANTING WITH LARGER CALIPER STOCK OR CONTAINERIZED STOCK MAY BE DONE AT ANY TIME PROVIDED A DETAILED MAINTENANCE SCHEDULE IS PROVIDED.
22. IF PLANTING CANNOT OCCUR DUE TO PLANTING CONDITIONS, THE DEVELOPER OR PROPERTY OWNER SHALL INSTALL THE FENCING AND SIGNAGE IN ACCORDANCE WITH THE APPROVED TYPE 2 TREE CONSERVATION PLAN. PLANTING SHALL THEN BE ACCOMPLISHED DURING THE NEXT PLANTING SEASON. IF PLANTING IS DELAYED BEYOND THE TRANSFER OF THE PROPERTY TITLE TO THE HOMEOWNER, THE DEVELOPER OR BUILDER SHALL OBTAIN A SIGNED STATEMENT FROM THE PURCHASER INDICATING THAT THEY UNDERSTAND THAT THE REFORESTATION AREA IS LOCATED ON THEIR PROPERTY AND THAT REFORESTATION WILL OCCUR DURING THE NEXT PLANTING SEASON. A COPY OF THAT DOCUMENT SHALL BE PRESENTED TO THE GRADING INSPECTOR AND THE COUNTY.
23. REFORESTATION AREAS SHALL NOT BE MOWED. THE MANAGEMENT OF COMPETING VEGETATION AROUND INDIVIDUAL TREES AND THE REMOVAL OF NOXIOUS, INVASIVE, AND NON-NATIVE VEGETATION WITHIN THE REFORESTATION AREAS IS ACCEPTABLE.
24. ALL REQUIRED TEMPORARY TREE PROTECTION FENCING SHALL BE INSTALLED PRIOR TO THE CLEARING AND GRADING OF THE SITE AND SHALL REMAIN IN PLACE UNTIL THE PERMANENT TREE PROTECTION FENCING IS INSTALLED WITH THE REQUIRED PLANTING. THE TEMPORARY FENCING IS NOT REQUIRED TO BE INSTALLED IF THE PERMANENT FENCING IS INSTALLED PRIOR TO CLEARING AND GRADING OF THE SITE. FAILURE TO INSTALL AND MAINTAIN TEMPORARY OR PERMANENT TREE PROTECTIVE FENCING IS A VIOLATION OF THIS TOP2.
25. AFFORESTATION/REFORESTATION AREAS SHALL BE POSTED WITH NOTIFICATION SIGNAGE, AS SHOWN ON THE PLANS, AT THE SAME TIME AS THE PERMANENT PROTECTION FENCING INSTALLATION. THESE SIGNS SHALL REMAIN IN PERPETUITY.
26. THE COUNTY INSPECTOR SHALL BE NOTIFIED PRIOR TO SOIL PREPARATION OR INITIATION OF ANY TREE PLANTING ON THIS SITE.
27. AT TIME OF ISSUANCE OF THE FIRST PERMIT, THE FOLLOWING INFORMATION SHALL BE SUBMITTED TO THE M-NCPPC PLANNING DEPARTMENT REGARDING THE CONTRACTOR RESPONSIBLE FOR IMPLEMENTATION OF THIS PLAN: CONTRACTOR NAME; BUSINESS NAME (IF DIFFERENT); ADDRESS; AND PHONE NUMBER. RESULTS OF ANNUAL SURVIVAL CHECKS FOR EACH OF THE REQUIRED FOUR YEARS AFTER TREE PLANTING SHALL BE REPORTED TO THE M-NCPPC PLANNING DEPARTMENT.
28. FAILURE TO ESTABLISH THE AFFORESTATION OR REFORESTATION WITHIN THE PRESCRIBED TIME FRAME WILL RESULT IN THE FORFEITURE OF THE REFORESTATION BOND AND/OR A VIOLATION OF THIS PLAN INCLUDING THE ASSOCIATED \$9.00 PER SQUARE FOOT PENALTY UNLESS THE COUNTY INSPECTOR APPROVES A WRITTEN EXTENSION.

PLANTING SPECIFICATION NOTES

29. QUANTITY: THE REQUIRED SITE STOCKING RATE IS 1,000 SEEDLING EQUIVALENTS PER ACRE, AS DEMONSTRATED BY THE PLANT SIZE AND QUANTITIES FOR DESIGNATED AFFORESTATION/REFORESTATION AREAS SHOWN IN THE PLANT SCHEDULE.
30. TYPE: (SEE PLANT SCHEDULE)
31. PLANT QUALITY STANDARDS: THE PLANTS SELECTED SHALL BE HEALTHY AND STURDY REPRESENTATIVES OF THEIR SPECIES. SEEDLINGS SHALL HAVE A MINIMUM TOP GROWTH OF 18". THE DIAMETER OF THE ROOT COLLAR (THE PART OF THE ROOT JUST BELOW GROUND LEVEL) SHALL BE AT LEAST 3/8". THE ROOTS SHALL BE WELL DEVELOPED AND AT LEAST 8" LONG, NO MORE THAN TWENTY-FIVE PERCENT (25%) OF THE ROOT SYSTEM (BOTH PRIMARY AND AUXILIARY/FIBROUS ROOTS SHALL BE PRESENT).
- PLANTS THAT DO NOT HAVE AN ABUNDANCE OF WELL DEVELOPED TERMINAL BUDS ON THE LEADERS AND BRANCHES SHALL BE REJECTED. PLANTS SHALL BE SHIPPED BY THE NURSERY IMMEDIATELY AFTER LIFTING FROM THE FIELD OR REMOVAL FROM THE GREEN HOUSE, AND PLANTED IMMEDIATELY UPON RECEIPT BY THE LANDSCAPE CONTRACTOR.
- IF THE PLANTS CANNOT BE PLANTED IMMEDIATELY AFTER DELIVERY TO THE REFORESTATION SITE, THEY SHALL BE STORED IN THE SHADE WITH THEIR ROOT MASSES PROTECTED FROM DIRECT EXPOSURE TO SUN AND WIND BY THE USE OF STRAW, PEAT MOSS, COMPOST, OR OTHER SUITABLE MATERIAL AND SHALL BE MAINTAINED THROUGH PERIODIC WATERING, UNTIL THE TIME OF PLANTING.
32. PLANT HANDLING: THE QUANTITY OF SEEDLINGS TAKEN TO THE FIELD SHALL NOT EXCEED THE QUANTITY THAT CAN BE PLANTED IN A DAY. SEEDLINGS, ONCE REMOVED FROM THE NURSERY OR TEMPORARY STORAGE AREA SHALL BE PLANTED IMMEDIATELY.
33. TIMING OF PLANTING: THE BEST TIME TO PLANT SEEDLINGS IS WHILE THEY ARE DORMANT, PRIOR TO SPRING BUDDING. THE MOST SUITABLE MONTHS FOR PLANTING ARE MARCH AND APRIL, WHEN THE SOIL IS MOIST, BUT MAY BE PLANTED FROM MARCH THROUGH NOVEMBER. NO PLANTING SHALL BE DONE WHILE GROUND IS FROZEN. PLANTING SHALL OCCUR WITHIN ONE GROWING SEASON OF THE ISSUANCE OF GRADING/BUILDING PERMITS AND/OR REACHING THE FINAL GRADES AND STABILIZATION OF PLANTING AREAS.
34. SEEDLING PLANTING: TREE SEEDLINGS SHALL BE HAND PLANTED USING A DIBBLE BAR OR SHARP-SHOOTER SHOVEL. IT IS IMPORTANT THAT THE SEEDLING BE PLACED IN THE HOLE SO THAT THE ROOTS CAN SPREAD OUT NATURALLY; THEY SHOULD NOT BE TWISTED, BALLED UP OR BENT. MOST SOIL SHOULD THEN BE PACKED FIRMLY AROUND THE ROOTS. SEEDLINGS SHOULD BE PLANTED AT A DEPTH WHERE THEIR ROOTS LIE JUST BELOW THE GROUND SURFACE. AIR POCKETS SHOULD NOT BE LEFT AFTER CLOSING THE HOLE WHICH WOULD ALLOW THE ROOTS TO DRY OUT. SEE PLANTING DETAILS FOR FURTHER EXPLANATION. IF THE CONTRACTOR WISHES TO PLANT BY ANOTHER METHOD, THE PREPARER OF THIS TREE CONSERVATION PLAN MUST BE CONTACTED AND GIVE HIS APPROVAL BEFORE PLANTING MAY BEGIN.
35. SPACING: SEE PLANT SCHEDULE AND/OR PLANTING PLAN FOR SPACING REQUIREMENTS. ALSO REFER TO THE PLANTING LAYOUT DETAIL FOR A DESCRIPTION OF THE GENERAL PLANTING THEORY.
36. SOIL: UPON THE COMPLETION OF ALL GRADING OPERATIONS, A SOIL TEST SHALL BE CONDUCTED TO DETERMINE WHAT SOIL PREPARATION AND SOIL AMENDMENTS, IF ANY, ARE NECESSARY TO CREATE GOOD TREE GROWING CONDITIONS. SOIL SAMPLES SHALL BE TAKEN AT A RATE THAT PROVIDES ONE SOIL SAMPLE FOR EACH AREA THAT APPEARS TO HAVE A DIFFERENT SOIL TYPE (IF THE ENTIRE AREA APPEARS UNIFORM, THEN ONLY ONE SAMPLE IS NECESSARY), AND SUBMITTED FOR TESTING TO A PRIVATE COMPANY. THE COMPANY OF CHOICE SHALL MAKE RECOMMENDATIONS FOR IMPROVING THE EXISTING SOIL. THE SOIL WILL BE TESTED AND RECOMMENDED FOR CORRECTIONS OF SOIL TEXTURE, PH, MAGNESIUM, PHOSPHORUS, POTASSIUM, CALCIUM AND ORGANIC MATTER.
37. SOIL IMPROVEMENT MEASURES: THE SOIL SHALL THEN BE IMPROVED ACCORDING TO THE RECOMMENDATIONS MADE BY THE TESTING COMPANY.
38. FENCING AND SIGNAGE: FINAL PROTECTIVE FENCING SHALL BE PLACED ON THE VISIBLE AND/OR DEVELOPMENT SIDE OF PLANTING AREAS. THE FINAL PROTECTIVE FENCE SHALL BE INSTALLED UPON COMPLETION OF PLANTING OPERATIONS UNLESS IT WAS INSTALLED DURING THE INITIAL STAGES OF DEVELOPMENT. SIGNS SHALL BE POSTED PER THE SIGNAGE DETAIL ON THIS SHEET.
39. PLANTING METHOD: CONSULT THE PLANTING DETAIL(S) SHOWN ON THIS PLAN.
40. MULCHING: APPLY TWO-INCH THICK LAYER OF WOODCHIP OR SHREDDED HARDWOOD MULCH (AS NOTED) TO EACH PLANTING SITE (SEE DETAIL SHOWN ON THIS PLAN).
41. GROUND COVER ESTABLISHMENT: THE REMAINING DISTURBED AREA BETWEEN SEEDLING PLANTING SITES SHALL BE SEEDED AND STABILIZED WITH WHITE CLOVER SEED AT THE RATE OF 5 LBS/ACRE.
42. MOWING: NO MOWING SHALL BE ALLOWED IN ANY PLANTING AREA.
43. SURVIVAL CHECK FOR BOND RELEASE: THE SEEDLING PLANTING IS TO BE CHECKED AT THE END OF EACH YEAR FOR FOUR YEARS TO ASSURE THAT NO LESS THAN 75% OF THE ORIGINAL PLANTED QUANTITY SURVIVES. IF THE MINIMUM NUMBER HAS NOT BEEN PROVIDED THE AREA MUST BE SUPPLEMENTED WITH ADDITIONAL SEEDLINGS TO REACH THE REQUIRED NUMBER AT TIME OF PLANTING.
44. SOURCE OF SEEDLINGS: STATE NAME, ADDRESS, AND PHONE NUMBER OF NURSERY OR SUPPLIER

4-YEAR MANAGEMENT PLAN FOR AFFORESTATION/REFORESTATION AREAS

- YEAR 1: SITE PREPARATION AND TREE PLANTING
SURVIVAL CHECK ONCE ANNUALLY (SEPTEMBER-NOVEMBER) (SEE NOTE 1)
WATERING IS NEEDED (2 X MONTH)
CONTROL OF UNDESIRABLE VEGETATION AS NEEDED (1 X IN JUNE AND 1 X IN SEPTEMBER MIN.)
- YEAR 2-3: REINFORCEMENT PLANTING IS NEEDED (SEE NOTE 2)
SURVIVAL CHECK ONCE ANNUALLY (SEPTEMBER-NOVEMBER)
CONTROL OF UNDESIRABLE VEGETATION IF NEEDED (1 X IN MAY AND 1 X IN AUGUST MIN.)
- YEAR 4: REINFORCEMENT PLANTING IF NEEDED. (SEE NOTE 2)
SURVIVAL CHECK (SEPTEMBER-NOVEMBER)
1. SURVIVAL CHECK: CHECK PLANTED STOCK AGAINST PLANT LIST (OR AS-BUILT) BY WALKING THE SITE AND TAKING INVENTORY. PLANTS MUST SHOW VITALITY. SUBMIT FIELD DATA FORM (CONDITION CHECK SHEETS) TO OWNER AFTER EACH INSPECTION. REMOVE ALL DEAD PLANTS.
2. REINFORCEMENT PLANTING: REPLACE DEAD OR MISSING PLANTS IN SUFFICIENT QUANTITY TO BRING THE TOTAL NUMBER OF LIVE PLANTS TO AT LEAST 75% OF THE NUMBER ORIGINALLY PLANTED. IF A PARTICULAR SPECIES SUFFERS UNUSUALLY HIGH MORTALITY, REPLACE WITH AN ALTERNATIVE PLANT TYPE.
3. MISCELLANEOUS: FERTILIZATION OR WATERING DURING YEARS 1 THROUGH 3 WILL BE DONE ON AN AS NEEDED BASIS. SPECIAL RETURN OPERATIONS OR RECOMMENDATIONS WILL BE CONDUCTED ON AN AS NEEDED BASIS.

POST DEVELOPMENT NOTES

WHEN WOODLANDS AND/OR SPECIMEN, HISTORIC OR CHAMPION TREES ARE TO REMAIN:

53. IF THE DEVELOPER OR BUILDER NO LONGER HAS AN INTEREST IN THE PROPERTY AND THE NEW OWNER DESIRES TO REMOVE A HAZARDOUS TREE OR PORTION THEREOF, THE NEW OWNER SHALL OBTAIN A WRITTEN STATEMENT FROM A CERTIFIED ARBORIST OR LICENSED TREE EXPERT IDENTIFYING THE HAZARDOUS CONDITION AND THE PROPOSED CORRECTIVE MEASURES PRIOR TO HAVING THE WORK CONDUCTED. AFTER PROPER DOCUMENTATION HAS BEEN COMPLETED PER THE HANDOUT GUIDANCE FOR PRINCE GEORGE'S COUNTY PROPERTY OWNERS, PRESERVATION OF WOODLAND CONSERVATION AREAS; THE ARBORIST OR TREE EXPERT MAY THEN REMOVE THE TREE. THE STUMP SHALL BE CUT AS CLOSE TO THE GROUND AS POSSIBLE AND LEFT IN PLACE. THE REMOVAL OR GRINDING OF THE STUMPS IN THE WOODLAND CONSERVATION AREA IS NOT PERMITTED.

IF A TREE OR PORTIONS THEREOF ARE IN IMMINENT DANGER OF STRIKING A STRUCTURE, PARKING AREA, OR OTHER HIGH USE AREA AND MAY RESULT IN PERSONAL INJURY OR PROPERTY DAMAGE, THEN THE CERTIFICATION IS NOT REQUIRED AND THE PERMITEE SHALL TAKE CORRECTIVE ACTION IMMEDIATELY. THE CONDITION OF THE AREA SHALL BE FULLY DOCUMENTED THROUGH PHOTOGRAPHS PRIOR TO CORRECTIVE ACTION BEING TAKEN. THE PHOTOS SHALL BE SUBMITTED TO THE INSPECTOR FOR DOCUMENTATION OF THE DAMAGE.

TREE WORK TO BE COMPLETED WITHIN A ROAD RIGHT-OF-WAY REQUIRES A PERMIT FROM THE MARYLAND DEPARTMENT OF NATURAL RESOURCES UNLESS THE TREE REMOVAL IS SHOWN WITHIN THE APPROVED LIMITS OF DISTURBANCE ON A TOP2. THE WORK IS REQUIRED TO BE CONDUCTED BY A LICENSED TREE EXPERT.

54. THE REMOVAL OF NOXIOUS, INVASIVE, AND NON-NATIVE PLANT SPECIES FROM ANY WOODLAND PRESERVATION AREA SHALL BE DONE WITH THE USE OF HAND-HELD EQUIPMENT ONLY (PRUNERS OR A CHAIN SAW). THESE PLANTS MAY BE CUT NEAR THE GROUND AND MATERIAL LESS THAN TWO INCHES DIAMETER MAY BE REMOVED FROM THE AREA AND DISPOSED OF APPROPRIATELY. ALL MATERIAL FROM THESE NOXIOUS, INVASIVE, AND NON-NATIVE PLANTS GREATER THAN TWO (2) INCHES DIAMETER SHALL BE CUT TO ALLOW CONTACT WITH THE GROUND, THUS ENCOURAGING DECOMPOSITION.

55. THE USE OF BROADCAST SPRAYING OF HERBICIDES IS NOT PERMITTED. HOWEVER, THE USE OF HERBICIDES TO DISCOURAGE RE-SPROUTING OF INVASIVE, NOXIOUS, OR NON-NATIVE PLANTS IS PERMITTED IF DONE AS AN APPLICATION OF THE CHEMICAL DIRECTLY TO THE CUT STUMP IMMEDIATELY FOLLOWING CUTTING OF PLANT TOPS. THE USE OF ANY HERBICIDE SHALL BE DONE IN ACCORDANCE WITH THE LABEL INSTRUCTIONS.

56. THE USE OF CHAINSAWS IS EXTREMELY DANGEROUS AND SHOULD NOT BE CONDUCTED WITH POORLY MAINTAINED EQUIPMENT, WITHOUT SAFETY EQUIPMENT, OR BY INDIVIDUALS NOT TRAINED IN THE USE OF THIS EQUIPMENT FOR THE PRUNING AND/OR CUTTING OF TREES.

TREE CONSERVATION NOTES

MILL BRANCH CROSSING

PRINCE GEORGE'S COUNTY, MARYLAND

SE # 4734
DSP # 13034
PLAN NUMBER

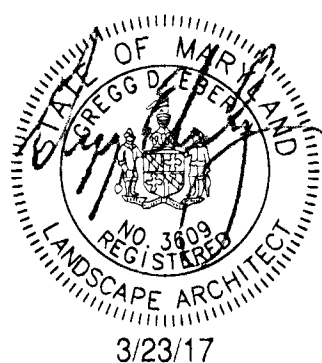

PLAN STATUS
10/17/16 REV. PER COUNTY COMMENTS
03/23/17 REV. PER COUNTY COMMENTS

DATE DESCRIPTION
GDE GDE GDE
DESIGN DRAWN CHKD
SCALE H: NO SCALE
V:
JOB No. 4557-01-002
DATE : 12/28/15
FILE No. 4557-D-SE-001

SHEET 7 OF 10

Prince George's County Planning Department, M-NCPPC Landscape Planning Section TREE CONSERVATION PLAN - ORIGINAL FORM 016-10			
Approved by	Date	DSD #	Reason for Revision
01 <i>[Signature]</i>	9/27/17	SE-4734	ZHE Certification
02			
03			
04			
05			
06			

RECEIVED

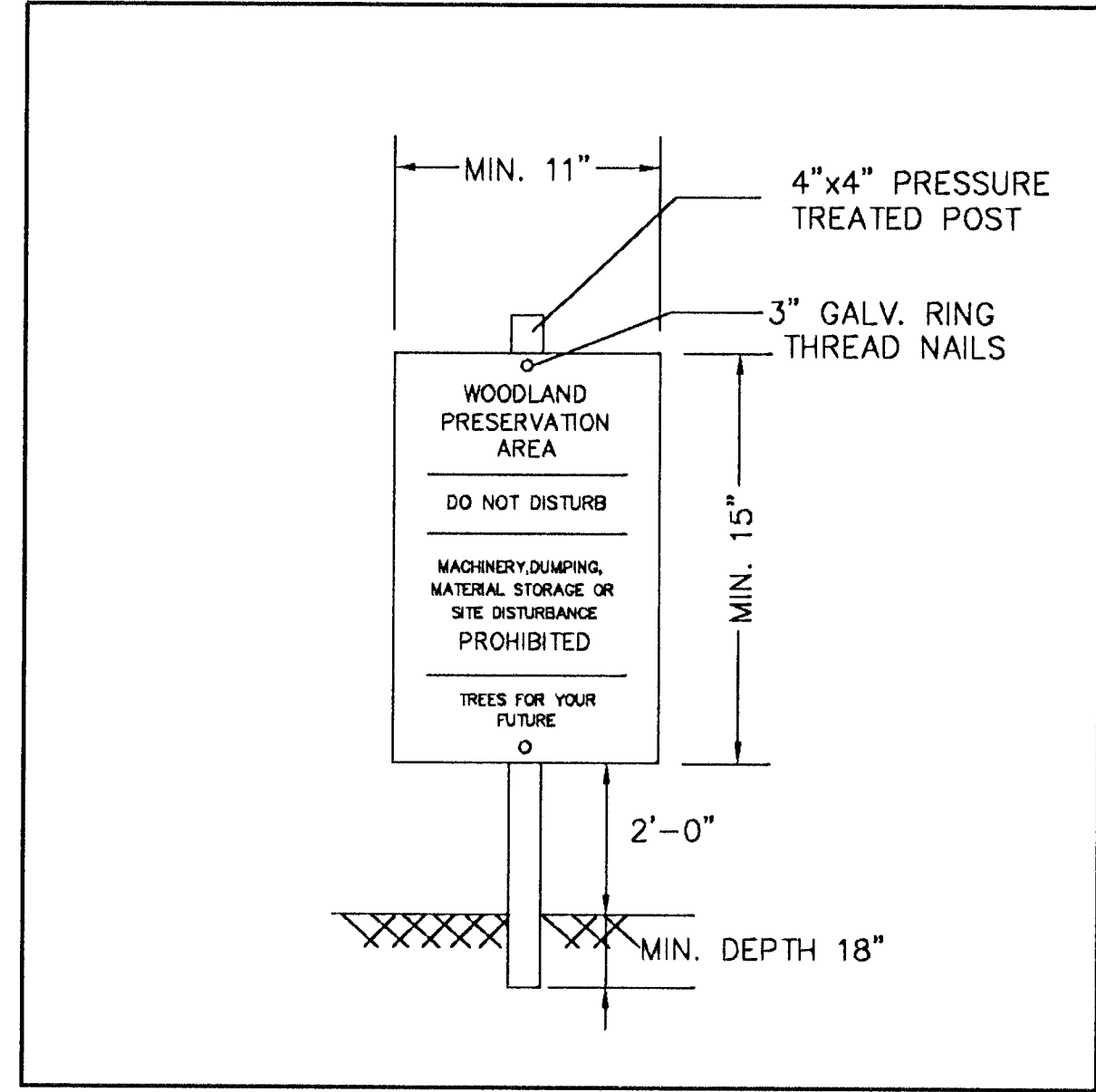

- NOTES:
1. ATTACHMENT OF SIGNS TO TREES IS PROHIBITED.
 2. SIGNS SHOULD BE PROPERLY MAINTAINED.
 3. AVOID INJURY TO ROOTS WHEN PLACING POSTS FOR THE SIGNS.
 4. SIGNS SHOULD BE POSTED TO BE VISIBLE TO ALL CONSTRUCTION PERSONNEL FROM ALL DIRECTIONS.
 5. SIGNS SHOULD BE INSTALLED AT SAME TIME AS TREE PROTECTION DEVICE.
 6. LOCATE SIGNS APPROXIMATELY EVERY 50 FEET ALONG FENCING.
 7. SIGNS SHOULD BE IN PLACE IMMEDIATELY FOLLOWING STAKE OUT OF L.O.D., AND REMAIN IN PLACE IN PERPETUITY.

WOODLAND PRESERVATION AREA SIGN

August 2010

A-4, DET-1

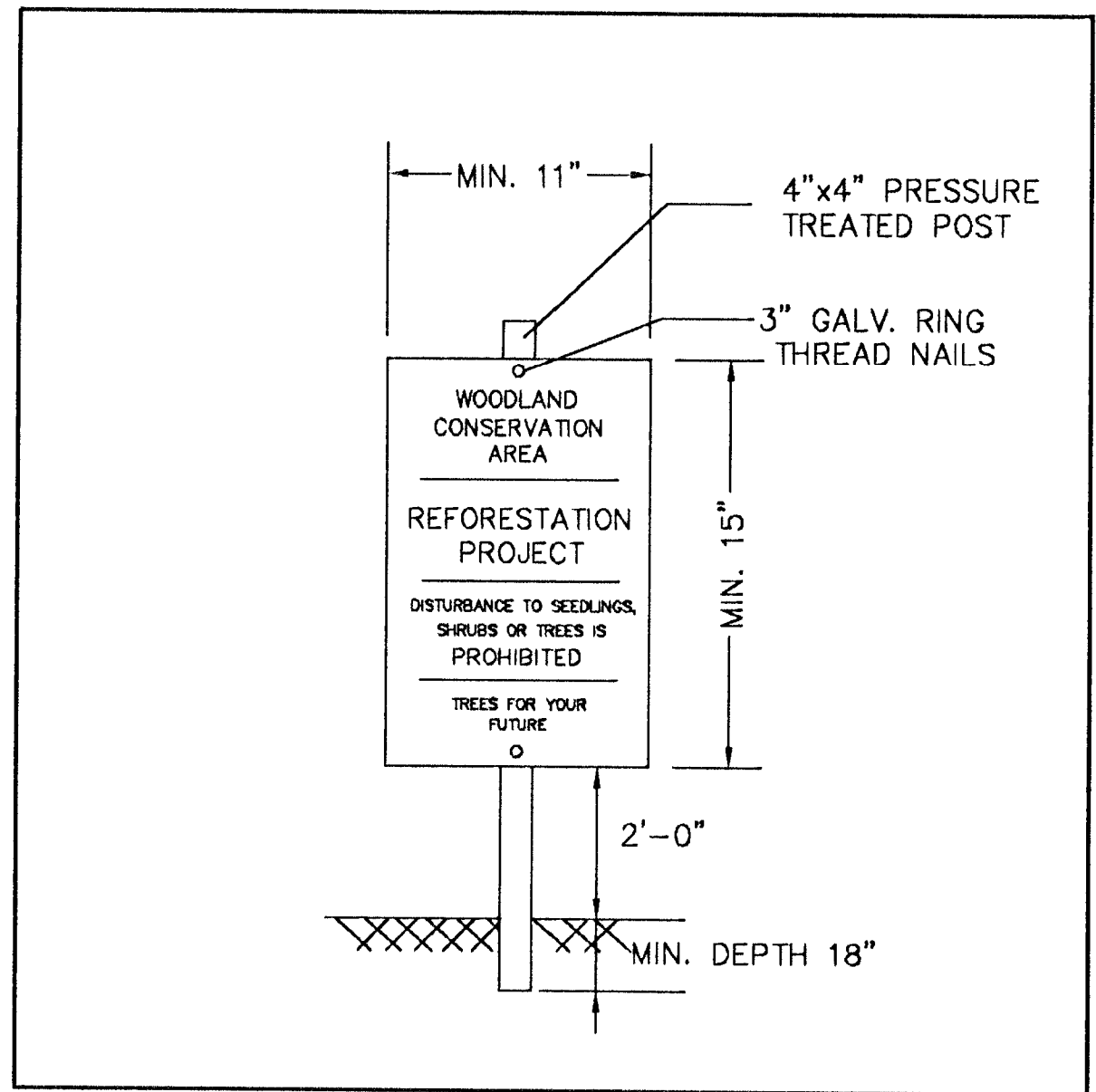

- NOTES:
1. ATTACHMENT OF SIGNS TO TREES IS PROHIBITED.
 2. SIGNS SHOULD BE PROPERLY MAINTAINED.
 3. AVOID INJURY TO ROOTS WHEN PLACING POSTS FOR THE SIGNS.
 4. SIGNS SHOULD BE POSTED TO BE VISIBLE TO ALL CONSTRUCTION PERSONNEL FROM ALL DIRECTIONS.
 5. SIGNS SHOULD BE INSTALLED AT SAME TIME AS TREE PROTECTION DEVICE.
 6. LOCATE SIGNS APPROXIMATELY EVERY 50 FEET ALONG FENCING.
 7. SIGNS SHOULD BE IN PLACE IMMEDIATELY FOLLOWING STAKE OUT OF L.O.D., AND REMAIN IN PLACE IN PERPETUITY.

REFORESTATION AREA SIGN

August 2010

A-4, DET-2

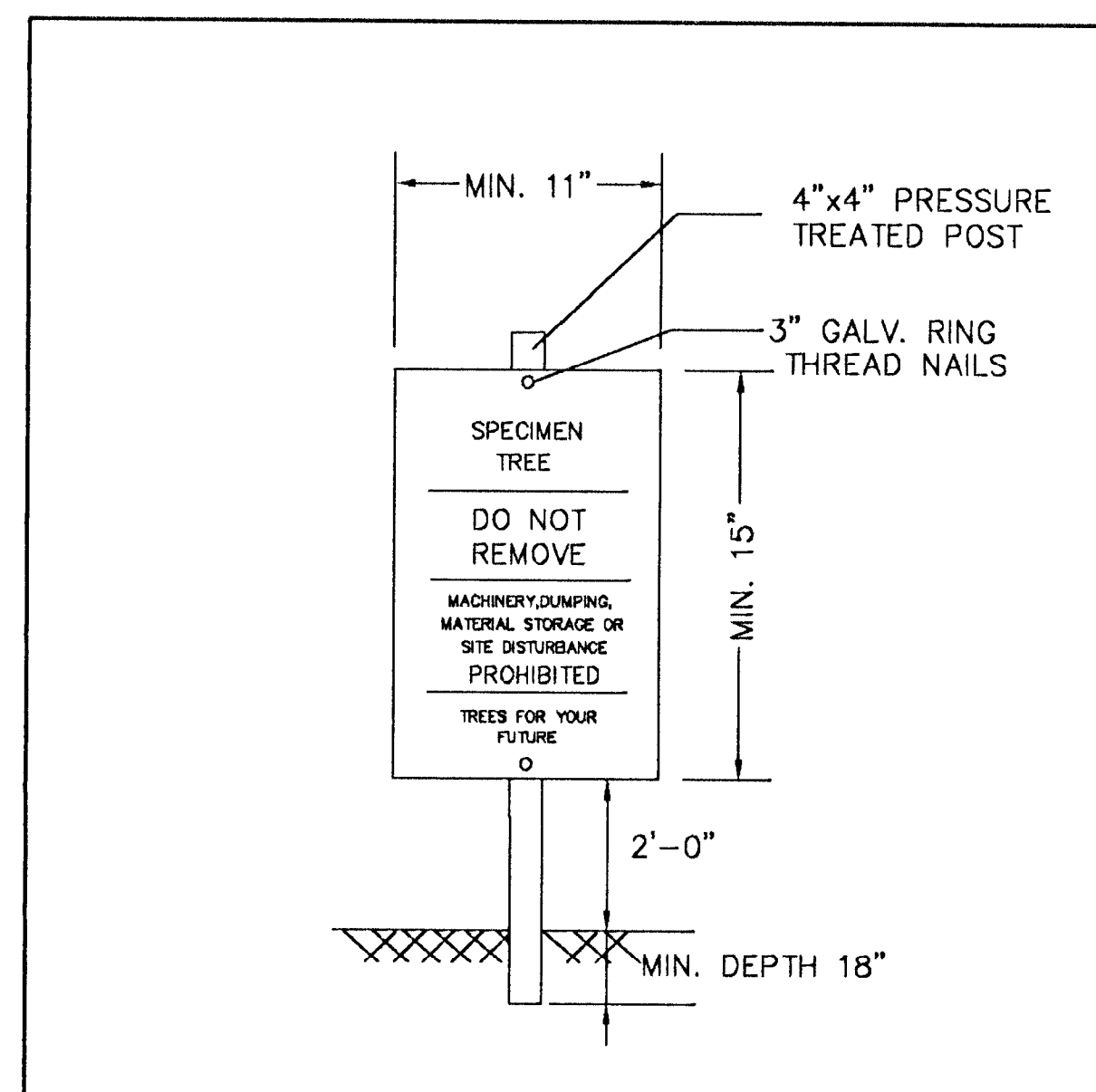

- NOTES:
1. ATTACHMENT OF SIGNS TO TREES IS PROHIBITED.
 2. SIGNS SHOULD BE PROPERLY MAINTAINED.
 3. AVOID INJURY TO ROOTS WHEN PLACING POSTS FOR THE SIGNS.
 4. SIGNS SHOULD BE POSTED TO BE VISIBLE TO ALL CONSTRUCTION PERSONNEL FROM ALL DIRECTIONS.
 5. SIGNS SHOULD BE INSTALLED AT SAME TIME AS TREE PROTECTION DEVICE.
 6. LOCATE SIGNS APPROXIMATELY EVERY 50 FEET ALONG FENCING.
 7. SIGNS SHOULD BE IN PLACE IMMEDIATELY FOLLOWING STAKE OUT OF L.O.D., AND REMAIN IN PLACE IN PERPETUITY.

SPECIMEN TREE SIGN

August 2010

A-4, DET-3

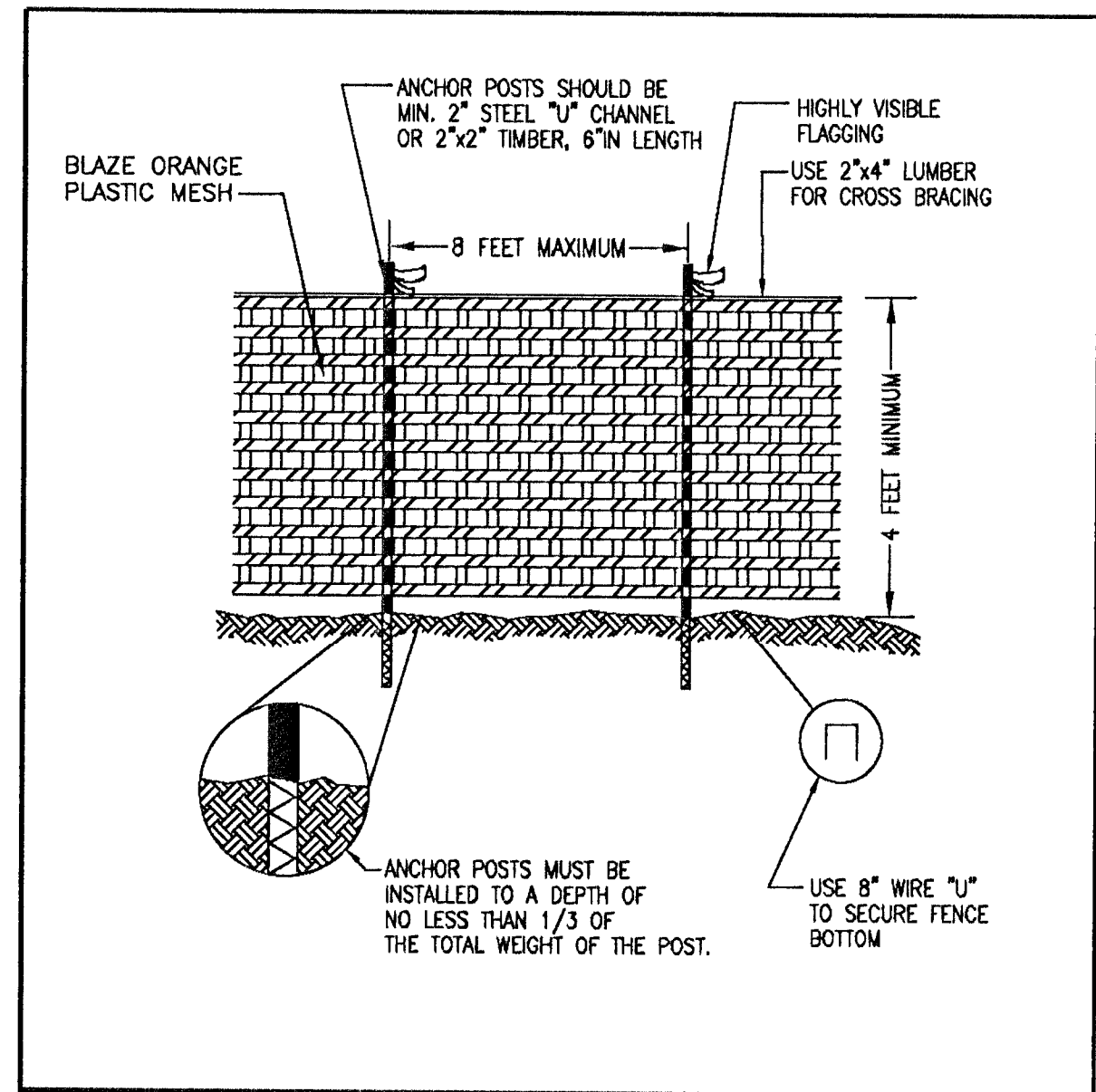

NOTES: (MUST BE INCLUDED WITH DETAIL)

1. FOREST PROTECTION DEVICE ONLY.
2. RETENTION AREA WILL BE SET AS PART OF THE REVIEW PROCESS.
3. BOUNDARIES OF RETENTION AREA SHOULD BE STAKED AND FLAGGED PRIOR TO INSTALLING DEVICES.
4. AVOID ROOT DAMAGE WHEN PLACING ANCHOR POSTS.
5. DEVICE SHOULD BE PROPERLY MAINTAINED DURING CONSTRUCTION.
6. PROTECTIVE SIGNAGE IS ALSO REQUIRED.

TYPE 1 (TEMPORARY) TREE PROTECTION FENCE DETAIL FOR WOODLAND PRESERVATION AREAS

August 2010

A-4, DET-4

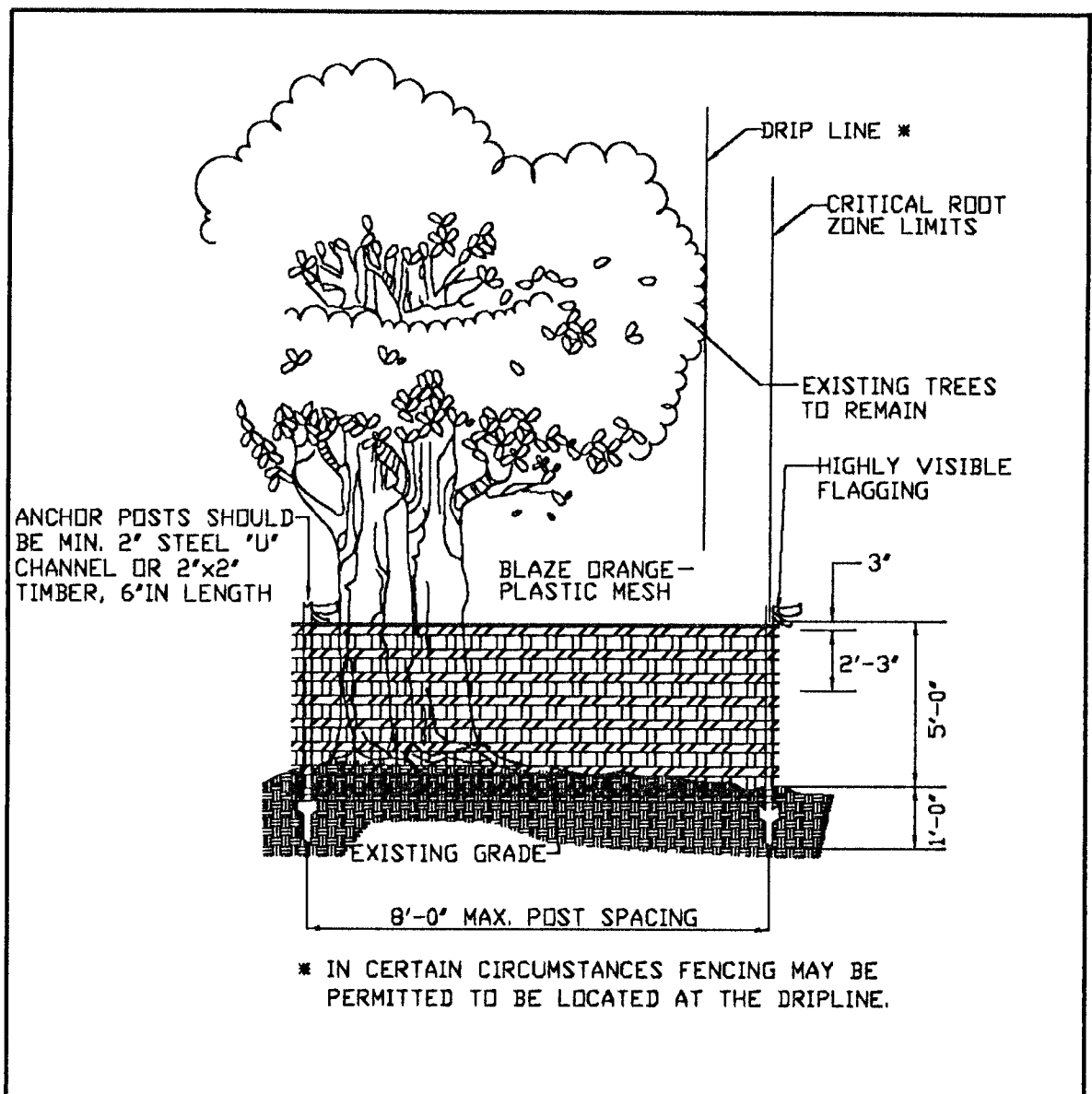

NOTES: (MUST BE INCLUDED WITH DETAIL)

1. FOREST PROTECTION DEVICE ONLY.
2. RETENTION AREA WILL BE SET AS PART OF THE REVIEW PROCESS.
3. BOUNDARIES OF RETENTION AREA SHOULD BE STAKED AND FLAGGED PRIOR TO INSTALLING DEVICES.
4. AVOID ROOT DAMAGE WHEN PLACING ANCHOR POSTS.
5. DEVICE SHOULD BE PROPERLY MAINTAINED DURING CONSTRUCTION.
6. PROTECTIVE SIGNAGE IS ALSO REQUIRED.

TEMPORARY FENCE PROTECTION DETAIL FOR WOODLAND PRESERVATION AREAS

August 2010

A-4, DET-5

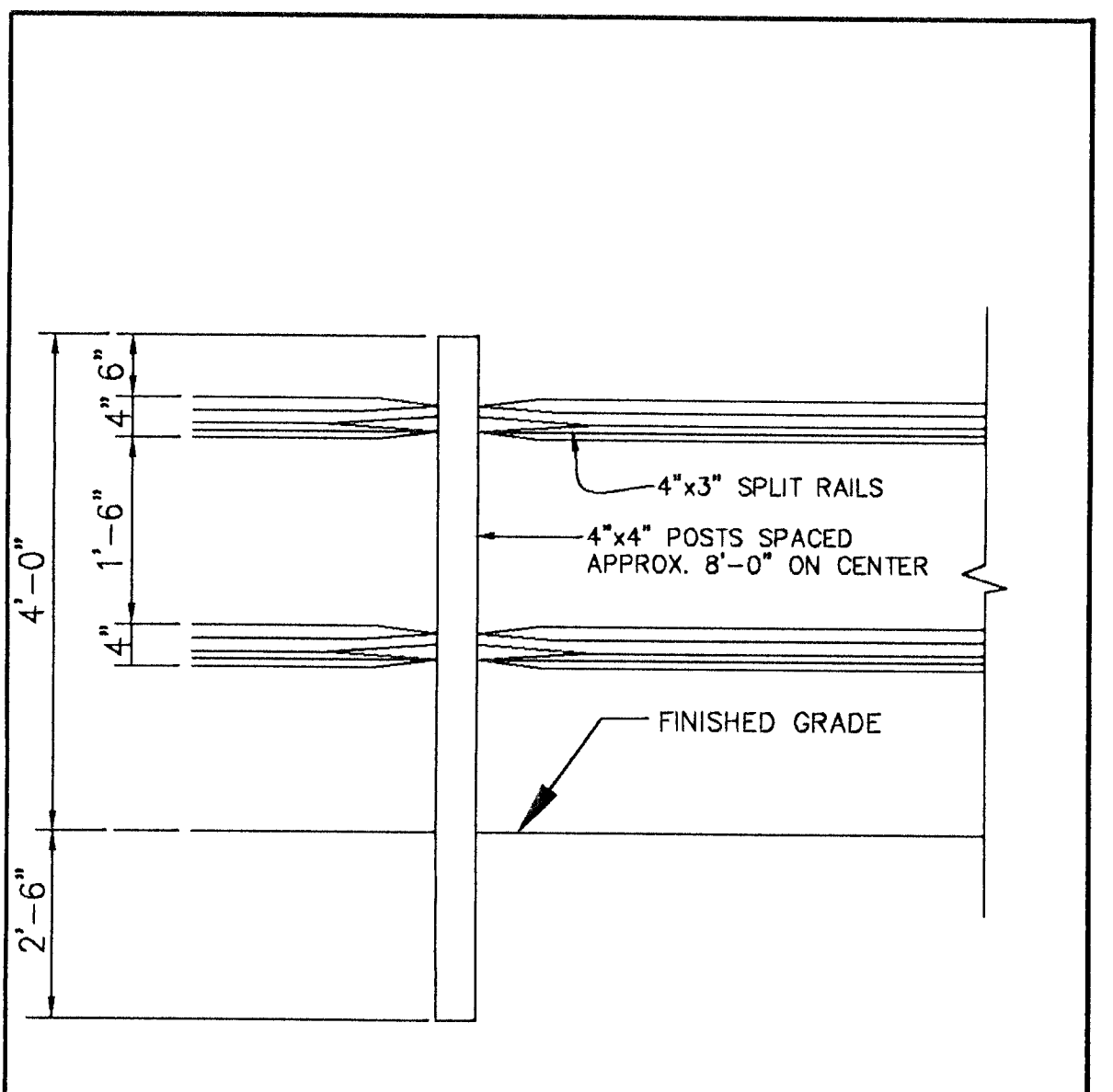

NOTES:

1. POSTS SHALL STAND PLUMB.
2. RAILS SHALL BE HUNG WITH UNIFORM HEIGHT AND SPACING.
3. REFORESTATION SIGNS TO BE ATTACHED TO WOOD FENCE POSTS EVERY 50 FEET.
4. TOP OF SIGN TO BE FLUSH WITH TOP OF WOOD FENCE POSTS.
5. SIGNS TO BE ATTACHED USING 2 GALVANIZED WOOD SCREWS EACH WITH A GALVANIZED WASHER.

PERMANENT (SPLIT RAIL) TREE PROTECTION FENCE FOR REFORESTATION AREAS

August 2010

A-4, DET-9

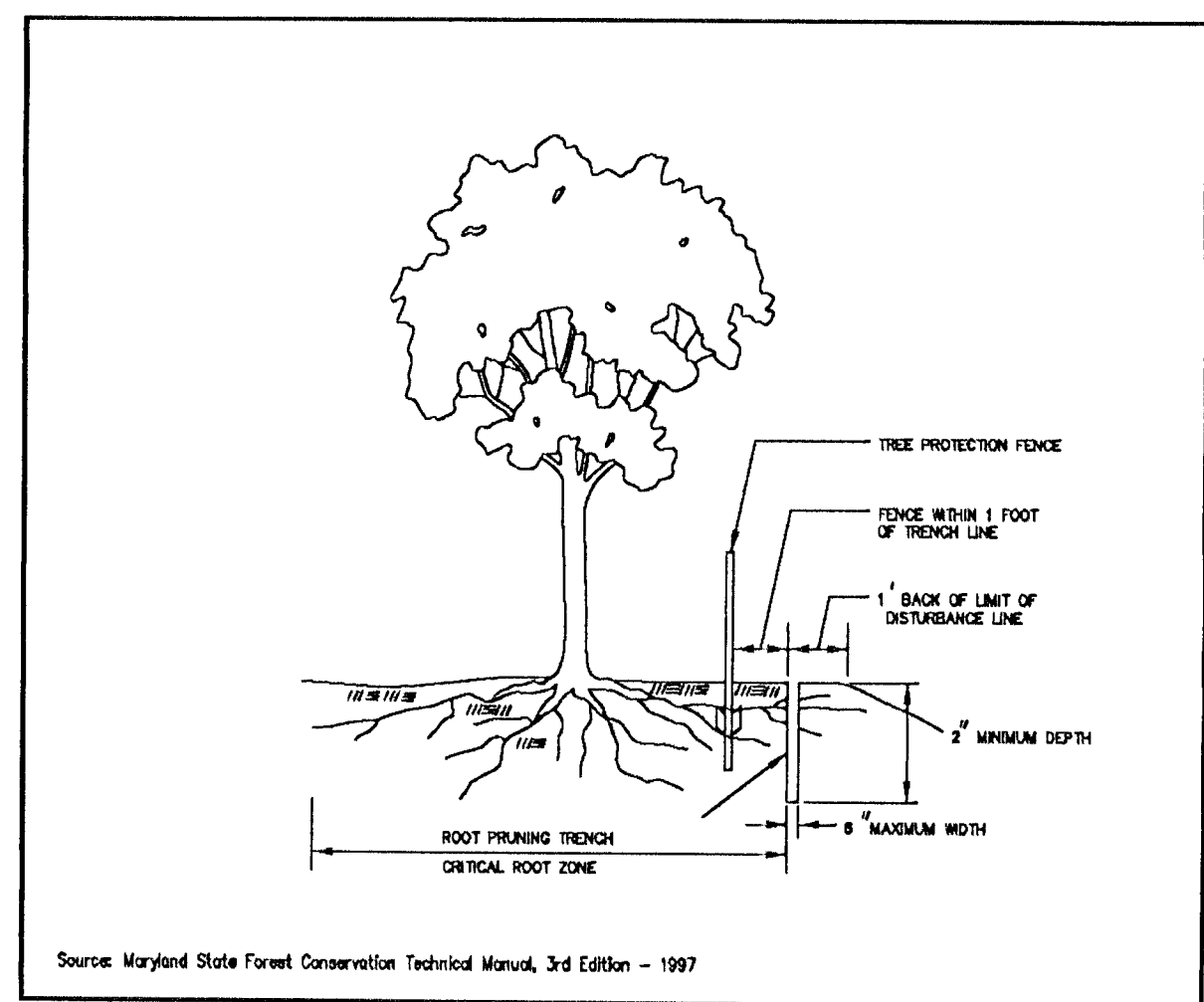

NOTES:

1. RETENTION AREAS TO BE ESTABLISHED AS PART OF THE FOREST CONSERVATION PLAN REVIEW PROCESS.
2. BOUNDARIES OF RETENTION AREAS SHOULD BE STAKED, FLAGGED AND/OR FENCED PRIOR TO TRENCHING.
3. EXACT LOCATION OF TRENCH SHOULD BE IDENTIFIED.
4. TRENCH SHOULD BE IMMEDIATELY BACKFILLED WITH SOIL REMOVED OR OTHER HIGH ORGANIC SOIL.
5. ROOTS SHOULD BE CLEANLY CUT USING VIBRATORY KNIFE OR OTHER ACCEPTABLE EQUIPMENT.

ROOT PRUNING

August 2010

A-4, DET-10

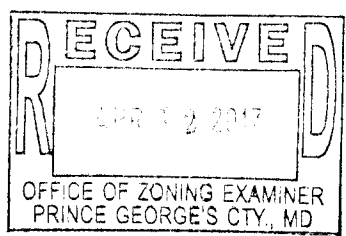

APPROVED

DATE: 4/23/17

SE-4734

Approved by	Date	DRD #	Reason for Rejection
00	4/23/17	SE-4734	ZHE Certification
01			
02			
03			
04			
05			
06			

Bowman
CONSULTING

Bowman Consulting Group, Ltd.
8815 Gwynn Drive
Manassas, Virginia 20110
Phone: (703) 500-8083
Fax: (703) 500-8475
www.bowmanconsulting.com
© Bowman Consulting Group, Ltd.

TREE CONSERVATION DETAILS (1 OF 2)
MILL BRANCH CROSSING

PRINCE GEORGE'S COUNTY, MARYLAND

SE # 4734
DSP # 13034
PLAN NUMBER

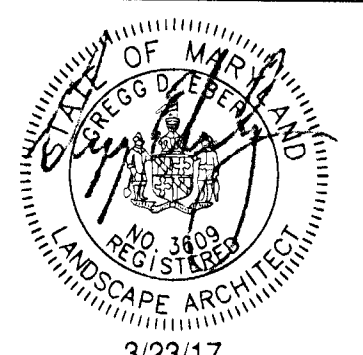

PLAN STATUS

10/17/16 REV. PER COUNTY COMMENTS

03/23/17 REV. PER COUNTY COMMENTS

DATE DESCRIPTION

GDE GDE GDE

DESIGN DRAWN CHKD

SCALE H: NO SCALE

JOB No. 4557-01-002

DATE: 12/28/15

FILE No. 4557-D-SE-001

SHEET 8 OF 10

REFORESTATION AREA #1 REQUIREMENTS

REFORESTATION/BUFFER AREA:	1.41 ACRES
STOCKING RATE REQUIRED:	1,000 SEEDLING EQUIVALENTS PER ACRE OR 1,410 SEEDLING EQUIVALENTS OR 705" CAL DBH (1 SEEDLING = .50")
STOCKING RATE PROVIDED:	1,410 SEEDLING EQUIVALENTS OR 705" CAL DBH (1,248 SEEDLING EQUIVALENTS OR 624" CAL DBH PER BUFFER #1 TREE SCHEDULE) (162 SEEDLING EQUIVALENTS OR 81" CAL DBH PER REFORESTATION AREA #1 SEEDLING SCHEDULE)
PERCENTAGE TREES REQUIRED:	50%, 705 SEEDLING EQUIVALENTS OR 352.50" CAL DBH
PERCENTAGE TREES PROVIDED:	89%, 1,248 SEEDLING EQUIVALENTS OR 624" CAL DBH PER BUFFER #1 TREE SCHEDULE

BUFFER #1 SCHEDULE 4.7-1

BUFFERING INCOMPATIBLE USE REQUIREMENTS

- GENERAL PLAN DESIGNATION: _____ DEVELOPED TIER, CORRIDOR
_____ NODE OR CENTER
☒ DEVELOPING OR RURAL TIER
RETAIL SALES LARGER THAN 60,000 S.F. GFA
ATHLETIC FIELD (UNLIGHTED)
LOW IMPACT
A B C D E
40 FEET
40 FEET
35 FEET
- USE OF PROPOSED DEVELOPMENT.
- IMPACT OF PROPOSED DEVELOPMENT:
- USE OF ADJOINING DEVELOPMENT:
- IMPACT OF ADJOINING DEVELOPMENT:
- MINIMUM REQUIRED BUFFERYARD (A, B, C, D OR E):
- MINIMUM REQUIRED BUILDING SETBACK:
- BUILDING SETBACK PROVIDED:
- MINIMUM REQUIRED WIDTH OF LANDSCAPED YARD:
- WIDTH OF LANDSCAPE YARD PROVIDED:
- (THE REQUIRED SETBACK AND LANDSCAPE YARD MAY
REDUCED BY 50% IN THE DEVELOPED TIER, CORRIDOR
NODE OR CENTER WHEN A SIX (6) FOOT HIGH FENCE
OR WALL IS PROVIDED.)
- LINEAR FEET OF BUFFER STRIP REQUIRED ALONG PROPERTY LINE AND R.O.W.: 1,731 LINEAR FEET
- PERCENTAGE OF REQUIRED BUFFERYARD OCCUPIED BY EXISTING TREES: 0 %
- IS A SIX (6) FOOT HIGH FENCE OR WALL INCLUDED IN BUFFERYARD? _____ YES _____ X NO
- (PER SECTION 4.7-3(F) OF THE LANDSCAPE MANUAL, THE REQUIRED
PLANT MATERIAL & LANDSCAPE YARD MAY BE REDUCED BY 50% WHEN A SIX (6) FOOT
HIGH OPAQUE FENCE IS PROVIDED.)
- TOTAL NUMBER OF PLANT UNITS REQUIRED IN BUFFER STRIP (120 PU PER 100 LF) 2,078 P.U.
- TOTAL NUMBER OF PLANT UNITS PROVIDED:

SHADE TREES 104 X 10 P.U. = 1,040 P.U.
EVERGREEN TREES 104 X 5 P.U. = 520 P.U.
ORNAMENTAL TREES 104 X 5 P.U. = 520 P.U.
SHRUBS 1 X 1 P.U. = 1 P.U.
TOTAL = 2,080 P.U.

REFORESTATION AREA #2 REQUIREMENTS

REFORESTATION/BUFFER AREA:	1.35 ACRES
STOCKING RATE REQUIRED:	1,000 SEEDLING EQUIVALENTS PER ACRE OR 1,350 SEEDLING EQUIVALENTS OR 675" CAL DBH (1 SEEDLING = .50")
STOCKING RATE PROVIDED:	1,350 SEEDLING EQUIVALENTS OR 675" CAL DBH (1,063 SEEDLING EQUIVALENTS OR 531.50" CAL DBH PER BUFFER #2 TREE SCHEDULE) (287 SEEDLING EQUIVALENTS OR 143.50" CAL DBH PER REFORESTATION AREA #2 SEEDLING SCHEDULE)
PERCENTAGE TREES REQUIRED:	50%, 675 SEEDLING EQUIVALENTS OR 338" CAL DBH
PERCENTAGE TREES PROVIDED:	79%, 1,063 SEEDLING EQUIVALENTS OR 531.50" CAL DBH PER BUFFER #2 TREE SCHEDULE

BUFFER #2 SCHEDULE 4.7-1

BUFFERING INCOMPATIBLE USE REQUIREMENTS

- GENERAL PLAN DESIGNATION: _____ DEVELOPED TIER, CORRIDOR
_____ NODE OR CENTER
☒ DEVELOPING OR RURAL TIER
RETAIL SALES LARGER THAN 60,000 S.F. GFA
HIGH IMPACT
AGRICULTURE
LOW IMPACT
A B C D E
40 FEET
40 FEET
30 FEET
40 FEET
- USE OF PROPOSED DEVELOPMENT.
- IMPACT OF PROPOSED DEVELOPMENT:
- USE OF ADJOINING DEVELOPMENT:
- IMPACT OF ADJOINING DEVELOPMENT:
- MINIMUM REQUIRED BUFFERYARD (A, B, C, D OR E):
- MINIMUM REQUIRED BUILDING SETBACK:
- BUILDING SETBACK PROVIDED:
- MINIMUM REQUIRED WIDTH OF LANDSCAPED YARD:
- WIDTH OF LANDSCAPE YARD PROVIDED:
- (THE REQUIRED SETBACK AND LANDSCAPE YARD MAY
REDUCED BY 50% IN THE DEVELOPED TIER, CORRIDOR
NODE OR CENTER WHEN A SIX (6) FOOT HIGH FENCE
OR WALL IS PROVIDED.)
- LINEAR FEET OF BUFFER STRIP REQUIRED ALONG PROPERTY LINE AND R.O.W.: 1,468 LINEAR FEET
- PERCENTAGE OF REQUIRED BUFFERYARD OCCUPIED BY EXISTING TREES: 0 %
- IS A SIX (6) FOOT HIGH FENCE OR WALL INCLUDED IN BUFFERYARD? _____ YES _____ X NO
- (PER SECTION 4.7-3(F) OF THE LANDSCAPE MANUAL, THE REQUIRED
PLANT MATERIAL & LANDSCAPE YARD MAY BE REDUCED BY 50% WHEN A SIX (6) FOOT
HIGH OPAQUE FENCE IS PROVIDED.)
- TOTAL NUMBER OF PLANT UNITS REQUIRED IN BUFFER STRIP (120 PU PER 100 LF) 1,762 P.U.
- TOTAL NUMBER OF PLANT UNITS PROVIDED:

SHADE TREES 88 X 10 P.U. = 880 P.U.
EVERGREEN TREES 88 X 5 P.U. = 440 P.U.
ORNAMENTAL TREES 88 X 5 P.U. = 440 P.U.
SHRUBS 1 X 1 P.U. = 1 P.U.
TOTAL = 1,770 P.U.

BUFFER #1 TREE SCHEDULE

KEY	QTY	BOTANICAL NAME	COMMON NAME	HEIGHT	CALIPER	CONDITION/REMARKS
MAJOR SHADE TREES						
AR	11	ACER RUBRUM	RED MAPLE	12'-14'	2.5" CAL	B&B - NATIVE
FG	11	FAGUS GRANDIFOLIA	AMERICAN BEECH	12'-14'	2.5" CAL	B&B - NATIVE
NS	11	NYSSA SYLVATICA	BLACK GUM	12'-14'	2.5" CAL	B&B - NATIVE
PO	11	PLATANUS OCCIDENTALIS	SYCAMORE	12'-14'	2.5" CAL	B&B - NATIVE
QA	12	QUERCUS ALBA	WHITE OAK	12'-14'	2.5" CAL	B&B - NATIVE
QP	12	QUERCUS PALustris	PIN OAK	12'-14'	2.5" CAL	B&B - NATIVE
QR	12	QUERCUS RUBRA	RED OAK	12'-14'	2.5" CAL	B&B - NATIVE
TA	12	LIRIODENDRON TULIPIFERA	AMERICAN BASSWOOD	12'-14'	2.5" CAL	B&B - NATIVE
UA	12	ULMUS AMERICANA	AMERICAN ELM	12'-14'	2.5" CAL	B&B - NATIVE
TOTAL	104			TOTAL	260"	
ORNAMENTAL TREES						
AC	14	AMELANCHIER CANADENSIS	SERVICEBERRY	7'-9'	1.5" CAL	B&B - NATIVE
CA	15	CARPINUS CAROLINIANA	AMERICAN HORNBEAM	7'-9'	1.5" CAL	B&B - NATIVE
CC	15	CERCIS CANADENSIS	REDBUD	7'-9'	1.5" CAL	B&B - NATIVE
CR	15	CORNUS FLORIDA	FLOWERING DOGWOOD	7'-9'	1.5" CAL	B&B - NATIVE
DV	15	DOSPYROS VIRGINIANA	COMMON PERSIMMON	7'-9'	1.5" CAL	B&B - NATIVE
MV	15	MAGNOLIA VIRGINIANA	SWEETBAY MAGNOLIA	7'-9'	1.5" CAL	B&B - NATIVE
SA	15	SASSAFRAS ALBIDUM	SASSAFRAS	7'-9'	1.5" CAL	B&B - NATIVE
TOTAL	104			TOTAL	196"	
EVERGREEN TREES						
IO	34	ILEX OPACA	AMERICAN HOLLY	8'-8"	2" CAL	B&B - NATIVE
JV	35	JUNIPERUS VIRGINIANA	EASTERN REDCEDAR	8'-8"	2" CAL	B&B - NATIVE
PS	35	PINUS STROBUS	WHITE PINE	8'-8"	2" CAL	B&B - NATIVE
TOTAL	104			TOTAL	298"	
				TOTAL	656"	

REFORESTATION AREA #1 SEEDLING SCHEDULE

KEY	QTY	BOTANICAL NAME	COMMON NAME	HEIGHT	CALIPER	CONDITION/REMARKS
MAJOR SHADE TREES						
AR	18	ACER RUBRUM	RED MAPLE	6'-12"	5" CAL	CONT. - NATIVE
FG	18	FAGUS GRANDIFOLIA	AMERICAN BEECH	6'-12"	5" CAL	CONT. - NATIVE
NS	18	NYSSA SYLVATICA	BLACK GUM	6'-12"	5" CAL	CONT. - NATIVE
PO	18	PLATANUS OCCIDENTALIS	SYCAMORE	6'-12"	5" CAL	CONT. - NATIVE
QA	18	QUERCUS ALBA	WHITE OAK	6'-12"	5" CAL	CONT. - NATIVE
QP	18	QUERCUS PALustris	PIN OAK	6'-12"	5" CAL	CONT. - NATIVE
QR	18	QUERCUS RUBRA	RED OAK	6'-12"	5" CAL	CONT. - NATIVE
TA	18	LIRIODENDRON TULIPIFERA	AMERICAN BASSWOOD	6'-12"	5" CAL	CONT. - NATIVE
UA	18	ULMUS AMERICANA	AMERICAN ELM	6'-12"	5" CAL	CONT. - NATIVE
TOTAL	182			TOTAL	81"	

BUFFER #2 TREE SCHEDULE

KEY	QTY	BOTANICAL NAME	COMMON NAME	HEIGHT	CALIPER	CONDITION/REMARKS
MAJOR SHADE TREES						
AR	9	ACER RUBRUM	RED MAPLE	12'-14'	2.5" CAL	B&B - NATIVE
FG	9	FAGUS GRANDIFOLIA	AMERICAN BEECH	12'-14'	2.5" CAL	B&B - NATIVE
NS	10	NYSSA SYLVATICA	BLACK GUM	12'-14'	2.5" CAL	B&B - NATIVE
PO	10	PLATANUS OCCIDENTALIS	SYCAMORE	12'-14'	2.5" CAL	B&B - NATIVE
QA	10	QUERCUS ALBA	WHITE OAK	12'-14'	2.5" CAL	B&B - NATIVE
QP	10	QUERCUS PALustris	PIN OAK	12'-14'	2.5" CAL	B&B - NATIVE
QR	10	QUERCUS RUBRA	RED OAK	12'-14'	2.5" CAL	B&B - NATIVE
TA	10	LIRIODENDRON TULIPIFERA	AMERICAN BASSWOOD	12'-14'	2.5" CAL	B&B - NATIVE
UA	10	ULMUS AMERICANA	AMERICAN ELM	12'-14'	2.5" CAL	B&B - NATIVE
TOTAL	88			TOTAL	220"	
ORNAMENTAL TREES						
AC	12	AMELANCHIER CANADENSIS	SERVICEBERRY	7'-9'	1.5" CAL	B&B - NATIVE
CA	12	CARPINUS CAROLINIANA	AMERICAN HORNBEAM	7'-9'	1.5" CAL	B&B - NATIVE
CC	13	CERCIS CANADENSIS	REDBUD	7'-9'	1.5" CAL	B&B - NATIVE
CR	13	CORNUS FLORIDA	FLOWERING DOGWOOD	7'-9'	1.5" CAL	B&B - NATIVE
DV	13	DOSPYROS VIRGINIANA	COMMON PERSIMMON	7'-9'	1.5" CAL	B&B - NATIVE
MV	13	MAGNOLIA VIRGINIANA	SWEETBAY MAGNOLIA	7'-9'	1.5" CAL	B&B - NATIVE
SA	13	SASSAFRAS ALBIDUM	SASSAFRAS	7'-9'	1.5" CAL	B&B - NATIVE
TOTAL	89			TOTAL	133.90"	
EVERGREEN TREES						
IO	29	ILEX OPACA	AMERICAN HOLLY	6'-8"	2" CAL	B&B - NATIVE
JV	30	JUNIPERUS VIRGINIANA	EASTERN REDCEDAR	6'-8"	2" CAL	B&B - NATIVE
PS	30	PINUS STROBUS	WHITE PINE	6'-8"	2" CAL	B&B - NATIVE
TOTAL	89			TOTAL	116"	
				TOTAL	531.90"	

REFORESTATION AREA #2 SEEDLING SCHEDULE

KEY	QTY	BOTANICAL NAME	COMMON NAME	HEIGHT	CALIPER	CONDITION/REMARKS
MAJOR SHADE TREES						
AR	31	ACER RUBRUM	RED MAPLE	6'-12"	5" CAL	CONT. - NATIVE
FG	32	FAGUS GRANDIFOLIA	AMERICAN BEECH	6'-12"	5" CAL	CONT. - NATIVE
NS	32	NYSSA SYLVATICA	BLACK GUM	6'-12"	5" CAL	CONT. - NATIVE
PO	32	PLATANUS OCCIDENTALIS	SYCAMORE	6'-12"	5" CAL	CONT. - NATIVE
QA	32	QUERCUS ALBA	WHITE OAK	6'-12"	5" CAL	CONT. - NATIVE
QP	32	QUERCUS PALustris	PIN OAK	6'-12"	5" CAL	CONT. - NATIVE
QR	32	QUERCUS RUBRA	RED OAK	6'-12"	5" CAL	CONT. - NATIVE
TA	32	LIRIODENDRON TULIPIFERA	AMERICAN BASSWOOD	6'-12"	5" CAL	CONT. - NATIVE
UA	32	ULMUS AMERICANA	AMERICAN ELM	6'-12"	5" CAL	CONT. - NATIVE
TOTAL	287			TOTAL	143.50"	

REFORESTATION AREA #3 REQUIREMENTS

REFORESTATION AREA:	0.73 ACRES
STOCKING RATE REQUIRED:	1,000 SEEDLING EQUIVALENTS PER ACRE OR 730 SEEDLING EQUIVALENTS OR 365" CAL DBH (1 SEEDLING = .50")
STOCKING RATE PROVIDED:	730 SEEDLING EQUIVALENTS OR 365" CAL DBH (365 SEEDLING EQUIVALENTS OR 182.50" CAL DBH PER REFORESTATION AREA #3 TREE SCHEDULE) (365 SEEDLING EQUIVALENTS OR 182.50" CAL DBH PER REFORESTATION AREA #3 SEEDLING SCHEDULE)
PERCENTAGE TREES REQUIRED:	50%, 365 SEEDLING EQUIVALENTS OR 182.50" CAL DBH
PERCENTAGE TREES PROVIDED:	50%, 365 SEEDLING EQUIVALENTS OR 182.50" CAL DBH PER REFORESTATION AREA #3 TREE SCHEDULE

BUFFER SCHEDULE 4.6-2

BUFFERING DEVELOPMENT FROM SPECIAL ROADWAYS

- NAME OF SPECIAL ROADWAY:
- TYPE OF SPECIAL ROADWAY:
- GENERAL PLAN DESIGNATION: _____ DEVELOPED TIER
☒ DEVELOPING TIER
RURAL TIER
818 FEET
20 FEET
40 FEET
40 FEET
0 %
YES ☒ NO
31 SHADE TREES
30 EVERGREEN TREES
193 SHRUBS (SEEDLINGS)
31 SHADE TREES
30 EVERGREEN TREES
365 SHRUBS (SEEDLINGS)
- LINEAR FEET OF STREET FRONTAGE, NOT INCLUDING DRIVEWAY ENTRANCES:
- MINIMUM WIDTH OF BUFFER PROVIDED:
- MINIMUM WIDTH OF PROVIDED BUFFER:
- PERCENTAGE OF REQUIRED BUFFER OCCUPIED BY EXISTING TREES:
- INVASIVE SPECIES IN THE BUFFER AREAS?
- NUMBER OF PLANTS REQUIRED:

-PLANT UNITS REQUIRED:
-PLANT UNITS PROVIDED:

MILL BRANCH ROAD
HISTORIC & SCENIC
DEVELOPED TIER
RURAL TIER
818 FEET
20 FEET
40 FEET
40 FEET
0 %
YES ☒ NO
31 SHADE TREES
30 EVERGREEN TREES
193 SHRUBS (SEEDLINGS)
31 SHADE TREES
30 EVERGREEN TREES
365 SHRUBS (SEEDLINGS)

80 PER 100 LINEAR FEET OR 653 PLANT UNITS
825 PLANT UNITS
(310 SHADE TREE PLANT UNITS,
150 EVERGREEN TREE PLANT UNITS &
365 SHRUB (SEEDLING) PLANT UNITS)

REFORESTATION AREA #3 TREE SCHEDULE

KEY	QTY	BOTANICAL NAME	COMMON NAME	HEIGHT	CALIPER	CONDITION/REMARKS
MAJOR SHADE TREES						
AR	3	ACER RUBRUM	RED MAPLE	12'-14'	2.5" CAL	B&B - NATIVE
FG	3	FAGUS GRANDIFOLIA	AMERICAN BEECH	12'-14'	2.5" CAL	B&B - NATIVE
NS	3	NYSSA SYLVATICA	BLACK GUM	12'-14'	2.5" CAL	B&B - NATIVE
PO	3	PLATANUS OCCIDENTALIS	SYCAMORE	12'-14'	2.5" CAL	B&B - NATIVE
QA	3	QUERCUS ALBA	WHITE OAK	12'-14'	2.5" CAL	B&B - NATIVE
QP	4	QUERCUS PALustris	PIN OAK	12'-14'	2.5" CAL	B&B - NATIVE
QR	4	QUERCUS RUBRA	RED OAK	12'-14'	2.5" CAL	B&B - NATIVE
TA	4	LIRIODENDRON TULIPIFERA	AMERICAN BASSWOOD	12'-14'	2.5" CAL	B&B - NATIVE
UA	4	ULMUS AMERICANA	AMERICAN ELM	12'-14'	2.5" CAL	B&B - NATIVE
TOTAL	31			TOTAL	77.5"	
ORNAMENTAL TREES						
AC	4	AMELANCHIER CANADENSIS	SERVICEBERRY	7'-9'	1.5" CAL	B&B - NATIVE
CA	4	CARPINUS CAROLINIANA	AMERICAN HORNBEAM	7'-9'	1.5" CAL	B&B - NATIVE
CC	4	CERCIS CANADENSIS	REDBUD	7'-9'	1.5" CAL	B&B - NATIVE
CR	4	CORNUS FLORIDA	FLOWERING DOGWOOD	7'-9'	1.5" CAL	B&B - NATIVE
DV	4	DOSPYROS VIRGINIANA	COMMON PERSIMMON	7'-9'	1.5" CAL	B&B - NATIVE
MV	5	MAGNOLIA VIRGINIANA	SWEETBAY MAGNOLIA	7'-9'	1.5" CAL	B&B - NATIVE
SA	5	SASSAFRAS ALBIDUM	SASSAFRAS	7'-9'	1.5" CAL	B&B - NATIVE
TOTAL	30			TOTAL	49"	
EVERGREEN TREES						
IO	10	ILEX OPACA	AMERICAN HOLLY	6'-8"	2" CAL	B&B - NATIVE
JV	10	JUNIPERUS VIRGINIANA	EASTERN REDCEDAR	6'-8"	2" CAL	B&B - NATIVE
PS	10	PINUS STROBUS	WHITE PINE	6'-8"	2" CAL	B&B - NATIVE
TOTAL	30			TOTAL	60"	
				TOTAL	182.5"	

REFORESTATION AREA #3 SEEDLING SCHEDULE

KEY	QTY	BOTANICAL NAME	COMMON NAME	HEIGHT	CALIPER	CONDITION/REMARKS
MAJOR SHADE TREES						
AR	40	ACER RUBRUM	RED MAPLE	6'-12"	5" CAL	CONT. - NATIVE
FG	40	FAGUS GRANDIFOLIA	AMERICAN BEECH	6'-12"	5" CAL	CONT. - NATIVE
NS	40	NYSSA SYLVATICA	BLACK GUM	6'-12"	5" CAL	CONT. - NATIVE
PO	40	PLATANUS OCCIDENTALIS	SYCAMORE	6'-12"	5" CAL	CONT. - NATIVE
QA	41	QUERCUS ALBA	WHITE OAK	6'-12"	5" CAL	CONT. - NATIVE
QP	41	QUERCUS PALustris	PIN OAK	6'-12"	5" CAL	CONT. - NATIVE
QR	41	QUERCUS RUBRA	RED OAK	6'-12"	5" CAL	CONT. - NATIVE
TA	41	LIRIODENDRON TULIPIFERA	AMERICAN BASSWOOD	6'-12"	5" CAL	CONT. - NATIVE
UA	41	ULMUS AMERICANA	AMERICAN ELM	6'-12"	5" CAL	CONT. - NATIVE
TOTAL	365			TOTAL	181"	

PLANTING SCHEDULES

MILL BRANCH CROSSING

PRINCE GEORGES COUNTY, MARYLAND

SE # 4734
DSP # 13034
PLAN NUMBER

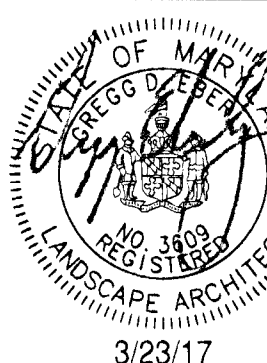

PLAN STATUS
10/17/16 REV. PER COUNTY COMMENTS
03/23/17 REV. PER COUNTY COMMENTS

DATE	DESCRIPTION
01	
02	
03	
04	
05	
06	

GDE GDE GDE
DESIGN DESIGN DESIGN
DRAWN DRAWN DRAWN
CHKD CHKD CHKD

SCALE H: NO SCALE
V:

JOB No. 4557-01-002

DATE : 12/28/15

FILE No. 4557-D-SE-001

SHEET 10 OF 10

APPROVED
DATE: 4/11/17

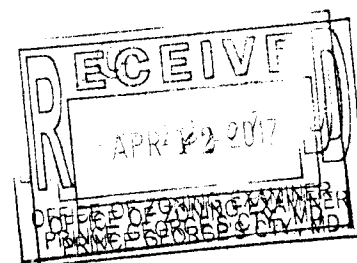

SE - 4734

Prince George's County Planning Department, MDCRC Environmental Planning Section TREE CONSERVATION PLAN APPROVAL (CP-0405-10)			
Approved by	Date	DRD #	Reason for Rejection
00		SE-4734	ZIE Certification
01			
02			
03			
04			
05			
06			