

CAPITOL HEIGHTS SHOPPING CENTER

TREE CONSERVATION PLAN - TYPE II

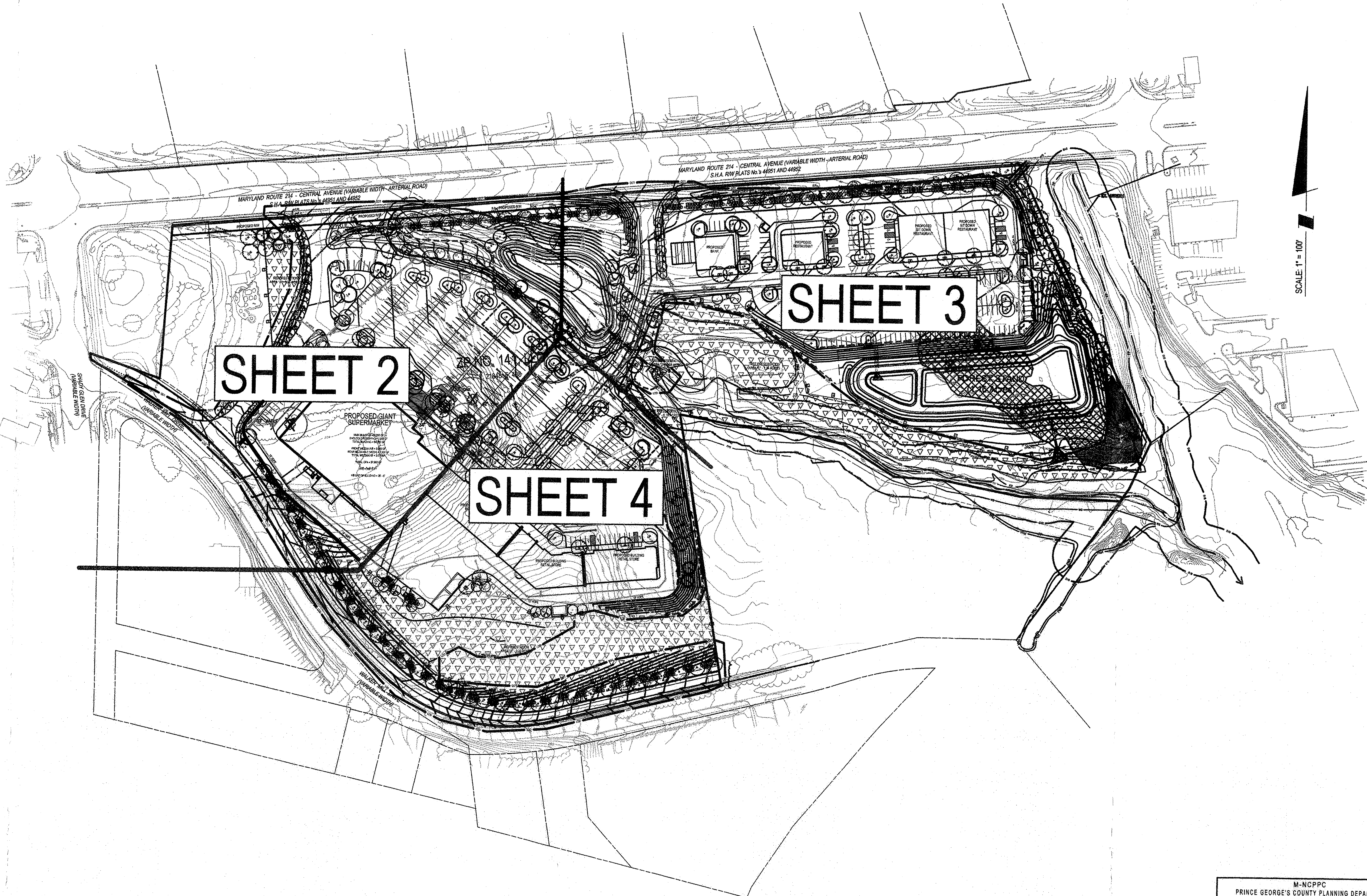
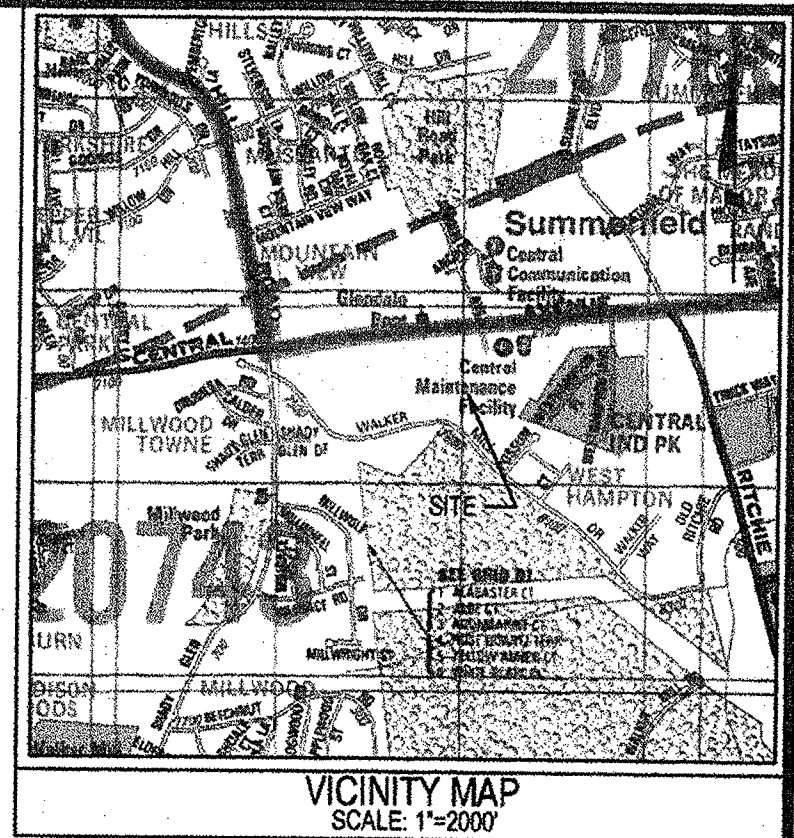

Woodland Conservation Worksheet for Prince George's County

SECTION I-Establishing Site Information (Enter acres for each zone)

1 Zone:	C-S-C	C-O
2 Gross Tract:	28.79	0.65
3 Floodplain:	0.65	
4 Previously Dedicated Land:		
5 Net Tract (NTA):	28.14	0.65

6 Property Description or Subdivision Name: Capitol Heights Shopping Center

7 Is this site subject to the 1989 Ordinance? N

8 Is this one (1) single family lot? (y/n) N

9 Are there prior TCP approvals which include a combination of this lot and/or other lots? (y/n) N

10 Is this a Mitigation Bank? N

11 Break-even Point (preservation) = 4.32 acres

12 Clearing permitted w/o reforestation = 3.16 acres

SECTION II-Determining Requirements (Enter acres for each corresponding column)

	Column A VCT/AFCT %	Column B Net Tract (1-1)	Column C Floodplain Off-Site Impacts (1-1)	Column D Off-Site Impacts (1-1)
13 Existing Woodland		1.16	0.01	
14 Woodland Conservation Threshold (NTA) =	15.00%	4.32		
15 Smaller of 13 or 14		1.16		
16 Woodland above WCT		0.00		
17 Woodland cleared		0.92	0.00	
18 Smaller of 16 or 17		0.00		
19 Clearing above WCT (0.25 : 1) replacement requirement		0.00		
20 Clearing below WCT (2:1 replacement requirement)		0.92		
21 Afforestation Threshold (AF%)	15.00%	3.16		
22 Off-site Conservation being provided on this property		0.00		
23 Woodland Conservation Required		5.24		

SECTION III-Meeting the Requirements

24 Woodland Preservation	0.23			
25 Afforestation / Reforestation	5.01			
26 Area approved for fee-in-lieu	0.00			\$0.00
27 Credits for Off-site Conservation on another property	0.00			
28 Off-site Conservation (preservation) being provided on this property	0.00			
29 Off-site Conservation (afforestation) being provided on this property	0.00			
30 Total Woodland Conservation Provided	5.24			

31 Area of woodland not cleared: 0.24 acres

32 Woodland retained not part of requirements: 0.01 acres

33 Prepared by: [Signature] Date: 6-2-10

* Per the Approved Sector Plan and Sectional Map Amendment for the Morgan Boulevard and Largo Town Center Metro Areas (May 2004) Development District Overlay Zone Standard C (pg. 102) the planting of site trees and street trees planted on abutting road rights-of-way shall be counted toward meeting the Woodland Conservation Ordinance requirements. 0.23 acres of preservation and 4.04 acres of reforestation is to be provided on-site. The remaining 0.97 acres of conservation shown as required is identified as reforestation but is satisfied by the street trees and site trees proposed on the landscape plan.

Preservation Areas	Acres	Reforestation Areas	Acres
A	0.23	A	0.24
		B	2.20
		C	1.34
		D	0.08
		E	0.18
Total	0.23	Total	4.04

SPECIMEN TREE LIST AND FINAL DISPOSITION

DISPOSITION ID#	SPECIES	DBH"	HEIGHT'	CROWN'	OBSERVATIONS
REMOVED 1	White Oak	34	70	35	Open grown, healthy
REMOVED 2	White Oak	40	65	45	Open grown, healthy
REMOVED 3	Northern Red Oak	45	55	50	Open grown, healthy
REMOVED 4	Pin Oak	30	55	30	Open grown, healthy
REMOVED 5	Northern Red Oak	33	55	30	Open grown, healthy, san. prune
REMOVED 6	Northern Red Oak	35	50	30	Open grown, no east crown
REMOVED 7	Northern Red Oak	32	45	30	Open grown, Y at 30', malformed
REMOVED 8	Southern Red Oak	42	60	30	Open grown, cavity wound, poor
REMOVED 9	Silver Maple	33	45	40	Two primaries, Open grown, poor
REMOVED 10	White Oak	32	55	35	Open grown, healthy, two primaries
REMOVED 11	White Oak	30	45	25	Open grown, white oak grove, healthy
REMOVED 12	White Oak	33	45	25	Edge of pasture, white oak grove, healthy
REMOVED 13	White Oak	35	50	35	Edge of slope of white oak grove, rot on east side of butt, healthy

All reforestation/afforestation and the associated split-rail fencing along the outer edge of all reforestation/afforestation areas shall be installed prior to the building permits for the adjacent lots/parcels. A certification prepared by a qualified professional may be used to provide verification that the afforestation has been completed. It must include, at a minimum, photos of the afforestation areas and the associated fencing for each lot, with labels on the photos identifying the locations and a plan showing the locations where the photos were taken.

DSP-0601577

APPROVED PLAN

M-NCPPC APPROVALS

PROJECT NAME: Capitol Heights Shopping Ctr.

PROJECT NUMBER: DSP-06015

APPROVAL

TREE CONSERVATION PLAN

TCPII 1009109

APPROVED BY: [Signature] DATE: 6/2/10

APPROVAL OR REVISION #	APPROVAL DATE	REVIEWER'S INITIALS	CERTIFICATION DATE
00	2-4-10	HZ	8-23-10
01			
02			
03			
04			
05			

 Lundberg Soltes Associates, Inc. Engineering Planning Surveying Environmental Sciences	Rockville Lanham Waldorf Leonardtown	MISS UTILITY NOTE		OWNER/DEVELOPER/APPLICANT		COPYRIGHT AND THE MAP PEOPLE PERMITTED USE NUMBER 2081198 99 GRID 103, EX		TREE CONSERVATION PLAN - TYPE II		
		INFORMATION CONCERNING EXISTING UNDERGROUND UTILITIES WAS OBTAINED FROM AVAILABLE RECORDS. THE CONTRACTOR MUST DETERMINE THE EXACT LOCATION AND ELEVATION OF ALL EXISTING UTILITIES AND UTILITY CROSSINGS BY DIGGING TEST PITS BY HAND, WELL IN ADVANCE OF THE START OF EXCAVATION. CONTACT "MISS UTILITY" AT 1-800-257-7777, 48 HOURS PRIOR TO THE START OF EXCAVATION. IF CLEARANCES ARE LESS THAN 18" IN ANY DIRECTION, THE CONTRACTOR SHALL BE RESPONSIBLE FOR PROTECTING THE UTILITIES. BEFORE PROCEEDING WITH CONSTRUCTION, CLEARANCES LESS THAN NOTED MAY REQUIRE REVISIONS TO THIS PLAN.		2P NO 141 LLC 111 PRINCESS ST. WILMINGTON, NC 28401		TAX MAP 88 - F4 ZONING CATEGORY: C-S-C WSSC 207 SHEET 2015ED7 SITE DATUM HORIZONTAL: VERTICAL:		CAPITOL HEIGHTS SHOPPING CENTER		
LANHAM OFFICE 4300 Forbes Boulevard, Suite 230 Lanham, MD 20706 t. 301.794.7555 f. 301.794.7656		NO. DATE: DECEMBER 2009 DESIGNED: BCG TECHNICIAN: BCG BY: DATE: CHECKED: KAS		REVISIONS V8 - 2009		SEAT PLEASANT (18th) ELECTION DISTRICT, PRINCE GEORGE'S COUNTY, MARYLAND		SHEET 1 OF 5		PROJECT NO. 1864-00-00

www.LSAssociates.net

P:\18640000\ENGINEERING\TCPII01.sht Scale=100.00000 R/in. User=bgblatte PLTdrv=Color.plt Penlib=TEXT.SUB.TBL 6/2/2010 10:41:01 AM

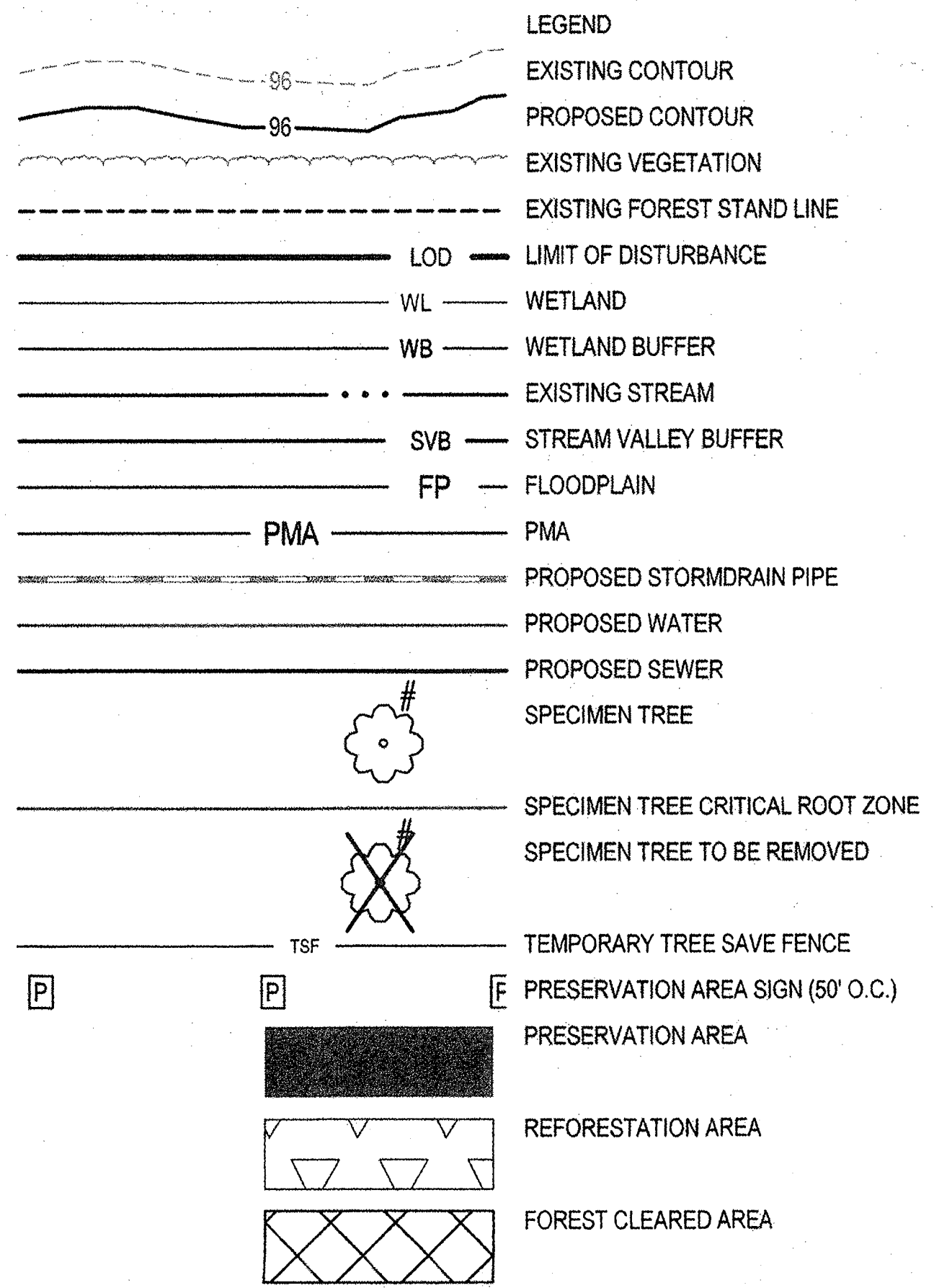

All reforestation/afforestation and the associated split-rail fencing along the outer edge of all reforestation/afforestation areas shall be installed prior to the building permits for the adjacent lots/parcels. A certification prepared by a qualified professional may be used to provide verification that the afforestation has been completed. It must include, at a minimum, photos of the afforestation areas and the associated fencing for each lot, with labels on the photos identifying the locations and a plan showing the locations where the photos were taken.

DS P - 06 015

APPROVED PLAN

		M-NCCPP APPROVALS			
M-NCCPP PRINCE GEORGE'S COUNTY PLANNING DEPARTMENT ENVIRONMENTAL PLANNING SECTION APPROVAL TREE CONSERVATION PLAN TCP#1 / 009 / 09		PROJECT NAME <i>Capitol Heights Shopping Ctr.</i> PROJECT NUMBER <i>DSP-06015</i>			
APPROVED BY <i>K. Shaulane</i>		DATE <i>6/10/10</i>			
01	FOR CONDITIONS OF APPROVAL, SEE SITE PLAN COVER SHEET OR APPROVAL SHEET REVISED LISTED BELOW APPLY TO THIS SHEET.				
02	APPROVAL OR REVISION # <i>DD</i>	APPROVAL DATE <i>2.4.10</i>	REVIEWER'S INITIALS <i>HZ</i>	CERTIFICATION DATE <i>8.23.10</i>	
03					
04					
05					

TREE CONSERVATION PLAN - TYPE II

CAPITOL HEIGHTS SHOPPING CENTER

SEAT PLEASANT (18TH) ELECTION DISTRICT, PRINCE GEORGE'S COUNTY, MARYLAND

 **Lundgerman
Solteiz Associates, Inc.**

LANHAM OFFICE
4300 Forbes Boulevard, Suite 230
Lanham, MD 20706
t. 301.794.7555 f. 301.794.7656

**Engineering
Planning
Surveying
Environmental Sciences**

**Rockville
Lanham
Waldorf
Leonardtown**

www.LSAssociates.net

[illegible]

MISS UTILITY NOTE

INFORMATION CONCERNING EXISTING UNDERGROUND UTILITIES WAS OBTAINED FROM AVAILABLE RECORDS. THE CONTRACTOR MUST DETERMINE THE EXACT LOCATION AND ELEVATION OF ALL EXISTING UTILITIES AND UTILITY CROSSINGS BY DIGGING TEST PITS BY HAND, WELL IN ADVANCE OF THE START OF EXCAVATION. CONTACT "MISS UTILITY" AT 1-800-267-7777, 48 HOURS PRIOR TO THE START OF EXCAVATION. IF CLEARANCES ARE LESS THAN SHOWN ON THIS PLAN OR TWELVE (12) INCHES, WHICHEVER IS LESS, CONTACT THE ENGINEER AND THE UTILITY COMPANY BEFORE PROCEEDING WITH CONSTRUCTION. CLEARANCES LESS THAN NOTED MAY REQUIRE REVISIONS TO THIS PLAN.



OWNER/DEVELOPER/APPLICANT

ZP NO 141 LLC
111 PRINCESS ST.
WILMINGTON, NC 28401

PERMITTED USE NUMBER 20811599 MAP 19 GRID 03, E3	
TAX MAP 66 - F4	ZONING CATEGORY C-S-C
WSSC 200' SHEET 201SE07	
SITE DATUM HORIZONTAL: _____ VERTICAL: _____	

A circular postmark from the State of Maryland. The text "STATE OF MARYLAND" is curved along the top inner edge, and "POST OFFICE BALTIMORE" is curved along the bottom inner edge. In the center, the date "1892" is stamped. A large, handwritten "D" is superimposed over the date. To the left of the "D", the number "18" is handwritten. To the right of the "D", the number "1892" is handwritten. The entire postmark is set against a background of a grid of small squares.

CAPITOL HEIGHTS SHOPPING CENTER

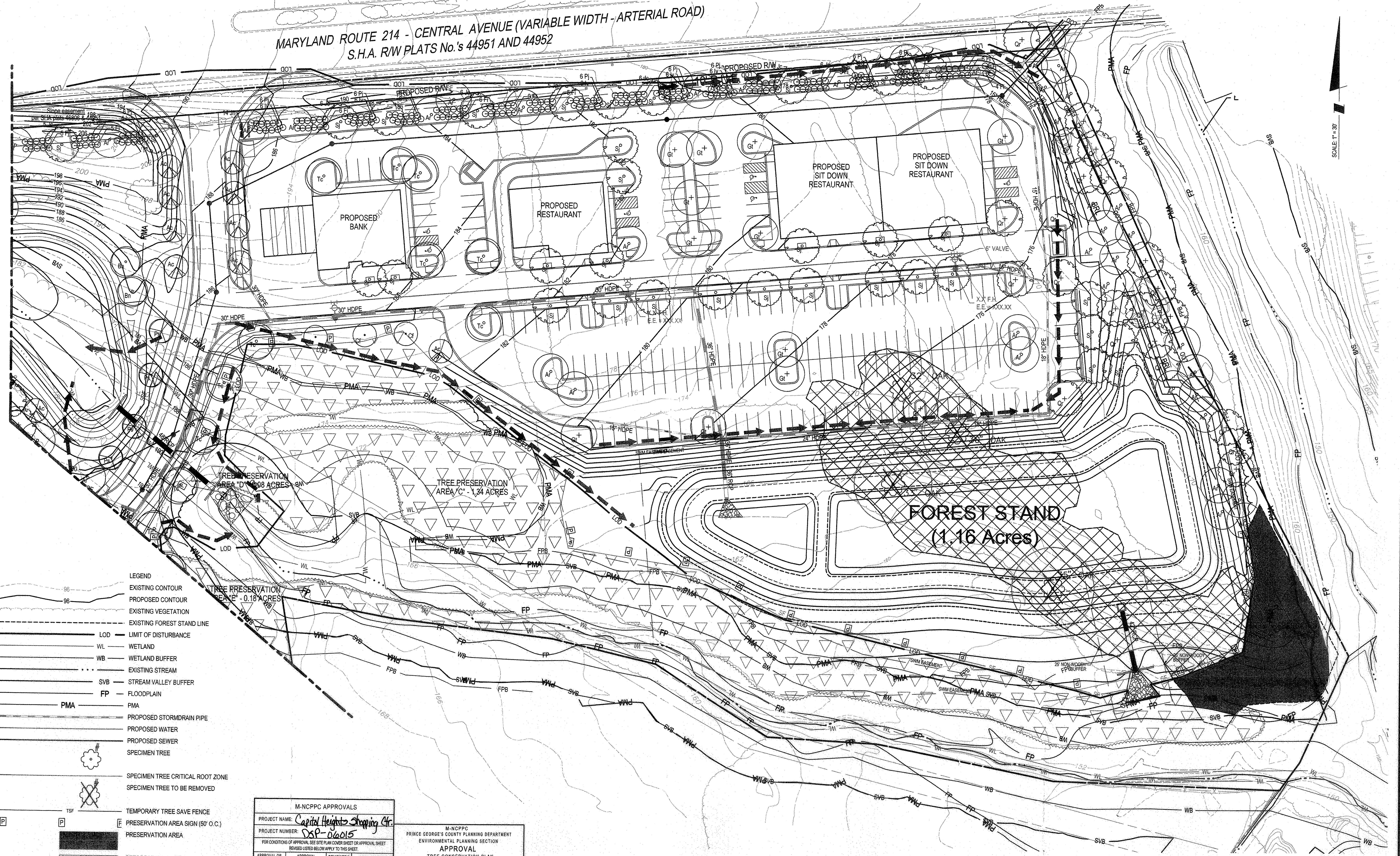

 SHEET 2
 OF 5
 PROJECT NO.
 1864-00-00

MARYLAND ROUTE 214 - CENTRAL AVENUE (VARIABLE WIDTH - ARTERIAL ROAD)
S.H.A. RW PLATS No.'s 44951 AND 44952



- LEGEND
- EXISTING CONTOUR
 - PROPOSED CONTOUR
 - EXISTING VEGETATION
 - EXISTING FOREST STAND LINE
 - LOD - LIMIT OF DISTURBANCE
 - WL - WETLAND
 - WB - WETLAND BUFFER
 - SVB - STREAM VALLEY BUFFER
 - FP - FLOODPLAIN
 - PMA - PMA
 - PROPOSED STORMDRAIN PIPE
 - PROPOSED WATER
 - PROPOSED SEWER
 - SPECIMEN TREE
 - SPECIMEN TREE CRITICAL ROOT ZONE
 - SPECIMEN TREE TO BE REMOVED
 - TSF - TEMPORARY TREE SAVE FENCE
 - P - PRESERVATION AREA SIGN (50' O.C.)
 - F - PRESERVATION AREA
 - REFORESTATION AREA
 - FOREST CLEARED AREA

M-NCPPC APPROVALS			
PROJECT NAME: <i>Capital Heights Shopping Ctr.</i>			
PROJECT NUMBER: <i>DSP-06015</i>			
FOR CONDITIONS OF APPROVAL SEE SITE PLAN COVER SHEET OR APPROVAL SHEET			
REVISIONS LISTED BELOW APPLY TO THIS SHEET			
APPROVAL OR REVISION #	APPROVAL DATE	REVIEWER'S INITIALS	CERTIFICATION DATE
00	2.4.10	HZ	3.23.10

M-NCPPC COUNTY PLANNING DEPARTMENT ENVIRONMENTAL PLANNING SECTION APPROVAL			
TREE CONSERVATION PLAN			
TCPII 1009109			
APPROVED BY		DATE	
<i>K. J. Smith</i>		6/10/10	
01			
02			
03			
04			
05			

All reforestation/afforestation and the associated split-rail fencing along the outer edge of all reforestation/afforestation areas shall be installed prior to the building permits for the adjacent lots/parcels. A certification prepared by a qualified professional may be used to provide verification that the afforestation has been completed. It must include, at a minimum, photos of the afforestation areas and the associated fencing for each lot, with labels on the photos identifying the locations and a plan showing the locations where the photos were taken.

DSP-06015
APPROVED PLAN

LS
Lundman
Soltesz Associates, Inc.
Rockville
Lanham
Waldorf
Leonardtown
LANHAM OFFICE
4300 Forbes Boulevard, Suite 230
Lanham, MD 20706
t. 301.794.7555 f. 301.794.7656
www.LSAssociates.net

REVISIONS			
NO.	DATE	REVISIONS	BY
1	DECEMBER 2009	CAD STANDARDS VERSION: V3 - 2009	BOG
2		TECHNICAL: BOG	
3		CHECKED: KAS	

MISS UTILITY NOTE
INFORMATION CONCERNING EXISTING UNDERGROUND UTILITIES WAS OBTAINED FROM AVAILABLE RECORDS. THE CONTRACTOR MUST DETERMINE THE EXACT LOCATION AND ELEVATION OF ALL EXISTING UTILITIES AND UTILITY CROSSINGS BY DIGGING TEST PITS BY HAND WELL IN ADVANCE OF THE START OF EXCAVATION. CONTACT "MISS UTILITY" AT 1-800-251-7777 48 HOURS PRIOR TO THE START OF EXCAVATION. IF CLEARANCES ARE LESS THAN SHOWN ON THIS PLAN OR TWELVE (12) INCHES, WHOEVER IS LESS, CONTACT THE ENGINEER AND THE UTILITY COMPANY BEFORE PROCEEDING WITH CONSTRUCTION. CLEARANCES LESS THAN NOTED MAY REQUIRE REVISIONS TO THIS PLAN.

OWNER/DEVELOPER/APPLICANT
ZP NO 141 LLC
111 PRINCESS ST.
WILMINGTON, NC 28401

COPYRIGHT AND THE MAP PEOPLE PERMITTED USE NUMBER: 2011115	
MAP 19 GRID D3 E3	
TAX MAP 66 - F4	ZONING CATEGORY: C-S-C
WSSC 200 SHEET 2015E07	
SITE DATUM	
HORIZONTAL	
VERTICAL	

TREE CONSERVATION PLAN - TYPE II

CAPITOL HEIGHTS SHOPPING CENTER

SEAT PLEASANT (16th) ELECTION DISTRICT, PRINCE GEORGE'S COUNTY, MARYLAND

1" = 30'

SHEET 3 OF 5

PROJECT NO. 1854-00-00

The origin of this drawing document was prepared by Lundman Soltesz Associates, Inc. (LSA). If this document was not obtained directly from LSA, it was transmitted electronically. LSA cannot guarantee the accuracy of any information that has been transmitted by electronic means.



- All reforestation/afforestation and the associated split-rail fencing along the outer edge of all reforestation/afforestation areas shall be installed prior to the building permits for the adjacent lots/parcels. A certification prepared by a qualified professional may be used to provide verification that the afforestation has been completed. It must include, at a minimum, photos of the afforestation areas and the associated fencing for each lot, with labels on the photos identifying the locations and a plan showing the locations where the photos were taken.

M-NCPPC		M-NCPPC APPROVALS	
PRINCE GEORGE'S COUNTY PLANNING DEPARTMENT		PROJECT NAME: <i>Capital Heights Shopping Ctr</i>	
ENVIRONMENTAL PLANNING SECTION		PROJECT NUMBER: <i>DSP- 86015</i>	
TREE CENSUS PLAN		FOR CONDITIONS OF APPROVAL, SEE SITE PLAN COVER SHEET OR APPROVAL SHEET REVISED (NOTE BELOW APPLY TO THIS SHEET)	
TCPII 1009109		APPROVAL OR REVISION #	CERTIFICATION DATE
APPROVED BY:	DATE	APPROVAL DATE	REVIEWER'S INITIALS
<i>K. Shoultan</i>	<i>6/10/10</i>	<i>00</i>	<i>2.4.10 #Z</i>
01			
02			
03			
04			
05			



1" = 30'

SHEET 4

OF 5

PROJECT NO.
1001-00-00

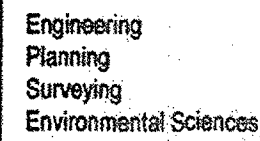

Rockville
Lanham
Waldorf
Leonardtown

NO.	REVISIONS		BY	DATE
DATE:	DECEMBER 2009	CAD STANDARDS VERSION:	V8 - 2009	
DESIGNED:	BCC	TECHNICIAN:	BCC	CHECKED: KAC

INFORMATION CONCERNING EXISTING UNDERGROUND UTILITIES WAS OBTAINED FROM AVAILABLE RECORDS. THE CONTRACTOR MUST DETERMINE THE EXACT LOCATION AND ELEVATION OF ALL EXISTING UTILITIES AND UTILITY CROSSINGS BY DIGGING TEST PITS BY HAND, WELL IN ADVANCE OF THE START OF EXCAVATION. CONTACT "MISS UTILITY" AT 1-800-257-7777, 48 HOURS PRIOR TO THE START OF EXCAVATION. IF CLEARANCES ARE LESS THAN SHOWN ON THIS PLAN OR TWELVE (12) INCHES, WHICHEVER IS LESS, CONTACT THE ENGINEER AND THE UTILITY COMPANY BEFORE PROCEEDING WITH CONSTRUCTION. CLEARANCES LESS THAN NOTED MAY REQUIRE REVISIONS TO THIS PLAN.

ZP NO 141 LLC.
111 PRINCESS ST.
WILMINGTON, NC 28401

TAX MAP 66 - F4	ZONING CATEGORY C-S-C
WSSC 200' SHEET 201SE07	
SITE DATUM HORIZONTAL: _____ VERTICAL: _____	



REMOVAL OF HAZARDOUS TREES OR HAZARDOUS LIMBS BY DEVELOPERS OR BUILDERS

THE DEVELOPER AND/OR BUILDER IS RESPONSIBLE FOR THE COMPLETE PRESERVATION OF ALL FORESTED AREAS SHOWN ON THE APPROVED PLAN TO REMAIN UNDISTURBED. ONLY TREES OR PARTS THEREOF DESIGNATED BY THE DEPARTMENT OF ENVIRONMENTAL RESOURCES AS DEAD, DYING, OR HAZARDOUS MAY BE REMOVED.

- A TREE IS CONSIDERED HAZARDOUS IF A CONDITION IS PRESENT WHICH LEADS A LICENSED ARBORIST OR A LICENSED TREE EXPERT TO BELIEVE THAT THE TREE OR A PORTION OF THE TREE HAS A POTENTIAL TO FALL AND STRIKE A STRUCTURE, PARKING AREA, OR OTHER HIGH USE AREA AND RESULT IN A PERSONAL INJURY OR PROPERTY DAMAGE.
- IF A HAZARDOUS CONDITION MAY BE ALLEVIATED BY CORRECTIVE PRUNING, THE LICENSED ARBORIST OR A LICENSED TREE EXPERT MAY PROCEED WITHOUT FURTHER AUTHORIZATION. THE PRUNING MUST BE DONE IN ACCORDANCE WITH THE LATEST EDITION OF THE ANSI A-300 PRUNING STANDARDS (TREE, SHRUB, AND OTHER WOODY PLANT MAINTENANCE - STANDARD PRACTICES).
- CORRECTIVE MEASURES REQUIRING THE REMOVAL OF THE HAZARDOUS TREE OR PORTIONS THEREOF SHALL REQUIRE AUTHORIZATION BY THE BUILDING OR GRADING INSPECTOR IF THERE IS A VALID GRADING OR BUILDING PERMIT FOR THE SUBJECT LOTS OR PARCELS ON WHICH THE TREES ARE LOCATED. ONLY AFTER APPROVAL OF THE APPROPRIATE INSPECTOR, OR MAY THE TREE BE CUT BY CHAINSAW TO NEAR THE EXISTING GROUND LEVEL. THE STUMP MAY NOT BE REMOVED OR COVERED WITH SOIL, MULCH OR OTHER MATERIALS THAT WOULD INHIBIT SPROUTING.

DEBRIS FROM THE TREE REMOVAL OR PRUNING THAT OCCURS WITHIN 35 FEET OF THE WOODLAND EDGE MAY BE REMOVED AND PROPERLY DISPOSED OF BY RECYCLING, CHIPPING OR OTHER ACCEPTABLE METHODS. ALL DEBRIS THAT IS MORE THAN 35 FEET FROM THE WOODLAND EDGE SHALL BE CUT UP TO ALLOW CONTACT WITH THE GROUND, THUS ENCOURAGING DECOMPOSITION. THE SMALLER MATERIALS SHALL BE PLACED INTO BRUSH PILES THAT WILL SERVE AS WILD-LIFE HABITAT.

REMOVAL OF HAZARDOUS TREES, HAZARDOUS LIMBS, NOXIOUS PLANTS, INVASIVE PLANTS OR NON-NATIVE PLANTS IN WOODLAND CONSERVATION AREAS OWNED BY INDIVIDUAL HOMEOWNERS

- IF THE DEVELOPER OR BUILDER NO LONGER HAS AN INTEREST IN THE PROPERTY THE HOME OWNER SHALL OBTAIN A WRITTEN STATEMENT FROM THE LICENSED ARBORIST OR LICENSED TREE EXPERT IDENTIFYING THE HAZARDOUS CONDITION AND THE PROPOSED CORRECTIVE MEASURES PRIOR TO HAVING THE WORK CONDUCTED. THE TREE MAY THEN BE REMOVED BY THE ARBORIST OR TREE EXPERT. THE STUMP SHALL BE CUT AS CLOSE TO THE GROUND AS POSSIBLE AND LEFT IN PLACE. THE REMOVAL OR GRINDING OF THE STUMPS IN THE WOODLAND CONSERVATION AREA IS NOT PERMITTED.

THE REMOVAL OF NOXIOUS, INVASIVE, AND NON-NATIVE PLANT SPECIES FROM THE WOODLAND CONSERVATION AREAS MAY BE DONE WITH THE USE OF HAND-HELD EQUIPMENT ONLY SUCH AS PRUNERS OR A CHAIN SAW. THESE PLANTS MAY BE CUT NEAR THE GROUND AND THE MATERIAL LESS THAN TWO (2) INCHES DIAMETER SHALL BE CUT TO ALLOW CONTACT WITH THE GROUND, THUS ENCOURAGING DECOMPOSITION.

- THE USE OF BROADCAST SPRAYING OF HERBICIDES IS NOT PERMITTED. HOWEVER, THE USE OF HERBICIDES TO DISCOURAGE RE-SPROUTING OF INVASIVE, NOXIOUS, OR NON-NATIVE PLANTS IS PERMITTED IF DONE AS AN APPLICATION OF THE CHEMICAL DIRECTLY TO THE CUT STUMP IMMEDIATELY FOLLOWING CUTTING OF PLANT TOPS. THE USE OF ANY HERBICIDE SHALL BE DONE IN ACCORDANCE WITH THE LABEL INSTRUCTIONS.

NOTE: THE USE OF CHAINSAWS IS EXTREMELY DANGEROUS AND SHOULD NOT BE CONDUCTED WITH POORLY MAINTAINED EQUIPMENT, WITHOUT SAFETY EQUIPMENT, OR BY INDIVIDUALS NOT TRAINED IN THE USE OF THIS EQUIPMENT FOR THE PRUNING AND/OR CUTTING OF TREES.

PROTECTION OF REFORESTATION AND AFFORESTATION AREAS BY DEVELOPERS OR BUILDERS

- REFORESTATION AND AFFORESTATION AREAS SHALL BE PLANTED PRIOR TO THE OCCUPANCY OF THE NEAREST BUILDING OR RESIDENCE. IF PLANTING CANNOT OCCUR DUE TO PLANTING CONDITIONS, THE DEVELOPER OR PROPERTY OWNER SHALL INSTALL THE FENCING AND SIGNAGE IN ACCORDANCE WITH THE APPROVED TYPE II TREE CONSERVATION PLAN. PLANTING SHALL THEN BE ACCOMPLISHED DURING THE NEXT PLANTING SEASON. IF PLANTING IS DELAYED BEYOND THE TRANSFER OF THE PROPERTY TITLE TO THE HOMEOWNER, THE DEVELOPER SHALL OBTAIN A SIGNED STATEMENT FROM THE PURCHASER INDICATING THAT THEY UNDERSTAND THAT THE REFORESTATION AREA IS LOCATED ON THEIR PROPERTY AND THAT REFORESTATION WILL OCCUR DURING THE NEXT PLANTING SEASON. A COPY OF THAT DOCUMENT SHALL BE PRESENTED TO THE GRADING INSPECTOR AND THE ENVIRONMENTAL PLANNING SECTION.

- REFORESTATION AREAS SHALL NOT BE MOVED, HOWEVER, THE MANAGEMENT OF COMPETING VEGETATION AROUND INDIVIDUAL TREES IS ACCEPTABLE.

WOODLAND AREAS NOT COUNTED AS PART OF THE WOODLAND CONSERVATION REQUIREMENTS

- A REVISED TREE CONSERVATION PLAN IS REQUIRED PRIOR TO CLEARING ANY WOODLAND AREA WHICH IS NOT SPECIFICALLY IDENTIFIED TO BE CLEARED ON THE MOST RECENTLY APPROVED TYPE II TREE CONSERVATION (TCP) ON FILE IN THE OFFICE OF THE M-NCPPC, ENVIRONMENTAL PLANNING SECTION, PLANNING DEPARTMENT, 111 PRINCESS ST., 4TH FLOOR, OF THE COUNTY ADMINISTRATION BUILDING AT 14741 GOVERNOR ODEW BOWIE DRIVE, UPPER MARLBORO, MARYLAND 20772. PHONE 301-952-3650. ADDITIONAL MITIGATION WILL BE REQUIRED FOR THE CLEARING OF ALL WOODLANDS BEYOND THAT REFLECTED ON THE APPROVED PLANS. ALTHOUGH CLEARING MAY BE ALLOWED, IT MAY BE SUBJECT TO ADDITIONAL REPLACEMENT REQUIREMENTS, MITIGATION, AND FEES WHICH MUST BE REFLECTED ON TOP REVISIONS APPROVED BY THE M-NCPPC ENVIRONMENTAL PLANNING SECTION.

- HOMEOWNERS OR PROPERTY OWNERS MAY REMOVE TREES LESS THAN TWO (2) INCHES DIAMETER, SHRUBS, AND VINES IN WOODLAND AREAS WHICH ARE SAVED BUT NOT PART OF THE WOODLAND CONSERVATION REQUIREMENTS AFTER ALL PERMITS HAVE BEEN RELEASED FOR THE SUBJECT PROPERTY. THIS AREA MAY NOT BE TILLED OR HAVE OTHER GROUND DISTURBANCES WHICH WOULD RESULT IN DAMAGE TO THE TREE ROOTS. RAKING THE LEAVES AND OVER SEEDING WITH NATIVE GRASSES INCLUDING ANY VARIETY OF KENTUCKY 31 FESCUE IS NOT ACCEPTABLE.

REFORESTATION INSPECTION AND PLANTING NARRATIVE

- REFORESTATION INSPECTION SCHEDULE THERE SHALL BE FIVE INSPECTIONS FOR FOREST CONSERVATION.

- THE FIRST INSPECTION SHALL OCCUR AFTER FLAGGING/TAKING OF THE L.O.D. AND/OR STREAM BUFFERS, AND PRIOR TO ANY CLEARING, GRADING OR SEDIMENT CONTROL MEASURE. THIS INSPECTION IS TO ADDRESS THE ISSUES OF TREE PROTECTION AND SEDIMENT CONTROL. THE DEVELOPER AND REPRESENTATIVES FROM MNCPPC AND MDCFP WILL MEET TO WALK THE PROPOSED LIMITS OF DISTURBANCE AND DETERMINE THE FINAL LOCATIONS OF SEDIMENT CONTROL DEVICES AND TREE PROTECTION DEVICES.
- THE SECOND INSPECTION SHALL OCCUR AFTER PLACEMENT OF SEDIMENT CONTROL DEVICES AND TREE PROTECTION DEVICES AND PRIOR TO CLEARING AND GRADING. THIS INSPECTION IS TO DETERMINE THE COMPLETION AND ADEQUACY OF PROTECTIVE MEASURES.
- THE THIRD INSPECTION SHALL OCCUR PRIOR TO PLANTING IN REFORESTATION AREAS. THIS PRE-PLANTING INSPECTION IS TO MAKE FINAL DECISIONS REGARDING THE BEST IMPLEMENTATION OF THE PLANTING PLAN, INCLUDING, BUT NOT LIMITED TO, THE FINAL PLACEMENT AND SELECTION OF PLANT SPECIES, DETERMINATION OF THE REGENERATION POTENTIAL OF EXISTING PLANTS TO REMAIN, AND A DETERMINATION OF THE BEST EDGE PLANTING TREATMENT. THE PURCHASE AND DELIVERY OF PLANT MATERIALS SHOULD NOT BE MADE UNTIL AFTER THE INSPECTION SINCE A DETERMINATION MAY BE MADE IN THE FIELD TO ALTER THE CHOICE OF PLANT MATERIAL.
- THE FOURTH INSPECTION SHALL OCCUR IMMEDIATELY FOLLOWING THE COMPLETION OF THE REFORESTATION PLANTING. THIS INSPECTION IS TO DETERMINE THE COMPLETION AND ADEQUACY OF THE PLANTING.
- THE FIFTH AND FINAL INSPECTION SHALL OCCUR AT THE COMPLETION OF THE TWO-YEAR MAINTENANCE PROGRAM. THE PURPOSE OF THIS INSPECTION IS TO DETERMINE THE SUCCESS AND ADEQUACY OF THE MAINTENANCE PROGRAM (AND DEER MANAGEMENT PROGRAM). A FINAL DETERMINATION WILL BE MADE AT THIS TIME AS TO WHETHER ADDITIONAL PLANTINGS AND A FURTHER MAINTENANCE PROGRAM ARE NECESSARY.

2. PRE-PLANTING CONSIDERATIONS

- IN AREAS WITH SUBSTANTIAL GROWTH OF INVASIVE GROUND COVER SPECIES, MEASURES SHALL BE TAKEN TO REMOVE AND CONTROL INVASIVES. THE INFESTED AREAS SHOULD BE MOVED PRIOR TO COMMENCEMENT OF PLANTING. NECESSARY WEED CONTROL MEASURES SHOULD BE DETERMINED DURING THE PRE-PLANTING INSPECTION, INCLUDING BUT NOT LIMITED TO MULCHING, PERIODIC MOWING AROUND THE REFORESTATION PLANTINGS, AND FABRIC COVERINGS. THE USE OF CHEMICAL WEED CONTROLS WILL BE LIMITED TO EXTREME CASES AND ONLY WITH PRIOR WRITTEN APPROVAL BY MNCPPC STAFF. WHERE PERIODIC MOWING WILL OCCUR AS A WEED CONTROL MEASURE, THE TYPICAL TREE PLANTING DISTRIBUTION PATTERN SHOULD BE MODIFIED SO AS TO ALLOW ACCESS BY MOWING EQUIPMENT WITHOUT DAMAGE TO PLANTINGS.
- A SOIL ANALYSIS WILL BE CONDUCTED PRIOR TO COMMENCEMENT OF REFORESTATION, ON LAND WHERE EXTENSIVE AGRICULTURAL USE HAS OCCURRED IN THE PAST. TEST PITS WILL BE DUG IN AREAS OF UNDISTURBED SOIL TO DETERMINE IF A FRAGRANT AND LEEB IS PRESENT. IF FRAGRANT AND LEEB IS PRESENT, IT SHOULD BE PIERCED BY AUGURING AND PLANTING HOLES SHOULD BE DUG TO TWICE THE NORMAL DIAMETER FOR THE MATERIAL PLANTED.
- SOILS SHOULD BE TREATED BY INCORPORATING NATURAL MULCH WITHIN THE TOP 12 INCHES, OR AMENDMENTS AS DETERMINED BY THE SOIL ANALYSIS. NATURAL AMENDMENTS, SUCH AS ORGANIC MULCH OR LEAF MOLD COMPOST ARE PREFERRED.
- IF FILL MATERIAL IS USED AT THE PLANTING SITE, IT SHOULD BE CLEAN FILL WITH 12 INCHES OF NATIVE SOIL. STOCKPILING OF NATIVE TOP SOILS MUST BE DONE IN SUCH A WAY THAT THE HEIGHT OF THE PILE DOES NOT DAMAGE THE SEED BANK.

3. PLANT MATERIAL STORAGE

IT IS RECOMMENDED THAT PLANTING OCCUR WITHIN 24 HOURS OF DELIVERY TO THE SITE. PLANT MATERIALS WHICH ARE LEFT UNPLANTED FOR MORE THAN 24 HOURS SHOULD BE PROTECTED FROM DIRECT SUN AND WEATHER AND KEPT MOIST. NURSERY STOCK SHOULD NOT BE LEFT UNPLANTED FOR MORE THAN TWO (2) WEEKS.

4. ON-SITE INSPECTION

PRIOR TO PLANTING, PLANTING STOCK SHOULD BE INSPECTED. PLANTS NOT CONFORMING TO STANDARD NURSERYMAN SPECIFICATIONS FOR SIZE, FORM, VIGOR, ROOTS, TRUNK WOUNDS, INSECTS, AND DISEASE SHOULD BE REPLACED.

5. PLANTING SPECIFICATIONS

- CONTAINER GROWN STOCK: SUCCESSFUL PLANTING OF CONTAINER GROWN STOCK REQUIRES CAREFUL SITE PREPARATION AND INSPECTION OF THE PLANT MATERIAL ROOT SYSTEM. CAUTION IS RECOMMENDED WHEN SELECTING PLANTS GROWN IN A SOIL MEDIUM DIFFERING FROM THAT OF THE PLANTING SITE. THE PLANT SHOULD BE REMOVED FROM THE CONTAINER AND THE ROOTS GENTLY WASHED FROM THE SOILS. IF THE ROOTS ENIRCLE THE ROOT BALL, SUBSTITUTION IS STRONGLY RECOMMENDED. J-SHAPED OR KINKED ROOT SYSTEMS SHOULD ALSO BE NOTED, AND SUBSTITUTED IF NECESSARY. ROOTS MAY NOT BE TRIMMED ON-SITE, DUE TO THE INCREASED CHANCES OF SOIL BORNE DISEASES. THE PLANTING FIELD SHOULD BE PREPARED AS SPECIFIED. NATIVE STOCKPILED SOILS SHOULD BE USED TO BACKFILL PLANTING FIELD. RAKE SOILS EVENLY OVER THE PLANTING FIELD AND COVER WITH 2 TO 4 INCHES OF MULCH.
- BALLED AND BURLAPPED TREES: BALLED AND BURLAPPED TREES MUST BE HANDLED WITH CARE WHILE PLANTING. TREES SHOULD NOT BE PICKED UP BY THE TRUNK OR DROPPED, AS BOTH PRACTICES WILL TEND TO SEPARATE THE TRUNK FROM THE ROOT BALL. PRIOR TO PLANTING, ROOT BALLS SHOULD BE KEPT MOIST.
- PLANTING FIELDS SHOULD BE CREATED EQUAL TO 2.5 TIMES THE DIAMETER OF THE ROOT BALL. USE WATERING TO SETTLE SOIL AMENDMENTS ARE NOT RECOMMENDED IN THE PLANTING FIELD, AS STUDIES HAVE SHOWN THAT ROOTS WILL BE DISCOURAGED TO STAY WITHIN THE AMENDED SOILS. SOILS SHOULD BE RAKED EVENLY OVER THE PLANTING FIELD AND COVERED WITH 2 TO 4 INCHES OF MULCH.
- STAKING OF TREES IS NOT RECOMMENDED EXCEPT IN AREAS OF HIGH WINDS. MOVEMENT IS NECESSARY TO STRENGTHEN THE TRUNK OF THE PLANTED TREE. IF STAKES ARE USED, THEY SHOULD BE REMOVED AFTER THE FIRST GROWING SEASON. WRAPPING IS ALSO NOT RECOMMENDED DUE TO THE INCREASED OPPORTUNITIES FOR INSECT INFESTATION AND DISEASE.

6. POST-PLANTING CONSIDERATIONS

- SOIL STABILIZATION: FOR AREAS OF LARGE-SCALE DISTURBANCE, SOILS MUST BE STABILIZED USING AN ON-TURF-BUILDING COVER OR ENGINEERING FABRIC.
- PROTECTIVE DEVICES: TO PREVENT DAMAGE OF PLANTED AREAS, ALL REFORESTATION AND AFFORESTATION SITES MUST BE POSTED WITH APPROPRIATE SIGNS AND FENCES. CONSTRUCTION EQUIPMENT SHALL BE PROHIBITED IN THESE AREAS.
- IN AREAS WHERE A SIGNIFICANT RISK OF DAMAGE BY DEER IS ANTICIPATED, A DEER MANAGEMENT PROGRAM MUST BE REVIEWED AND APPROVED BY M-NCPPC. ANY SUBSTANTIAL DAMAGE OR DESTRUCTION RESULTING FROM A FAILURE TO COMPLY WITH THE APPROVED DEER MANAGEMENT PROGRAM MUST BE REPAIRED BEFORE REFORESTATION BONDS WILL BE RELEASED.
- SURVIVAL RATE OF REFORESTATION MATERIAL TO BE 100% AT THE END OF THE SECOND GROWING SEASON.

TYPE II TREE CONSERVATION PLAN NOTES

- CUTTING OR CLEARING OF WOODLAND NOT IN CONFORMANCE WITH THIS PLAN OR WITHOUT THE EXPRESSED WRITTEN CONSENT OF THE PLANNING DIRECTOR OR DESIGNEE SHALL BE SUBJECT TO A \$1.50 PER SQUARE FOOT MITIGATION FEE.
- THE DEPARTMENT OF ENVIRONMENTAL RESOURCES (DER) MUST BE CONTACTED PRIOR TO THE START OF ANY WORK ON THE SITE TO ADDRESS IMPLEMENTATION OF TREE CONSERVATION MEASURES SHOWN ON THIS PLAN.
- PROPERTY OWNERS SHALL BE NOTIFIED BY THE DEVELOPER OR CONTRACTOR OF ANY WOODLAND CONSERVATION AREAS (TREE SAVE AREAS, REFORESTATION AREAS, AFFORESTATION AREAS, OR SELECTIVE CLEARING AREAS) LOCATED ON THEIR LOT OR PARCEL OF LAND AND THE ASSOCIATED FINES FOR UNAUTHORIZED DISTURBANCE TO THESE AREAS. UPON THE SALE OF THE PROPERTY THE OWNER/DEVELOPER OR OWNERS REPRESENTATIVE SHALL NOTIFY THE PURCHASER OF THE PROPERTY OF ANY WOODLAND CONSERVATION AREAS.
- ALL APPROPRIATE BONDS SHALL BE POSTED WITH THE BUILDING OFFICIAL PRIOR TO THE ISSUANCE OF ANY PERMITS. THESE BONDS WILL BE RETAINED AS SURETY BY THE BUILDING OFFICIAL UNTIL ALL REQUIRED ACTIVITIES HAVE BEEN SATISFIED.
- ALL REQUIRED OFF-SITE MITIGATION SHALL BE IDENTIFIED ON AN APPROVED TOPCI FOR THE OFF-SITE LOCATION AND SHALL BE RECORDED AS AN OFF-SITE EASEMENT IN THE LAND RECORDS OF PRINCE GEORGE'S COUNTY PRIOR TO THE ISSUANCE OF ANY PERMITS FOR THE SUBJECT PROPERTY.
- THE LOCATION OF ALL TREE PROTECTIVE DEVICES (TPDs) SHOWN ON THIS PLAN SHALL BE FLAGGED OR STAKED IN THE FIELD PRIOR TO THE PRE-CONSTRUCTION MEETING WITH THE SEDIMENT AND EROSION CONTROL INSPECTOR.
- THE FIELD PRIOR TO THE PRE-CONSTRUCTION MEETING WITH THE SEDIMENT AND EROSION CONTROL INSPECTOR, INSTALLATION OF THE TPD'S MAY BEGIN. TPD INSTALLATION SHALL BE COMPLETED PRIOR TO INSTALLATION OF INITIAL SEDIMENT CONTROLS. NO CUTTING OR CLEARING OF TREES MAY BEGIN BEFORE FINAL APPROVAL OF TPD INSTALLATION.
- WOODLAND CONSERVATION - TREE SAVE AREAS AND/OR REFORESTATION AREAS SHALL BE POSTED AS SHOWN AT THE SAME TIME AS TREE PROTECTIVE DEVICE INSTALLATION AND/OR START OF REFORESTATION ACTIVITIES. THESE SIGNS SHALL REMAIN IN PLACE IN PERPETUITY.
- ALL TREE PLANTINGS FOR WOODLAND REPLACEMENT, REFORESTATION OR AFFORESTATION WILL BE COMPLETED AFFORESTATION WITHIN THE PRESCRIBED TIME FRAME. WILL RESULT IN THE FORFEITURE OF THE REFORESTATION BOND AND/OR A VIOLATION OF THIS PLAN INCLUDING THE ASSOCIATED \$1.50 PER SQUARE FOOT PENALTY UNLESS A WRITTEN EXTENSION IS APPROVED BY THE DER INSPECTOR.
- THE DER INSPECTOR SHALL BE NOTIFIED PRIOR TO SOIL PREPARATION OR INITIATION OF ANY TREE PLANTING ON THIS SITE.
- RESULTS OF SURVIVAL CHECKS FOR ALL TREE PLANTINGS SHALL BE REPORTED TO THE DER INSPECTOR FOR THAT SITE.
- PRIOR TO THE ISSUANCE OF ANY PERMITS THE CONTRACTOR RESPONSIBLE FOR SOIL PREPARATION, SITE PREPARATION, TREE PLANTING AND TREE MAINTENANCE MUST BE IDENTIFIED.

BUSINESS NAME _____
ADDRESS _____
PHONE NUMBER _____

TREE/WOODLAND CONSERVATION AREA MANAGEMENT GUIDANCE FOR HOMEOWNERS

PREPARED BY THE ENVIRONMENTAL PLANNING SECTION, PLANNING DEPARTMENT, M-NCPPC

REMOVAL OF HAZARDOUS TREES, HAZARDOUS LIMBS, NOXIOUS PLANTS, INVASIVE PLANTS OR NON-NATIVE PLANTS IN WOODLAND CONSERVATION AREAS OWNED BY INDIVIDUAL HOMEOWNERS

- IF THE DEVELOPER OR BUILDER NO LONGER HAS AN INTEREST IN THE PROPERTY THE HOMEOWNER SHALL OBTAIN A WRITTEN STATEMENT FROM THE LICENSED ARBORIST OR LICENSED TREE EXPERT IDENTIFYING THE HAZARDOUS CONDITION AND THE PROPOSED CORRECTIVE MEASURES PRIOR TO HAVING THE WORK CONDUCTED. THE TREE MAY THEN BE REMOVED BY THE ARBORIST OR TREE EXPERT. THE STUMP SHALL BE CUT AS CLOSE TO THE GROUND AS POSSIBLE AND LEFT IN PLACE. THE REMOVAL OR GRINDING OF THE STUMPS IN THE WOODLAND CONSERVATION AREA IS NOT PERMITTED.

- THE REMOVAL OF NOXIOUS, INVASIVE, AND NON-NATIVE PLANT SPECIES FROM THE WOODLAND CONSERVATION AREAS MAY BE DONE WITH THE USE OF HAND-HELD EQUIPMENT ONLY SUCH AS PRUNERS OR A CHAIN SAW. THESE PLANTS MAY BE CUT NEAR THE GROUND AND THE MATERIAL LESS THAN TWO INCHES IN DIAMETER MAY BE REMOVED FROM THE AREA AND DISPOSED OF APPROPRIATELY. ALL MATERIAL FROM THESE NOXIOUS, INVASIVE, AND NON-NATIVE PLANTS GREATER THAN TWO (2) INCHES DIAMETER SHALL BE CUT TO ALLOW CONTACT WITH THE GROUND, THUS ENCOURAGING DECOMPOSITION.

- THE USE OF BROADCAST SPRAYING OF HERBICIDES IS NOT PERMITTED. HOWEVER, THE USE OF HERBICIDES TO DISCOURAGE RE-SPROUTING OF INVASIVE, NOXIOUS, OR NON-NATIVE PLANTS IS PERMITTED IF DONE AS AN APPLICATION OF THE CHEMICAL DIRECTLY TO THE CUT STUMP IMMEDIATELY FOLLOWING CUTTING OF PLANT TOPS. THE USE OF ANY HERBICIDE SHALL BE DONE IN ACCORDANCE WITH THE LABEL INSTRUCTIONS.

- NOTE: THE USE OF CHAINSAWS IS EXTREMELY DANGEROUS AND SHOULD NOT BE CONDUCTED WITH POORLY MAINTAINED EQUIPMENT, WITHOUT SAFETY EQUIPMENT, OR BY INDIVIDUALS NOT TRAINED IN THE USE OF THIS EQUIPMENT FOR THE PRUNING AND/OR CUTTING OF TREES.
- EXCEPT FOR THE REMOVAL OF HAZARDOUS TREES OR LIMBS AS DESCRIBED ABOVE, A REVISED TREE CONSERVATION PLAN IS REQUIRED PRIOR TO CLEARING ANY WOODLAND AREA WHICH IS NOT SPECIFICALLY IDENTIFIED TO BE CLEARED ON THE MOST RECENTLY APPROVED TYPE II TREE CONSERVATION (TCP) ON FILE IN THE OFFICE OF THE COUNTY ENVIRONMENTAL PLANNING SECTION LOCATED ON THE 4TH FLOOR OF THE COUNTY ADMINISTRATION BUILDING AT 14741 GOVERNOR ODEW BOWIE DRIVE, UPPER MARLBORO, MARYLAND 20772. PHONE 301-952-3650. ADDITIONAL MITIGATION WILL BE REQUIRED FOR THE CLEARING OF ALL WOODLANDS BEYOND THAT REFLECTED ON THE APPROVED PLANS. ALTHOUGH CLEARING MAY BE ALLOWED, IT MAY BE SUBJECT TO ADDITIONAL REPLACEMENT REQUIREMENTS, MITIGATION, AND FEES WHICH MUST BE REFLECTED ON TOP REVISIONS APPROVED BY THE M-NCPPC ENVIRONMENTAL PLANNING SECTION.

PREPARED: APRIL 21, 2003

FIGURE J-1

ROOT PRUNING NOT TO SCALE

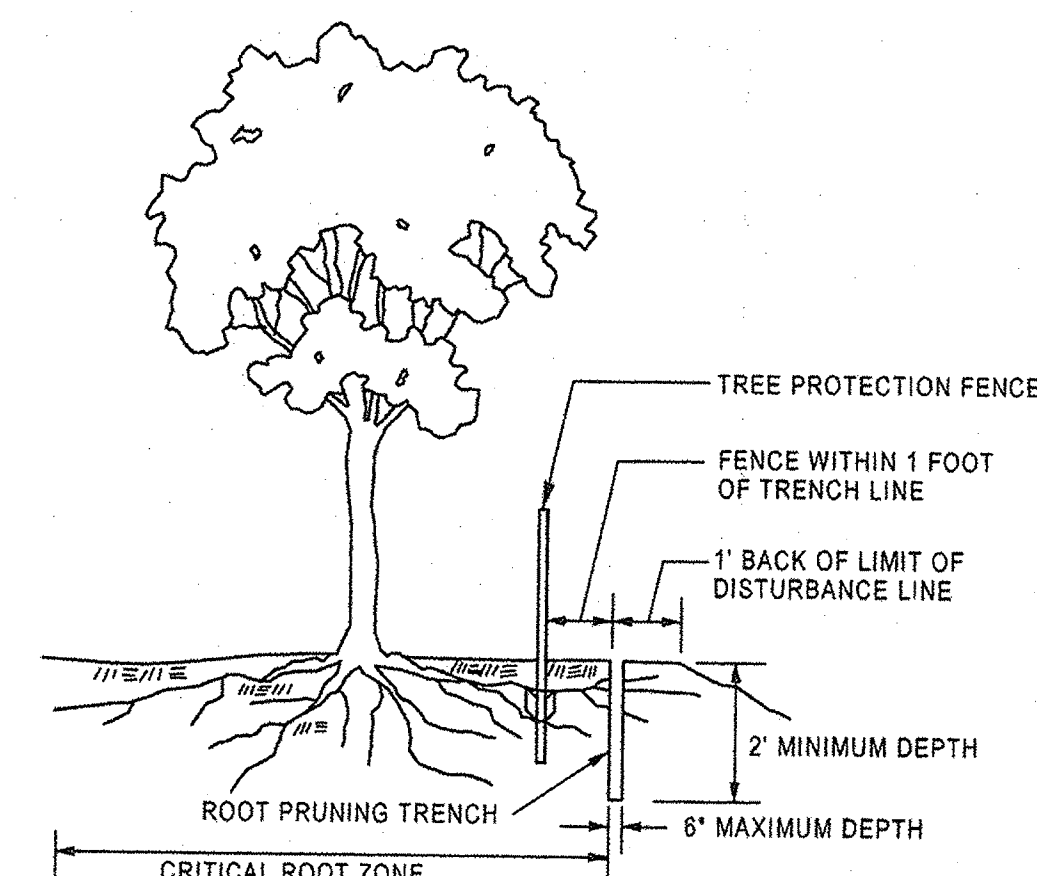

- NOTES:
- RETENTION AREA WILL BE SET AS PART OF THE REVIEW PROCESS.
 - BOUNDARIES OF RETENTION AREA SHOULD BE STAKED AND FLAGGED PRIOR TO TRENCHING.
 - EXACT LOCATION OF TRENCH SHOULD BE IDENTIFIED.
 - TRENCH SHOULD BE IMMEDIATELY BACKFILLED WITH SOIL REMOVED OR OTHER HIGH ORGANIC SOIL.
 - ROOTS SHOULD BE CLEANLY CUT USING VIBRATORY KNIFE OR OTHER ACCEPTABLE EQUIPMENT.

SOURCE: CITY OF GAITHERSBURG, MD: CITY TREE MANUAL AND THE MD DNR FOREST CONSERVATION MANUAL 1991

AFFORESTATION / REFORESTATION TYPICAL DETAIL NOT TO SCALE

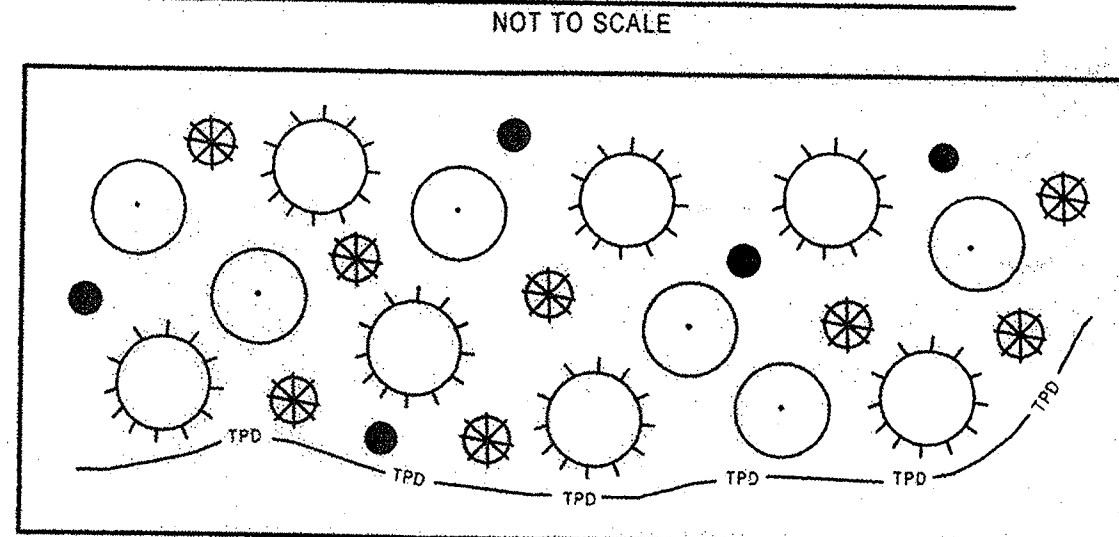

TYPICAL PLANTING LEGEND

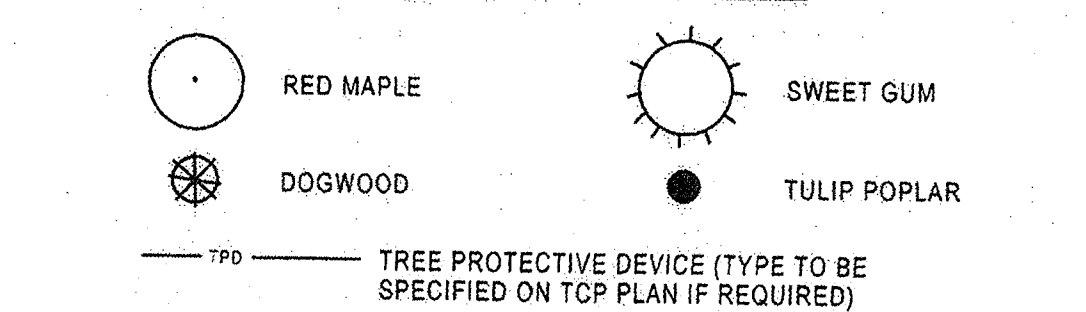

PLANT LIST/RATIO FOR SEEDLINGS

REFORESTATION AREA PROVIDED	TOTAL PER MANUAL	TOTAL THIS PLAN
SPECIES	NUMBER/ACRE	NUMBER/ACRE
RED MAPLE	330 SEEDLINGS	1333 SEEDLINGS
TULIP POPULAR	330 SEEDLINGS	1333 SEEDLINGS
SWEET GUM	230 SEEDLINGS	929 SEEDLINGS
DOGWOOD	110 SEEDLINGS	445 SEEDLINGS
TOTAL PROVIDED	1000 SEEDLINGS	4040 SEEDLINGS

NOTES:

- 1000 SEEDLINGS REQUIRED PER ACRE OF REFORESTATION/AFFORESTATION
- USE BARE ROOT WHIPS TO FULFILL PLANTING REQUIREMENTS

NOTES:

- THE SIGNS NOTIFIED CONSTRUCTION WORKERS AND FUTURE RESIDENTS OF THE NEWLY PLANTED MATERIAL, IMPROVING THE TREES' SURVIVAL RATES.
- SIGNS MAY BE ADAPTED BY RESIDENTS FOR IDENTIFICATION OF FOREST RETENTION AREAS IN LONG TERM.

Source: Adapted from Forest Conservation Manual, 1991

REFORESTATION AND AFFORESTATION AREA SIGNS

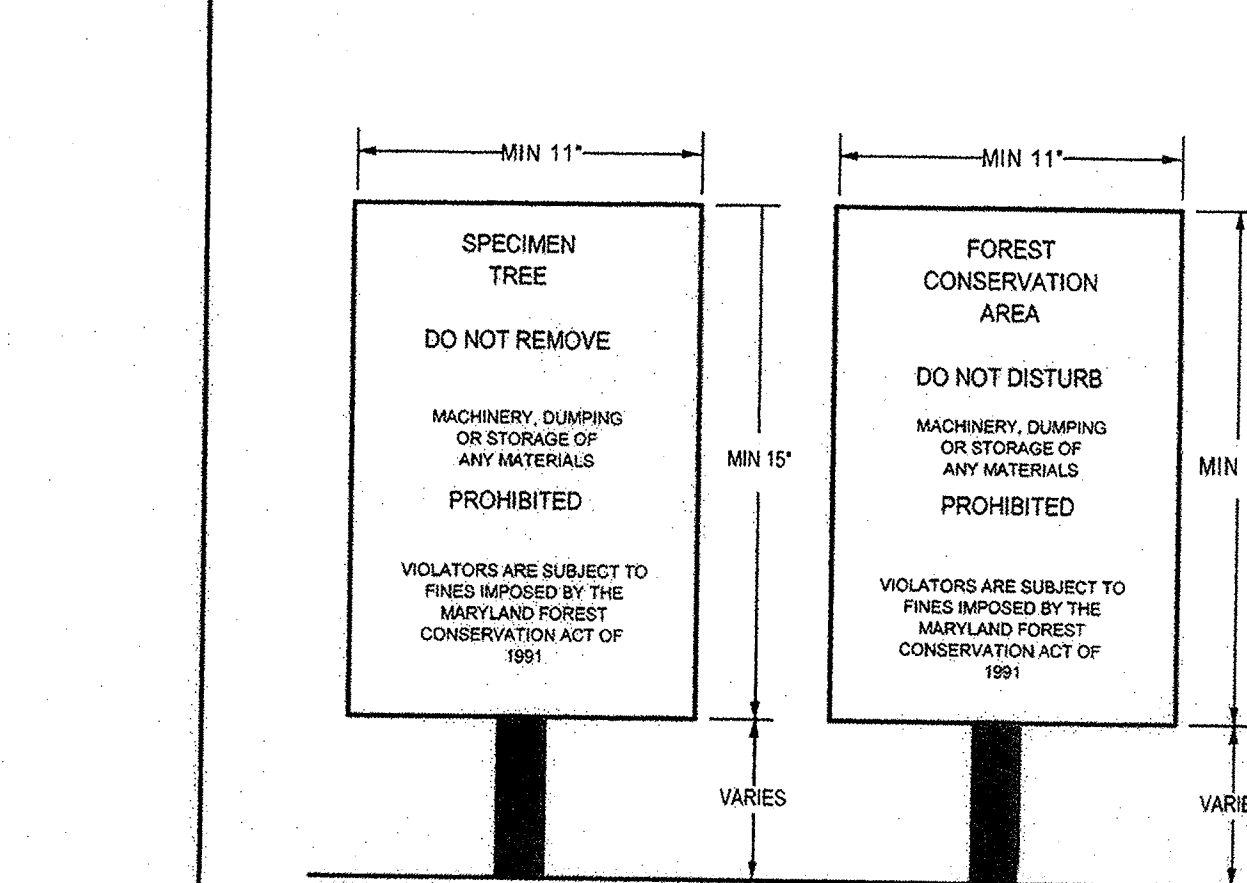

- NOTES:
- BOTTOM OF SIGNS TO BE HIGHER THAN TOP OF TREE PROTECTION FENCE.
 - SIGNS TO BE PLACED APPROXIMATELY 50' APART. CONDITIONS ON SITE AFFECTING VISIBILITY MAY WARRANT PLACING SIGNS CLOSER OR FARTHER APART.
 - ATTACHMENT OF SIGNS TO TREES IS PROHIBITED.

SOURCE: ADAPTED FROM FOREST CONSERVATION MANUAL, 1991

CONSTRUCTION SIGNS

FIGURE D-4

FIGURE 3.6.5

SEEDLING PLANTING METHODS

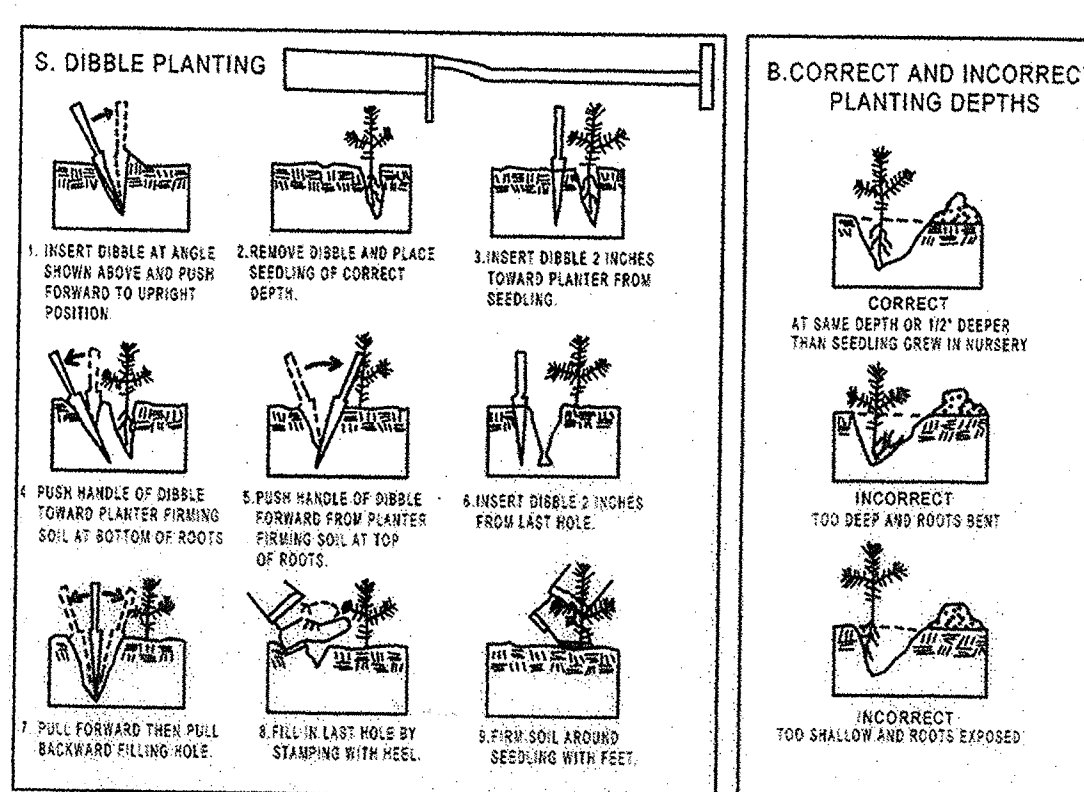

SEEDLING AND WHIPS NEED SPECIAL CARE WHEN PLANTED. FIGURE 3.6.5 DETAILS THE RECOMMENDED MANUAL PLANTING PROCEDURES WHICH INCLUDE CORRECT PLANTING DEPTHS (B) AS WELL AS METHODS FOR TWO DIFFERENT PLANTING TOOLS: THE DIBBLE (A) AND THE MATTOCK (C).

TPD-G OPTION 3

TREE PROTECTIVE DEVICE

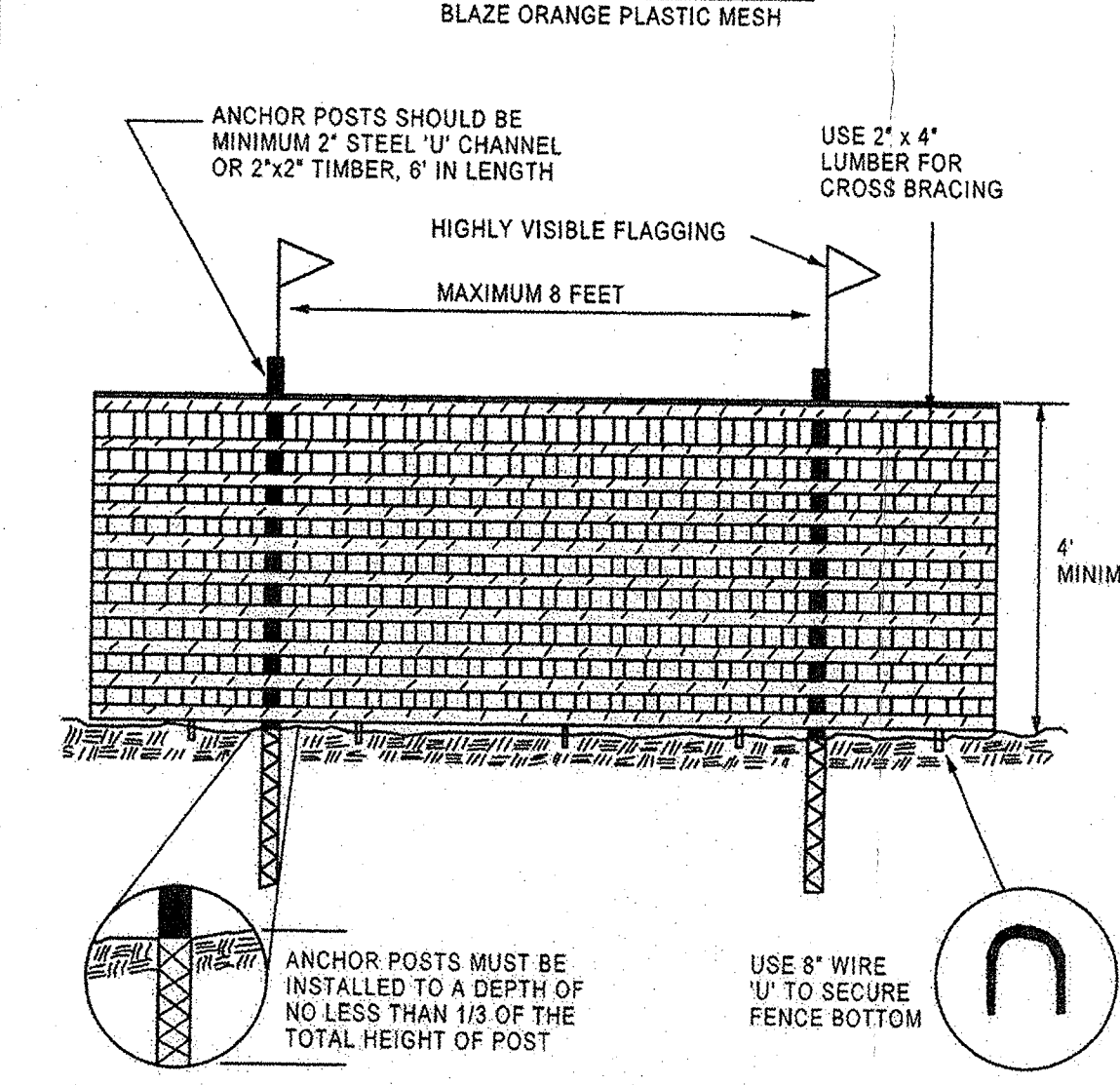

NOTES:

- LIMITS OF DISTURBANCE WILL BE SET AS PART OF THE REVIEW PROCESS FOR AN APPROVED TCP.
- THE BOUNDARIES OF THE LIMITS OF DISTURBANCE SHOULD BE STAKED AND FLAGGED PRIOR TO ERECTING THE PROTECTIVE DEVICES.
- ANCHOR POSTS SHOULD BE PLACED TO AVOID SEVERING OR DAMAGING LARGE TREE ROOTS.
- FENCING MATERIAL SHOULD BE FASTENED SECURELY TO THE ANCHOR POSTS, CROSS BRACING, AND GROUND.

FIGURE E-4: GENERALIZED GRAPHIC REPRESENTATION OF INFORMATION NEEDED FOR ROOT MASS RADIUS CALCULATIONS.

DSP - 06015

APPROVED PLAN

M-NCPPC APPROVALS			
PROJECT NAME: <i>Capitol Heights Shopping Ctr</i>			
PROJECT NUMBER: <i>DSP-06015</i>			
FOR CONDITIONS OF APPROVAL, SEE SITE PLAN COVER SHEET OR APPROVAL SHEET			
REVISED LISTED BELOW APPLY TO THIS SHEET			
APPROVAL OR REVISION #	APPROVAL DATE	REVIEWER'S INITIALS	CERTIFICATION DATE
01	02	03	04
05			

TREE CONSERVATION PLAN - TYPE II

CAPITOL HEIGHTS SHOPPING CENTER

SEAT PLEASANT (19th) ELECTION DISTRICT, PRINCE GEORGE'S COUNTY, MARYLAND