

SHEET INDEX

1. PLAN VIEW
2. DETAIL SHEET

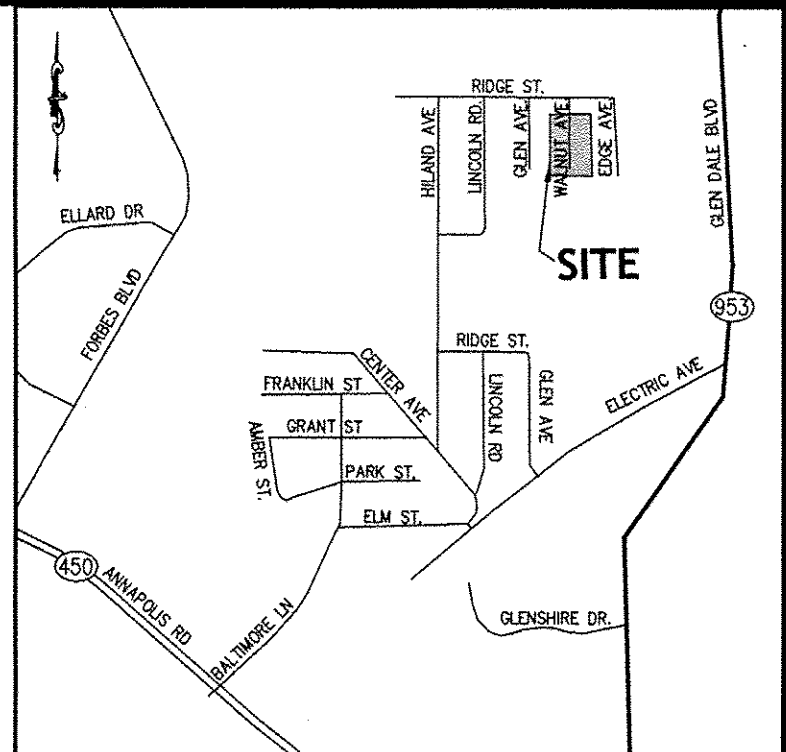

VICINITY MAP
SCALE: 1" = 200'
ADC PG. CO. MAP: MAP 5411, GRID K5
200' SHEET 208 NE 10
PRINCE GEORGE'S COUNTY
TAX MAP 45 GRID C-1

TCP GENERAL NOTES

- THIS PLAN IS SUBMITTED TO FULFILL THE WOODLAND CONSERVATION REQUIREMENTS FOR A GRADING PERMIT. IF THIS GRADING PERMIT EXPIRES, THEN THIS TCP2 ALSO EXPIRES AND IS NO LONGER VALID.
- CUTTING OR CLEARING OF WOODLAND NOT IN CONFORMANCE WITH THIS PLAN OR WITHOUT THE EXPRESSED WRITTEN CONSENT OF THE PLANNING DIRECTOR OR DESIGNEE SHALL BE SUBJECT TO A \$9.00 PER SQUARE FOOT MITIGATION FEE.
- A PRE-CONSTRUCTION MEETING IS REQUIRED PRIOR TO THE ISSUANCE OF GRADING PERMITS. THE DEPARTMENT OF PERMITS, INSPECTIONS AND ENFORCEMENT SHALL BE CONTACTED PRIOR TO THE START OF ANY WORK ON THE SITE TO CONDUCT A PRE-CONSTRUCTION MEETING IMPLEMENTATION OF WOODLAND CONSERVATION MEASURES SHOWN ON THIS PLAN WILL BE DISCUSSED IN DETAIL.
- THE DEVELOPER OR BUILDER OF THE LOTS OR PARCELS SHOWN ON THIS PLAN SHALL NOTIFY FUTURE BUYERS OF ANY WOODLAND CONSERVATION AREAS THROUGH THE PROVISION OF A COPY OF THIS PLAN AT TIME OF CONTRACT SIGNING. FUTURE PROPERTY OWNERS ARE ALSO SUBJECT TO THIS REQUIREMENT.
- THE OWNERS OF THE PROPERTY SUBJECT TO THIS TREE CONSERVATION PLAN ARE SOLELY RESPONSIBLE FOR CONFORMANCE TO THE REQUIREMENTS CONTAINED HEREIN.
- THE PROPERTY IS WITHIN ENVIRONMENTAL STRATEGY AREA ESA 2 AND IS ZONE R-R.
- THE SITE IS NOT ADJACENT TO A ROADWAY DESIGNATED AS SCENIC, HISTORIC, A PARKWAY OR A SCENIC BYWAY.
- THE SITE IS NOT ADJACENT TO A ROADWAY CLASSIFIED AS ARTERIAL OR GREATER.
- THIS PLAN IS NOT GRANDFATHERED UNDER CB-27-2010, SECTION 25-117 (G).
- PRIOR TO THE ISSUANCE OF THE FIRST PERMIT FOR THE DEVELOPMENT SHOWN ON THIS TCP2, ALL OFF-SITE WOODLAND CONSERVATION REQUIRED BY THIS PLAN SHALL BE IDENTIFIED ON AN APPROVED TCP2 PLAN AND RECORDED AS AN OFF-SITE EASEMENT IN THE LAND RECORDS OF PRINCE GEORGE'S COUNTY. PROOF OF RECORDED OF THE OFF-SITE CONSERVATION SHALL BE PROVIDED TO THE M-NCPPC PLANNING DEPARTMENT PRIOR TO ISSUANCE OF ANY PERMIT FOR THE ASSOCIATED PLAN.
- THE PREVIOUSLY DEDICATED LAND (0.73 ACRES) ON THIS SITE IS THE RIGHT OF WAY FOR LINCOLN WALNUT AVENUE AS WELL AS DEDICATION FOR THE PUBLIC ALLEYS THAT HAVE ALREADY BEEN DEDICATED FOR PUBLIC USE.

LEGEND

| | CdD2 | SOILS |
|----------------------------|----------------------------|--------------------------------------|
| BOUNDARY | EX. ROW | EX. WATER |
| EX. ROW | EX. 8" S | EX. SANITARY SEWER |
| BRL | EX. 8" S | EX. STORM DRAIN |
| PUE | EX. 10" CONTOUR | EX. STRUCTURES |
| EASEMENTS | EX. SPOT ELEVATION | EX. GAS MAIN |
| EX. 2" CONTOUR | PROP. 2" CONTOUR | EX. OVERHEAD ELECTRIC LINE |
| EX. 10" CONTOUR | PROP. 10" CONTOUR | EX. ROAD |
| EX. SPOT ELEVATION | STREAMS | CENTERLINE |
| PROP. 2" CONTOUR | STREAM BUFFER | PROPOSED STREET LIGHT |
| PROP. 10" CONTOUR | WETLANDS | PROP. PAVEMENT |
| STREAMS | WETLANDS 25' BUFFER | PROP. CONCRETE |
| STREAM BUFFER | PROP. LIMIT OF DISTURBANCE | EXIST. TREE-2 |
| WETLANDS | PROP. STORM DRAIN | SPECIMEN TREE AND CRITICAL ROOT ZONE |
| WETLANDS 25' BUFFER | EX. TREE LINE | |
| PROP. LIMIT OF DISTURBANCE | | |
| PROP. STORM DRAIN | | |
| EX. TREE LINE | | |

TCP LEGEND

| | |
|--|---|
| WOODLAND TO REMAIN - COUNTED AS CLEARED | OFF-SITE TREE CLEARING |
| TREE PROTECTION FENCE - BLAZE ORANGE PLASTIC MESH FENCE (TO BE USED WHEN AN EXTERIOR SEDIMENT CONTROL DEVICE IS NOT PRESENT) | TREE PROTECTION FENCE TYPE 4 - TEMPORARY TREE PROTECTION FENCE COMBINATION SILT FENCE & TREE PROTECTION |

| LINCOLN SUBDIVISION - TCP TYPE II - AREA TABULATIONS | | | |
|--|------|-----------------------|------|
| TREE PRESERVATION COUNTED AS CLEARED (AC) | | OFFSITE CLEARING (AC) | |
| AREA 'A' | 0.12 | AREA 1 | 0.05 |
| AREA 'B' | 0.08 | | |
| AREA 'C' | 0.14 | | |
| TOTAL | 0.34 | TOTAL | 0.05 |

| SOILS DATA | | | | |
|------------|--|----------|-------------------------|------------------------|
| Symbol | Soil Name | K-Factor | Drainage Class | Hydrologic Soils Group |
| CcD | Christiana-Downer complex, 10-15% slopes | 0.49 | Moderately well drained | C |
| RcB | Russet-Christiana complex, 2-5% slopes | 0.28 | Moderately well drained | C |

| Specimen, Champion, and Historic Tree Table: | | | | | | |
|--|-------------|-----------------|--------------|------------------|--------------------|-------------------|
| NO. | Common Name | Scientific Name | DBH (Inches) | Condition Rating | Condition Comments | Final Disposition |
| 3 | White Oak | Quercus alba | 31" | Fair | Split Trunk | To Be Removed |
| 4 | White Oak | Quercus alba | 33.5" | Poor | Silime Flux | To Be Removed |
| The trees were were survey located | | | | | | |

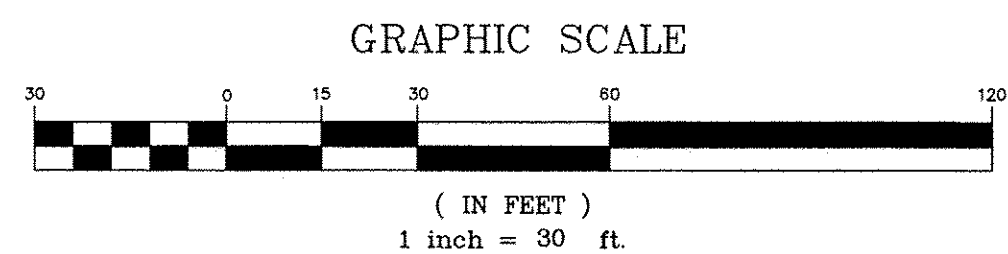

CALL "MISS UTILITY"
TELEPHONE: 1-800-257-7777 FOR UTILITY LOCATIONS AT LEAST 48 HOURS BEFORE BEGINNING CONSTRUCTION.

M-NCPPC
Prince George's County Planning Department
Environmental Planning Section
APPROVAL
TREE CONSERVATION PLAN
TCP 2-017-15
Approved by: *Mass. Juh* Date: 3-7-2016

| DESIGNED | | 12/15 | | REVISIONS | |
|----------|-----|----------|-----|-----------|--|
| DATE | EMD | DATE | BY | DATE | DESCRIPTIONS |
| 12/15 | MAM | 9-15-15 | MAM | 12/15 | REVISED PER MNCPPC COMMENTS, UPDATED NOTES, ADDED SED. CONTROL EXTERIOR DEVICES, REVISED GRADING AND LOD |
| 12/15 | KLM | 11-20-15 | MAM | 12/15 | REV. PER MNCPPC COMMENTS, TYPE 4 FENCE, LOD OUT OF ROW |
| 12/15 | DAD | | | | |



201 Defense Highway
Suite 200
Annapolis, MD 21401
Ph. (443) 274-3232
Fax (443) 274-3233
Contact Person: D. Andrew Doresey
Chief Engineer
adoresey@techgroupinc.net

ADDRESS OF PROPERTY
5718, 5724, 5727, 5728, 5729 & 5731
WALNUT AVENUE
LANHAM, MD 20706

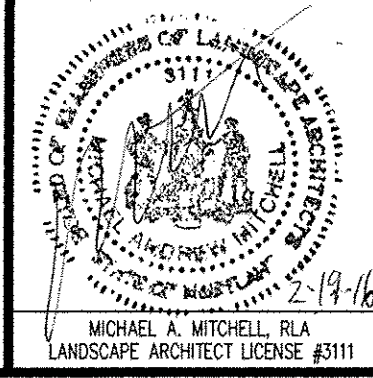

APPLICANT
W.F. CHESLEY REAL ESTATES, LLC
1641 ROUTE 3 NORTH, SUITE 202
CROFTON, MD 21114
PHONE: 301 261-6700
C/O RUSSELL BAKER
RUSSELL@WFCHESELEY.COM

OWNERS/DEVELOPERS
WESTPOINT, LLC
WFC FLAGSHIP, LLC
1641 ROUTE 3 NORTH, SUITE 202
CROFTON, MD 21114
PHONE: 301 261-6700
C/O RUSSELL BAKER
RUSSELL@WFCHESELEY.COM

TREE CONSERVATION PLAN - TYPE II
PLAN VIEW

LINCOLN SUBDIVISION

LOTS 8R, 9R, 12R - 14R, 40R & 41R, BLOCKS Q & R, WALNUT AVENUE
PRINCE GEORGE'S COUNTY, MARYLAND
20TH/LANHAM ELECTION DISTRICT
TAX MAP 45, GRID C1. TAX ACCT. #S 1686971, 1686989, 1612043, 1649524, 1694132, 1580901

SCALE: 1" = 30' DATE: FEBRUARY 2016 TTG PROJECT No. 514018 SHEET 1 OF 2

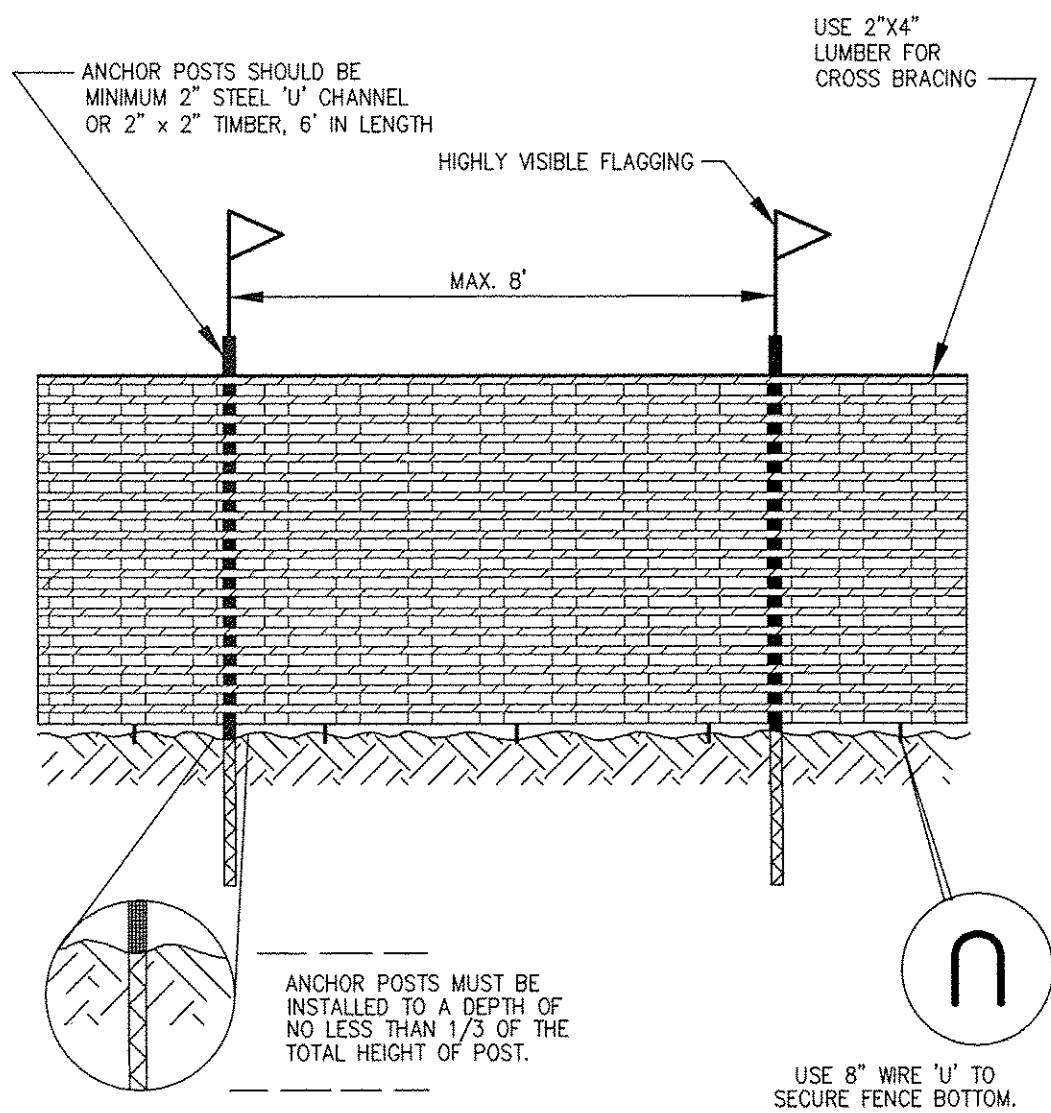

NOTES

1. FOREST PROTECTION DEVICE ONLY.
2. RETENTION AREA WILL BE SET AS PART OF THE REVIEW PROCESS.
3. BOUNDARIES OF RETENTION AREA SHOULD BE STAKED AND FLAGGED PRIOR TO INSTALLED DEVICE.
4. ROOT DAMAGE SHOULD BE AVOIDED.
5. PROTECTIVE SIGNAGE MAY ALSO BE USED.
6. DEVICE SHOULD BE MAINTAINED THROUGHOUT CONSTRUCTION.

TPF - BLAZE ORANGE PLASTIC MESH FENCING

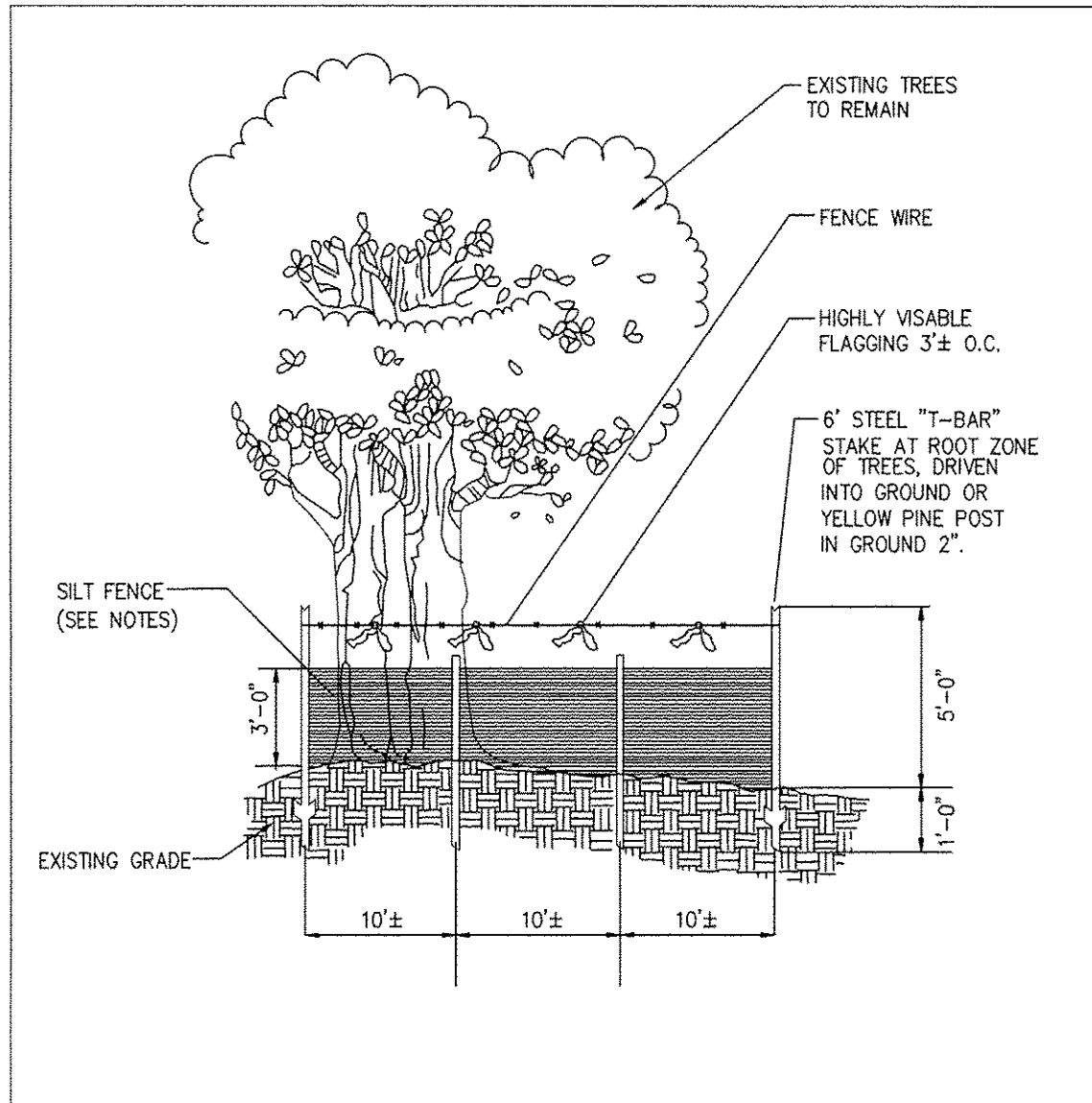

NOTES:

1. SILT FENCE TO BE HEELED INTO SOIL.
2. WIRE, SNOW FENCE, ETC. FOR TREE PROTECTION ONLY.
3. BOUNDARIES OF RETENTION AREA WILL BE ESTABLISHED AS PART OF THE TREE CONSERVATION PLAN REVIEW PROCESS.
4. BOUNDARIES OF RETENTION AREA SHOULD BE STAKED AND FLAGGED PRIOR TO INSTALLING DEVICE.
5. AVOID ROOT DAMAGE WHEN PLACING ANCHOR POSTS.
6. DEVICE SHOULD BE PROPERLY MAINTAINED THROUGHOUT CONSTRUCTION.
7. PROTECTION SIGNS ARE ALSO REQUIRED.
8. LOCATE FENCE OUTSIDE THE CRITICAL ROOT ZONE.

TYPE 4 (TEMPORARY) TREE PROTECTION FENCE COMBINATION SILT FENCE & TREE PROTECTION

August 2010

A-4, DET-8

Standard Woodland Conservation Worksheet for Prince George's County

| SECTION I-Establishing Site Information- (Enter acres for each zone) | | | | |
|--|------|------|------|--|
| 1 Zone: | R-R | | | |
| 2 Gross Tract: | 2.45 | | | |
| 3 Floodplain: | 0.00 | | | |
| 4 Previously Dedicated Land: | 0.73 | | | |
| 5 Net Tract (NTA): | 1.72 | 0.00 | 0.00 | |

| | | | |
|--|---|------------|---|
| 6 TCP Number | | Revision # | 0 |
| 7 Property Description or Subdivision Name: | Lincoln Subdivision - contains previously dedicated ROW | | |
| 8 Is this site subject to the 1989 Ordinance?(Y/N) | N | | |
| 9 Is this one (1) single family lot? (Y/N) | N | | |
| 10 Are there prior TCP approvals which include a | N | | |
| 11 combination of this lot/s? (Y/N) | N | | |
| 12 Is any portion of the property in a WC Bank? | N | | |
| 13 Break-even Point (preservation) = | 0.71 acres | | |
| 14 Clearing permitted w/o reforestation = | 1.44 acres | | |

| SECTION II-Determining Requirements (Enter acres for each corresponding column) | | | | |
|---|-----------------------|-----------------------|---------------------------------|---------------------------------------|
| | Column A WCT/AFT % | Column B Net Tract | Column C Floodplain (1:1) | Column D Off-Site Impacts (1:1) |
| 15 Existing Woodland | | 2.15 | | |
| 16 Woodland Conservation Threshold (WCT) = | 20.00% | 0.34 | 0.00 | |
| 17 Smaller of 13 or 14 | | 0.34 | | |
| 18 Woodland above WCT | | 1.81 | | |
| 19 Woodland cleared | | 2.15 | 0.00 | 0.050 |
| 20 Woodland cleared above WCT (smaller of 16 or 17) | | 1.81 | | |
| 21 Clearing above WCT (0.25 : 1) replacement requirement | | 0.45 | | |
| 22 Woodland cleared below WCT | | 0.34 | | |
| 23 Clearing below WCT (2:1 replacement requirement) | | 0.69 | | |
| 24 Afforestation Required | | 0.00 | | |
| 25 Off-site WCA being provided on this property | Threshold (AFT) = | 15.00% | | |
| 26 Woodland Conservation Required | | 1.190 | | |

| SECTION III-Meeting the Requirements (Enter acres for each corresponding column) | | | | |
|--|------|------|-----------------|--------|
| 27 Woodland Preservation | | 0.00 | | |
| 28 Afforestation / Reforestation | | 0.00 | Bond amount: \$ | - |
| 29 Natural Regeneration | | 0.00 | | |
| 30 Landscape Credits | | 0.00 | | |
| 30 Specimen/Historic Tree Credit (CRZ area * 2.0) | 0.00 | 0.00 | | |
| 31 Forest Enhancement Credit (Area * .25) | 0.00 | 0.00 | | |
| 32 Street Tree Credit (Existing or 10-year canopy coverage) | | 0.00 | | |
| 33 Area approved for fee-in-lieu/PFA (Priority Funding Area) | | 0.00 | Fee amount: | \$0.00 |
| 34 Area approved for fee-in-lieu/non-PFA | | 0.00 | Fee amount: | \$0.00 |
| 35 Off-site Woodland Conservation Credits Required | | 1.19 | | |
| 36 Off-site WCA (preservation) being provided on this property | | 0.00 | | |
| 37 Off-site WCA (afforestation) being provided on this property | | 0.00 | | |
| 38 Woodland Conservation Provided | | 1.19 | | |

| | |
|--|------------|
| 39 Area of woodland not cleared | 0.00 acres |
| 40 Net tract woodland retained not part of requirements: | 0.00 acres |
| 41 100-floodplain woodland retained: | 0.00 acres |
| 42 On-site woodland conservation provided | 0.00 acres |
| 43 On-site woodland retained not credited | 0.00 acres |

44 Prepared by:

Last Revised: January 20, 2012

WOODLAND PRESERVATION OR RETENTION

WOODLAND PRESERVATION AND RETENTION NOTES

1. ALL WOODLANDS DESIGNATED ON THIS PLAN FOR PRESERVATION ARE THE RESPONSIBILITY OF THE PROPERTY OWNER. THE WOODLAND AREAS SHALL REMAIN IN A NATURAL STATE. THIS INCLUDES THE CANOPY TREES AND UNDERSTORY VEGETATION. A REVISED TREE CONSERVATION PLAN IS REQUIRED PRIOR TO CLEARING WOODLAND AREAS THAT ARE NOT SPECIFICALLY IDENTIFIED TO BE CLEARED ON THE APPROVED TCP2.
2. TREE AND WOODLAND CONSERVATION METHODS SUCH AS ROOT PRUNING SHALL BE CONDUCTED AS NOTED ON THIS PLAN.
3. THE LOCATION OF ALL TEMPORARY TREE PROTECTION FENCING (TPFs) SHOWN ON THIS PLAN SHALL BE FLAGGED OR STAKED IN THE FIELD PRIOR TO THE PRE-CONSTRUCTION MEETING. UPON APPROVAL OF THE LOCATIONS BY THE COUNTY INSPECTOR, INSTALLATION OF THE TPFs MAY BEGIN.
4. ALL TEMPORARY TREE PROTECTION FENCING REQUIRED BY THIS PLAN SHALL BE INSTALLED PRIOR TO COMMENCEMENT OF CLEARING AND GRADING OF THE SITE AND SHALL REMAIN IN PLACE UNTIL THE BOND IS RELEASED FOR THE PROJECT. FAILURE TO INSTALL AND MAINTAIN TEMPORARY OR PERMANENT TREE PROTECTIVE DEVICES IS A VIOLATION OF THIS TCP2.
5. WOODLAND PRESERVATION AREAS SHALL BE POSTED WITH SIGNAGE AS SHOWN ON THE PLANS AT THE SAME TIME AS THE TEMPORARY TPF INSTALLATION. THESE SIGNS MUST REMAIN IN PERPETUITY.
- REMOVAL OF HAZARDOUS TREES OR LIMBS BY DEVELOPERS OR BUILDERS
6. THE DEVELOPER AND/OR BUILDER IS RESPONSIBLE FOR THE COMPLETE PRESERVATION OF ALL FORESTED AREAS SHOWN ON THE APPROVED PLAN TO REMAIN UNDISTURBED. ONLY TREES OR PARTS THEREOF DESIGNATED BY THE COUNTY AS DEAD, DYING, OR HAZARDOUS MAY BE REMOVED.
7. A TREE IS CONSIDERED HAZARDOUS IF A CONDITION IS PRESENT WHICH LEADS A CERTIFIED ARBORIST OR LICENSED TREE EXPERT TO BELIEVE THAT THE TREE OR A PORTION OF THE TREE HAS A POTENTIAL TO FALL AND STRIKE A STRUCTURE, PARKING AREA, OR OTHER HIGH USE AREA AND RESULT IN PERSONAL INJURY OR PROPERTY DAMAGE.
8. DURING THE INITIAL STAGES OF CLEARING AND GRADING, IF HAZARDOUS TREES ARE PRESENT, OR TREES ARE PRESENT THAT ARE NOT HAZARDOUS BUT ARE LEANING INTO THE DISTURBED AREA, THE PERMITTEE SHALL REMOVE SAID TREES USING A CHAIN SAW. CORRECTIVE MEASURES REQUIRING THE REMOVAL OF THE HAZARDOUS TREE OR PORTIONS THEREOF SHALL REQUIRE AUTHORIZATION BY THE COUNTY INSPECTOR. ONLY AFTER APPROVAL BY THE INSPECTOR MAY THE TREE BE CUT BY CHAINSAW TO NEAR THE EXISTING GROUND LEVEL. THE STUMP SHALL NOT BE REMOVED OR COVERED WITH SOIL, MULCH, OR OTHER MATERIALS THAT WOULD INHIBIT SPROUTING.
9. IF A TREE OR TREES BECOME HAZARDOUS PRIOR TO BOND RELEASE FOR THE PROJECT, DUE TO STORM EVENTS OR OTHER SITUATIONS NOT RESULTING FROM AN ACTION BY THE PERMITTEE, PRIOR TO REMOVAL, A CERTIFIED ARBORIST OR A LICENSED TREE EXPERT MUST CERTIFY THAT THE TREE OR THE PORTION OF THE TREE IN QUESTION HAS A POTENTIAL TO FALL AND STRIKE A STRUCTURE, PARKING AREA, OR OTHER HIGH USE AREA AND MAY RESULT IN PERSONAL INJURY OR PROPERTY DAMAGE. IF A TREE OR PORTIONS THEREOF ARE IN IMMINENT DANGER OF STRIKING A STRUCTURE, PARKING AREA, OR OTHER HIGH USE AREA AND MAY RESULT IN PERSONAL INJURY OR PROPERTY DAMAGE THEN THE CERTIFICATION IS NOT REQUIRED AND THE PERMITTEE SHALL TAKE CORRECTIVE ACTION IMMEDIATELY. THE CONDITION OF THE AREA SHALL BE FULLY DOCUMENTED THROUGH PHOTOGRAPHS PRIOR TO CORRECTIVE ACTION BEING TAKEN. THE PHOTOS SHALL BE SUBMITTED TO THE INSPECTOR FOR DOCUMENTATION OF THE DAMAGE.
- IF CORRECTIVE PRUNING MAY ALLEVIATE A HAZARDOUS CONDITION, THE CERTIFIED ARBORIST OR A LICENSED TREE EXPERT MAY PROCEED WITHOUT FURTHER AUTHORIZATION. THE PRUNING MUST BE DONE IN ACCORDANCE WITH THE LATEST EDITION OF THE APPROPRIATE ANSI A-300 PRUNING STANDARDS. THE CONDITION OF THE AREA SHALL BE FULLY DOCUMENTED THROUGH PHOTOGRAPHS PRIOR TO CORRECTIVE ACTION BEING TAKEN. THE PHOTOS SHALL BE SUBMITTED TO THE INSPECTOR FOR DOCUMENTATION OF THE DAMAGE.
- DEBRIS FROM THE TREE REMOVAL OR PRUNING THAT OCCURS WITHIN 35 FEET OF THE WOODLAND EDGE MAY BE REMOVED AND PROPERLY DISPOSED OF BY RECYCLING, CHIPPING OR OTHER ACCEPTABLE METHODS. ALL DEBRIS THAT IS MORE THAN 35 FEET FROM THE WOODLAND EDGE SHALL BE CUT UP TO ALLOW CONTACT WITH THE GROUND, THUS ENCOURAGING DECOMPOSITION. THE SMALL MATERIALS SHALL BE PLACED INTO BRUSH PILES THAT WILL SERVE AS WILDLIFE HABITAT.
- TREE WORK TO BE COMPLETED WITHIN A ROAD RIGHT-OF-WAY REQUIRES A PERMIT FROM THE MARYLAND DEPARTMENT OF NATURAL RESOURCES UNLESS THE TREE REMOVAL IS SHOWN WITHIN THE APPROVED LIMITS OF DISTURBANCE ON A TCP2. THE WORK IS REQUIRED TO BE CONDUCTED BY A LICENSED TREE EXPERT.
- IF DEBRIS PILES ARE NOTED ON THE FSD AND LOCATED IN PRESERVATION AREAS

10. DEBRIS PILES SHOWN IN WOODLAND PRESERVATION AREAS SHALL BE REMOVED BY HAND WITHOUT THE USE OF MECHANICAL EQUIPMENT WITHIN THE PRESERVATION AREA. CHAINS MAY BE USED TO PULL DEBRIS OUT OF THE PRESERVATION AREAS. CAUTION MUST BE USED NOT TO DAMAGE REMAINING VEGETATION.

POST DEVELOPMENT NOTES

WHEN WOODLANDS AND/OR SPECIMEN, HISTORIC OR CHAMPION TREES ARE TO REMAIN

1. IF THE DEVELOPER OR BUILDER NO LONGER HAS AN INTEREST IN THE PROPERTY AND THE NEW OWNER DESIRES TO REMOVE A HAZARDOUS TREE OR PORTION THEREOF, THE NEW OWNER SHALL OBTAIN A WRITTEN STATEMENT FROM A CERTIFIED ARBORIST OR LICENSED TREE EXPERT IDENTIFYING THE HAZARDOUS CONDITION AND THE PROPOSED CORRECTIVE MEASURES PRIOR TO HAVING THE WORK CONDUCTED. AFTER PROPER DOCUMENTATION HAS BEEN COMPLETED PER THE HANDOUT "GUIDANCE FOR PRINCE GEORGE'S COUNTY PROPERTY OWNERS, PRESERVATION OF WOODLAND CONSERVATION AREAS", THE ARBORIST OR TREE EXPERT MAY THEN REMOVE THE TREE. THE STUMP SHALL BE CUT AS CLOSE TO THE GROUND AS POSSIBLE AND LEFT IN PLACE. THE REMOVAL OR GRINDING OF THE STUMPS IN THE WOODLAND CONSERVATION AREA IS NOT PERMITTED.
- IF A TREE OR PORTIONS THEREOF ARE IN IMMINENT DANGER OF STRIKING A STRUCTURE, PARKING AREA OR OTHER HIGH USE AREA AND MAY RESULT IN PERSONAL INJURY OR PROPERTY DAMAGE THEN THE CERTIFICATION IS NOT REQUIRED AND THE PERMITTEE SHALL TAKE CORRECTIVE ACTION IMMEDIATELY. THE CONDITION OF THE AREA SHALL BE FULLY DOCUMENTED THROUGH PHOTOGRAPHS PRIOR TO CORRECTIVE ACTION BEING TAKEN. THE PHOTOS SHALL BE SUBMITTED TO THE INSPECTOR FOR DOCUMENTATION OF THE DAMAGE.
- TREE WORK TO BE COMPLETED WITHIN A ROAD RIGHT-OF-WAY REQUIRES A PERMIT FROM THE MARYLAND DEPARTMENT OF NATURAL RESOURCES UNLESS THE TREE REMOVAL IS SHOWN WITHIN THE APPROVED LIMITS OF DISTURBANCE ON A TCP2. THE WORK IS REQUIRED TO BE CONDUCTED BY A LICENSED TREE EXPERT.
2. THE REMOVAL OF NOXIOUS, INVASIVE, AND NON-NATIVE PLANT SPECIES FROM ANY WOODLAND PRESERVATION AREA SHALL BE DONE WITH THE USE OF HAND-HELD EQUIPMENT ONLY (PRUNERS OR A CHAIN SAW). THESE PLANTS MAY BE CUT NEAR THE GROUND AND MATERIAL LESS THAN TWO INCHES DIAMETER MAY BE REMOVED FROM THE AREA AND DISPOSED OF APPROPRIATELY. ALL MATERIAL FROM THESE NOXIOUS, INVASIVE, AND NON-NATIVE PLANTS GREATER THAN TWO (2) INCHES DIAMETER SHALL BE CUT TO ALLOW CONTACT WITH THE GROUND, THUS ENCOURAGING DECOMPOSITION.
3. THE USE OF BROADCAST SPRAYING OF HERBICIDES IS NOT PERMITTED. HOWEVER, THE USE OF HERBICIDES TO DISCOURAGE RE-SPROUTING OF INVASIVE, NOXIOUS, OR NON-NATIVE PLANTS IS PERMITTED IF DONE AS AN APPLICATION OF THE CHEMICAL DIRECTLY TO THE CUT STUMP IMMEDIATELY FOLLOWING CUTTING OF PLANT TOPS. THE USE OF ANY HERBICIDE SHALL BE DONE IN ACCORDANCE WITH THE LABEL INSTRUCTIONS.
4. THE USE OF CHAINSAWS IS EXTREMELY DANGEROUS AND SHOULD NOT BE CONDUCTED WITH POORLY MAINTAINED EQUIPMENT, WITHOUT SAFETY EQUIPMENT, OR BY INDIVIDUALS NOT TRAINED IN THE USE OF THIS EQUIPMENT FOR THE PRUNING AND/OR CUTTING OF TREES.
- PROTECTION OF REFORESTATION AND AFFORESTATION AREAS BY INDIVIDUAL HOMEOWNERS
5. REFORESTATION FENCING AND SIGNAGE SHALL REMAIN IN PLACE IN ACCORDANCE WITH THE APPROVED TYPE 2 TREE CONSERVATION PLAN.
6. REFORESTATION AREAS SHALL NOT BE MOWED; HOWEVER, THE MANAGEMENT OF COMPETING VEGETATION AND REMOVAL OF NOXIOUS, INVASIVE, AND NON-NATIVE VEGETATION AROUND INDIVIDUAL TREES IS ACCEPTABLE.

| | | | | | |
|----------|-----|-------|------|--|-----|
| DESIGNED | DLM | 12/15 | DATE | REVISIONS | |
| DRAWN | FA | 12/15 | DATE | DATE | BY |
| CHECKED | KLM | 12/15 | DATE | 9-15-15 | MAM |
| APPROVED | DAD | 12/15 | DATE | 11-20-15 | MAM |
| | | | | REVISED PER MNCPPC COMMENTS, UPDATED NOTES, ADDED SED. | |
| | | | | CONTROL EXTERIOR DEVICES, REVISED GRADING AND LOD | |
| | | | | REV. PER MNCPPC COMMENTS, TYPE 4 FENCE, LOD OUT OF ROW | |
| | | | | | |
| | | | | | |

201 Defense Highway
Suite 200
Annapolis, MD 21401
Ph. (443) 274-3232
Fax (443) 274-3233
Contact Person: D. Andrew Dorsey
adorsey@techgroupinc.net

ADDRESS OF PROPERTY

5718, 5724, 5727, 5728, 5729 & 5731
WALNUT AVENUE
LANHAM, MD 20706

APPLICANT

W.F. CHESLEY REAL ESTATES, LLC
1641 ROUTE 3 NORTH, SUITE 202
CROFTON, MD. 21114
PHONE: 301 261-6700
C/O RUSSELL BAKER
RUSSELL@WFCHESELEY.COM

OWNERS/DEVELOPERS

WESTPOINT, LLC
WFC FLAGSHIP, LLC
1641 ROUTE 3 NORTH, SUITE 202
CROFTON, MD. 21114
PHONE: 301 261-6700
C/O RUSSELL BAKER
RUSSELL@WFCHESELEY.COM

TREE CONSERVATION PLAN - TYPE II
DETAIL SHEET
LINCOLN SUBDIVISION

LOTS 8R, 9R, 12R - 14R, 40R & 41R, BLOCKS Q & R, WALNUT AVENUE

PRINCE GEORGE'S COUNTY, MARYLAND
20TH/LANHAM ELECTION DISTRICT
TAX MAP 45, GRID C1. TAX ACCT. #'S 1686971, 1686989, 1612043, 1649524, 1694132, 1560901

CALL "MISS UTILITY"

TELEPHONE: 1-800-257-7777 FOR UTILITY
LOCATIONS AT LEAST 48 HOURS BEFORE
BEGINNING CONSTRUCTION.

SCALE: NOT TO SCALE

DATE: FEBRUARY 2016

TTC PROJECT No. 514018

SHEET 2 OF 2