

1. This site is zoned R-10 (Multi-Family Medium Density Residential) and is located in the Developed Type as defined in the Approved General Plan.
2. The source of the property boundaries on this plan is from a field run boundary survey performed by Ben Dyer Associates and record plat book NW116 No. 3.
3. The topography shown on this plan is from a field run topography survey performed by Ben Dyer Associates.
4. The source of the soils information on this plan is from the USDA NRCS Web Soil Survey (NSSL) in a Custom Soil Resource Report for an Area of Interest (AOI) established for the subject site.
5. No county regulated 100-year floodplain is located within the NRI project area because the drainage area to the site is less than 50 acres as verified by Michael A. Novy, P.E. water resources engineer, Ben Dyer Associates, Inc.
6. No wetlands or streams are located on-site as verified by Mike Petrakis of Ben Dyer Associates, Inc.
7. The site does not contain Wetlands of Special State Concern as defined in COMAR 26.23.06.01.
8. This site does not contain a Tier II waterbody as defined in COMAR 26.08.02.04.
9. This site is not located within a Stronghold Watershed as established by the MD DNR.
10. This site is not within a Sensitive Species Review Area based on the SSFRA GIS Plan prepared by the Heritage and Wildlife Service, Maryland Department of Natural Resources.
11. This site does not include Forest Interior Dwelling Species habitat.
12. This site is not subject a previously approved TCP.
13. There is one (1) specimen tree located on the property. The tree was surveyed located.
14. There are no scenic or historic roads located on or adjacent to this property.
15. The subject property is not located in a designated historic district.
16. There are no known archeological sites located on the subject property; however, the subject property has not been surveyed for archeological resources and a Phase I archeology report may be required during subsequent development review processes.
17. Marlboro clay and Christiana complex are not found to occur on or within the vicinity of this property.
18. The site is not located in the vicinity of any master planned roadway designated as arterial or higher.
19. The subject property is not located within the 2000 Air Installation Compatible Use Zone (AICUZ) Study for Andrews Air Force Base.
20. The site is not located in an Aviation Policy Area (APA).
21. The site is not located in the Chesapeake Bay Critical Area (CBCA).
22. An approved NRI is valid for five years from the date of signature by staff, or until information used to prepare the NRI changes. NRIs will be required to be re-reviewed and re-approved if the base information changes significantly. Approval of this NRI in no way imports any other development application approvals.

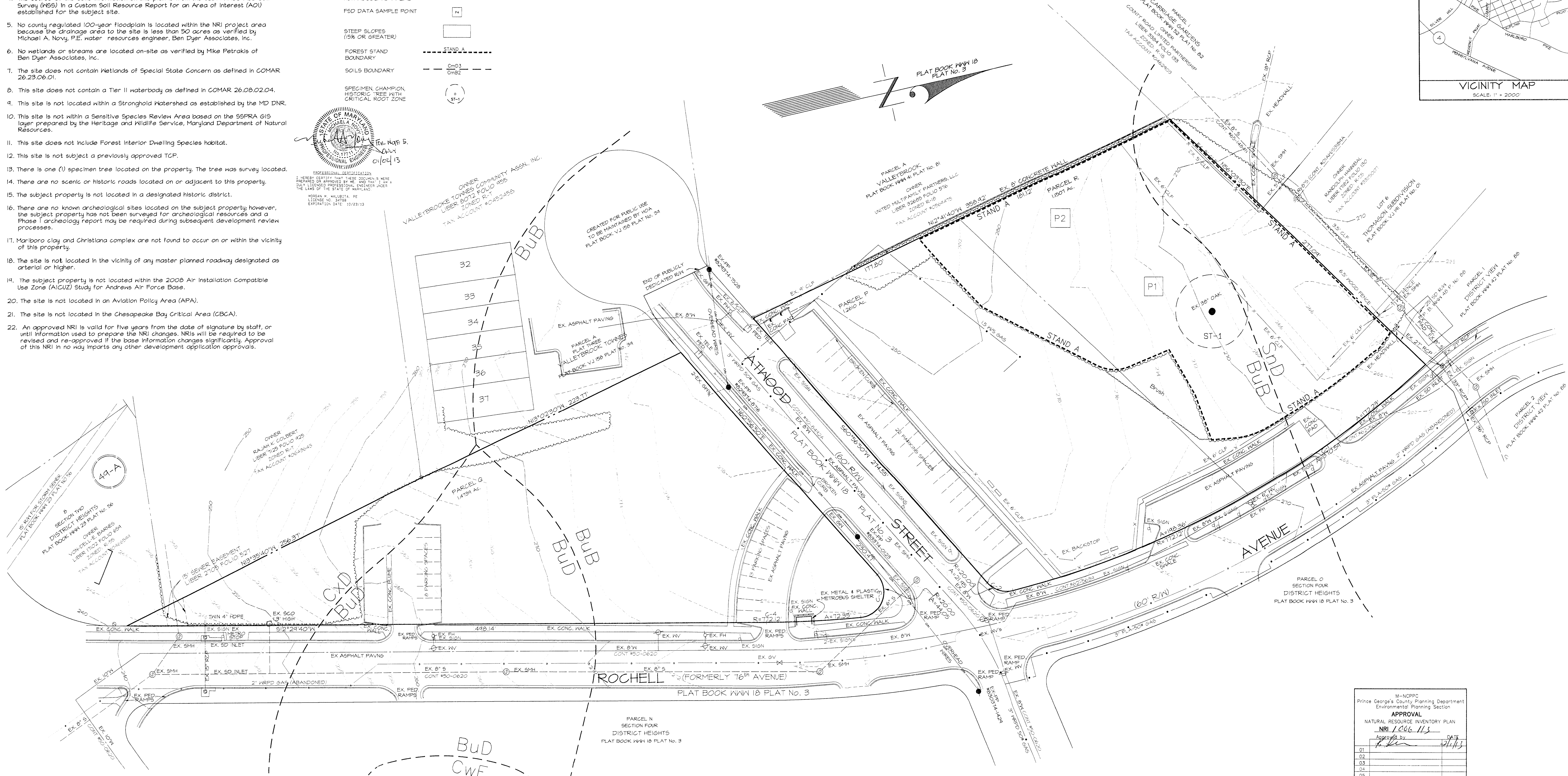
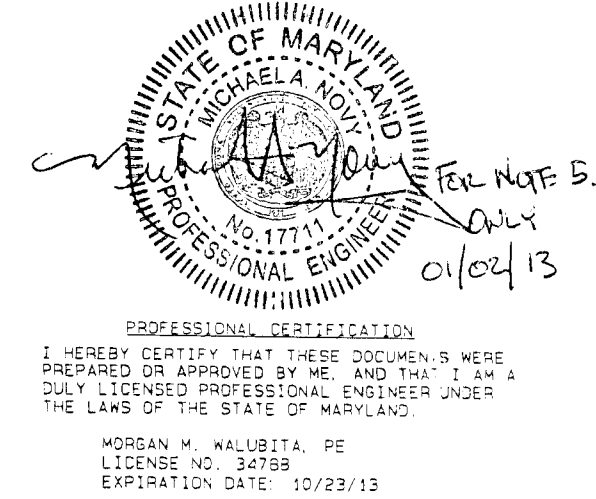

SPECIMEN TREE TABLE					
No.	Common Name	Scientific Name	DBH (Inches)	Condition Rating	Condition Comments
1	White Oak	Quercus alba	38"	Fair	

Site Statistics	Total
Gross tract area	3.00 ac.
Existing 100-year floodplain	0.00 ac.
Net tract area	3.00 ac.
Existing woodland in the floodplain	0.00 ac.
Existing woodland net tract	1.04 ac.
Existing woodland total	1.04 ac.
Existing FMA	0.00 sf
Regulated streams (linear feet of centerline)	0 lf

OWNER/APPLICANT  
SHELTER DEVELOPMENT, LLC  
218 NORTH CHARLES STREET  
SUITE 220  
BALTIMORE, MARYLAND 2120

NATURAL RESOURCE INVENTORY  
FOR  
WOODLAND SPRINGS TOWNHOMES  
ON  
PARCELS 'R', 'P', & 'Q'  
SECTION FOUR  
DISTRICT HEIGHTS  
SPAULDING DISTRICT No. 6  
PRINCE GEORGE'S COUNTY, MARYLAND



1-2-2013  
DATE

Mike Peters  
Qualified Professional  
CONWR 08/09/01

DATE DESCRIPTION REVISIONS BY SCALE

12/01/2012 54.00