

PRINCE GEORGE'S ORGANIC COMPOSTING FACILITY TYPE 2 TREE CONSERVATION PLAN TCP-021-2024

6550 SE Crain Highway, Upper Marlboro, MD, 20772

GENERAL NOTES

- This plan is submitted to fulfill the woodland conservation requirements for FSC # 150-23. If FSC # 150-23 expires, then this TCP2 also expires and is no longer valid.
- Cutting or clearing of woodland not in conformance with this plan or without the expressed written consent of the Planning Director or designee shall be subject to a \$9.00 per square foot mitigation fee.
- A pre-construction meeting is required prior to the issuance of grading permits. The Department of Public Works and Transportation or the Department of Environmental Resources, as appropriate, shall be contacted prior to the start of any work on the site to conduct a pre-construction meeting where implementation of woodland conservation measures shown on this plan will be discussed in detail.
- The owner of the parcels shown on this plan shall notify future buyers of any woodland conservation areas through the provision of a copy of this plan at time of contract signing. Future property owners are also subject to this requirement.
- The owners of the property subject to this tree conservation plan are solely responsible for conformance to the requirements contained herein.
- The property is within the Rural Tier and is zoned Reserved Open Space (R-O-S).
- The property is adjacent to Crain Road which is designated a scenic and historic roadway.
- The site is not adjacent to a roadway classified as arterial or greater.
- This plan is/is not grandfathered under CB-27-2010, Section 25-117 (g).

Woodland Conservation Worksheet for Governmental and Linear Projects in Prince George's County			
SECTION 1 - Establishing Site Information			
1) Property Description or Name:	Prince George's County Organic Compost Facility		
2) Project Location:	6550 SE Crain Highway, Upper Marlboro, MD 20772		
3) TCP# Number:	TCP-021-2024	Rev. No.	
4) NRI Number:	NRI-000-2022	Rev. No.	
5) Zone:	R-O-S		
6) Gross Tract:	195.73 acres		
7) Project Area/Limits:	5.40 acres		
SECTION 2 - Determining Requirements			
8) Existing Woodland in Project Limits - WCT	1.37	or	25.00%
9) Woodland Cleared in Project Limits - WCT	1.37		
10) Total area of woodland cleared (subject to 1:1 replacement)	1.37		
11) Off-Site Woodland Conservation Provided (afforestation)	0.00		
12) Off-Site Woodland Conservation Provided (preservation)	0.00		
13) Woodland Conservation Requirement	1.37	acres	
SECTION 3 - Meeting the Requirements			
14) Woodland Preserved	0.00		
15) Afforestation (Reforestation)	0.00	Bond amount:	\$ 17,903.16
16) Native Regeneration	0.00		
17) Landscape Credits	0.00		
18) Species/Habitat Tree Credit (CRZ area *2.0)	0.00		
19) Forest Enhancement Credit (Area *2.5)	0.00		
20) Street Tree Credit (existing or 10-year canopy coverage)	0.00		
21) Prior Credit for Off-site Woodland Conservation	0.00		
22) Current Credit for Off-site Woodland Conservation	0.00		
23) Off-site Woodland Conservation provided (afforestation)	0.00		
24) Off-site Woodland Conservation provided (preservation)	0.00	Fee amount:	\$0.00
25) Area Approved for Fee-in-lieu/PFA	0.00	Fee amount:	\$0.00
26) Area Approved for Fee-in-lieu/PFA	0.00		
27) Woodland Conservation Provided	1.37	acres	
28) Prepared by: Heather Tatone, QP <i>Heather Tatone</i> 7/25/2024			
Signed		Date	
Note: The gross tract area and project area only reflect the area of the site that is outside of the Chesapeake Bay Critical Area.			

General Information Table		
Layer Name		Value
Zone	Zoning (Zone)	R-O-S (Reserved Open Space)
Zone	Aviation Policy Area (APA)	N/A
Administrative	Tax Grid (TAG)	111-B2, 111-B3, 111-C2, 111-C3
Administrative	WSSC Grid (Sheet 20)	209SE13, 209SE14, 210SE13, 210SE14
Administrative	Planning Area (Plan Area)	828 (Mount Calvert-Nottingham)
Administrative	Election District (ED)	3
Administrative	Councilmanic District (CD)	9
Administrative	General Plan 2002 Tier (Tier)	Rural
Administrative	General Plan Growth Policy (2005)	Rural & Agricultural Areas
Administrative	Traffic Analysis Zone (TAZ-C20)	1281
Administrative	PG Traffic Analysis Zone (TAZ-PG)	4555
Administrative	Police District	V

Prince George's County Planning Department, M-NCPPC

Environmental Planning Section

TYPE 2 TREE CONSERVATION PLAN APPROVAL TCP2-021-2024

	Approved by	Date	DRD #	Reason for Revision
00	<i>Heather Tatone</i>	10/24/2024		
01				
02				
03				
04				
05				



INDEX MAP

SCALE: 1" = 600'

SITE STATISTICS TABLE			
Resources	Total	Outside of CBCA	Within CBCA
Gross tract area (subject property)	216.17 AC.	195.73 AC.	20.42 AC.
Existing 100-year floodplain	24.07 AC.	19.31 AC.	4.76 AC.
Existing 100-year floodplain in linear NRI area	0.00 AC.	0.00 AC.	0.00 AC.
Linear NRI (LOD)	12.92 AC.	5.46 AC.	7.46 AC.
Existing woodland in the floodplain (total)	24.07 AC.	19.30 AC.	4.77 AC.
Existing woodland in linear NRI area	2.65 AC.	1.37 AC.	1.28 AC.
Existing woodland (total)	132.69 AC.	121.86 AC.	10.83 AC.
Existing PMA (total)	86.21 AC.	86.21 AC.	N/A
Existing PMA in linear NRI area	0.30 AC.	0.30 AC.	N/A
Regulated streams (centerline) total	18,840 LF.	17,815 LF.	1,025 LF.
Regulated streams (centerline) in linear NRI area	0 LF.	0 LF.	0 LF.
Riparian (wooded) buffer up to 300' wide (total)	155.23 AC.	142.26 AC.	12.96 AC.
Primary buffer	5.98 AC.	N/A	5.98 AC.
Secondary buffer	8.71 AC.	N/A	8.71 AC.

SPECIMEN TREE TABLE				
Tree ID	Common Name	Scientific Name	DBH (IN)	Condition/Notes
11A	Sweet-gum	Liquidambar styraciflua	30	Good, some whorl on lower trunk
12A	Sweet-gum	Liquidambar styraciflua	32	Poor, appears dead
13A	Tulip tree	Liriodendron tulipifera	30	Good
14A	White oak	Quercus alba	32	Good
15A	Northern red oak	Quercus rubra	32	Good
16A	Sweet-gum	Liquidambar styraciflua	30	Good
17A	Tulip tree	Liriodendron tulipifera	32	Good
18A	Tulip tree	Liriodendron tulipifera	32.5	Good
19A	Northern red oak	Quercus rubra	32.5	Good
20A	Tulip tree	Liriodendron tulipifera	32, 18, 13	Fair, some trunk rot
21A	Tulip tree	Liriodendron tulipifera	32.5	Good
22A	Tulip tree	Liriodendron tulipifera	33	Good
23A	Tulip tree	Liriodendron tulipifera	30.5	Good

*Tree planting proposed

SHEET INDEX	
SHEET TITLE	SHEET NUMBER
COVER SHEET	1
NOTES & DETAILS	2
PLAN SHEET	3
PLAN SHEET	4
PLAN SHEET	5

Property Owners Awareness Certificate

I/We, Marilyn Naumann, Prince George's County, hereby acknowledge that we are aware of this Type 2 Tree Conservation Plan (TCP2) and that we understand the requirements as set forth in this TCP2.

Marilyn Naumann 9/4/24
Owner or Owners Representative Date

I/We, _____, hereby acknowledge that we are aware of this Type 2 Tree Conservation Plan (TCP2) and that we understand the requirements as set forth in this TCP2.

Contract Purchaser Date



QUALIFIED PROFESSIONAL CERTIFICATION

This plan complies with the current requirements of Subtitle 25 and the Woodland and Wildlife Conservation Technical Manual

Heather Tatone
SIGNATURE DATE
Heather Tatone
Coastal Resources, Inc.
25 Old Solomons Island Road
Annapolis, MD 21401
443-837-2146
heather@crilbiz

PROJECT TITLE

PRINCE GEORGE'S ORGANIC COMPOSTING FACILITY

6550 SE Crain Highway, Upper Marlboro, MD, 20772 Prince George's County

SHEET TITLE

TYPE 2 TREE CONSERVATION PLAN

REVISIONS			
No.	DATE	DESCRIPTION	REV BY

CHECKED BY: _____
DESIGNED: _____
DRAWN: _____
PROJECT No.: 2019-06
DATE: 8/10/2024
SHEET: _____

POST DEVELOPMENT

1. If the developer or builder no longer has an interest in the property and the new owner desires to have the hazardous waste or petroleum removed, the new owner shall obtain a written acceptance from Certified Airports or Licensed Tree Expert identifying the hazardous condition and the proposed corrective measures to be taken to complete the work conducted. After proper documentation has been completed per the requirements of the TCEQ, the new owner shall be responsible for the removal of the hazardous waste and/or asbestos, the removal of the tree or tree part, the removal of the stump and to cut all stumps to the base of the stump at least six inches above the ground. The stump should be placed in the woodland container and the area not permitted.

2. If a tree or portions thereof are in imminent danger of sinking the structure, parking area, or other high use area, the owner shall be responsible for the removal of the tree or tree part and the stump. The permittee shall take corrective action immediately. The condition of the area shall be fully documented through photographs prior to corrective action being taken. The photos shall be submitted to the inspector for review.

3. Tree work to be completed within a road right-of-way requires a permit from the Maryland Department of Transportation, Division of Transportation Planning and Design, and is considered limited to a TCEQ. The work is required to be conducted by a Licensed Tree Expert.

4. The removal of noxious, invasive, and non-native plant species from any woodland presentation area shall be done with the use of hand-held equipment (e.g. pruners or a chain saw). These plants may be cut and left on the ground for no more than two inches diameter may be removed from the area and disposed of appropriately. All areas from these noxious, invasive, and non-native plants greater than two inches in diameter must be removed from the area and disposed of appropriately.

5. The use of broadcast spraying of herbicides is not permitted. However, the use of herbicides to discourage re-sprouting of invasive, noxious, or non-native plants is permitted if done in accordance A-36 Environmental Technical Manual August 2010 A-3, TCEP-2 and should not include an application of the chemical to the ground.

6. The use of herbicides to remove noxious, invasive, and non-native plants is permitted if done in accordance with the label instructions.

7. The use of herbicides to remove noxious, invasive, and non-native plants should not be conducted with equipment, without safety equipment, or by individuals not trained in the use of this equipment for the pruning and/or cutting of trees.

8. The use of herbicides to remove noxious, invasive, and non-native plants should be conducted with equipment that shall remain in place in accordance with the approved Tree 2 Tree Conservation Plan.

9. Revegetation areas shall not be mowed, however, the management of competing vegetation and removal of noxious, invasive, and non-native plants may be necessary.

1. All woodlands designated on this plan for preservation are the responsibility of the property owner. The woodland areas shall remain in a natural state. This includes the canopy trees and understorey vegetation. A review tree conservation plan is required prior to clearing woodland and the plan must specifically identified trees to be retained.
2. Tree and woodland conservation methods such as root pruning shall be conducted as noted on this plan.
3. The location of all temporary tree protection fencing (TPF) shown on this plan shall be flagged in the field prior to the pre-construction meeting. Upon approval of the locations by the county engineer, installation of the TPFs may begin.
4. All temporary tree protection fencing required by this plan shall be installed prior to commencement of clearing and grading of the site and shall remain in place until the bond is released for the project. Failure to install and maintain temporary or permanent tree protective devices will result in a stop-work order.
5. Woodland preservation areas shall be posted with signage as shown on the plans at the same time as the temporary TPF installation. These signs must remain in perpetuity.

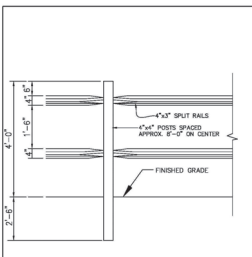

- NOTES:
1. POSTS SHALL STAND PLUMB.
 2. RAILS SHALL BE HUNG WITH UNIFORM HEIGHT AND SPACING.
 3. REFORESTATION SIGNS TO BE ATTACHED TO WOOD POSTS EVERY 50 FEET.
 4. TOP OF SIGN TO BE FLUSH WITH TOP OF WOOD POST.
 5. SIGNS TO BE ATTACHED USING 2 GALVANIZED WOOD SCREWS EACH WITH A GALVANIZED WASHER.

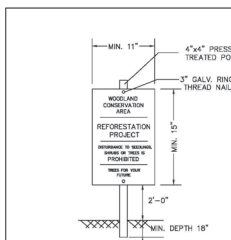
PERMANENT (SPLIT RAIL) TREE PROTECTION FENCE
FOR REFORESTATION AREAS

- NOTES:
1. ATTACHMENT OF SIGNS TO TREES IS PROHIBITED.
 2. SIGNS SHOULD BE PROPERLY MAINTAINED.
 3. AVOID INJURY TO ROOTS WHEN PLACING POSTS FOR THE SIGNS.
 4. SIGNS SHOULD BE POSTED TO BE VISIBLE TO ALL CONSTRUCTION PERSONNEL FROM ALL DIRECTIONS.
 5. SIGNS SHOULD BE INSTALLED AT SAME TIME AS TREE PROTECTION DEVICE.
 6. LOCATE SIGNS APPROXIMATELY EVERY 50 FEET ALONG FENCING.
 7. SIGNS SHOULD BE IN PLACE IMMEDIATELY FOLLOWING STAKE OUT OF L.O.D., AND REMAIN IN PLACE IN PERPETUITY.

REFORESTATION AREA SIGN

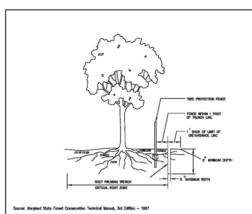

1. RETENTION AREAS TO BE ESTABLISHED AS PART OF THE FOREST CONSERVATION PLAN REVIEW PROCEEDS.
2. BOUNDARIES OF RETENTION AREAS SHOULD BE STAKED, FLAGGED AND/OR FENCED PRIOR TO TRENCING.
3. EXACT LOCATION OF TRENCH SHOULD BE IDENTIFIED.
4. TRENCH SHOULD BE IMMEDIATELY BACKFILLED WITH SOIL REMOVED OR OTHER IN ORGANIC SOIL.
5. ROOTS SHOULD BE CLEANLY CUT USING VERVORY KNOT, OR OTHER ACCEPTABLE EQUIPMENT.

ROOT PRUNING

NATURAL REGENERATION NOTES

All areas designated for reforestation shall be reforested by natural regeneration. The following requirements and conditions apply:

1. All existing turf, ground covers, and invasive species shall be exterminated using a general broadcast herbicide such as "RoundUp" or equivalent. Secondary vegetation may be removed as needed.
2. Care shall be taken to avoid spraying any hardwood seedlings or saplings.
3. Root-tilling of cultural areas and manual removal of invasive trees shall be completed two weeks after herbicide treatments are completed.
4. Reforestation signs shall be installed every fifty feet or as appropriate and two strand wire fencing shall be installed along tree frontage adjacent to any reforestation areas.
5. Reforestation materials to the site shall be posted as required in the direction of any access roads.
6. Natural regeneration shall be encouraged by semi-annual maintenance of the designated areas. The maintenance shall, at a minimum, require removal of competing vegetation and the removal of the desired indigenous hardwoods. This maintenance shall occur for a period of two years.
7. After one and two years all desirable seedlings and saplings shall be counted and recorded on the Reforestation Data Tables.
8. If after two years there is less than one seedling per 80 square feet and there are indications that natural regeneration is not occurring adequately then the owners shall plant these areas with container grown seedlings at a rate of one per 80 square feet.

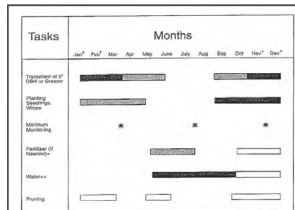

Tree Planting and Maintenance Calendar

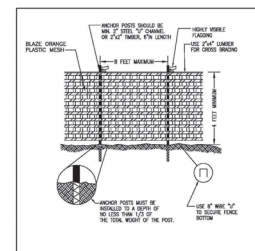

NOTES: (MUST BE INCLUDED WITH DATA)

1. FOREST PROTECTION DEVICE ONLY.
2. RETENTION AREA WILL BE SET AS PART OF THE REVIEW PROCESS.
3. BOUNDARIES OF RETENTION AREA SHOULD BE STAKED AND FLAGGED PRIOR TO INSTALLING DEVICES.
4. AVOID ROOT DAMAGE WHEN PLACING ANCHOR POSTS.
5. DEVICE SHOULD BE PROPERLY MAINTAINED DURING CONSTRUCTION.
6. PROTECTIVE SIGNAGE IS ALSO REQUIRED.

TYPE 1 (TEMPORARY) TREE PROTECTION FENCE DETAIL
FOR WOODLAND PRESERVATION AREAS

Prince George's County Planning Department, MNCPPC Environmental Planning Section TYPE 2 TREE CONSERVATION PLAN APPROVAL TCP2-021-2024				
	Approved by	Date	DRD #	Reason for Revision
00	<i>Marie John</i>	10/24/2024		
01				
02				
03				
04				
05				

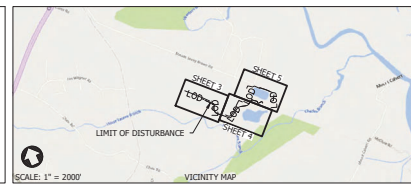

QUALIFIED PROFESSIONAL
CERTIFICATION

This plan complies with the current requirements of Subtitle 25 and the Woodland and Wildlife Conservation Technical Manual

Heather Tatone
SIGNATURE

Heather Tatone
Coastal Resources, Inc.
25 Old Solomons Island Road
Annapolis, MD 21401
443-837-2146
heathert@cri.biz

PROJECT TITLE

**PRINCE GEORGE'S
ORGANIC
COMPOSTING
FACILITY**

6550 SE Crain Highway, Upper Marlboro
MD, 20772 Prince George's County

SHEET TITLE

**TYPE 2 TREE
CONSERVATION PLAN**

REVISIONS			
No.	DATE	DESCRIPTION	REV BY

CHECKED BY: _____
DESIGNED: _____
DRAWN: _____ DH
PROJECT No.: _____ 2019-06
DATE: _____ 8/12/2024
SHEET: _____

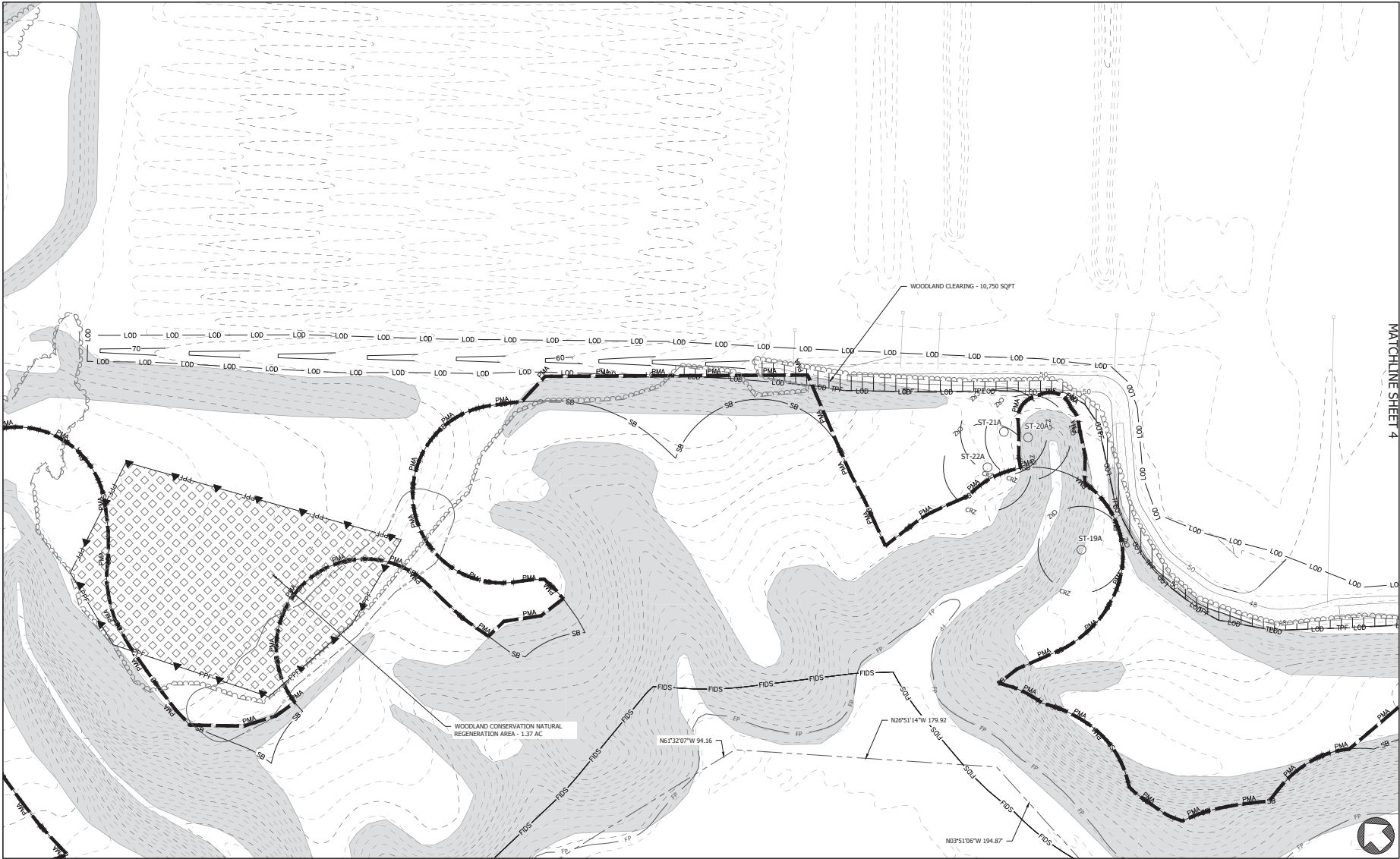

Prince George's County Planning Department, M-NCPPC Environmental Planning Section TYPE 2 TREE CONSERVATION PLAN APPROVAL TYP2-021-2024				
00	Approved by	Date	DRD #	Reason for Revision
01	Thane J. [Signature]	11/24/2024		
02				
03				
04				
05				

LEGEND

- | | |
|----------|---------------------------------------|
| — LOD — | FOREST STAND BOUNDARY* |
| — LOD — | LIMIT OF DISTURBANCE / TRACT AREA |
| — SB — | PROPERTY BOUNDARY |
| — FP — | HARBOR CLAY BOUNDARY |
| — PMA — | 100-YEAR FLOODPLAIN |
| — CBCA — | ADJACENT PROPERTY BOUNDARY |
| | EX. CONTOURS MAJOR |
| | EX. CONTOURS MINOR |
| | PRIMARY MANAGEMENT AREA (PMA) |
| | CHESAPEAKE BAY CRITICAL AREA BOUNDARY |
| CL | EX. ROAD BOUNDARY |
| SB | EX. BUILDING OUTLINE |
| WB | REGULATED STREAM (CENTERLINE) |
| SSF | REGULATED 25' WETLAND BUFFER |
| TPF | PROPOSED CONTOUR |
| PPF | SUPER SILT FENCE |
| PSD-24 | TREE PROTECTION FENCE (TEMP) |
| EWS | TREE PROTECTION FENCE (PERM) |
| | EASEMENT |
| | EXISTING 24 IN PIPE SLOPE DRAIN |
| | EXPANDED WETLAND BUFFER |

- | | |
|------|--|
| FIDS | NON-TIDAL WETLAND |
| ST-1 | FOREST INTERIOR DWELLING SPECIES 300' HABITAT BUFFER |
| | EX. TREE LINE |
| | SPECIMEN TREE (>30" DBH) |
| | CRITICAL ROOT ZONE |
| | SLOPES > 15% |
| | WOODLAND CLEARING |
| | PROPOSED STOCKPILE |

- | | |
|--|--|
| | PROPOSED ASPHALT |
| | PROPOSED RIPRAP |
| | PROPOSED WOODLAND CONSERVATION NATURAL REGENERATION AREA |
| | TREE REMOVAL |
| | TREE PROTECTION PLANKING |
| | FOREST CONSERVATION SIGN |

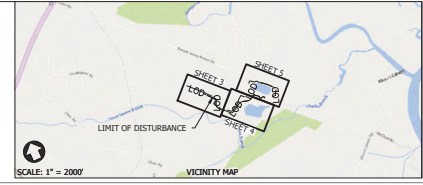

QUALIFIED PROFESSIONAL CERTIFICATION

This plan complies with the current requirements of Subtitle 25 and the Woodland and Wildlife Conservation Technical Manual

Heather Tatone
SIGNATURE

7/29/2024
DATE

Heather Tatone
Coastal Resources, Inc.
25 Old Solomons Island Road
Annapolis, MD 21401
443-837-2146
heather@cr.biz

PROJECT TITLE

PRINCE GEORGE'S
ORGANIC
COMPOSTING
FACILITY

6550 SE Crain Highway, Upper Marlboro,
MD, 20772 Prince George's County

SHEET TITLE

TYPE 2 TREE
CONSERVATION PLAN

0 50 100 Feet
SCALE: 1" = 50'

REVISIONS			
No.	DATE	DESCRIPTION	REV BY

CHECKED BY: _____

DESIGNED: _____

DRAWN: _____

PROJECT No.: 2019-05

DATE: 8/10/2024

SHEET:

3 of 5

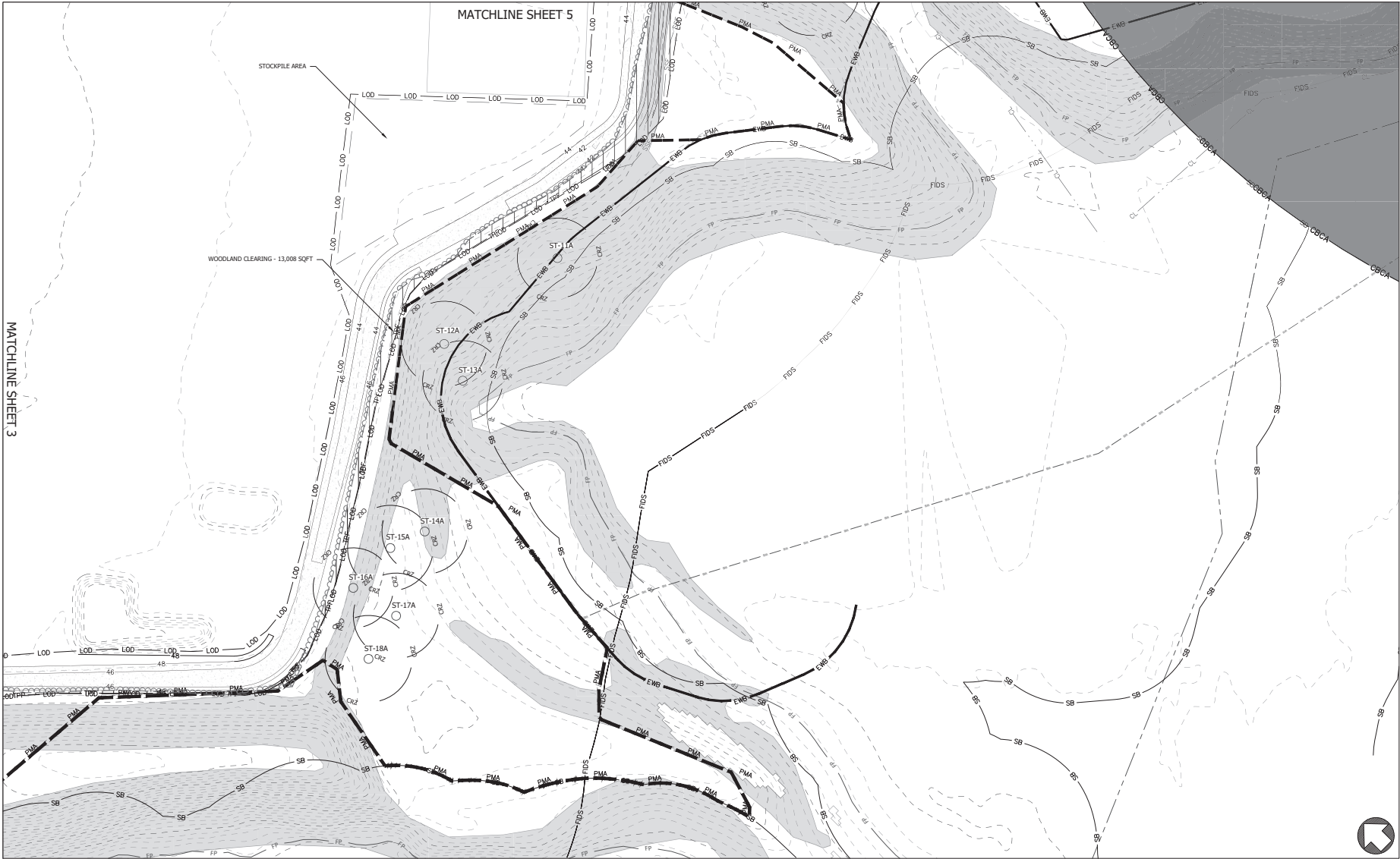

Prince George's County Planning Department, M-NCPPC Environmental Planning Section TYPE 2 TREE CONSERVATION PLAN APPROVAL TYP2-021-2024				
	Approved by	Date	CRD #	Reason for Revision
00	<i>Heather Tatone</i>	10/24/2024		
01				
02				
03				
04				
05				

LEGEND

- | | | | |
|-----|---------------------------------------|--------|---------------------------------|
| LOD | FOREST STAND BOUNDARY* | CL | EX. ROAD BOUNDARY |
| SB | LIMIT OF DISTURBANCE / TRACT AREA | SB | EX. BUILDING OUTLINE |
| WB | PROPERTY BOUNDARY | WB | REGULATED STREAM (CENTERLINE) |
| FP | MARLBORO CLAY BOUNDARY | WB | REGULATED 25' WETLAND BUFFER |
| FP | 100-YEAR FLOODPLAIN | SSF | REGULATED 25' WETLAND BUFFER |
| PMA | ADJACENT PROPERTY BOUNDARY | TPF | SUPER SILT FENCE |
| PMA | EX. CONTOURS MAJOR | PPF | TREE PROTECTION FENCE (TEMP) |
| PMA | EX. CONTOURS MINOR | PPF | TREE PROTECTION FENCE (PERM) |
| PMA | PRIMARY MANAGEMENT AREA (PMA) | PSD-24 | EASEMENT |
| PMA | CHESAPEAKE BAY CRITICAL AREA BOUNDARY | EWB | EXISTING 24 IN PIPE SLOPE DRAIN |
| PMA | | EWB | EXPANDED WETLAND BUFFER |
- | | |
|------|--|
| W | NON-TIDAL WETLAND |
| FIDS | FOREST INTERIOR DWELLING SPECIES 300' HABITAT BUFFER |
| ST-1 | EX. TREE LINE |
| ST-1 | SPECIMEN TREE (>30" DBH) |
| ST-1 | CRITICAL ROOT ZONE |
| ST-1 | SLOPES > 15% |
| ST-1 | WOODLAND CLEARING |
| ST-1 | PROPOSED STOCKPILE |
- | | |
|----|--|
| AS | PROPOSED ASPHALT |
| RR | PROPOSED RIPRAP |
| RR | PROPOSED WOODLAND CONSERVATION NATURAL REGENERATION AREA |
| RR | TREE REMOVAL |
| RR | TREE PROTECTION PLANKING |
| RR | FOREST CONSERVATION SIGN |

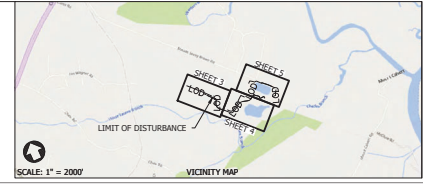

QUALIFIED PROFESSIONAL CERTIFICATION

This plan complies with the current requirements of Subtitle 25 and the Woodland and Wildlife Conservation Technical Manual

Heather Tatone
SIGNATURE

Heather Tatone
Coastal Resources, Inc.
25 Old Solomons Island Road
Annapolis, MD 21401
443-837-2146
heather@crs.biz

7/29/2024
DATE

PROJECT TITLE

**PRINCE GEORGE'S
ORGANIC
COMPOSTING
FACILITY**

6500 SE Crain Highway, Upper Marlboro,
MD, 20772 Prince George's County

SHEET TITLE

**TYPE 2 TREE
CONSERVATION PLAN**

0 50 100 Feet
SCALE: 1" = 50'

REVISIONS			
No.	DATE	DESCRIPTION	REV BY

CHECKED BY: _____
DESIGNED: _____
DRAWN: _____
PROJECT No.: 2019-05
DATE: 8/10/2024
SHEET:

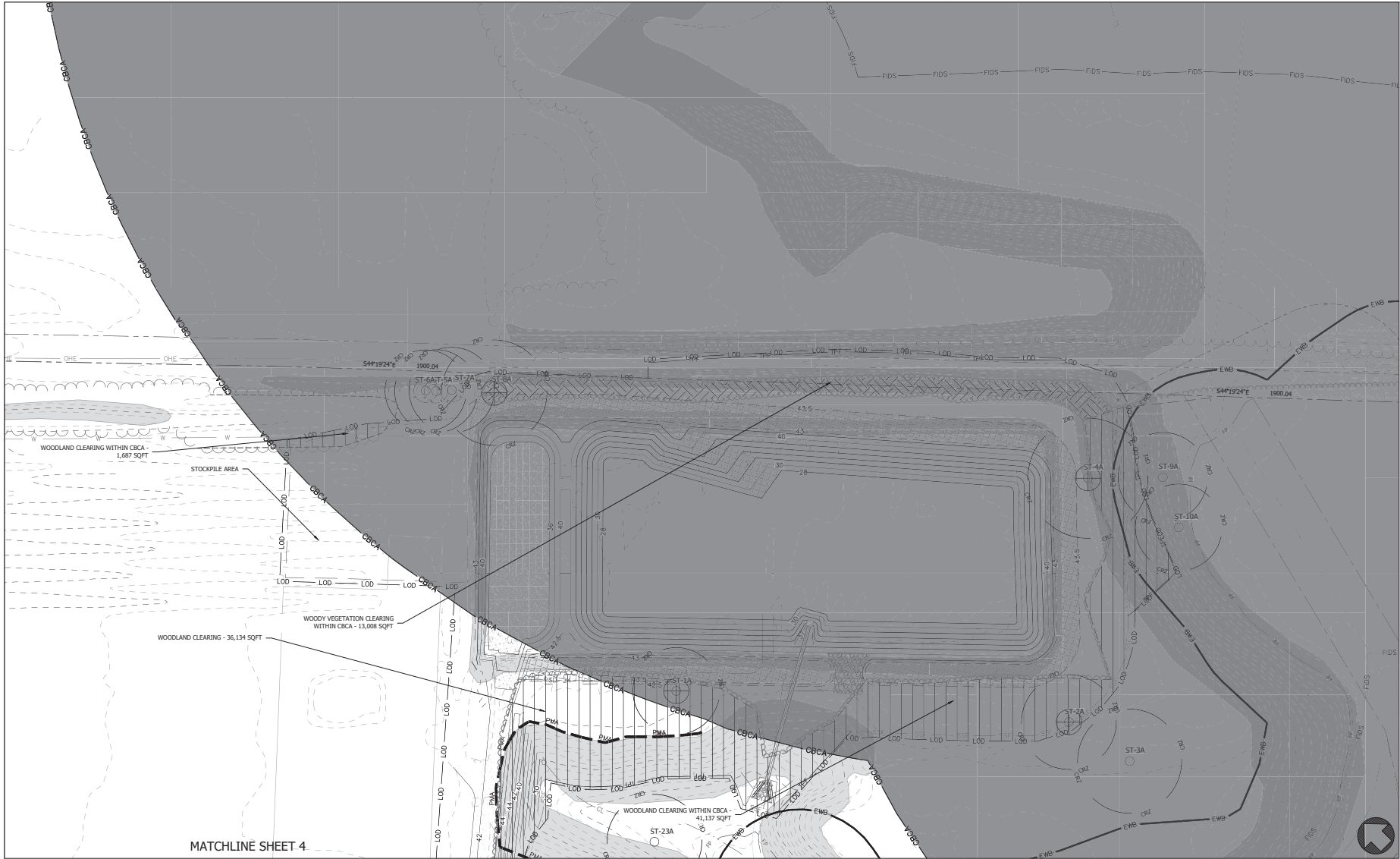

Prince George's County Planning Department, M-NCPPC Environmental Planning Section TYPE 2 TREE CONSERVATION PLAN APPROVAL TYP2-021-2024				
	Approved by	Date	CRD #	Reason for Revision
00	Heather Tatone	10/24/2024		
01				
02				
03				
04				
05				

LEGEND

— LOD — FOREST STAND BOUNDARY*
— L.O.D. — LIMIT OF DISTURBANCE / TRACT AREA
— SB — PROPERTY BOUNDARY
— WB — MARLBORO CLAY BOUNDARY
— PP — 100-YEAR FLOODPLAIN
— ADJACENT PROPERTY BOUNDARY
— EX. CONTOURS MAJOR
— EX. CONTOURS MINOR
— PMA — PRIMARY MANAGEMENT AREA (PMA)
— CBCA — CHESAPEAKE BAY CRITICAL AREA BOUNDARY

CL — CL
SB — SB
WB — WB
SSF — SSF
TPF — TPF
PPF — PPF
PSD-24 — PSD-24
EWS — EWS

EX. ROAD BOUNDARY
EX. BUILDING OUTLINE
REGULATED STREAM (CENTERLINE)
REGULATED 25' WETLAND BUFFER
PROPOSED CONTOUR
SUPER SALT FENCE
TREE PROTECTION FENCE (TEMP)
TREE PROTECTION FENCE (PERM)
EASEMENT
EXISTING 24" IN PIPE SLOPE DRAIN
EXPANDED WETLAND BUFFER

NON-TIDAL WETLAND
FOREST INTERIOR DWELLING SPECIES 300' HABITAT BUFFER
EX. TREE LINE
SPECIMEN TREE (>30" DBH)
CRITICAL ROOT ZONE
SLOPES > 15%
WOODLAND CLEARING
PROPOSED STOCKPILE

PROPOSED ASPHALT
PROPOSED RIPRAP
PROPOSED WOODLAND CONSERVATION NATURAL REGENERATION AREA
TREE REMOVAL
TREE PROTECTION PLANNING
FOREST CONSERVATION SIGN

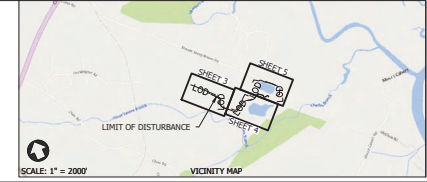

QUALIFIED PROFESSIONAL CERTIFICATION

This plan complies with the current requirements of Subtitle 25 and the Woodland and Wildlife Conservation Technical Manual

Heather Tatone
SIGNATURE

Heather Tatone
Coastal Resources, Inc.
25 Old Solomons Island Road
Annapolis, MD 21401
443-837-2146
heather@crs.biz

PROJECT TITLE

PRINCE GEORGE'S ORGANIC COMPOSTING FACILITY

6550 SE Crain Highway, Upper Marlboro,
MD, 20772 Prince George's County

SHEET TITLE

TYPE 2 TREE CONSERVATION PLAN

0 50 100 Feet
SCALE: 1" = 50'

REVISIONS			
No.	DATE	DESCRIPTION	REV BY

CHECKED BY: _____
DESIGNED: _____
DRAWN: _____
PROJECT No.: 2019-05
DATE: 8/10/2024
SHEET: