[illegible]

WOODLANDS PRESERVED, PLANTED, OR REGENERATED IN FULFILLMENT OF WOODLAND CONSERVATION REQUIREMENTS ON-SITE HAVE BEEN PLACED IN A WOODLAND AND WILDLIFE HABITAT CONSERVATION EASEMENT RECORDED IN THE PRINCE GEORGE'S COUNTY LAND RECORDS AT LIBER 50215 FOLIO 92. REVISIONS TO THIS TCP 2 MAY REQUIRE A REVISION TO THE RECORDED EASEMENT.

Prince George's County Planning Department, M-NCPPC Environmental Planning Section GENERAL INFORMATION TABLE		
LAYER CATEGORY	LAYER NAME	VALUE
Zone	Zoning (Zone)	LE
Zone	Aviation Policy Area (APA)	N/A
Administrative	Trax Grid (TMG)	9-04
Administrative	USDC Grid (Sheet 200)	21NE068; 217NE08
Administrative	Planning Areas (Plan Area)	60
Administrative	Election District (ED)	1
Administrative	Councilmember District (CD)	1
Administrative	General Plan 2002 (Tier 1)	DEVELOPING
Administrative	General Plan Growth Policy (2035)	EST. COMMUNITIES
Administrative	Police District	VI

If the site is within an APA, enter the name of the airport. If the site is not within an APA enter "N/A"

Prince George's County Planning Department, MNCPPC Environmental Planning Section TREE CONSERVATION PLAN TYPE 2 APPROVAL TCP2-032-2023			
APPROVED BY	DATE	DRD #	REASON FOR REVISION
N. NICHOLS	12-04-2024	SPE-2022-005	N/A
<i>Arian Meek</i>	2/20/2025	SPE-2022-005-01	MINOR ENGINEERING CHANGES

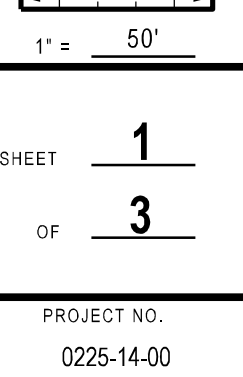

General Notes

- This plan is submitted to fulfill the woodland conservation requirements for SE-2022-005. If SE-2022-005 expires, then this TCP2 also expires and is no longer valid.
- Cutting or clearing of woodland not in conformance with this plan without the expressed written consent of the planning director or designer shall be subject to a \$50.00 per square foot mitigation fee.
- A pre-construction meeting is required prior to the issuance of grading permits, the department of public works and transportation or the department of environmental resources, as appropriate, shall be contacted prior to the start of any work on the site to conduct a pre-construction meeting where implementation of woodland conservation measures shown on the plan will be discussed in detail.
- The developer or builder of the lots or parcels shown on this plan shall notify future buyers of any woodland conservation areas through the provision of a copy of this plan at time of contract signing. Future property owners are also subject to this requirement.
- The owners of the property subject to this tree and zone plan are solely responsible for conformance to the requirements contained herein.
- The property is within the Developing Tier and is zoned IE (formerly I-3).
- The property is not adjacent to a road which is a designated historic roadway.
- The property is adjacent to the IOC which is classified as a Freeway and Konterra Drive which is an arterial road.
- This plan is not grandfathered under cb-27-2010, section 25-117(g).

- Woodlands preserved, planted, or regenerated in fulfillment of on-site woodland conservation requirements have been placed in a woodland and wildlife habitat conservation easement recorded in the Prince George's County Land Records at Liber xxx Folio xxx. Revisions to this TCP2 may require a revision to the recorded easement.
- Tree Preservation and Retention Notes:
 - All woodlands designated on this plan for preservation are the responsibility of the Property owner. The woodland areas shall remain in a natural state. This includes the canopy trees and understory vegetation. The Property owner shall be responsible for the maintenance of the woodland areas. The Property owner shall be responsible for the maintenance of the woodland areas. The Property owner shall be responsible for the maintenance of the woodland areas.

- The location of all Temporary Tree Protection Fencing (TPF) shown on this plan shall be flagged or staked in the field prior to the pre-construction meeting, upon approval of the Locations by the county inspector. Installation of the TPF may begin.
- All Temporary Tree Protection Fencing required by this plan shall be installed prior to Commencement of clearing and grading of the site and shall remain in place until the bond is Released for the project. Failure to install and maintain temporary or permanent tree protective devices is a violation of the TCP2.

- Woodland preservation areas shall be protected with signage as shown on the plans at the same time as the temporary TPF installation. These signs shall remain in perpetuity.

- Removal of Hazardous Trees or Limbs by Developers or Builders:
 - The developer and/or builder is responsible for the complete preservation of all forested Areas shown on the approved plan to remain undisturbed, only trees or parts thereof Designated by the county as dead, dying, or otherwise unsafe may be removed.

- During the initial stages of clearing and grading, if hazardous trees are present, or trees are Present that are not hazardous but that are in the path of the proposed development, the permittee shall Remove said trees using a chain saw, corrective measures requiring the removal of the Hazardous tree or portions thereof shall require authorization by the county inspector, only after approval by the inspector may the tree be cut by chainsaw to near the existing ground Level. The stump shall not be removed or covered with soil, mulch or other materials that Would inhibit sprouting.
- If a tree or trees become hazardous prior to bond release for the project, due to storm events Or other situations not resulting from an action by the permittee, prior to removal, a certified Arborist or a licensed tree expert shall be contacted to determine the condition of the tree in Question has a potential to fall and strike a structure, parking area, or other high use area and may result in personal injury or property damage. If a tree or portions thereof are in the path of the proposed development, the permittee shall immediately remove the tree or portions thereof. The permittee shall take corrective action immediately, the condition of the area shall be fully documented through Photographs prior to corrective action being taken. The photos shall be submitted to the inspector for documentation of the damage.

- If corrective pruning may alleviate a hazardous condition, the certified arborist or a licensed Tree expert may proceed without further authorization, the pruning must be done in Accordance with the latest edition of the appropriate ANSI-300 pruning standards. The Condition of the area shall be fully documented through photographs prior to corrective action being taken. The photos shall be submitted to the inspector for documentation of the damage.

- Debris from the tree removal or pruning that occurs within 35 feet of the woodland edge may be removed and properly disposed of by recycling, chipping or other acceptable methods. Debris that is more than 35 feet from the woodland edge shall be cut up to allow contact with the ground, thus encouraging decomposition. The smaller materials shall be placed into Brum piles that will serve as wildlife habitat.

- Tree work to be completed within a road right-of-way requires a permit from the Maryland Department of natural resources unless the tree removal is shown within the approved limits Of disturbance on a TCP2. The work is required to be conducted by a licensed tree expert.

- All existing debris shall be removed from the woodland preservation area and all proposed impact areas shall have all nuisance debris(bottles,cans,plastics and metal objects)removed.

Post Development Notes:

- If the developer or builder no longer has an interest in the property and the owner desires to remove a hazardous tree or portion thereof, the new owner shall obtain a written statement from a certified arborist or tree expert describing the hazardous condition and the proposed corrective measures prior to having the work conducted, after proper documentation has been completed per the "handout" guidance for Prince George's County property owners, preservation of woodland conservation areas, the arborist or tree expert may then remove the tree, the stump shall be cut as close to the ground as possible and left in place, the removal or grinding of the stumps in the woodland conservation area is not permitted.

- If a tree or portions thereof are in imminent danger of striking a structure, parking area, or other high use area and may result in personal injury or property damage from the certification is not required and the permittee shall take corrective action immediately, the condition of the area shall be fully documented through photographs prior to corrective action being taken, the photos shall be submitted to the inspector for documentation of the damage.

- Tree work to be completed within a road right-of-way requires a permit from the Maryland department of natural resources unless the tree removal is shown within the approved limits Of disturbance on a TCP2. The work is required to be conducted by a licensed tree expert.

- The removal of noxious, invasive, and non-native plant species from any woodland preservation area shall be done with the use of hand-held equipment only (pruners or a chain saw), these plants may be cut near the ground, thus encouraging decomposition. All material from these noxious, invasive, and non-native plants greater than two (2) inches diameter shall be cut to allow contact with the ground, thus encouraging decomposition.

- The use of broadcast spraying of herbicides is not permitted, however, the use of herbicides to discourage re-sprouting of invasive, noxious, or non-native plants is permitted if done as an application of the chemical directly to the cut stump immediately following cutting of plant tops, the use of any herbicide shall be done in accordance with the label instructions.

- The use of chainsaws is extremely dangerous and should not be conducted with poorly maintained equipment, without safety equipment, or by individuals not trained in the use of this equipment for the pruning and/or cutting of trees.

When off-site woodland conservation is proposed

- Prior to the issuance of the first permit for the development shown on this TCP2, all off-site woodland conservation required by this plan shall be identified on an approved TCP2 plan and recorded as an off-site easement in the land records of Prince George's County. Proof of recordation of the off-site conservation shall be provided to the M-NCPPC Planning Department prior to issuance of any permit for the associated plan.

- When Virginia pines are present within 40 feet of the limits of disturbance in a preservation area:
 - a. The subject property contains Virginia pines(Plus virginiana) which are subject to wind throw. All Virginia pines greater than 6 inches in diameter within 40 feet of the final proposed limit of disturbance or the boundary of the property shall be cut down by hand during the clearing of the site.
 - b. After the Virginia pines have been removed, the contractor responsible for implementation of the TCP2 shall submit an evaluation of the stocking levels for the residual stand, management techniques to be applied to the residual stand, and supplemental planting requirements to the M-NCPPC Planning Department. This evaluation shall be submitted prior to the issuance of the first building permit to ensure that all high risk trees have been removed. A planting schedule and details for the management of natural regeneration to fully restock the site must be shown on the plan.

- Invasive Species:
 - a. Invasive plant removal shall be completed prior to MID-SEPTEMBER and conform to the recommendations of the invasive plant removal plan shown on the plan prepared by SOLTESZ shown on this plan sheet.
 - b. The removal of noxious, invasive, and non-natives plant species shall be done with the use of hand-held equipment only such as pruners or a chain saw. These plants may be cut near the ground and the material less than two inches diameter may be removed from the area and disposed of appropriately. All material from these noxious, invasive, and non-native plants greater than two (2) inches diameter shall be cut to allow contact with the ground, thus encouraging decomposition.
 - c. The use of broadcast spraying of herbicides is not permitted, however, the use of herbicides to discourage re-sprouting of invasive, noxious, or non-native plants is permitted if done as an application of the chemical directly to the cut stump immediately following cutting of plant tops. The use of any herbicide shall be done in accordance with the label instructions and be applied by a certified pesticide applicator.

Afforestation and Reforestation Notes

- All afforestation and reforestation projects, based on square footage, shall be posted with the county prior to the issuance of any permits. These bonds will be retained as surety until all required activities have been satisfied or the required timeframe for maintenance has passed, whichever is longer.
- The planning of afforestation or reforestation areas shall be completed prior to the issuance of the first building permit. (This standard may be modified as necessary to address which building permits are adjacent to the proposed planting area.) Seeding planting is to occur from November through May only. No planting shall be done while ground is frozen. Planting with larger caliper stock or containerized stock may be done at any time provided a detailed maintenance schedule is provided.
- C. If planting cannot occur due to planting conditions, the developer or property owner shall install the fencing and signage in accordance with the approved Type 2 Tree Conservation Plan. Planting shall then be accomplished during the next planting season. If planting is delayed beyond the transfer of the property title to the homeowner, the developer or builder shall obtain a signed statement from the purchaser indicating that they understand that the reforestation area is located on their property and that reforestation will occur during the next planting season. A copy of that document shall be conformance to the requirements contained herein.

- D. Reforestation areas shall not be moved. The management of competing vegetation around individual trees and the removal of noxious, invasive, and non-native vegetation within the reforestation areas is acceptable.

- E. All required temporary tree protection fencing shall be installed prior to the clearing and grading of the site and shall remain in place until the permanent tree protection fencing is installed with the required planting. The temporary fencing is not required to be installed if the permanent fencing is installed prior to clearing and grading of the site. Failure to install and maintain temporary or permanent tree protective fencing is a violation of this TCP2.

- F. Afforestation/reforestation areas shall be posted with notification signage, as shown on the plans, at the same time as the permanent protection fencing installation. These signs shall remain in perpetuity.

- G. The county inspector shall be notified prior to soil preparation or initiation of any tree planting on this site.

- H. At time of issuance of the first permit, the following information shall be submitted to the M-NCPPC Planning Department regarding the contractor responsible for implementation of this plan: contractor name, business name (if different), address, phone number. Results of annual survival checks for each of the required four years after tree planting shall be reported to the M-NCPPC Planning Department.

- I. Failure to establish the afforestation or reforestation within the prescribed time frame will result in the forfeiture of the reforestation bond and/or a violation of this plan including the associated \$50.00 per square foot penalty unless the county inspector approves a written extension.

Planting Specification Notes

- Quantity: (See Plant Schedule)
- Type: (See Plant Schedule)
- Plant Quality Standards: The plants selected shall be healthy and sturdy representatives of their species. Seedlings shall have a minimum top growth of 18". The diameter of the root collar (the part of the root just below ground level) shall be at least 5/8". The roots shall be well developed and at least 2' long, no more than twenty-five percent (25%) of the root system (both primary and auxiliary) shall be present. Plants that do not have an abundance of well developed terminal buds on the leaders and branches shall be rejected.

- Plants shall be shipped by the nursery immediately after lifting from the field or removal from the green house, and planted immediately upon receipt by the landscape contractor.

- If the plants cannot be planted immediately after delivery to the reforestation site, they shall be stored in the shade with their root masses protected from direct exposure to sun and wind by the use of straw, peat moss, compost, or other suitable material and be maintained through periodic watering, until the time of planting.

- Plant Handling: The quantity of seedlings taken to the field shall not exceed the quantity that can be planted in a day. Seedlings, once removed from the nursery or temporary storage area shall be planted immediately.

- Timing of Planting: The best time to plant seedlings is while they are dormant, prior to spring budding. The most suitable months for planting are March and April, when the soil is moist, but may be planted from March through November. No planting shall be done while ground is frozen. Planting shall occur within one growing season of the issuance of grading/building permits and/or reaching the first grade and stabilization of planting areas.

- Seeding Planting: Tree seedlings shall be hand planted using a dibble bar or sharp-shovel grade. It is important that the seedling be placed in the hole so that the roots can spread out naturally, they should not be twisted, balled up or bent. Moist soil should then be packed firmly around the roots. Seedlings should be planted at a depth where their roots lie just below the ground surface. Air pockets should not be left after clearing the hole which would allow the roots to dry out. See planting details for further explanation. If retractor/wheelers to plant by another method, the preparer of this tree conservation plan must be contacted and give his approval before planting may begin.

- Spacing: See Plant Schedule and/or Planting Plan for spacing requirements. Also refer to the Planting Layout detail for a description of the general planting theory.

- Soil: Upon the completion of all grading operations, a soil test shall be conducted to determine what soil preparation and soil amendments, if any, are necessary to create good tree growing conditions. Soil samples shall be taken at a rate that provides one soil sample for each area that appears to have a different soil type (if the entire area appears uniform, then only one sample is necessary), and submitted for testing to a private company. The company of choice shall make recommendations for improving the existing soil. The soil will be tested and recommended for corrections of soil texture, pH, magnesium, phosphorus, potassium, calcium and organic matter.

- Soil Improvement Measures: the soil shall then be improved according to the recommendations made by the testing company.

- Fencing and Signage: Final protective fencing shall be placed on the visible and/or development side of planting areas. The final protective fence shall be installed upon completion of planting operations unless it is installed during the initial stages of development. Signs shall be posted per the signage detail on this sheet.

- Planting method: Consult the Planting Detail(s) shown on this plan.

- Mulching: Apply two-inch thick layer of woodchip or shredded hardwood mulch (as noted) to each planting site (see detail shown on this plan).

- Groundcover Establishment: the remaining disturbed area between seeding planting sites shall be seeded and stabilized with white clover seed at the rate of 5 lbs/acre.

- Mowing: No mowing shall be allowed in any planting plan.

- Survival Check for Bond Release: The seeding planting is to be checked at the end of each year for four years to assure that not less than 75% of the original planted quantity survives. If the minimum number has not been provided the area must be supplemented with additional seedlings to reach the required number at time of planting.

- Source of Seedlings: state name, address, and phone number of nursery or supplier.

Four Year Management Plan for Reafforestation Areas

- Field check the re-afforestation areas according to the following schedule:

- Year 1: Site preparation and Tree Planting
Survival check once annually (September-November) (see Note 1) Watering is needed (2 x month) Control of undesirable vegetation as needed (1 x in June and 1 x in September min.)

- Year 2-3: Reinforcement planting is needed (See Note 2) Survival check once annually (September-November) Control of undesirable vegetation if needed (1 x in May and 1 x in August min.)

- Year 4: Reinforcement planting if needed (See Note 2) Survival check (September-November)

1. Survival Check: Check planted stock against plant list for as-built by walking the site and taking inventory. Plants must show vitality. Submit field data forms (Condition Check Sheets) to owner after each inspection. Remove all dead plants.

2. Reinforcement Planting: Replace dead or missing plants in sufficient quantity to bring the total number of live plants to at least 75% of the number originally planted. If a particular species suffers unusually high mortality, replace with an alternative plant type.

3. Miscellaneous: Fertilization or watering during years 1 through 3 will be done on as needed basis. Special report operations or recommendations will be conducted on as needed basis.

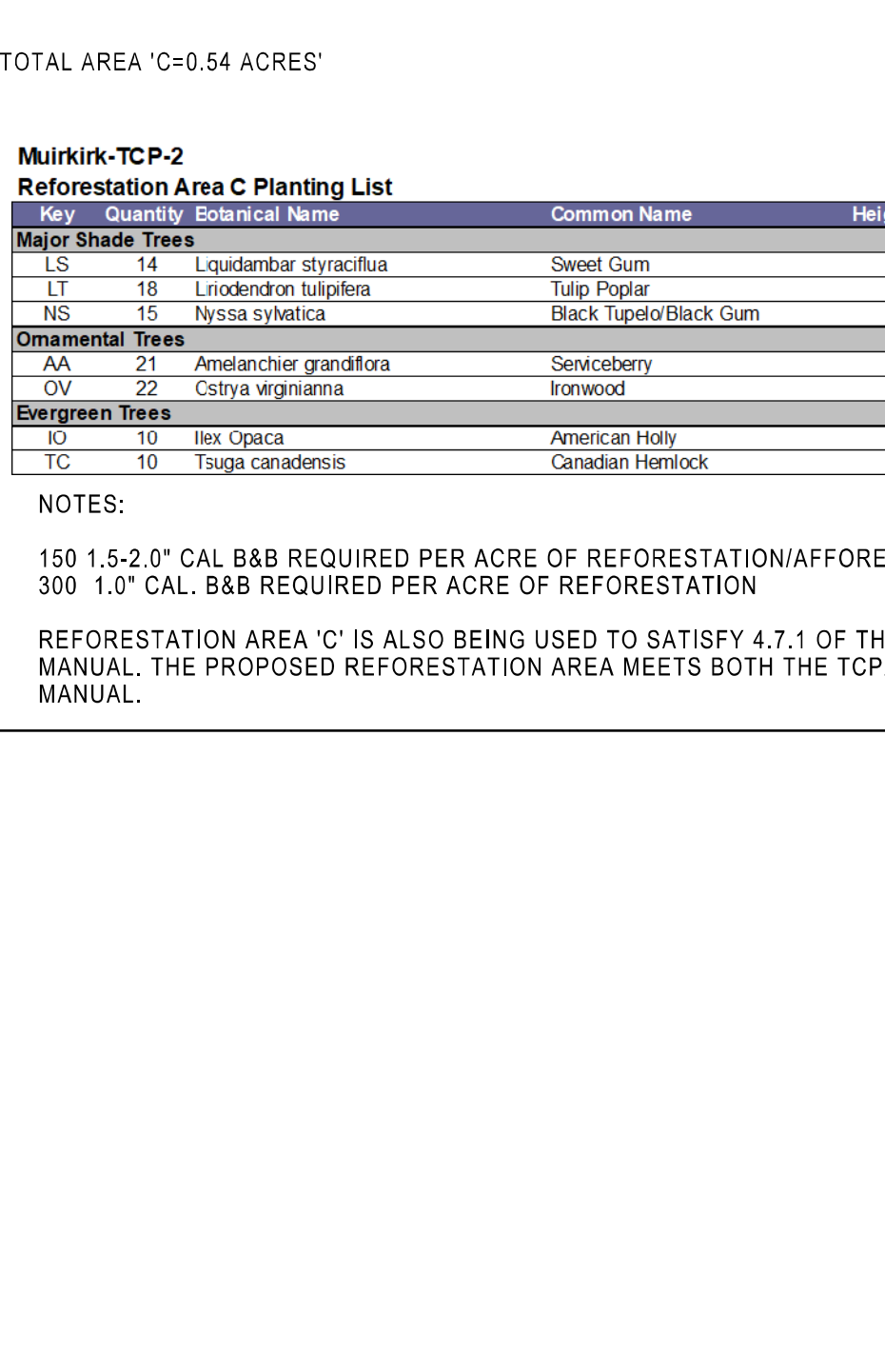
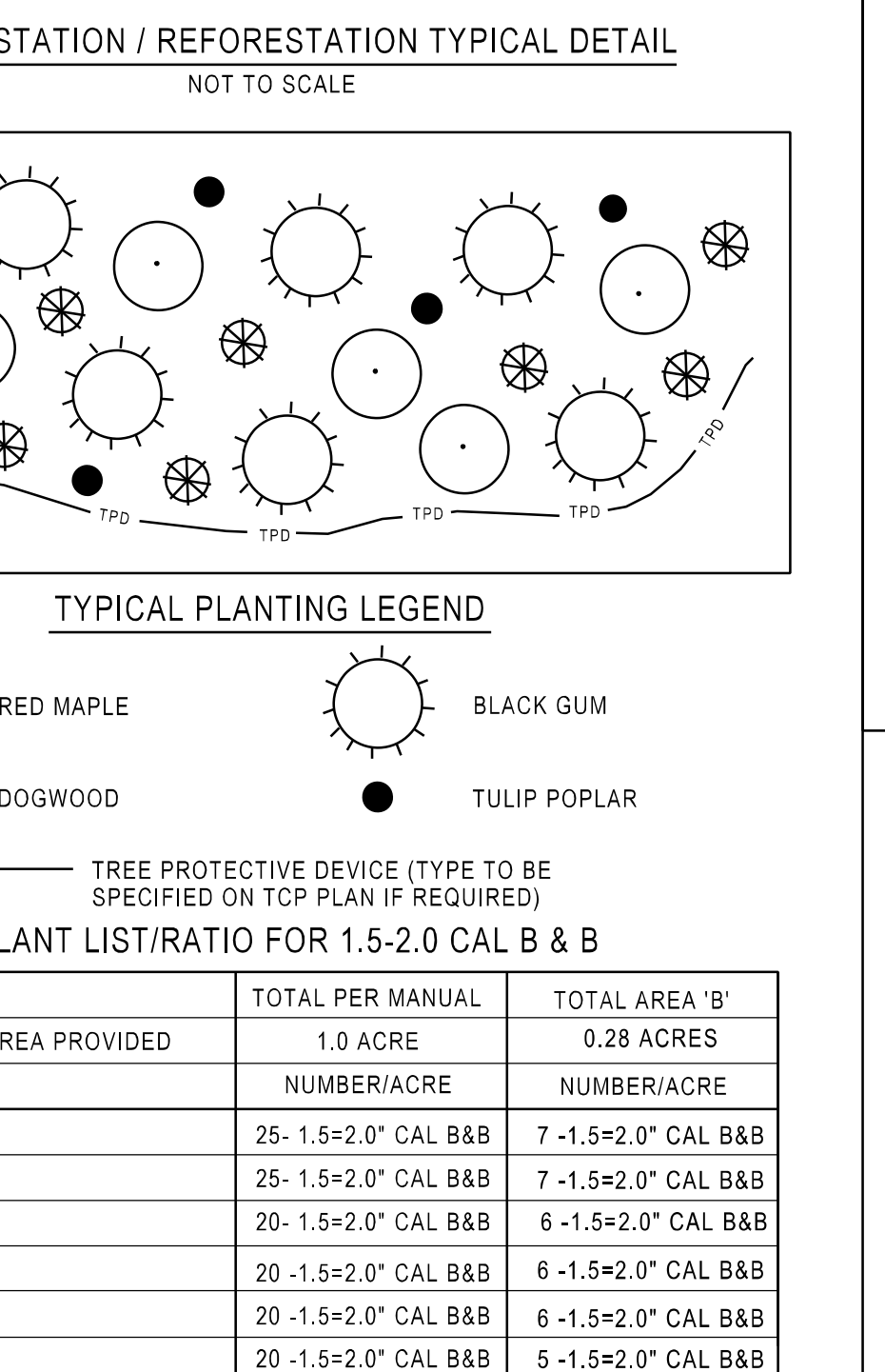
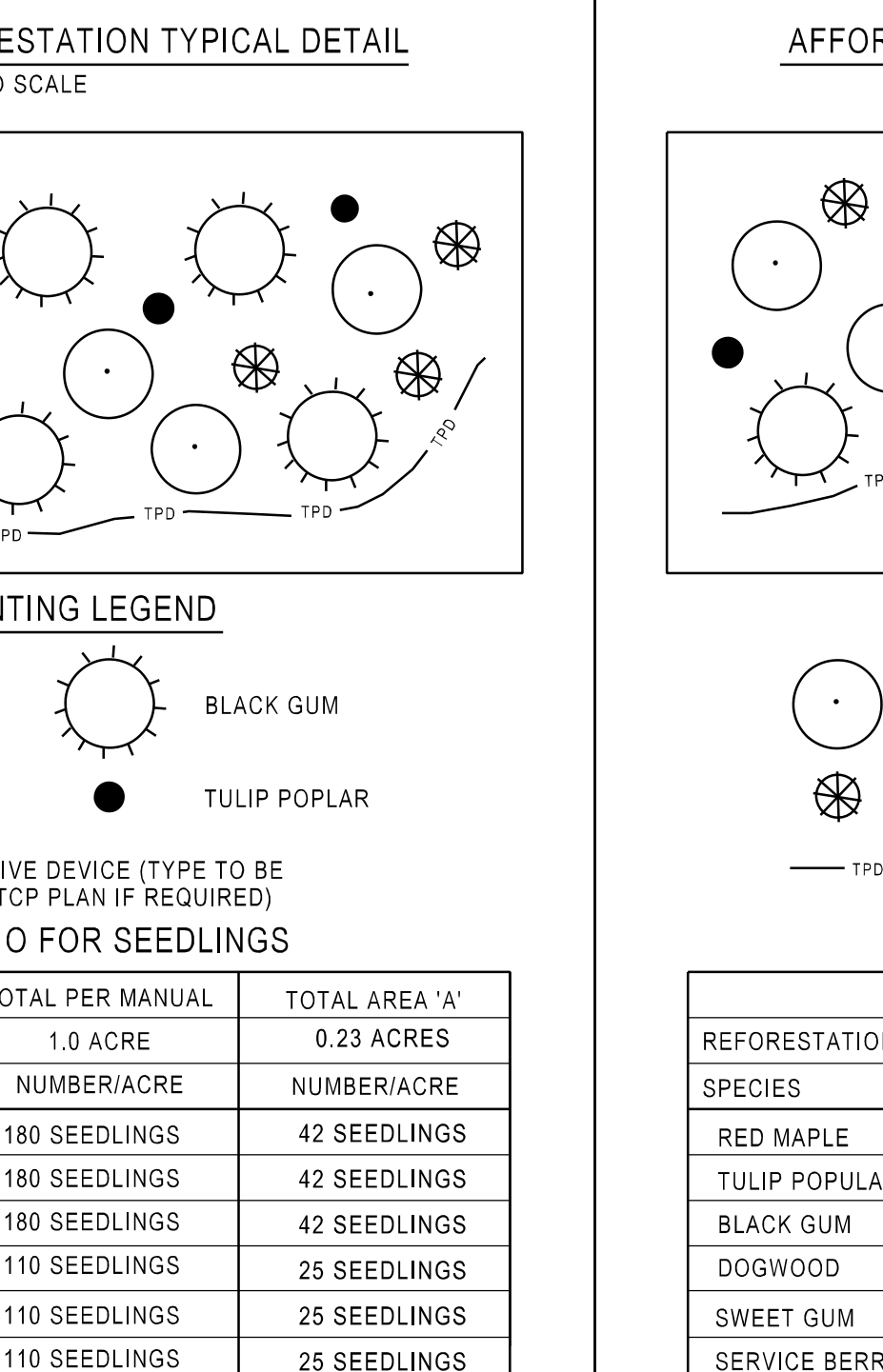
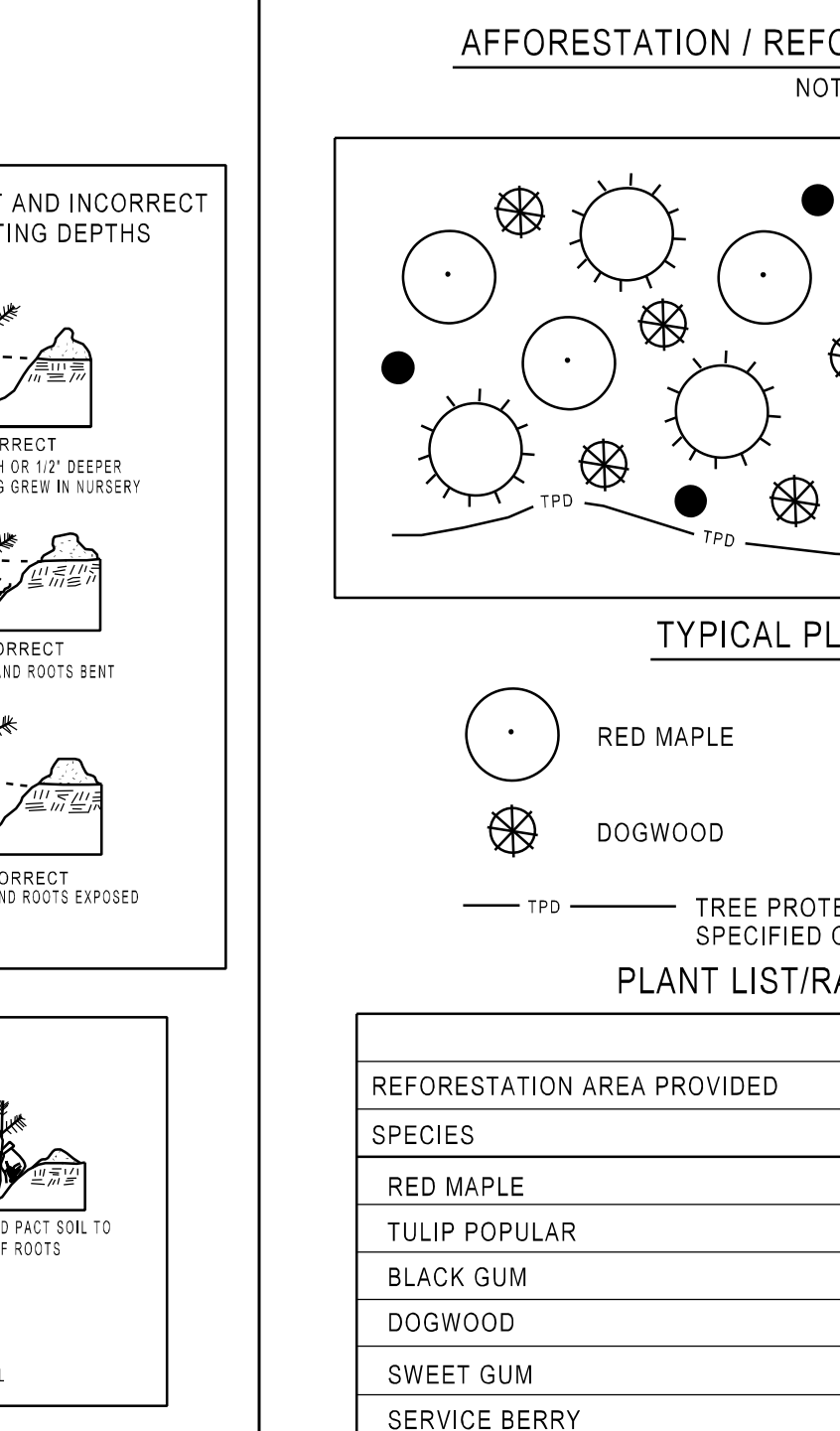
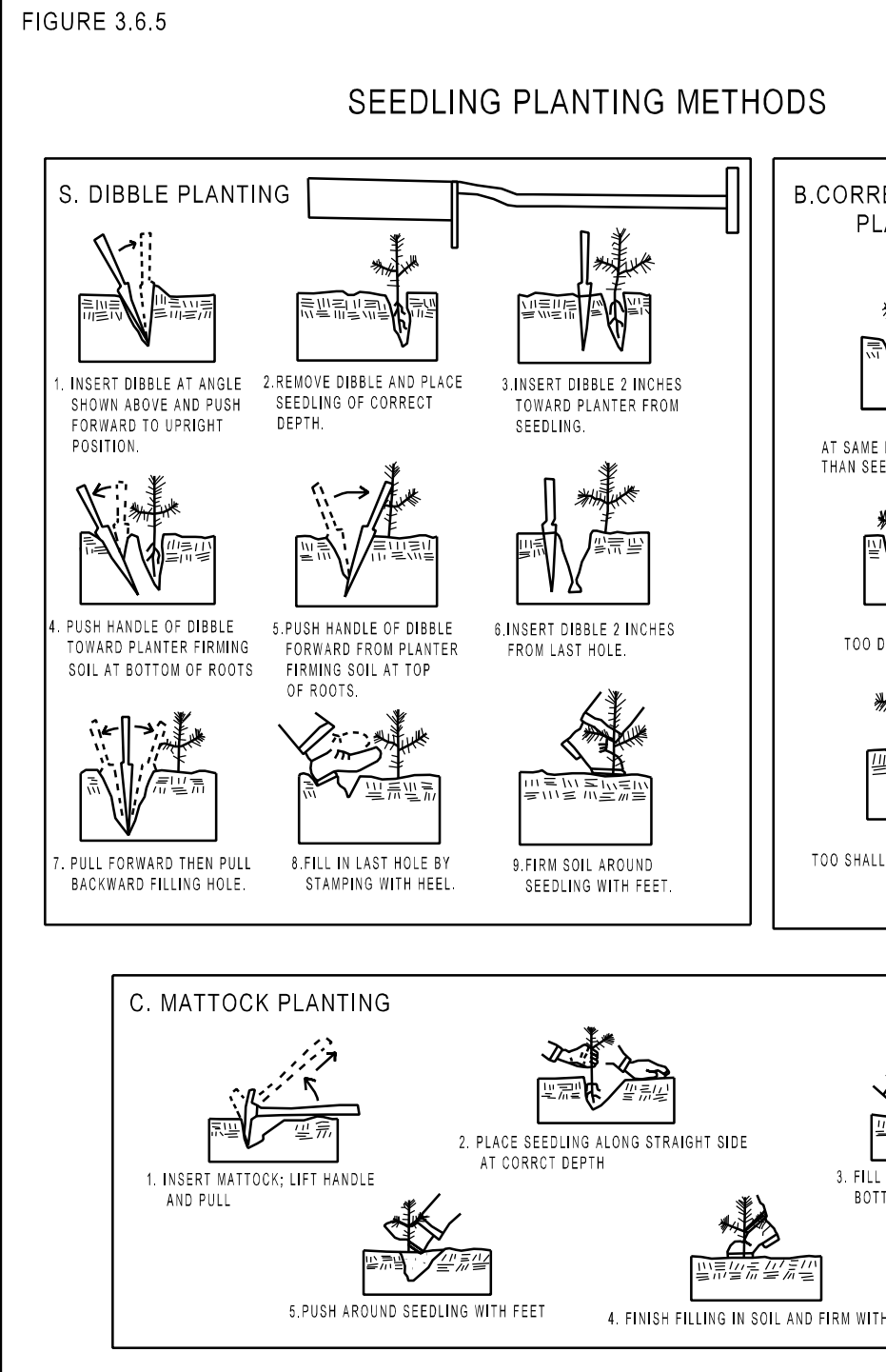
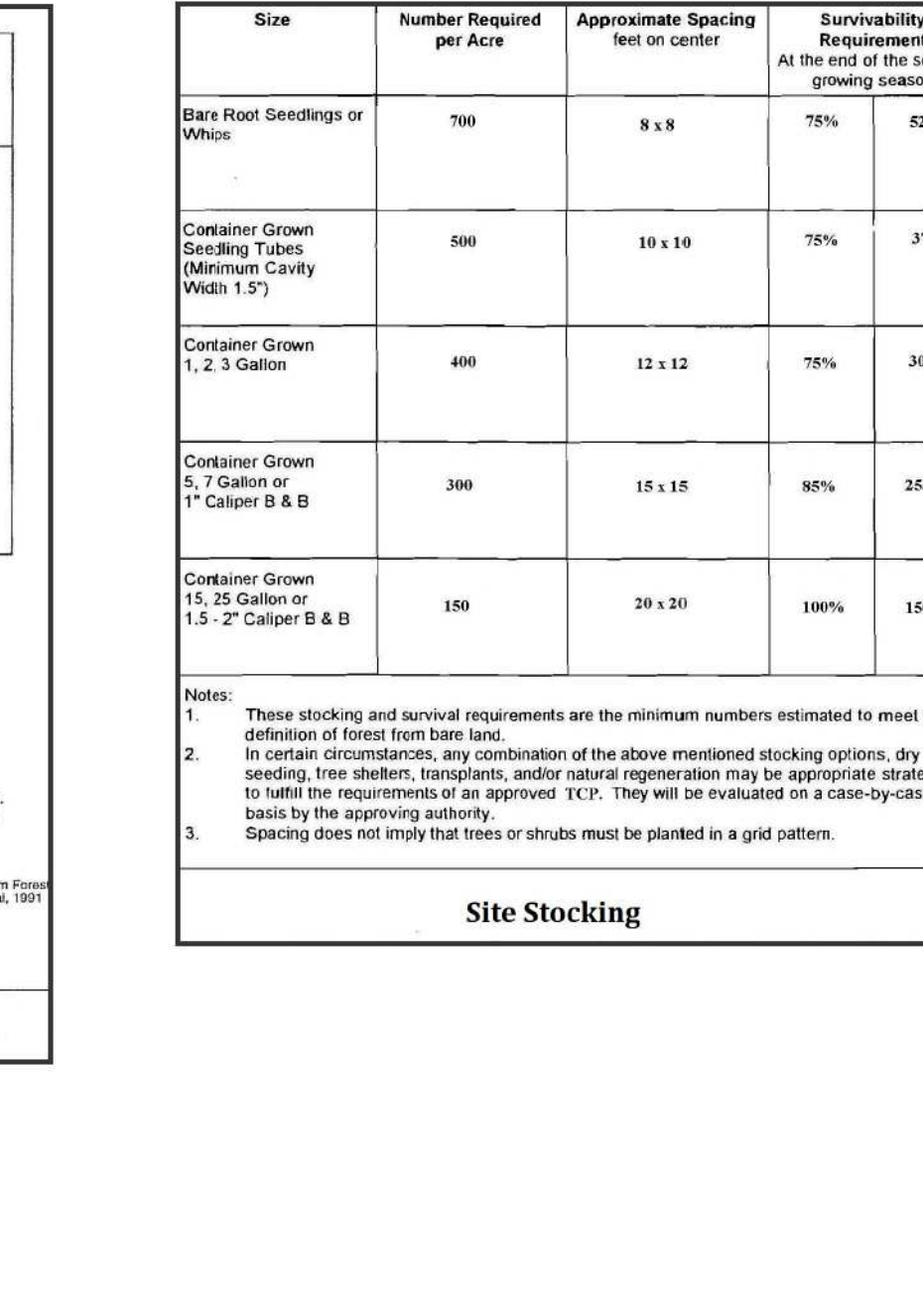
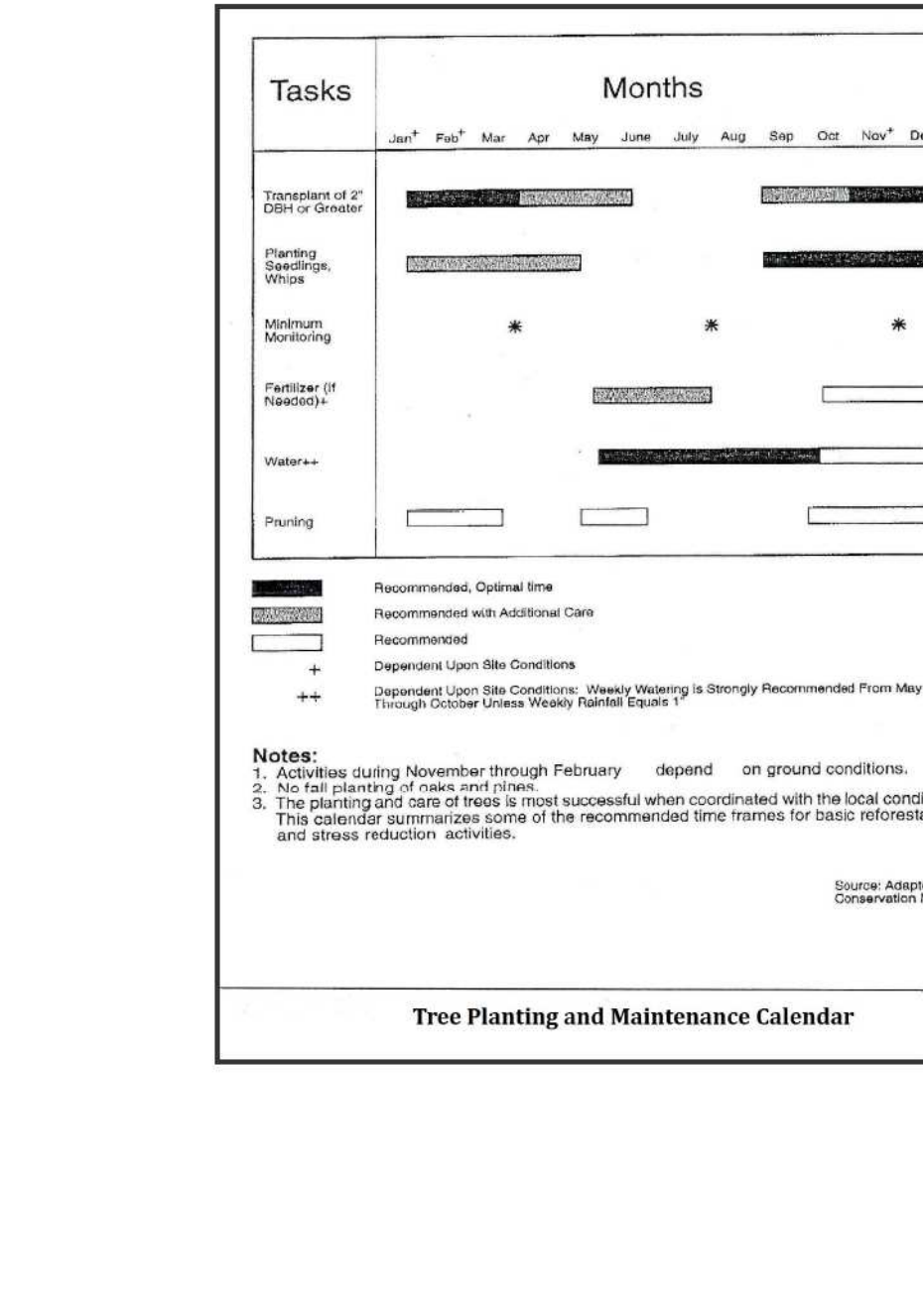
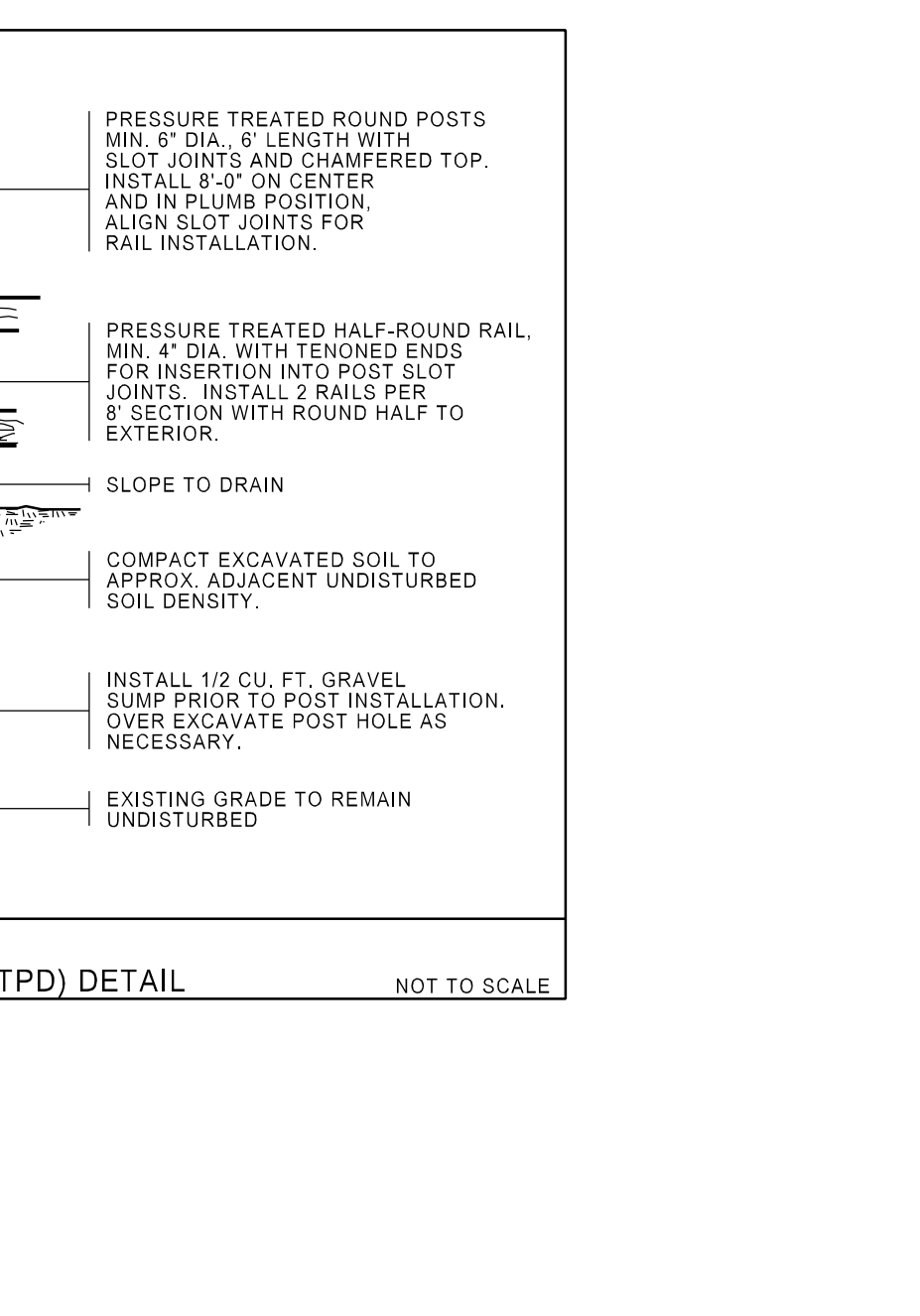
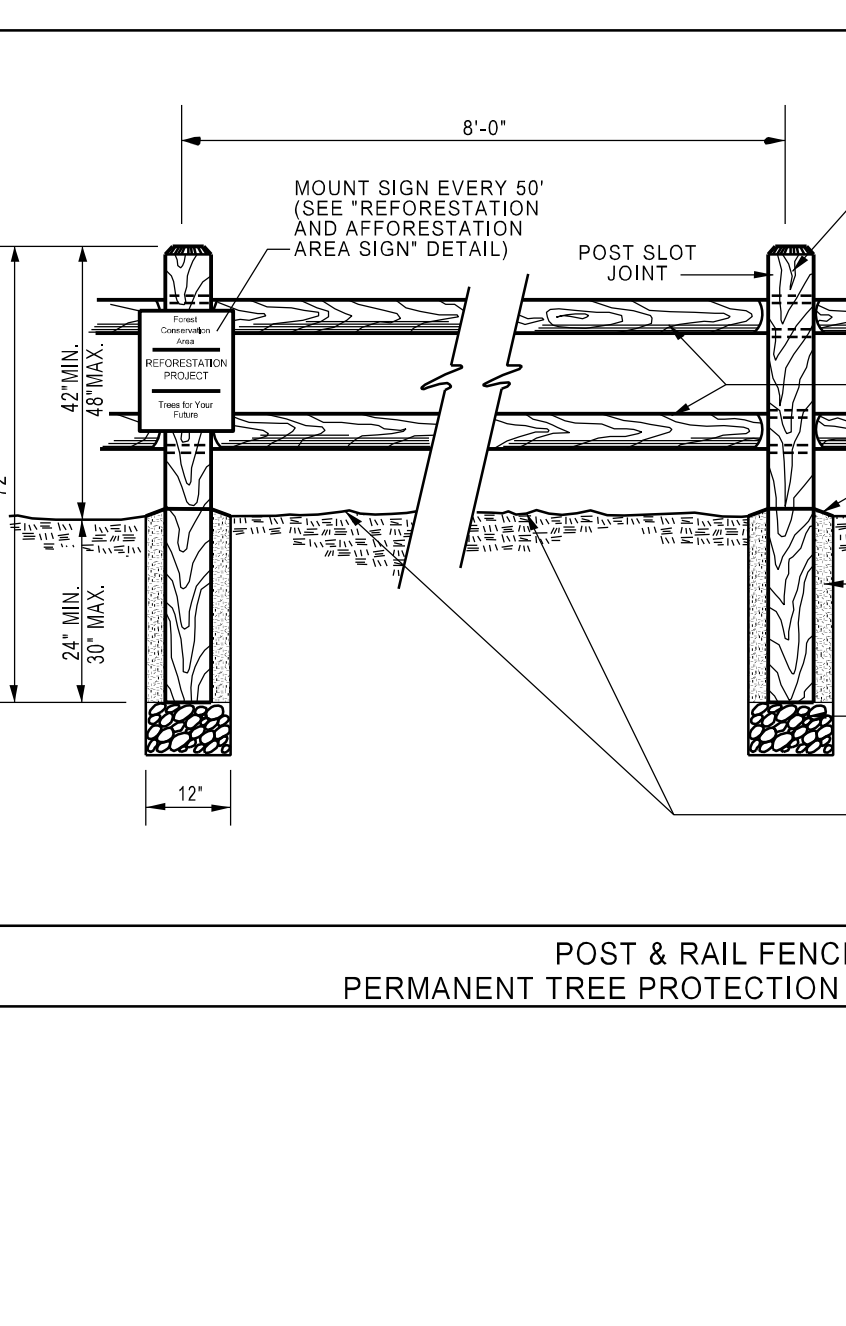
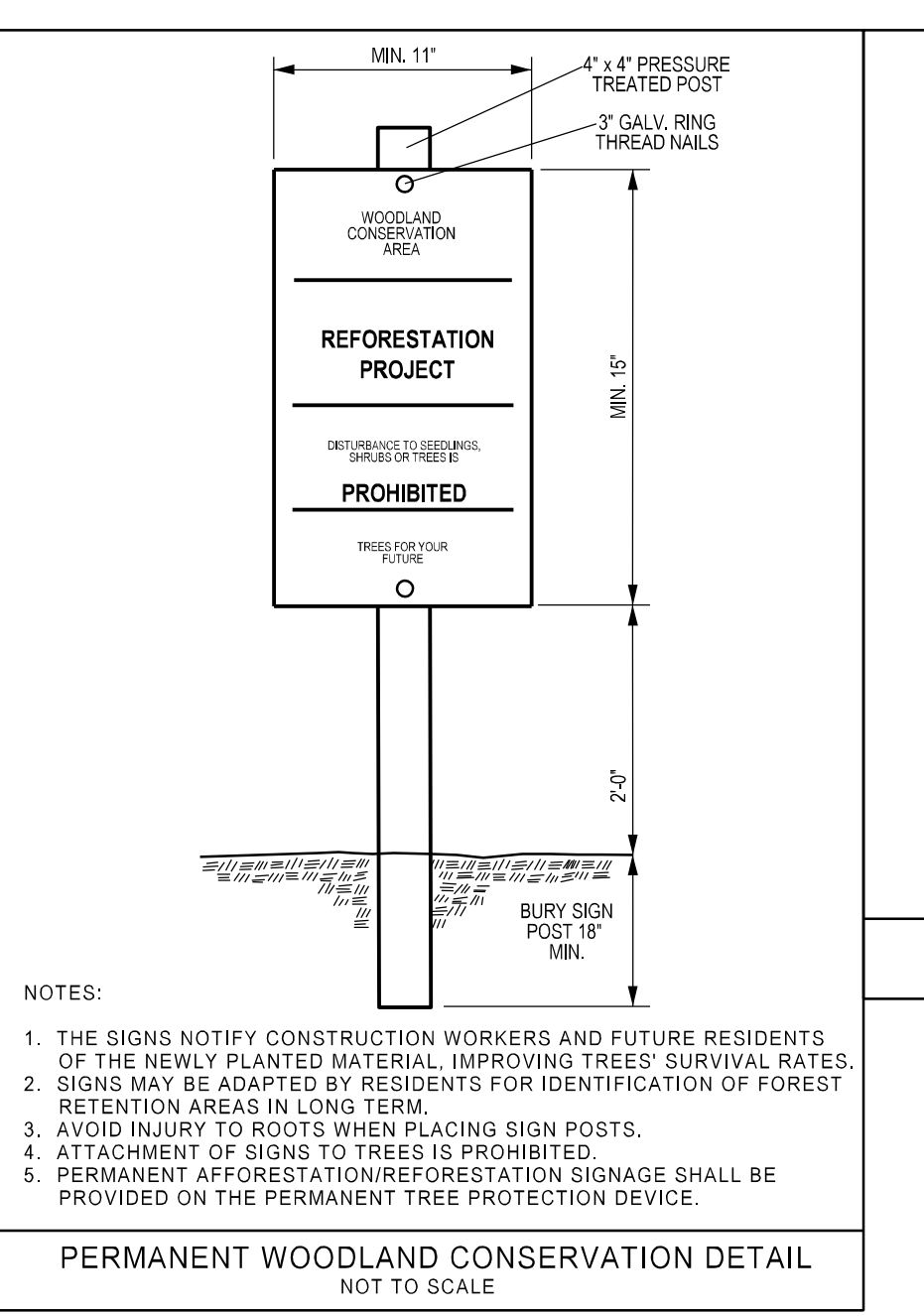
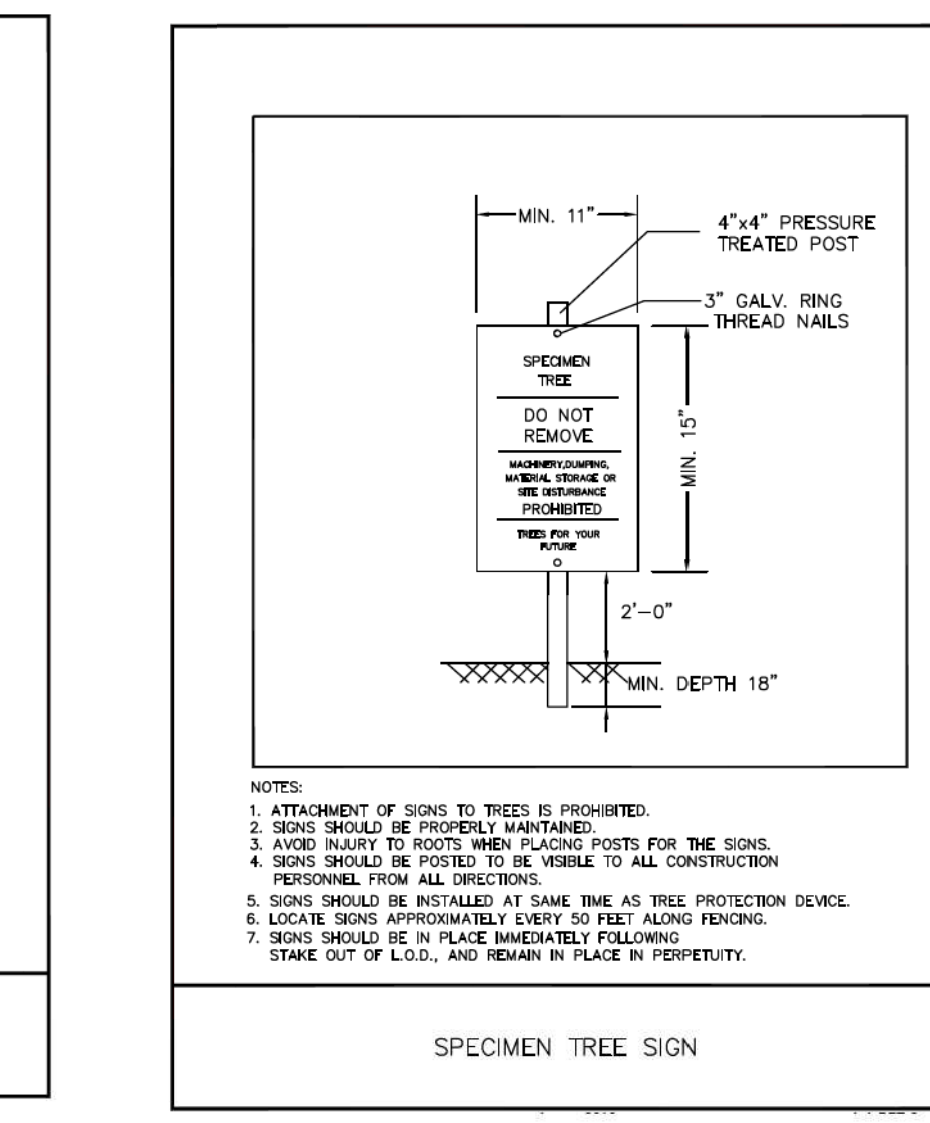
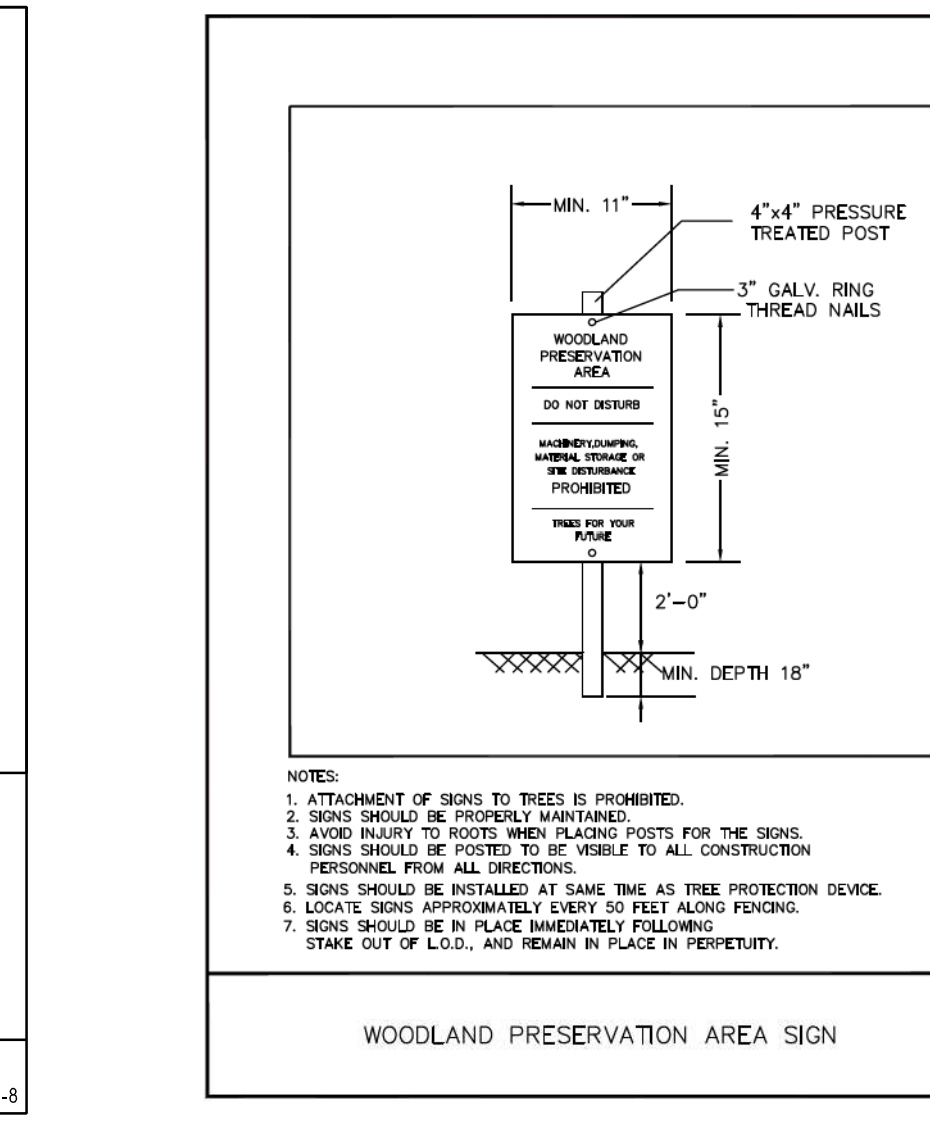
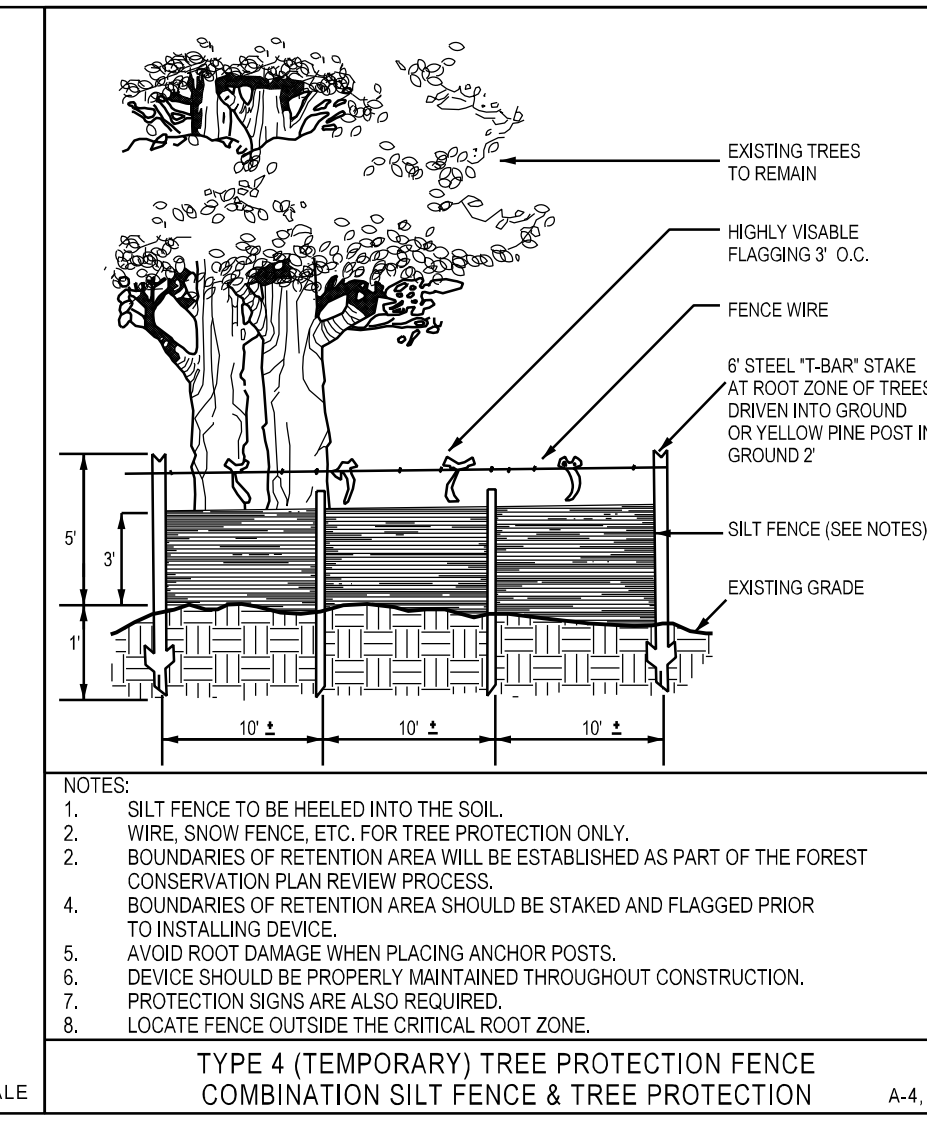
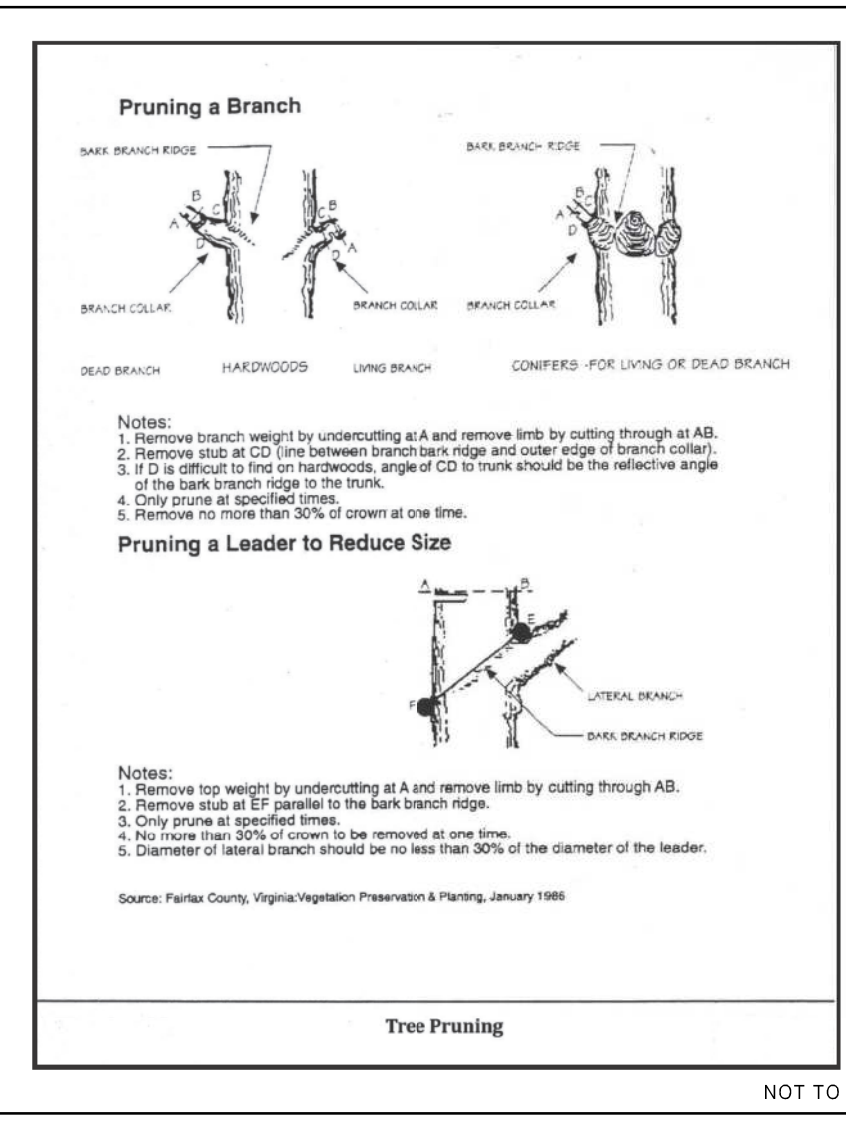
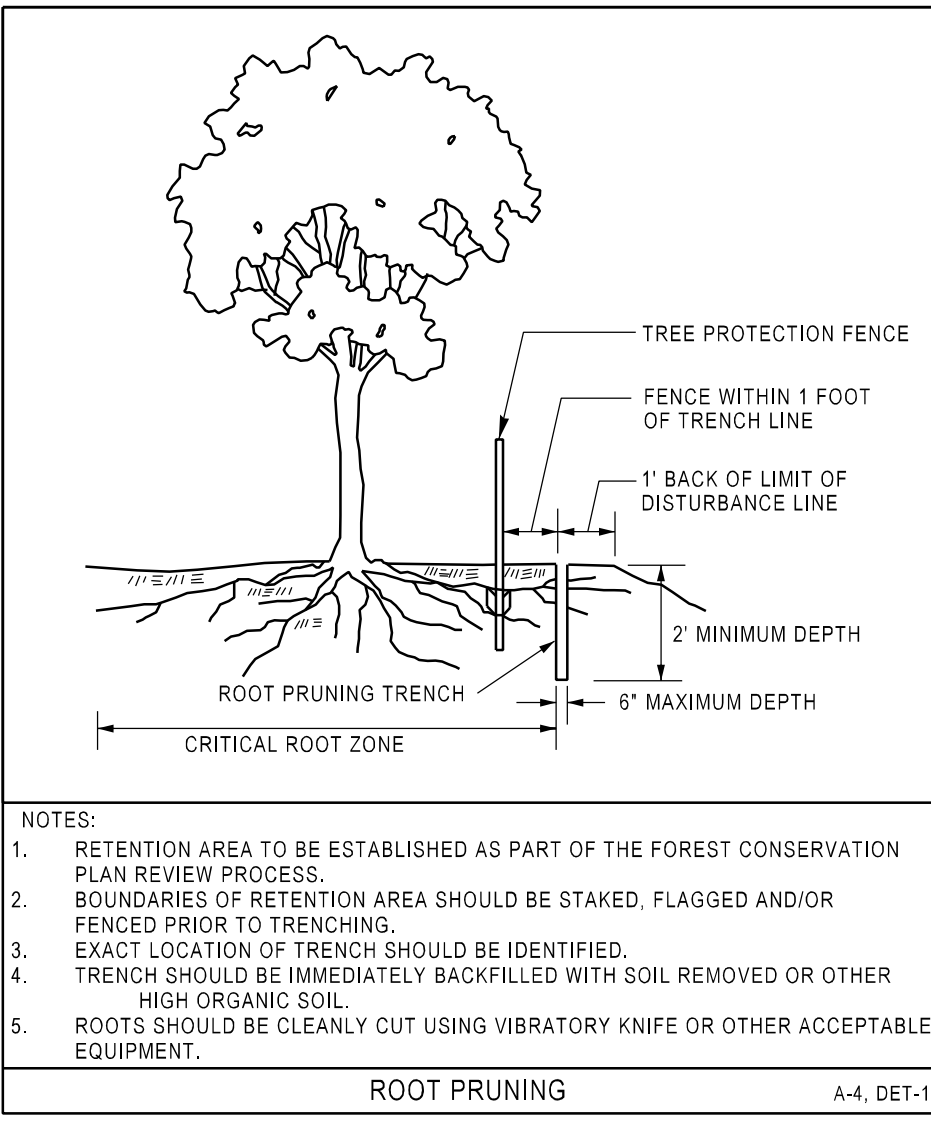

SOLTESZ, LLC
LANHAM OFFICE
4300 Forbes Boulevard, Suite 230
Lanham, MD 20706
P. 301.794.7555 F. 301.794.7656
www.soltesz.com

NO.	REVISIONS	BY	DATE
1	SEPTEMBER 2022	TECHNICAL: DUB	18 - NCS
2	DESIGNED: DUB	CHADNICK: DUB	
3	CHECKED: DUB		

MISS UTILITY NOTE
INFORMATION CONCERNING EXISTING UNDERGROUND UTILITIES WAS OBTAINED FROM AVAILABLE RECORDS. THE CONTRACTOR MUST DETERMINE THE EXACT LOCATION AND ELEVATION OF ALL EXISTING UTILITIES AND UTILITY CROSSINGS PRIOR TO ANY EXCAVATION. CONTACT MISS UTILITY AT 1-800-267-7777. 48 HOURS PRIOR TO THE START OF EXCAVATION. IF CLEARANCES ARE LESS THAN SHOWN ON THE PLAN OR TWELVE (12) INCHES, WHICHEVER IS LESS, CONTACT THE ENGINEER AND THE UTILITY COMPANY BEFORE PROCEEDING WITH CONSTRUCTION. CLEARANCES LESS THAN NOTED MAY REQUIRE REVISIONS TO THIS PLAN.

OWNER/APPLICANT
MUIRKIRK ENTERPRISES LLC
7315 WISCONSIN AVENUE
SUITE 800
BETHESDA, MD 20814

TAX MAP
9-04
216N002, 217N006
ZONING CATEGORY:
IE
XXXX
XXXX
XXXX

STATE OF MARYLAND LANDSCAPE ARCHITECT
2/19/2025

TREE CONSERVATION PLAN TYPE II
TCP2-032-2023
MUIRKIRK WAREHOUSES
MUIRKIRK ROAD & KONTERA DRIVE
BELTSVILLE, MD 20705
VANVILLE (1st) ELECTION DISTRICT, PRINCE GEORGE'S COUNTY, MARYLAND

REASON FOR REVISION
DATE: 12/04/2024
SPE-2022-005
N/A
MINOR ENGINEERING CHANGES
SHEET 2 OF 3
PROJECT NO. 0225-14-00

The original of this drawing document was prepared by Soltesz, LLC (SOLTESZ). This document was not obtained directly from SOLTESZ and/or it was transmitted electronically. SOLTESZ cannot guarantee that unauthorized changes and/or alterations were not made by others. If verification of the information contained herein is needed, contact should be made directly with SOLTESZ. SOLTESZ makes no warranties, express or implied, concerning the accuracy of any information that has been transmitted by electronic means.



INVASIVE SPECIES MANAGEMENT AREA 'A'

- 1) PRELIMINARY SITE GRADING THE INITIAL CONTROL OF THE INVASIVE SPECIES ON THIS SITE BEGINS WITH THE INITIAL SITE GRADING UP TO THE LIMITS OF DISTURBANCE (LOD). THIS INITIAL GRADING WILL BE THE MOST EFFECTIVE WAY TO REMOVE THESE INVASIVE SPECIES BY REMOVING BOTH THE ABOVE GROUND AND BELOW GROUND (ROOTS) PORTION OF THE PLANTS.
- 2) ONCE THE INITIAL GRADING HAS BEEN COMPLETED MECHANICAL CONTROLS WILL BE USED, PREFERABLY DURING THE DORMANT SEASON OR SPRING GROWING SEASON. CONTROL DURING THE WINTER AND/OR SPRING WILL HELP TO MINIMIZE SEED DISPERSAL SHOULD ANY SEED BE PRESENT ON THE STEMS OF THESE INVASIVE SPECIES.
- 3) THE MECHANICAL CONTROL PORTION OF THE WORK WILL INVOLVE MANUALLY UPROOTING ANY STEMS THAT CAN BE EASILY PULLED FROM THE GROUND BY HAND AND DISPOSING OF THE PLANT MATERIALS IN A MANNER SO AS TO ENSURE REROOTING AND RESEEDING CANNOT OCCUR. THIS IS TYPICALLY DONE BY DISPOSAL IN SEAL REFUSE BAGS WITH THOSE BAGS THEN GOING TO A LANDFILL.
- 4) ALL PLANT MATERIAL EITHER UPROOTED OR CUT SHALL BE DISPOSED OF SO AS TO MINIMIZE SEED FROM THE PLANT MATERIAL REMOVED IS MINIMIZED. BECAUSE MANY OF THESE SPECIES WILL SPROUT PROLIFERICALLY FROM THE ROOTS AND FROM CUT STEMS, IT IS IMPORTANT NOT TO LEAVE THE PLANT MATERIAL ON-SITE WHERE IF LEFT IN CONTACT WITH DAMP SOILS THERE IS A POTENTIAL FOR REROOT AND REGROWTH.
- 5) THE REMOVAL OF ALL VEGETATION AND DEVELOPMENT OF THE SITE IN MANAGEMENT AREA 'A' WILL ELIMINATE THE INVASIVE SPECIES.

INVASIVE SPECIES MANAGEMENT AREA 'B'

- 1) NO SITE GRADING PERMITTED WITHIN INVASIVE SPECIES MANAGEMENT AREA 'B' THE INITIAL CONTROL OF THE INVASIVE SPECIES IN THIS AREA BEGINS WITH THE MOWING OF AREAS WHERE MOWING EQUIPMENT IS PERMITTED AND MANAGEABLE. THIS SHOULD BE DONE BEFORE IT GOES TO SEED (ONCE IN MID AUGUST AND AGAIN IN MID-LATE SEPTEMBER).
- 2) WHEN MOWING IS NOT AN OPTION, WEED EATING THE STILTGRASS BEFORE IT GOES TO SEED (ONCE IN MID AUGUST AND AGAIN IN MID-LATE SEPTEMBER) - WOULD BE LABOR INTENSIVE BUT MIGHT PROVIDE SOME CONTROL.
- 3) ONCE THE INITIAL MECHANICAL CONTROLS HAS BEEN COMPLETED, ADDITIONAL MANUAL CAN BE USED WHICH INCLUDE UPROOTING OF SMALLER PLANTS BY PULLING WITH HANDS, JUST AS IF WEEDING A GARDEN, UPROOTING WITH THE AID OF SMALL HAND TOOLS, HAND DIGGING WITH SHOVELS TO REMOVE THE ENTIRE PLANT AND ROOT SYSTEM, CUTTING THE ABOVE GROUND PORTION OF THE PLANT WITH HAND TOOLS. THIS WOULD BE EXTREMELY LABOR INTENSIVE BUT MIGHT PROVIDE SOME CONTROL, IN-HARD TO REACH AREAS. ALL WORK SHOULD BE DONE PREFERABLY DURING THE DORMANT SEASON OR SPRING GROWING SEASON. CONTROL DURING THE WINTER AND/OR SPRING WILL HELP TO MINIMIZE SEED DISPERSAL SHOULD ANY SEED BE PRESENT ON THE STEMS OF THESE INVASIVE SPECIES.
- 4) THE MECHANICAL CONTROL PORTION OF THE WORK WILL INVOLVE MANUALLY UPROOTING ANY STEMS THAT CAN BE EASILY PULLED FROM THE GROUND BY HAND AND DISPOSING OF THE PLANT MATERIALS IN A MANNER SO AS TO ENSURE REROOTING AND RESEEDING CANNOT OCCUR. THIS IS TYPICALLY DONE BY DISPOSAL IN SEAL REFUSE BAGS WITH THOSE BAGS THEN GOING TO A LANDFILL.
- 5) ALL PLANT MATERIAL EITHER UPROOTED OR CUT SHALL BE DISPOSED OF SO AS TO MINIMIZE SEED FROM THE PLANT MATERIAL REMOVED IS MINIMIZED. BECAUSE MANY OF THESE SPECIES WILL SPROUT PROLIFERICALLY FROM THE ROOTS AND FROM CUT STEMS, IT IS IMPORTANT NOT TO LEAVE THE PLANT MATERIAL ON-SITE WHERE IF LEFT IN CONTACT WITH DAMP SOILS THERE IS A POTENTIAL FOR REROOT AND REGROWTH.
- 6) JAPANESE STILTGRASS IS VERY DIFFICULT TO CONTROL IN A FLOODPLAIN.
- 7) STILTGRASS IS AN ANNUAL GRASS MEANING THAT IT DIES WHEN SUBJECTED TO FREEZING TEMPS. IF YOU CAN PREVENT IT FROM GOING TO SEED IN SEPTEMBER YOU CAN REDUCE POPULATION THE FOLLOWING SPRING.
- 8) DO NOT APPLY A PRE-EMERGENT HERBICIDE. THE USE OF PRE-EMERGENT IN THE FLOODPLAIN IS NOT PRACTICAL SINCE ANY FLOOD EVENT WOULD CAUSE THE CHEMICAL TO LEACH OUT OF THE SOIL, REDUCING ITS EFFECTIVENESS AND INTRODUCES THE HERBICIDE INTO THE STREAM.

INVASIVE SPECIES

A. INVASIVE PLANT REMOVAL SHALL BE COMPLETED PRIOR TO MID-SEPTEMBER AND CONFORM TO THE RECOMMENDATIONS OF THE INVASIVE PLANT REMOVAL PLAN SHOWN ON THE PLAN PREPARED BY SOLTESZ, LLC SHOWN ON THIS PLAN SHEET.
B. THE REMOVAL OF NOXIOUS, INVASIVE, AND NON-NATIVES PLANT SPECIES SHALL BE DONE WITH THE USE OF HAND-HELD EQUIPMENT ONLY SUCH AS PRUNERS OR A CHAIN SAW. THESE PLANTS MAY BE CUT NEAR THE GROUND AND THE MATERIAL LESS THAN TWO INCHES DIAMETER MAY BE REMOVED FROM THE AREA AND DISPOSED OF APPROPRIATELY. ALL MATERIAL FROM THESE NOXIOUS, INVASIVE, AND NON-NATIVES PLANTS GREATER THAN TWO (2) INCHES DIAMETER SHALL BE CUT TO ALLOW CONTACT WITH THE GROUND, THUS ENCOURAGING DECOMPOSITION.
C. THE USE OF BROADCAST SPRAYING OF HERBICIDES IS NOT PERMITTED. HOWEVER, THE USE OF HERBICIDES TO DISCOURAGE RE-SPROUTING OF INVASIVE, NOXIOUS, OR NON-NATIVE PLANTS IS PERMITTED IF DONE AS AN APPLICATION OF THE CHEMICAL DIRECTLY TO THE CUT STUMP IMMEDIATELY FOLLOWING CUTTING OF PLANT TOPS. THE USE OF ANY HERBICIDE SHALL BE DONE IN ACCORDANCE WITH THE LABEL INSTRUCTIONS AND BE APPLIED BY A CERTIFIED PESTICIDE APPLICATOR.

MANAGEMENT SCHEDULE

YEAR 1 PRELIMINARY SITE GRADING
YEAR 1 OR 2 INITIAL MECHANICAL CONTROL, DEPENDING ON TIMING OF INITIAL GRADING
YEAR 2 JUNE/JULY FOLLOW UP INSPECTION & TREATMENT
YEAR 3 JUNE/JULY FOLLOW UP INSPECTION & TREATMENT AS NEEDED

MISS UTILITY NOTE

INFORMATION CONCERNING EXISTING UNDERGROUND UTILITIES WAS OBTAINED FROM AVAILABLE RECORDS. THE CONTRACTOR MUST DETERMINE THE EXACT LOCATION AND ELEVATION OF ALL EXISTING UTILITIES AND UTILITY CROSSINGS BY CROWING TEST, PITTS BY HAND, WELL IN ADVANCE OF THE START OF EXCAVATION. CONTACT MISS UTILITY AT 1-800-257-7777, 48 HOURS PRIOR TO THE START OF EXCAVATION. IF CLEARANCES ARE LESS THAN SHOWN ON THIS PLAN OR TWELVE (12) INCHES, WHICHEVER IS LESS, CONTACT THE ENGINEER AND THE UTILITY COMPANY BEFORE PROCEEDING WITH CONSTRUCTION. CLEARANCES LESS THAN NOTED MAY REQUIRE REVISIONS TO THE PLAN.

OWNER/APPLICANT

MUIRKIRK ENTERPRISES LLC
7315 WISCONSIN AVENUE
SUITE 800
BETHESDA, MD 20814

TAX MAP 9-D4	ZONING CATEGORY: 1E
WESC 200' SHEET 216A(NEDE, 217NE06)	XXXX
SITE DATUM HORIZONTAL:	XXXX
VERTICAL:	

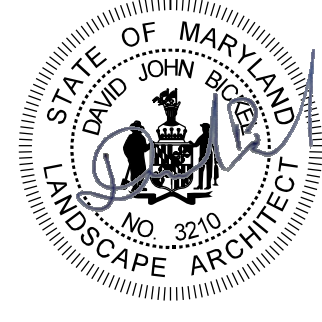

2/19/2025

INVASIVE SPECIES MANAGEMENT PLAN

TCPII-032-2023
MUIRKIRK WAREHOUSES
MUIRKIRK ROAD & KONTERRA DRIVE
BELTSVILLE, MD 20705

VANSVILLE (1st) ELECTION DISTRICT, PRINCE GEORGE'S COUNTY, MARYLAND



1" = 50'

SHEET **3**
OF **3**

PROJECT NO.
0225-14-00

Princo George's County Planning Department, MANCPPC Environmental Planning Section TREE CONSERVATION PLAN TYPE 2 APPROVAL TCPII-032-2023			
APPROVED BY	DATE	DRD #	REASON FOR REVISION
01 J. NICHOLS	12-04-2024	SPE-2022-005	N/A
02 Christine Mark	2/20/2025	SPE-2025-000-01	MINOR ENGINEERING CHANGES
03			
04			
05			