

The original of this drawing document was prepared by Soltesz, LLC (SOLTESZ). If this document was not obtained directly from SOLTESZ, and/or it was transmitted electronically, SOLTESZ cannot guarantee that unauthorized changes and/or alterations were not made by others. If verification of the information contained herein is needed, contact should be made directly with SOLTESZ. SOLTESZ makes no warranties, express or implied, concerning the accuracy of any information that has been transmitted by electronic means.



THE MARYLAND NATIONAL CAPITAL
PLANNING AND DESIGN COMMISSION
FOR OFFICIAL USE ONLY

APPLICATION NAME: NEW CARROLLTON DEVELOPER LLC
APPLICATION NO.: DSP-16043-02
TOP NO.: TOPS-08-001-01
SIGNATURE APPROVAL OF THIS PLAN IS IN
ACCORDANCE WITH THE RESOLUTION
ADOPTED BY THE COMMISSION ON
11/18/21
SIGNATURE APPROVAL DATE:
Jill Kosack
Principal Planner

LEGEND	
PROPERTY BOUNDARY	---
EXISTING CONTOUR	---
PROPOSED CONTOUR	---
STREAM	---
STREAM BUFFER	---
EXISTING FLOODPLAIN	---
25 FT FLOODPLAIN BUFFER (BRL)	---
PRIMARY MANAGEMENT AREA	---
LIMIT OF DISTURBANCE	---
EXISTING TREELINE	---
TREE PROTECTION FENCE	---
WOODLAND RETAINED-ASSUMED CLEARED	---
FLOODPLAIN CLEARED	---

Price George's County Planning Department, MNCPPC Environmental Planning Section TREE CONSERVATION PLAN APPROVAL TCP2-036-2016-03			
APPROVED BY	DATE	DR#	REASON FOR REVISION
00 M. REISER	4-13-17	DSP-16043	
01 M. REISER	11-15-18	DSP-16043-01	PHASE 2 TO ADD MULTIFAMILY BUILDING
02 C. SCHNEIDER	06-04-20	MW-1330F	PHASE 2 TO ADD PARCEL 7, OFFICE BUILDING
03 M. REISER	11/18/21	DSP-16043-02	PHASE 4 TO ADD MULTIFAMILY BUILDING
04			
05			

NOTE: AN OFF-SITE WOODLAND CONSERVATION EASEMENT HAS BEEN REQUIRED
IN THE LAND RECORDS TO MEET THE 2.2 ACRE REQUIREMENT (L-30010 F-307)

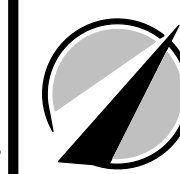
**SOLTESZ, LLC**

Engineering
Surveying
Planning
Environmental Sciences

4300 Forbes Boulevard, Suite 230
Lanham, MD 20706
P. 301.794.7555 F. 301.794.7656
www.soltesz.com

NO. _____
DATE: JUNE 2016
DESIGNED: YOR
REVISIONS
CAO STANDARDS VERSION: V5 - 2005
TECHNICIAN: YOR
BY _____
DATE _____
CHECKED: DJB

MISS UTILITY NOTE	
INFORMATION CONCERNING EXISTING UNDERGROUND UTILITIES WAS OBTAINED FROM AVAILABLE RECORDS. THE CONTRACTOR MUST DETERMINE THE EXACT LOCATION AND ELEVATION OF ALL EXISTING UTILITIES AND UTILITY CROSSINGS BY DIGGING TEST PIES BY HAND, WELL IN ADVANCE OF THE START OF EXCAVATION. CONTACT "MISS UTILITY" AT 1-800-251-7777 48 HOURS PRIOR TO THE START OF EXCAVATION. IF CLEARANCES ARE LESS THAN SHOWN ON THIS PLAN OR TWELVE (12) INCHES, WHICHEVER IS LESS, CONTACT THE ENGINEER AND THE UTILITY COMPANY BEFORE PROCEEDING WITH CONSTRUCTION. CLEARANCES LESS THAN NOTED MAY REQUIRE REVISIONS TO THIS PLAN.	

OWNER/DEVELOPER/APPLICANT	
WASHINGTON METRO AREA TRANSIT AUTHORITY 6TH AND D ST NW WASHINGTON, DC 20004	NEW CARROLLTON DEVELOPER LLC 7735 OLD GEORGETOWN ROAD SUITE 600 BETHESDA, MD 20814

MAP 13 GRID D5 E5	
TAX MAP 52, A1	ZONING CATEGORY: M-X-T
WBC 200' SHEET 208NE07	XXXX XXXX
SITE DATUM: HORIZONTAL: XXXXXX VERTICAL: XXXXXX	XXXX XXXX

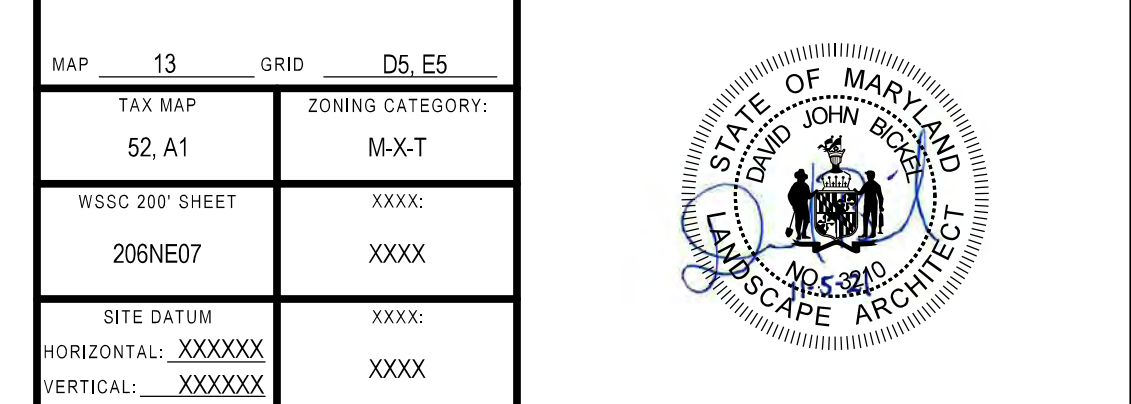

TREE CONSERVATION AREA TYPE II

TCP2-036-2016-03
NEW CARROLLTON
REVISION FOR DSP-16043-02

LANHAM (20th) ELECTION DISTRICT, PRINCE GEORGE'S COUNTY, MARYLAND

PROJECT NO.
1958-00-00

1" = 30'

SHEET
2
OF
3

P:\19580000\ENGINEERING\TCPL\02.sht Scale= 30,000.0 ft/in. User= D:\bickel\PLTdrv\PDF_Grey_150.plot\p\msh\TEXT_SJB.sh 11/14/2021 3:45:58 PM

The original of this drawing document was prepared by Soltesz, LLC (SOLTESZ). If this document was not obtained directly from Soltesz, LLC (SOLTESZ), and/or it was transmitted electronically, SOLTESZ cannot guarantee that unauthorized changes and/or alterations were not made by others. If verification of the information contained herein is needed, contact should be made directly with SOLTESZ. SOLTESZ makes no warranty, express or implied, concerning the accuracy of any information that has been transmitted by electronic means.

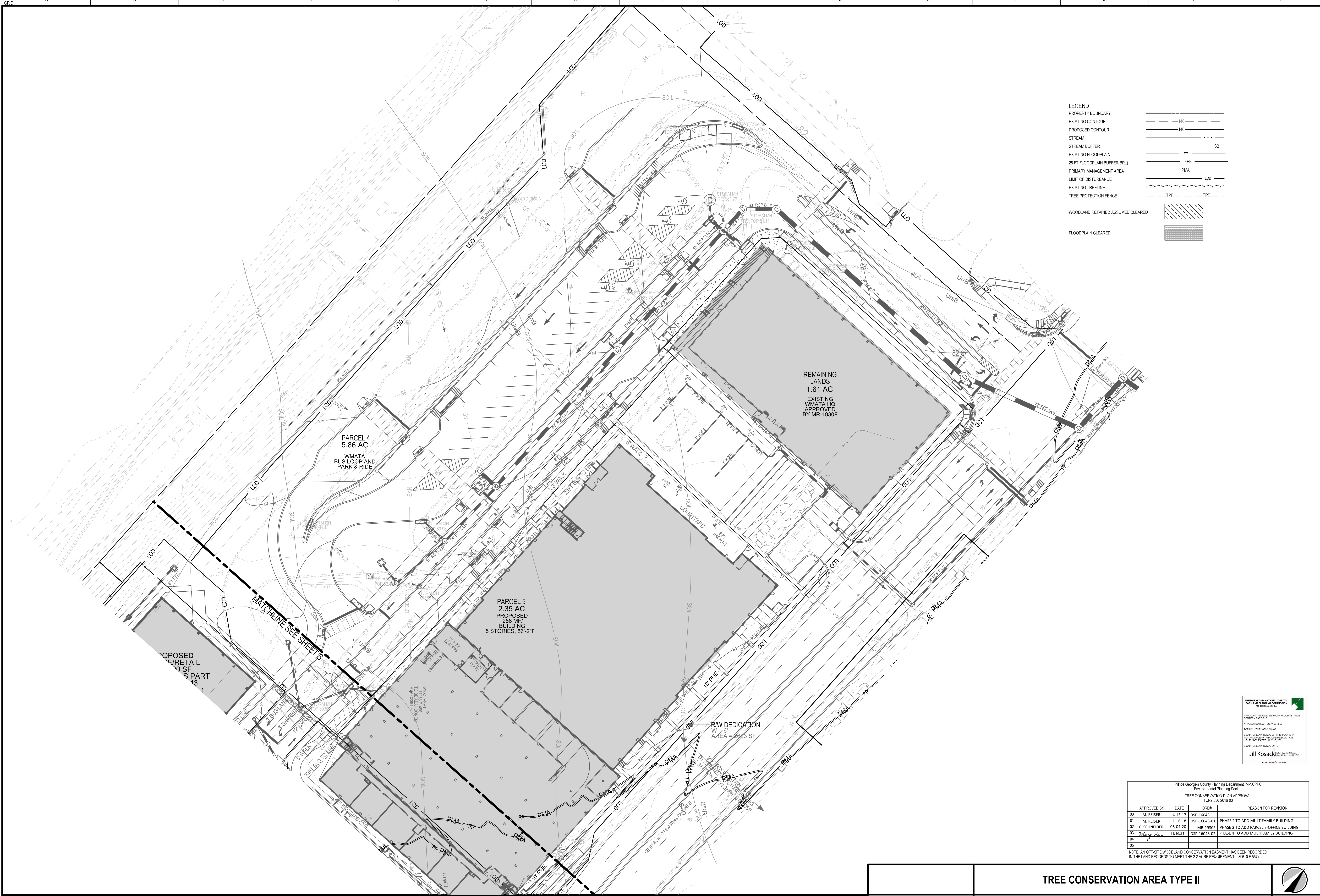

LEGEND

PROPERTY BOUNDARY
EXISTING CONTOUR
PROPOSED CONTOUR
STREAM
STREAM BUFFER
EXISTING FLOODPLAIN
25 FT FLOODPLAIN BUFFER (BRL)
PRIMARY MANAGEMENT AREA
LIMIT OF DISTURBANCE
EXISTING TREELINE
TREE PROTECTION FENCE

WOODLAND RETAINED-ASSUMED CLEARED
FLOODPLAIN CLEARED

THE MARYLAND NATIONAL CAPITAL PARK AND PLANNING COMMISSION
APPLICATION NAME: NEW CARROLLTON TOWN
APPROVAL: 11-16-21
TOPIC: TOPIC 036-2016-03
SIGNATURE APPROVAL DATE: 11/16/21
Jill Kosack

Price George's County Planning Department, MNCPPC Environmental Planning Section			
TREE CONSERVATION PLAN APPROVAL			
TOPIC 036-2016-03			
APPROVED BY	DATE	DATE	REASON FOR REVISION
00 M. REISER	4-13-17	DSP-16043	
01 M. REISER	11-6-18	DSP-16043-01	PHASE 2 TO ADD MULTIFAMILY BUILDING
02 C. SCHNEIDER	06-04-20	MR-1930F	PHASE 3 TO ADD PARCEL 7-OFFICE BUILDING
03 Mary Cos	11/16/21	DSP-16043-02	PHASE 4 TO ADD MULTIFAMILY BUILDING
04			
05			

NOTE: AN OFF-SITE WOODLAND CONSERVATION EASMENT HAS BEEN RECORDED IN THE LAND RECORDS TO MEET THE 2.2 ACRE REQUIREMENT (L 39610 F 557)

SOLTESZ, LLC
Engineering
Surveying
Planning
Environmental Sciences
4300 Forbes Boulevard, Suite 230
Lanham, MD 20706
P. 301.794.7555 F. 301.794.7656
www.solteszco.com

REVISIONS			
NO.	DATE	BY	DATE
1	JUNE 2016		
DESIGNED:	YOR	TECHNICIAN:	YOR
CAD STANDARDS VERSION:	V5 - 2005	CHECKED:	DJB

MISS UTILITY NOTE
INFORMATION CONCERNING EXISTING UNDERGROUND UTILITIES WAS OBTAINED FROM AVAILABLE RECORDS. THE CONTRACTOR MUST DETERMINE THE EXACT LOCATION AND ELEVATION OF ALL EXISTING UTILITIES AND UTILITY CROSSINGS BY DIGGING TEST PITS BY HAND, WELL IN ADVANCE OF THE START OF EXCAVATION. CONTACT "MISS UTILITY" AT 1-800-251-7777 48 HOURS PRIOR TO THE START OF EXCAVATION. IF CLEARANCES ARE LESS THAN SHOWN ON THIS PLAN OR TWELVE (12) INCHES, WHICHEVER IS LESS, CONTACT THE ENGINEER AND THE UTILITY COMPANY BEFORE PROCEEDING WITH CONSTRUCTION. CLEARANCES LESS THAN NOTED MAY REQUIRE REVISIONS TO THIS PLAN.

OWNER/DEVELOPER/APPLICANT
WASHINGTON METRO AREA TRANSIT AUTHORITY
6TH AND D ST NW
WASHINGTON, DC 20004
NEW CARROLLTON DEVELOPER LLC
7735 OLD GEORGETOWN ROAD
SUITE 600
BETHESDA, MD 20814

MAP 13	GRID DS, ES
TAX MAP 52, A1	ZONING CATEGORY: M-X-T
WBC 200 SHEET 208NE07	XXXX
SITE DATUM	XXXX
HORIZONTAL: XXXXXX	XXXX
VERTICAL: XXXXXX	XXXX

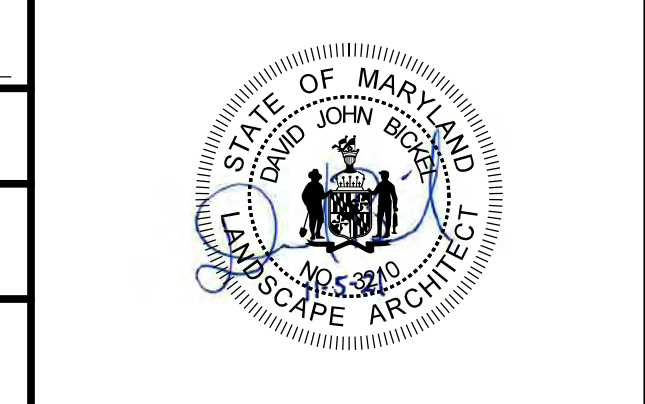

TREE CONSERVATION AREA TYPE II

TCP2-036-2016-03
NEW CARROLLTON
REVISION FOR DSP-16043-02

LANHAM (20th) ELECTION DISTRICT, PRINCE GEORGE'S COUNTY, MARYLAND

1" = 30'

SHEET 3 OF 3

PROJECT NO. 1958-00-00