

Note: All specimen trees have been GPS located

CLEARING AREAS (CA)	
No.	AREA (AC)
1 (Ph. 1A)	5.48
2 (Ph.1B)	4.80
3 (Ph. 1B)	5.96
4 (Ph. 2)	16.70
5 (Ph. 2)	0.02
6 (Ph. 2)	0.34
7 (Ph. 3)	5.19
8 (Ph. 3)	1.44
9 (Ph. 3A)	0.05
TOTAL	45.48

PRESERVATION AREAS (PA)	
No.	AREA (AC)
I	14.40
TOTAL	14.40

REFORESTATION AREAS (RA)	
No.	AREA (AC)
Ph. 1A-I	3.67
Ph. 1A-II	2.68
Ph. 1B	18.22
Ph. 2	19.77
Ph. 3	12.32
TOTAL	56.66

AFFORESTATION AREAS (AA)	
No.	AREA (AC)
Non- Disturbed	0.10

W002 AND CONSERVATION WORKSHEET FOR PRINCE GEORGE'S COUNTY, MARYLAND	
REF:	0-9
TRACT (PART):	81.44
SUBPLAT:	0.00
INDIVIDUALLY DEDICATED LAND:	0.00
NET TRACT (INTA):	81.44
PROPERTY DESCRIPTION OR SUBDIVISION NAME:	JENKINS PROPERTY
IS THIS SITE SUBJECT TO THE 1984 ORDINANCE?	N
AREAS (EVEN POINT (PRESERVATION ACRES)):	44.55
ACRES OF NET TRACT (EASING)	0.00
PERMITTED TWO REFORESTATION	15.99

WOOD AND CONSERVATION SEGMENT CALCULATIONS						
EXISTING WOODLAND ON NET TRACT (ACRES)						
WOODLAND CONSERVATION THRESHOLD (NTAL) = 50.00%						
MINIMUM OF A OR B						
A OR B AND ABOVE PCT						
(HAVE NUMBERS)						
	PHASE 1 A	PHASE 1 B	PHASE 2	PHASE 3	Non-disturbed Area	TOTALS
350000 TRACT AREA	9.85	22.74	20.23	18.45	15.17	86.44
WOODLAND AREA IN THE APPLICATION	0.00	0.00	0.00	0.00	0.00	0.00
NET TRACT AREA IN THE APPLICATION	9.85	22.74	20.23	18.45	15.17	86.44
WOODLAND ON THE NET TRACT FOR THE PHASE	6.08	15.76	17.06	6.68	14.40	59.88
WOODLAND ON THE FLOODPLAIN FOR THE PHASE	0.00	0.00	0.00	0.00	0.00	0.00
WOODLAND CLEARED ON NET TRACT FOR THE PHASE	6.08	15.76	17.06	6.68	0.00	45.40
WOODLAND CLEARED IN FLOODPLAIN FOR THE PHASE	0.00	0.00	0.00	0.00	0.00	0.00
NET-SITE WOODLAND CLEARING (U)	0.00	0.00	0.00	0.00	0.00	0.00
OFF-SITE MITIGATION PROVIDED ON THIS PROPERTY	0.00	0.00	0.00	0.00	0.00	0.00
(IMMEDIATE ACRES OF NET TRACT WOODLAND CLEARED)	6.08	15.71	39.25	45.48	45.48	146.00
(IMMEDIATE ACRES OF FLOODPLAIN WOODLAND CLEARED)	0.00	0.00	0.00	0.00	0.00	0.00
HAZARD OF D OR E	0.00	19.16	19.16	19.16	19.16	76.64
WOODLAND CLEARING BELOW PCT	0.00	1.58	1.58	1.58	1.58	6.32
OFF-SITE MITIGATION FOR CLEARING ABOVE THE PCT (0.25U)	1.58	4.31	4.31	4.31	4.31	17.81
REPLACEMENT FOR CLEARING BELOW THE PCT (2U)	0.00	3.26	34.39	55.64	55.64	149.29
OFF-SITE MITIGATION PROVIDED ON THIS PROPERTY	0.00	0.00	0.00	0.00	0.00	0.00
(IMMEDIATE WOODLAND CONSERVATION REQUIRED)	42.23	24.14	65.20	71.83	71.83	255.23
LATEST PHASE RELATED OPERATED REDEVELOPMENT TRENDS FROM THREE OF FOUR						
WOODLAND CONSERVATION PROVIDED					15.07	15.07
REPRODUCTION					0.00	0.00
REFORESTATION	6.39	19.22	18.77	12.52	0.00	56.86
OFF-REFORESTATION					0.10	0.10
(AREA APPROVED FOR FREE-IN-LIEU)						0.00
REMIT FOR OFF-SITE MITIGATION ON ANOTHER PROPERTY						0.00
NET-SITE MITIGATION PROVIDED ON THIS PROPERTY	6.39	24.51	44.34	36.66	71.83	213.83
TOTAL WOODLAND CONSERVATION PROVIDED						0.00
WOODLAND SAVED ON THIS PHASE BUT NOT COUNTED	0.00	0.00	0.00	0.00	0.00	0.00
EXISTING NET TRACT WOODLAND IN LATER PHASES	54.52	39.76	2.17	15.07	0.00	111.52

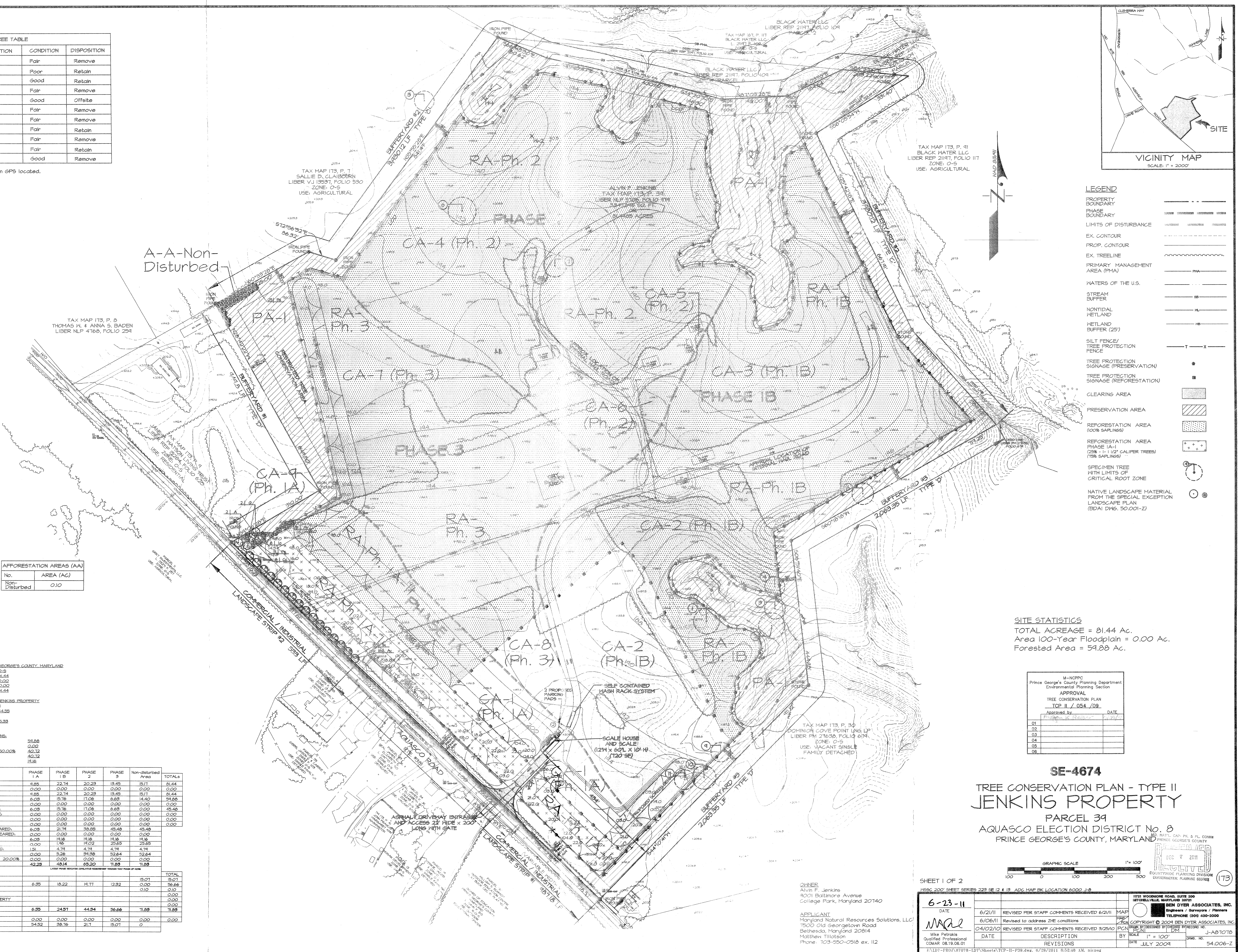

# LEGEND

PROPERTY BOUNDARY	
PHASE BOUNDARY	
LIMITS OF DISTURBANCE	
EX. CONTOUR	
PROP. CONTOUR	
EX. TREELINE	
PRIMARY MANAGEMENT AREA (PMA)	
WATERS OF THE U.S.	
STREAM BUFFER	
NONTIDAL WETLAND	
WETLAND BUFFER (25')	
SILT FENCE/ TREE PROTECTION FENCE	
TREE PROTECTION SIGNAGE (PRESERVATION)	
TREE PROTECTION SIGNAGE (REFORESTATION)	
CLEARING AREA	
PRESERVATION AREA	
REFORESTATION AREA (100% SAPLINGS)	
REFORESTATION AREA PHASE 1A-1 (25% ± 1" 1/2" CALIPER TREES) (75% SAPLINGS)	
SPECIMEN TREE WITH LIMITS OF CRITICAL ROOT ZONE	
NATIVE LANDSCAPE MATERIAL FROM THE SPECIAL EXCEPTION LANDSCAPE PLAN (EDAI DWG. 50.001-Z)	

SITE STATISTICS  
TOTAL ACREAGE = 81.44 Ac.  
Area 100-Year Floodplain = 0.00 Ac.  
Forested Area = 59.88 Ac.

M-NCPPC  
Prince George's County Planning Department  
Environmental Planning Section

APPROVAL

TREE CONSERVATION PLAN

TCP II / 054 / 09

Approved by \_\_\_\_\_ DATE \_\_\_\_\_

*Shirley M. Bailey* 6/23/09

01	
02	
03	
04	
05	

SE-4674

TREE CONSERVATION PLAN - TYPE II

JENKINS PROPERTY

PARCEL 39

AQUASCO ELECTION DISTRICT No. 8

PRINCE GEORGE'S COUNTY, MARYLAND

MD. NAT'L CAP.

OWNER  
Alvin F. Jenkins  
9001 Baltimore Avenue  
College Park, Maryland 20740

APPLICANT  
Maryland Natural Resources Solutions, LLC  
7500 Old Georgetown Road  
Bethesda, Maryland 20814  
Matthew Tillotson  
Phone: 103-550-0518 ex. 112

SHEET 1 OF 2

00 0 100 200 300

STATEMENT OF WORK

1751 WOODMOORE ROAD, SUITE 200  
METTSVILLE, MARYLAND 20721

6-23-11

DATE

6/21/11

6/10/11

04/02/10

DATE

DESCRIPTION

REVISED PER STAFF COMMENTS RECEIVED 6/21/11

Revised to address ZIE conditions

REVISED PER STAFF COMMENTS RECEIVED 3/25/10

REVISIONS

MAP

PCN

BY

DATE

1751 WOODMOORE ROAD, SUITE 200  
METTSVILLE, MARYLAND 20721

© 2004 BEN DYTER ASSOCIATES, INC.  
Engineers / Surveyors / Planners  
Telephone (301) 430-2000

© 2004 BEN DYTER ASSOCIATES, INC.  
DRAWN BY DESIGNED BY  
PCN DM

1" = 100'

JULY 2009

54-006-Z



## PLANTING SPECIFICATIONS FOR RE/AFFORESTATION AREAS (As applicable)

- Quantity: (see Plant Schedule)
- Age: (see Plant Schedule)
- Plant Quality Standards: The plants selected shall be healthy and sturdy representatives of their species. Seedlings shall have a minimum top growth of 18". The diameter of the root collar (the part of the stem just below ground level) shall be at least 3/8". The roots shall be well developed and at least 8" long. No more than twenty-five percent (25%) of the root system (both primary and auxiliary/fibrous roots) shall be being cut (pruned) or stripped from the plant during the planting process. Substantial auxiliary/fibrous roots shall be present.

Plants that do not have an abundance of well developed terminal buds on the leaders and branches shall be rejected.

Plants shall be shipped by the nursery immediately after lifting from the field or removal from the greenhouse, and planted immediately upon receipt by the landscape contractor.

If the plants cannot be planted immediately after delivery to the reforestation site, they shall be stored in the shade with their root masses protected from direct exposure to sun and wind by the use of straw, peat moss, compost, or other suitable material and shall be maintained through periodic watering until the time of planting.

Plant Handling: The quantity of seedlings taken to the field shall not exceed the quantity that can be planted in a day. Seedlings, once removed from the nursery or temporary storage area shall be planted immediately.

Timing of Planting: The best time to plant seedlings is while they are dormant, prior to spring budging. The most suitable months for planting are March and April, when the soil is moist. November and early December are also acceptable planting times for this region as cool and cloudy weather is considered ideal. Planting shall occur within one growing season of the issuance of grading/building permits and/or reaching the final grades and stabilization of planting areas.

Seedling Planting: Tree seedlings can be hand planted using a dibble bar or pump-shooter shovel. It is important that the seedling be placed in the hole so that the roots can spread out naturally; they should not be twisted, balled up, or bent. Moist soil should then be packed firmly around the roots. Seedlings should be planted at a depth where their roots collar lie just below the ground surface. Air pockets should not be left after closing the hole which would allow the roots to dry out. See planting details for further explanation. If the contractor wishes to plant by another method, the preparer of this tree conservation plan must be contacted and give his approval before planting may begin.

Soil Mixing: See Plant Schedule and/or Planting Plan for spacing recommendations. Also refer to the Planting Layout detail for a description of the general planting theory.

Soil: Upon the completion of all grading operations, a soil test shall be conducted to determine what soil preparation and soil amendments, if any, are necessary to create good tree growing conditions. Soil samples shall be taken at a rate that provides one soil sample for each acre that appears to have a different soil type (if the entire area appears uniform, then only one sample is necessary, and submitted for testing to a private company. The company of choice shall make recommendations for improving the existing soil. The soil will be tested and recommended for corrections of soil texture, pH, magnesium, phosphorus, potassium, calcium and organic matter.

Soil Improvement Measures: The soil shall then be improved according to the recommendations made by the testing company.

Fencing & Signage: Final protective fencing shall be placed on the site, and/or development side of planting areas. The protective fence shall be installed upon completion of planting operations. Signs shall be posted per the signage detail on this sheet.

Planting Method: Consult the Planting Detail(s) shown on this plan.

Mulching: Apply 2" thick layer of woodchip or shredded hardwood mulch (see noted) to each planting site (see detail shown on this plan).

Soil and/or Cover Establishment: The remaining disturbed area between seedling planting sites shall be seeded and stabilized with white clover seed at the rate of 5 lbs./acre.

Mowing: No mowing shall be allowed in any planting area.

Permit Check for Bond Release: The seedling planting is to be completed at the end of each year for two years to assure that no less than 75% of the original planned quantity survives.

Potential Source of Seedlings: Maryland Department of Natural Resources, John S. Ayon State Forest, Natural Resources Nursery, 3424 Colchester Road, Preston, MD 21655 (410) 613-2467

Potential Source of Seedlings: Maryland Department of Natural Resources, John S. Ayon State Forest, Natural Resources Nursery, 3424 Colchester Road, Preston, MD 21655 (410) 613-2467

Potential Source of Seedlings: Maryland Department of Natural Resources, John S. Ayon State Forest, Natural Resources Nursery, 3424 Colchester Road, Preston, MD 21655 (410) 613-2467

Potential Source of Seedlings: Maryland Department of Natural Resources, John S. Ayon State Forest, Natural Resources Nursery, 3424 Colchester Road, Preston, MD 21655 (410) 613-2467

Potential Source of Seedlings: Maryland Department of Natural Resources, John S. Ayon State Forest, Natural Resources Nursery, 3424 Colchester Road, Preston, MD 21655 (410) 613-2467

Potential Source of Seedlings: Maryland Department of Natural Resources, John S. Ayon State Forest, Natural Resources Nursery, 3424 Colchester Road, Preston, MD 21655 (410) 613-2467

Potential Source of Seedlings: Maryland Department of Natural Resources, John S. Ayon State Forest, Natural Resources Nursery, 3424 Colchester Road, Preston, MD 21655 (410) 613-2467

Potential Source of Seedlings: Maryland Department of Natural Resources, John S. Ayon State Forest, Natural Resources Nursery, 3424 Colchester Road, Preston, MD 21655 (410) 613-2467

Potential Source of Seedlings: Maryland Department of Natural Resources, John S. Ayon State Forest, Natural Resources Nursery, 3424 Colchester Road, Preston, MD 21655 (410) 613-2467

Potential Source of Seedlings: Maryland Department of Natural Resources, John S. Ayon State Forest, Natural Resources Nursery, 3424 Colchester Road, Preston, MD 21655 (410) 613-2467

Potential Source of Seedlings: Maryland Department of Natural Resources, John S. Ayon State Forest, Natural Resources Nursery, 3424 Colchester Road, Preston, MD 21655 (410) 613-2467

Potential Source of Seedlings: Maryland Department of Natural Resources, John S. Ayon State Forest, Natural Resources Nursery, 3424 Colchester Road, Preston, MD 21655 (410) 613-2467

Potential Source of Seedlings: Maryland Department of Natural Resources, John S. Ayon State Forest, Natural Resources Nursery, 3424 Colchester Road, Preston, MD 21655 (410) 613-2467

Potential Source of Seedlings: Maryland Department of Natural Resources, John S. Ayon State Forest, Natural Resources Nursery, 3424 Colchester Road, Preston, MD 21655 (410) 613-2467

Potential Source of Seedlings: Maryland Department of Natural Resources, John S. Ayon State Forest, Natural Resources Nursery, 3424 Colchester Road, Preston, MD 21655 (410) 613-2467

Potential Source of Seedlings: Maryland Department of Natural Resources, John S. Ayon State Forest, Natural Resources Nursery, 3424 Colchester Road, Preston, MD 21655 (410) 613-2467

Potential Source of Seedlings: Maryland Department of Natural Resources, John S. Ayon State Forest, Natural Resources Nursery, 3424 Colchester Road, Preston, MD 21655 (410) 613-2467

Potential Source of Seedlings: Maryland Department of Natural Resources, John S. Ayon State Forest, Natural Resources Nursery, 3424 Colchester Road, Preston, MD 21655 (410) 613-2467

Potential Source of Seedlings: Maryland Department of Natural Resources, John S. Ayon State Forest, Natural Resources Nursery, 3424 Colchester Road, Preston, MD 21655 (410) 613-2467

Potential Source of Seedlings: Maryland Department of Natural Resources, John S. Ayon State Forest, Natural Resources Nursery, 3424 Colchester Road, Preston, MD 21655 (410) 613-2467

Potential Source of Seedlings: Maryland Department of Natural Resources, John S. Ayon State Forest, Natural Resources Nursery, 3424 Colchester Road, Preston, MD 21655 (410) 613-2467

Potential Source of Seedlings: Maryland Department of Natural Resources, John S. Ayon State Forest, Natural Resources Nursery, 3424 Colchester Road, Preston, MD 21655 (410) 613-2467

Potential Source of Seedlings: Maryland Department of Natural Resources, John S. Ayon State Forest, Natural Resources Nursery, 3424 Colchester Road, Preston, MD 21655 (410) 613-2467

Potential Source of Seedlings: Maryland Department of Natural Resources, John S. Ayon State Forest, Natural Resources Nursery, 3424 Colchester Road, Preston, MD 21655 (410) 613-2467

Potential Source of Seedlings: Maryland Department of Natural Resources, John S. Ayon State Forest, Natural Resources Nursery, 3424 Colchester Road, Preston, MD 21655 (410) 613-2467

Potential Source of Seedlings: Maryland Department of Natural Resources, John S. Ayon State Forest, Natural Resources Nursery, 3424 Colchester Road, Preston, MD 21655 (410) 613-2467

Potential Source of Seedlings: Maryland Department of Natural Resources, John S. Ayon State Forest, Natural Resources Nursery, 3424 Colchester Road, Preston, MD 21655 (410) 613-2467

Potential Source of Seedlings: Maryland Department of Natural Resources, John S. Ayon State Forest, Natural Resources Nursery, 3424 Colchester Road, Preston, MD 21655 (410) 613-2467

Potential Source of Seedlings: Maryland Department of Natural Resources, John S. Ayon State Forest, Natural Resources Nursery, 3424 Colchester Road, Preston, MD 21655 (410) 613-2467

Potential Source of Seedlings: Maryland Department of Natural Resources, John S. Ayon State Forest, Natural Resources Nursery, 3424 Colchester Road, Preston, MD 21655 (410) 613-2467

Potential Source of Seedlings: Maryland Department of Natural Resources, John S. Ayon State Forest, Natural Resources Nursery, 3424 Colchester Road, Preston, MD 21655 (410) 613-2467

Potential Source of Seedlings: Maryland Department of Natural Resources, John S. Ayon State Forest, Natural Resources Nursery, 3424 Colchester Road, Preston, MD 21655 (410) 613-2467

Potential Source of Seedlings: Maryland Department of Natural Resources, John S. Ayon State Forest, Natural Resources Nursery, 3424 Colchester Road, Preston, MD 21655 (410) 613-2467

Potential Source of Seedlings: Maryland Department of Natural Resources, John S. Ayon State Forest, Natural Resources Nursery, 3424 Colchester Road, Preston, MD 21655 (410) 613-2467

Potential Source of Seedlings: Maryland Department of Natural Resources, John S. Ayon State Forest, Natural Resources Nursery, 3424 Colchester Road, Preston, MD 21655 (410) 613-2467

Potential Source of Seedlings: Maryland Department of Natural Resources, John S. Ayon State Forest, Natural Resources Nursery, 3424 Colchester Road, Preston, MD 21655 (410) 613-2467

Potential Source of Seedlings: Maryland Department of Natural Resources, John S. Ayon State Forest, Natural Resources Nursery, 3424 Colchester Road, Preston, MD 21655 (410) 613-2467

Potential Source of Seedlings: Maryland Department of Natural Resources, John S. Ayon State Forest, Natural Resources Nursery, 3424 Colchester Road, Preston, MD 21655 (410) 613-2467

Potential Source of Seedlings: Maryland Department of Natural Resources, John S. Ayon State Forest, Natural Resources Nursery, 3424 Colchester Road, Preston, MD 21655 (410) 613-2467

Potential Source of Seedlings: Maryland Department of Natural Resources, John S. Ayon State Forest, Natural Resources Nursery, 3424 Colchester Road, Preston, MD 21655 (410) 613-2467

Potential Source of Seedlings: Maryland Department of Natural Resources, John S. Ayon State Forest, Natural Resources Nursery, 3424 Colchester Road, Preston, MD 21655 (410) 613-2467

Potential Source of Seedlings: Maryland Department of Natural Resources, John S. Ayon State Forest, Natural Resources Nursery, 3424 Colchester Road, Preston, MD 21655 (410) 613-2467

Potential Source of Seedlings: Maryland Department of Natural Resources, John S. Ayon State Forest, Natural Resources Nursery, 3424 Colchester Road, Preston, MD 21655 (410) 613-2467

Potential Source of Seedlings: Maryland Department of Natural Resources, John S. Ayon State Forest, Natural Resources Nursery, 3424 Colchester Road, Preston, MD 21655 (410) 613-2467

Potential Source of Seedlings: Maryland Department of Natural Resources, John S. Ayon State Forest, Natural Resources Nursery, 3424 Colchester Road, Preston, MD 21655 (410) 613-2467

## TREE II TREE CONSERVATION NOTES (As applicable)

- Cutting or clearing of woodland not in conformance with this plan or without the expressed written consent of the Planning Director or designee, shall be subject to a \$150 per square foot mitigation fee.
- The County Inspection and Code Compliance Section (301-863-6033), must be contacted prior to the start of any work on the site to address implementation of Tree Conservation measures shown on this plan.
- Property owners shall be notified by the Developer or Contractor, of any Woodland Conservation Areas (Tree Save Areas, Reforestation Areas, Afforestation Areas or Salvage Clearing Areas) located on their lot or parcel of land and the associated fines for unauthorized disturbances to these areas. Upon the sale of the property the owner/developer or owners representative shall notify the purchaser of the property of any Woodland Conservation Areas.
- All appropriate bonds shall be posted with the Building Official prior to the issuance of any permits. These bonds will be retained as surety by the Building Official until all required activities have been satisfied. Three copies of the bonds are submitted with the grading permit application.
- All required off-site mitigation shall be identified on an approved TCP/II for the issuance of any permits. These bonds will be retained as surety by the Building Official until all required activities have been satisfied. Three copies of the bonds are submitted with the grading permit application.
- Work on this project will be initiated in several phases. All TPDs required for a given phase shall be installed prior to any disturbance within that phase of work.
- Woodland Conservation - Tree Save Areas and/or Reforestation Areas shall be posted as shown at the same time as the Tree Protective Device installation and/or start of reforestation activities. These signs shall remain in place.
- The County shall be notified prior to soil preparation or initiation of any tree planting on this site.
- Results of survival checks for all tree plantings shall be reported to the County for the site and M-NCPPC, Environmental Planning Section.
- The location of all Tree Protection Devices (TPDs) shown on this Plan, shall be flagged or staked in the field prior to the pre-construction meeting with the Sediment and Erosion Control Inspector. Upon approval of the flagged or staked TPD locations by the Inspector, installation of the TPD's may begin. TPD installation shall be completed prior to installation of initial sediment controls. No cutting or clearing of trees may begin before final approval of TPD installation.
- All tree planting for woodland replacement, reforestation or afforestation will be completed after final grading is established. Failure to establish the woodland replacement, reforestation or afforestation within the prescribed time frame will result in the forfeiture of the associated \$150 per square foot penalty unless a written extension is approved by the DER Inspector.
- The Applicant shall notify the Maryland-National Park and Planning Commission, Environmental Planning Section, prior to the start of work on each phase of this mining operation and schedule a meeting to address reforestation and woodland conservation issues including: timing for reforestation activities associated with the most recently completed phase, timing for restoration for the upcoming phase, changes in the species to be planted, decreases in the quantity of trees planted in the event that some natural regeneration has occurred, the need for additional or less site preparation, and other pertinent woodland conservation or reforestation issues. The installation of perimeter sediment control devices shall not be subject to this, as set forth in the Special Exception Conditions.
- Prior to the start of work in any phase or portion thereof, the limits of disturbance for that phase or portion thereof shall be identified and marked in the field. The Applicant or their representative shall walk the limits of disturbance with a representative of the MDE Minerals, Oil and Gas Division, prior to the installation of sediment/erosion control measures and tree protective devices. The Applicant or their representative shall notify the M-NCPPC, Environmental Planning Section, as to the date and time this walk will occur, and they will be afforded the opportunity to participate in this walk and provide their concerns to the MDE representatives.

Pre-construction Activities

Pre-construction Activities

Pre-construction Activities

Pre-construction Activities

Pre-construction Activities

Pre-construction Activities

Pre-construction Activities

Pre-construction Activities

Pre-construction Activities

Pre-construction Activities

Pre-construction Activities

Pre-construction Activities

Pre-construction Activities

Pre-construction Activities

Pre-construction Activities

Pre-construction Activities

Pre-construction Activities

Pre-construction Activities

Pre-construction Activities

Pre-construction Activities

Pre-construction Activities

Pre-construction Activities

Pre-construction Activities

Pre-construction Activities

Pre-construction Activities

Pre-construction Activities

Pre-construction Activities

Pre-construction Activities

Pre-construction Activities

Pre-construction Activities

Pre-construction Activities

Pre-construction Activities

Pre-construction Activities

Pre-construction Activities

Pre-construction Activities

Pre-construction Activities

Pre-construction Activities

Pre-construction Activities

Pre-construction Activities

Pre-construction Activities

Pre-construction Activities

## WOODLAND CONSERVATION AREA MANAGEMENT NOTES (As applicable)

Removal of Hazardous Trees or Limbs BY DEVELOPERS OR BUILDERS

The developer and/or builder is responsible for the complete preservation of all forested areas shown on the approved plan to remain undisturbed. Only trees or parts thereof designated by the Department of Environmental Resources as dead, dying or hazardous may be removed.

1. A tree is considered hazardous if a condition is present which leads a Licensed Arborist or a Licensed Tree Expert to believe that the tree or a portion of the tree has a potential to fall and strike a structure, parking area or other high use area and result in personal injury or property damage.

2. If a hazardous condition may be alleviated by corrective pruning, the Licensed Arborist or a Licensed Tree Expert may proceed without further authorization. The pruning must be done in accordance with the latest edition of the ANSI A-300 Pruning Standards ("Tree Shrub and Other Woody Plant Maintenance-Standard Practices").

3. Corrective measures requiring the removal of the hazardous tree or portions thereof shall require authorization by the building or grading inspector. If there is a valid grading or building permit for the subject lots or parcels on which the trees are located. Only after approval of the appropriate inspector, may the tree be cut by chainsaw to near the existing ground level. The stump may not be removed or covered with soil, mulch or other materials that would inhibit sprouting.

4. Debris from the tree removal or pruning that occurs within 35 feet of the woodland edge may be removed and properly disposed of by recycling, chipping or other acceptable methods. All debris that is more than 35 feet from the woodland edge shall be cut up to allow contact with the ground, thus encouraging decomposition. The smaller materials shall be placed into brush piles that will serve as wildlife habitat.

Removal of Hazardous Trees, Limbs, Noxious Plants, Invasive Plants or Non-native Plants in Woodland Conservation Areas Owned BY INDIVIDUAL HOMEOWNERS

1. If the developer or builder no longer has an interest in the property, the homeowner shall obtain a written statement from the Licensed Arborist or Licensed Tree Expert identifying the hazardous condition and the proposed corrective measures prior to having the work conducted. The tree may then be removed by the arborist or tree expert. The stump shall be cut as close to the ground as possible and left in place. The removal or grinding of the stumps in the woodland conservation area is not permitted.

2. The removal of noxious, invasive and non-native plant species from the woodland conservation areas may be done with the use of hand-held equipment only, such as pruners or a chain saw. These plants may be cut near the ground and the material less than two inches diameter may be removed from the area and disposed of appropriately. All material from these noxious, invasive and non-native plants greater than two (2) inches diameter shall be cut to allow contact with the ground, thus encouraging decomposition.

3. The use of broadcast spraying of herbicides is not permitted. However, the use of herbicides to discourage re-sprouting of invasive noxious or non-native plants is permitted if done as an application of the chemical directly to the cut stump immediately following the cutting of plant tops. The use of any herbicide shall be done in accordance with the label instructions.

Note: The use of chainsaws is extremely dangerous and should not be conducted with untrained personnel, without safety equipment, or by individuals not trained in the use of this equipment for the pruning and/or cutting of trees.

Protection of Reforestation and Afforestation Areas BY DEVELOPERS OR BUILDERS

1. Reforestation and afforestation areas shall be planted prior to occupancy of the nearest building or residence. If planting cannot occur due to planting conditions, the developer or property owner shall install the fencing and signage in accordance with the approved Type II Tree Conservation Plan. Planting shall then be accomplished during the next planting season. If planting is delayed beyond the transfer of property title, to the homeowner, the developer shall obtain a signed statement from the purchaser indicating that they understand that the reforestation area is located on their property and that reforestation will occur during the next planting season. A copy of that document shall be presented to the grading inspector and the environmental planning section.

2. Reforestation areas shall not be moved, however the management of competing vegetation around individual trees is acceptable.

Protection of Reforestation and Afforestation Areas BY INDIVIDUAL HOMEOWNERS

1. Reforestation fencing and signage shall remain in place in accordance with the approved Type II Tree Conservation Plan or until the trees have grown sufficiently to have crown closure.

2. Reforestation areas shall not be moved, however, the management of competing vegetation around individual trees is acceptable.

WOODLAND AREAS NOT COUNTED AS PART OF THE WOODLAND CONSERVATION REQUIREMENTS

1. A revised Tree Conservation Plan is required prior to clearing any woodland area which is not specifically identified to be cleared on the most recently approved Type II Tree Conservation Plan located on the 4th floor of the County Administration Building at 14741 Governor Olden Bowie Drive, Upper Marlboro, Maryland 20774, phone 301-452-3650. Additional mitigation will be required for the clearing of all woodlands beyond that reflected on the approved plans. Although clearing may be allowed, it may be subject to additional replacement requirements. Mitigation and fees which must be reflected on TCP revisions approved by the M-NCPPC Environmental Planning Section.

2. Homeowners or property owners may remove trees less than two (2) inches diameter, shrubs, and vines in woodland areas which are saved but not part of the woodland conservation requirements after all permits have been released for the subject property. This area may not be tilled or have other ground disturbances which would result in damage to the tree roots. Raking leaves and over-seeding with native grasses, flowers and groundcovers is acceptable. Seeding with invasive grasses, including any variety of Kentucky 31 fescue is not acceptable.

NOTES:

1. All tree/shrub species planted within the re/afforestation areas, should be randomly distributed throughout the proposed re/afforestation area, so as to promote a natural woodland structure. (See Planting Layout detail)

2. In the event of species unavailability, a substitution may be made. Any substitution made requires written notification to MNCPPC, Environmental Planning Section.

3. All 1 1/2" caliper trees are to be planted as randomly as indicated on the Planting Layout detail and as shown on the Special Exception Landscape Plan (BDAI drg. no. 50.001-Z).

4. The 1 1/2" caliper trees meet county requirements for "Type D" bufferland.

\*Excludes 34 - 1 1/2" caliper trees from Landscape Plan.

\*Excludes 34 - 1 1/2" caliper trees from Landscape Plan.

\*Excludes 34 - 1 1/2" caliper trees from Landscape Plan.

\*Excludes 34 - 1 1/2" caliper trees from Landscape Plan.

\*Excludes 34 - 1 1/2" caliper trees from Landscape Plan.

\*Excludes 34 - 1 1/2" caliper trees from Landscape Plan.

\*Excludes 34 - 1 1/2" caliper trees from Landscape Plan.

\*Excludes 34 - 1 1/2" caliper trees from Landscape Plan.

\*Excludes 34 - 1 1/2" caliper trees from Landscape Plan.

\*Excludes 34 - 1 1/2" caliper trees from Landscape Plan.

\*Excludes 34 - 1 1/2" caliper trees from Landscape Plan.

\*Excludes 34 - 1 1/2" caliper trees from Landscape Plan.

\*Excludes 34 - 1 1/2" caliper trees from Landscape Plan.

\*Excludes 34 - 1 1/2" caliper trees from Landscape Plan.

\*Excludes 34 - 1 1/2" caliper trees from Landscape Plan.

\*Excludes 34 - 1 1/2" caliper trees from Landscape Plan.

\*Excludes 34 - 1 1/2" caliper trees from Landscape Plan.

\*Excludes 34 - 1 1/2" caliper trees from Landscape Plan.

\*Excludes 34 - 1 1/2" caliper trees from Landscape Plan.

\*Excludes 34 - 1 1/2" caliper trees from Landscape Plan.

\*Excludes 34 - 1 1/2" caliper trees from Landscape Plan.

\*Excludes 34 - 1 1/2" caliper trees from Landscape Plan.

\*Excludes 34 - 1 1/2" caliper trees from Landscape Plan.

\*Excludes 34 - 1 1/2" caliper trees from Landscape Plan.

\*Excludes 34 - 1 1/2" caliper trees from Landscape Plan.

\*Excludes 34 - 1 1/2" caliper trees from Landscape Plan.

\*Excludes 34 - 1 1/2" caliper trees from Landscape Plan.

\*Excludes 34 - 1 1/2" caliper trees from Landscape Plan.

\*Excludes 34 - 1 1/2" caliper trees from Landscape Plan.

\*Excludes 34 - 1 1/2" caliper trees from Landscape Plan