

LOT 9  
Monica L. & Willie Lowe, III  
6900 Brentwood Dr.  
Zoning: R-A

LOT 11  
Scott Rosenbloom  
6816 Brentwood Dr.  
Zoning: R-A

LOT 7  
Imelda M. Johnson, ETAL  
6906 Brentwood Dr.  
Zoning: R-A

LOT 4  
McCormick Living Trust  
7004 Brentwood Dr.  
Zoning: R-A

LOT 4  
Calvin R. & Audra R. Griner  
7008 Brentwood Dr.  
Zoning: R-A

LOT 26  
Tsehay T. & Norton C. Joerg  
11817 Capston Dr.  
Zoning: R-A

Woodland Retained Not  
Credited=0.01 Ac.

WOODLAND PRESERVATION=1.20 Ac.

Woodland Retained  
Not Credited= 0.01 Ac.

Standard Woodland Conservation Worksheet for Prince George's County

SECTION I Establishing Site Information (Enter acres for each zone)

Zone	RA	Revision	3
Gross Tract	2.00		
Floodplain	0.00		
Previously Dedicated Land	0.00		
Net Tract (NTA)	2.00		

TCP Number: TCP#104-92  
Property Description or Subdivision Name: MARYVALE SUBDIVISION 48.0000 AC. GASTON PROPERTY  
Is this site subject to the 1989 Ordinance? Y  
Are there prior TCP approvals which include a combination of this lot? (Y/N) Y  
Is any portion of the property in a WC Bank? N  
Break-even Point (Preservation) = 1.15 acres  
Clearing permitted with reforestation = 0.82 acres

SECTION II Determining Requirements (Enter acres for each corresponding column)

Column A VCT/RTF %	Column B Net Tract	Column C Floodplain	Column D Of Site
Existing Woodland	1.77	(1.1)	0.00
Woodland Conservation Threshold (WCT) =	50.00%	1.00	0.00
Scrub of 15 or 14	1.00	1.00	0.00
Woodland above WCT	0.77	0.00	0.00
Woodland cleared above WCT (a multiplier of 16 or 17)	0.85	0.00	0.00
Clearing above WCT (0.25: 1) replacement requirement	0.14	0.00	0.00
Woodland cleared below WCT	0.00	0.00	0.00
Clearing below WCT (2-1) replacement requirement	0.00	0.00	0.00
Abandonment Threshold (AT) =	20.00%	0.00	0.00
Of the WCA being provided on this property	0.00	0.00	0.00
Woodland Conservation Required	1.14	0.00	0.00

SECTION III Meeting the Requirements

Woodland Preservation	1.20		
Abandonment/Reforestation	0.00		
Natural Regeneration	0.00		
Specimen/Isolated Tree Credit (CER 2 area * 2.0)	0.00		
Forest Enhancement Credit (Area * 2.5)	0.00		
Area approved for fee-in-lieu/PTA	0.00		\$0.00
Area approved for fee-in-lieu/PTA	0.00		\$0.00
Credits for DRA Conservation on another property	0.00		
Off-site VCA (reforestation) being provided on this property	0.00		
Off-site VCA (reforestation) being provided on this property	0.00		
TOTAL Woodland Conservation Provided	1.20		

Area of woodland not cleared: 1.22 acres  
Net tract woodland retained not part of requirements: 0.00 acres  
100-foot buffer woodland retained: 0.00 acres  
On the woodland conservation provided: 1.20 acres  
On the woodland retained not credited: 0.01 acres

Prepared by: Darrell V. Oliver  
Signed: 11/26/13  
Date: 11/26/13

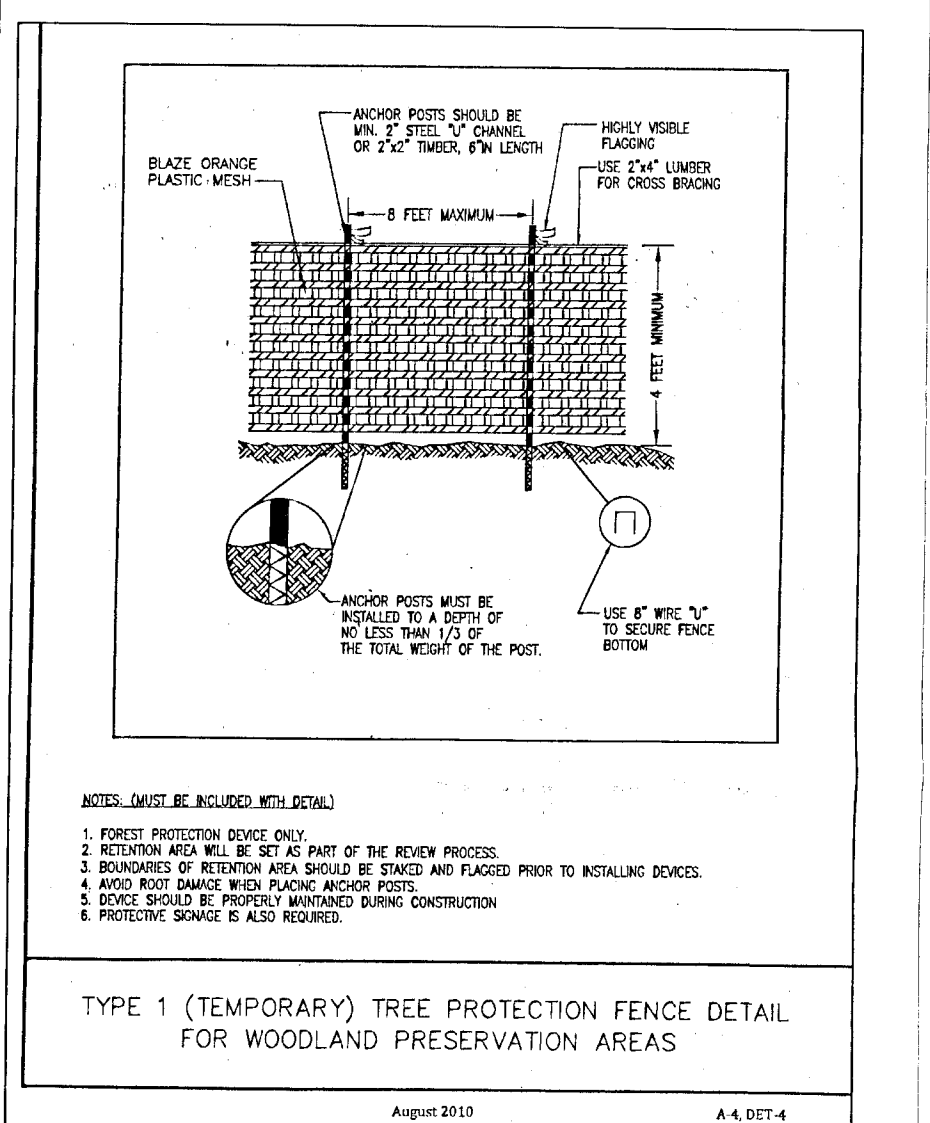
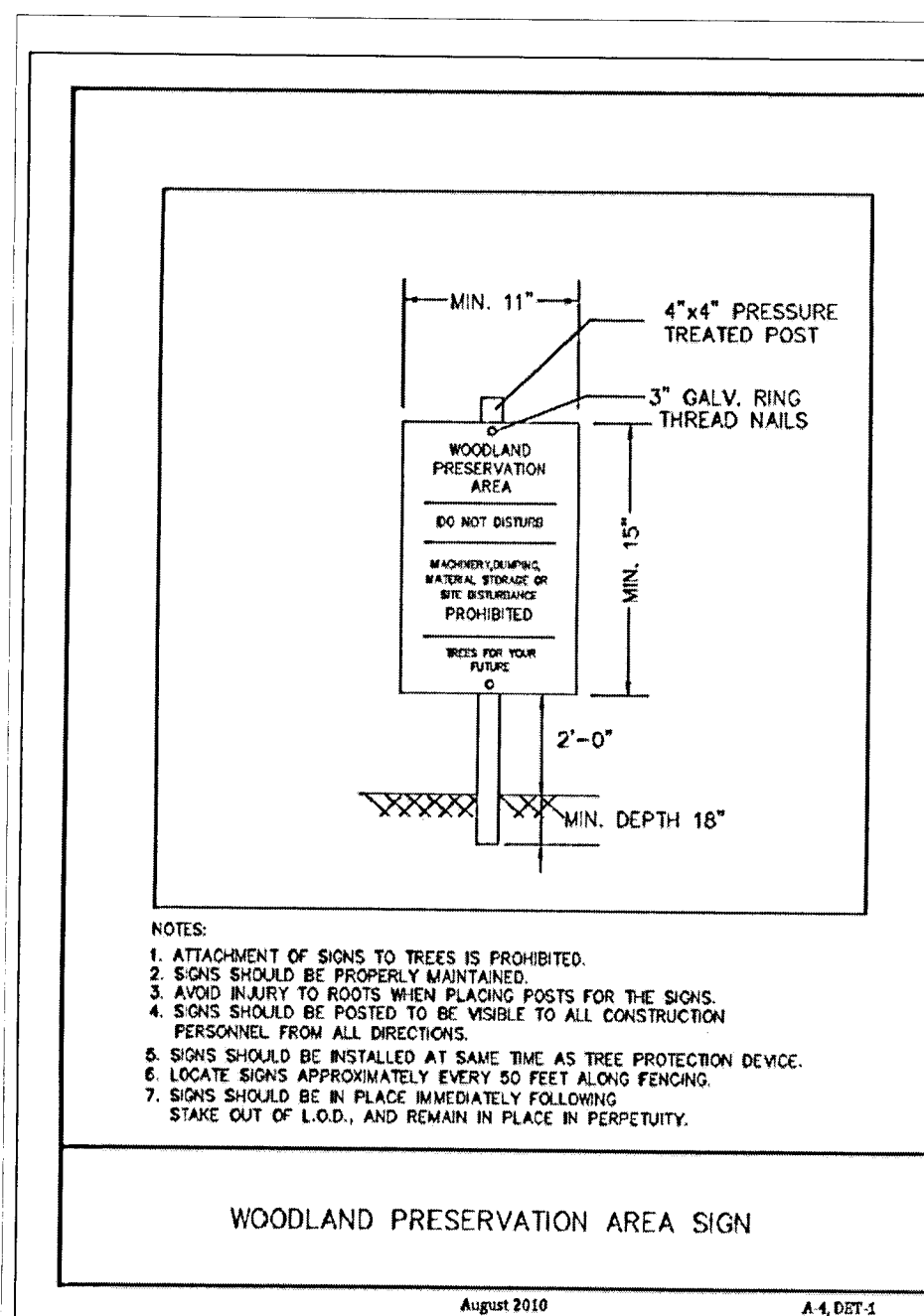

Property Owners Awareness Certificate

I, Jeffery A. & Kimberly Gaston, hereby acknowledge that we are aware of this Type 2 Tree Conservation Plan (TCP2) and that we understand the requirements as set forth in this TCP2.

Signed: 11/26/13  
Date: 11/26/13

Contract Purchaser: \_\_\_\_\_ Date: \_\_\_\_\_

TCP2 PLAN LEGEND

- 58 PROPOSED CONTOURS
- 58 EXISTING CONTOURS
- TPF TREE PROTECTION FENCE (TEMPORARY)
- WOODLAND PRESERVATION
- LOD LIMIT OF DISTURBANCE
- EXISTING TREE LINE
- WOODLAND PRESERVATION SIGNS
- ORIGINAL WOODLINE APPROVED WITH TCP#104-92
- WOODLINE RETAINED NOT CREDITED
- 6' HT. ORNAMENTAL FENCE
- 6' HT. CHAIN-LINK FENCE

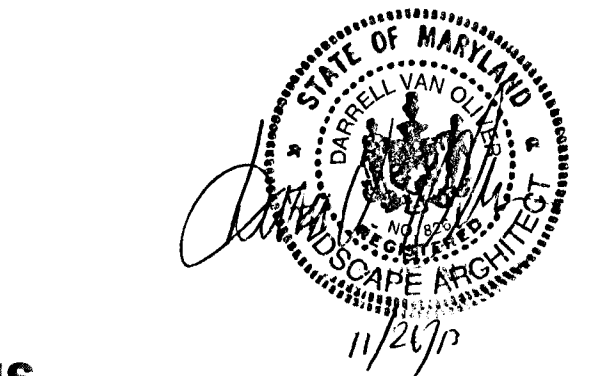
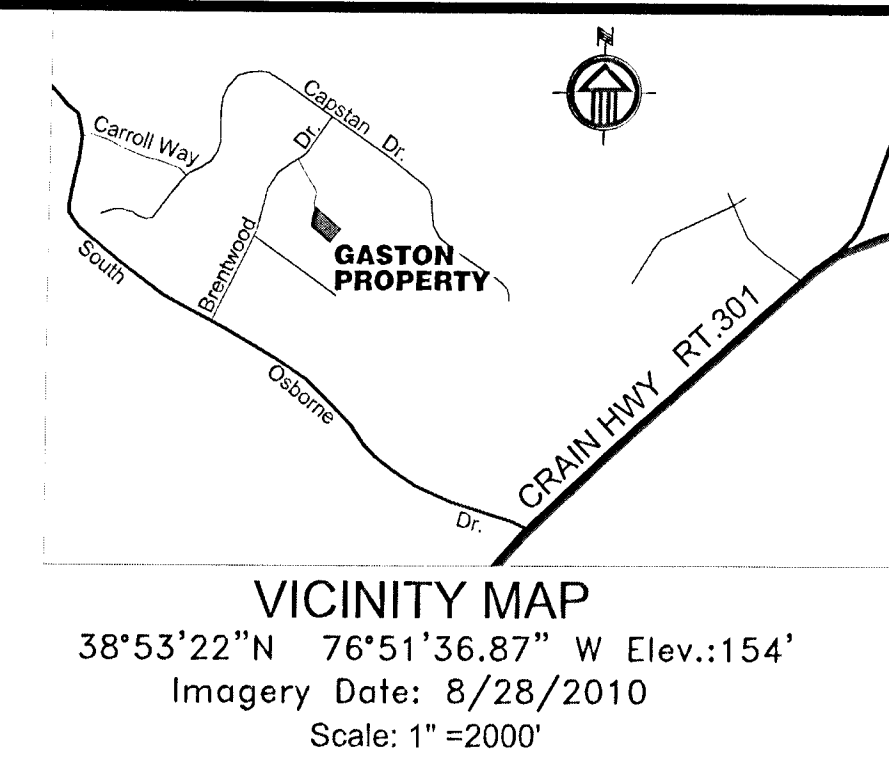

M-NCPPC  
Prince George's County Planning Department  
Environmental Planning Section  
APPROVAL  
TREE CONSERVATION PLAN  
TCP2-104-92

Approved by: JS Date: 9/25/13

01 JS 10/06/13  
02 JS 11/25/13  
03 JS 11/25/13  
04 JS 11/25/13  
05 JS 11/25/13

Darrell V. Oliver  
8910 Simpson Lane, Suite 3  
Clinton, MD 20735  
301.877.0271  
doliver@digiterradesign.com

DIGITERRA design

CLIENT: JEFFERY A. & KIMBERLY GASTON  
6820 BRENTWOOD DRIVE  
UPPER MARLBORO, MARYLAND 20772

PROJECT TITLE: MARYVALE SUBDIVISION LOT 10/BLOCK "G"

SHEET TITLE: TCP-2 PLAN REVISION

DATE: 11/26/13  
REVISION: 11/26/13  
NO. 11/26/13

FILE: C:\213-0415\DWG  
DATE: 26NOV2013  
SCALE: 1"=30'  
PLAN NUMBER: TC-101