







The purpose of this TCP2 revision is to remove all of the existing 0.56 acres of Woodland Preservation (WPA) from the property and to mitigate with the use of the Fee-in-lieu. The WPA was of extremely poor quality and dominated by invasive species including Mile-a-minute, Asian Bittersweet, Japanese Honeysuckle and Multiflora Rose. A few scattered native trees were present and those trees remain. In addition native Grape was present in some of the few trees that were present.

The initial phase of the invasive species removal has generally been completed but secondary control measures remain. Only scattered tree were initially present and scattered trees remain. The LOP on the plan is for purposes of demonstrating the limits of the WDA being removed. No grading will be done to perform the work. However, the owners intent to landscape the yard area to include planting trees, shrubs and flowers along with other typical landscaping features.

General Information Table		
Layer Category	Layer Name	Value
Zone	Zoning (Zone)	R-E
Zone	Aviation Policy Area (APA)	NA
Administrative	Tax Grid (TMG)	62 F-3
Administrative	WSSC Grid (Sheet 20)	2039E13
Administrative	Planning Area (Plan Area)	71B
Administrative	Election District (ED)	7
Administrative	Councilmanic District (CD)	4
Administrative	General Plan 2035 ESA & 2002 Tier (Tier)	ESA2 – Developing Tier
Administrative	Traffic Analysis Zone (COG) (TAZ-COG)	1226
Administrative	PG Traffic Analysis Zone (TAZ-PG)	2435

## Legend

-  LOD (Limit of Disturbance)  
 Treeline  
 BRL (Building Restriction Line)  
 Easements  
 Property Boundary  
 Topographic Contours  
 Fence (existing)

I/We Jerome M. Southers hereby acknowledge that we are aware of this Type 2 Tree Conservation Plan (TCP2) and that we understand the requirements as set forth in this TCP2.

Jerome M. Southern 9/6/2018

Jerome M. Southers 2215 Davit Court Bowie, MD 20721	Date
---	------

### QUALIFIED PROFESSIONAL CERTIFICATION

This complies with the current requirements of Subtitle 25 and the Environmental Technical Manual.

Signed: John P. Macdonald Date: 9/6/2018

John P. Markovich  
JM Forestry Services, LLC  
11552 Timberbrook Drive  
Waldorf, MD 20601  
Phone: 301-645-4977  
E-mail: [jpmarkovich@comcast.net](mailto:jpmarkovich@comcast.net)

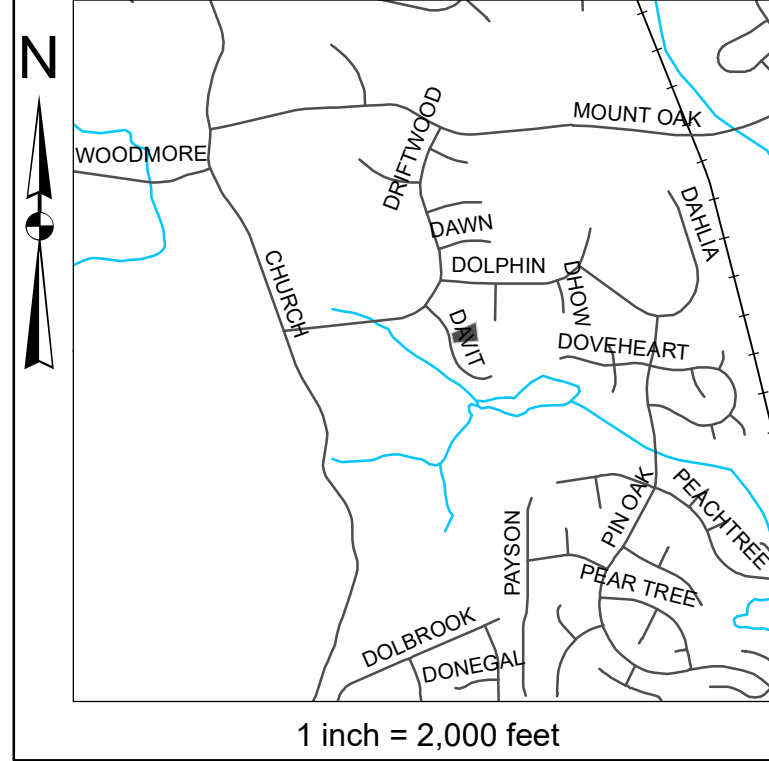

**Individual TCP2 with Previously Approved TCP1 or TCP2**  
**Woodland Conservation Worksheet for Prince George's County**

**SECTION I -- Establishing Site Information (Enter acres for each zone)**

- |   |                                    |      |      |
|---|------------------------------------|------|------|
| 1 Zone:                                     | R-E                                |      |      |
| 2 Gross Tract:                              | 0.98                               |      |      |
| 3 Floodplain:                               | 0.00                               |      |      |
| 4 Previously Dedicated Land:                | 0.00                               |      |      |
| 5 Net Tract (NTA):                          | 0.98                               | 0.00 | 0.00 |
| 6 Property Description or Subdivision Name: | Tall Oak Estates, Lot 1, Block "E" |      |      |
| 7 Current TCP Number:                       | Rev #                              |      | 0    |
| 8 Previous TCP Number:                      | Rev #                              |      |      |

**SECTION II - Determining Woodland Conservation Requirements** (Enter acres in corresponding column)

- |                                       |   |             |  |
|---------------------------------------|---|-------------|--|
| 9 Woodland Conservation Calculations: |   | Net tract   | Floodplain                             |
| 11                                    | Acres of Existing Woodland                              | 0.98        | 0.00                                   |
| 12                                    | Woodland Conservation Required for per TCPI or TCP2     | 57.62% 0.56 |  |
| 13                                    | Area of Woodland Cleared per ovious TCPI or TCP2        | 0.42        | 0.00                                   |
| 14                                    | Area of Woodland Cleared per current TCP2               | 0.98        | 0.00                                   |
| 15                                    | Area of Woodland above WCT1 not cleared by TCPI or TCP2 | 21.26       | 0.00                                   |
| 16                                    | Additional Woodland Cleared by current TCP2             | 0.56        | 0.00                                   |
| 17                                    | Does the TCPI show 2:1 replacement?                     | N           |  |
| 18                                    | Cleaving above WCT (1/4:1 Replacement)                  | 0.56        | Additional Replacement required = 0.14 |
| 19                                    | Cleaving below WCT (2:1 Replacement)                    | 0.00        | Additional Replacement required = 0.00 |
| 20                                    | Total Woodland Conservation Required :                  | 0.70        |  |

**SECTION III-Meeting the Requirement (Enter acres in corresponding column)**

- |    |  |         |      |
|----|--|---------|------|
| 21 | Woodland Conservation Provided:                              | (acres) |      |
| 22 | Woodland Preservation  |         | 0.00 |
| 23 | Reforestation / Afforestation                                |         | 0.00 |
| 24 | Natural Regeneration   |         | 0.00 |
| 25 | Landscape Credits  |         | 0.00 |
| 26 | Area approved for fee-in-lieu                                |         | 0.70 |
| 27 | Credits Received for Off-site Mitigation on another property |         | 0.70 |
| 28 | Off-site Mitigation provided on this property                |         | 0.00 |
| 29 | Total Woodland Conservation Provided                         |         | 0.70 |

- |  |            |
|--|------------|
| 29 Area of net tract woodland not cleared      | 0.00 acres |
| 30 Woodland retained not part of requirements: | 0.00 acres |

31 Prepared by: \_\_\_\_\_ Date: \_\_\_\_\_

### 32 Qualifications:

**JM Forestry Services, LLC**  
  
 11552 Timberbrook Drive  
 Waldorf, MD 20601  
 Phone/FAX: (301) 645-4977

APPLICANT / DEVELOPER

Jerome M. Southerns, et al  
2215 Davit Court  
Bowie, MD 20721  
Phone: 703-538-6728

# Type II Tree Conservation Plan

## Single Lot Revision

### TCP11-125-99

**Tall Oaks Estates**  
**Lot 1, Block "E"**  
**2215 Davit Court**  
7th ELECTION DISTRICT  
PRINCE GEORGE'S COUNTY, MARYLAND

## REVISIONS

01- Unknown
02- Increased LOD - Dewberry 8/2001
03- Change LOD for SD Dewberry 5/2002
04- Single Lort revision Lot 12-F JPM 11/1/2007

DWN	Checked
JPM	JPM

Scale **1" = 30'**

Sheet No. **1 of 1**