

L:_Maryland\Projects\MD01000a\MD01400\MD1487.01\CADD\05-ENR\Outfall 55\TCP\MD1487_01_TCP_55_revisions\3.dwg TCP2-1 Plotted By: Owen, Kara, 4/5/2019 11:24 AM

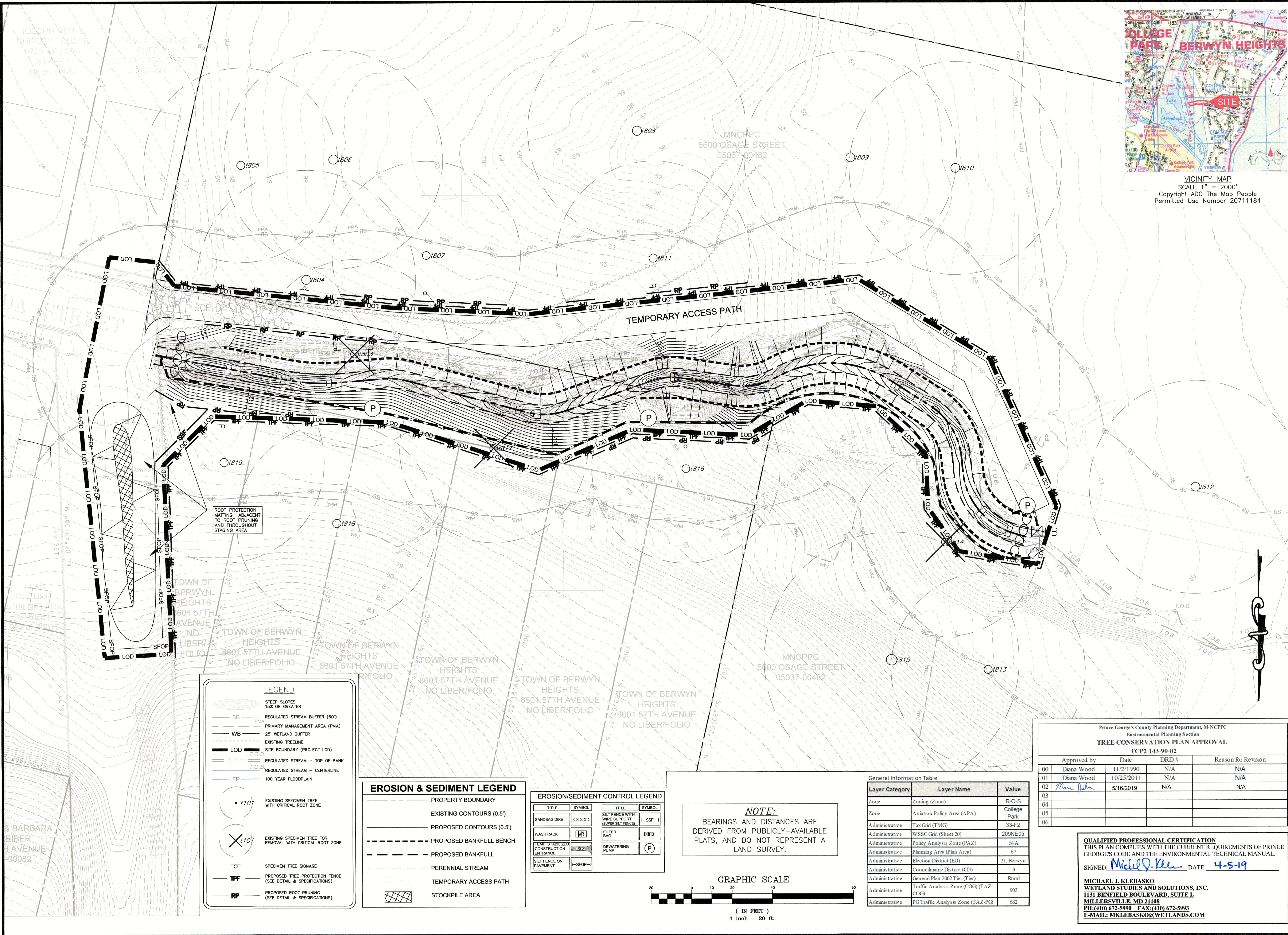

LEGEND

- SB REGULATED STREAM BUFFER (60')
- PMA PRIMARY MANAGEMENT AREA (PMA)
- WB 25' WETLAND BUFFER
- EXISTING TREELINE
- LOD SITE BOUNDARY (PROJECT LOD)
- REGULATED STREAM - TOP OF BANK
- REGULATED STREAM - CENTERLINE
- FP 100 YEAR FLOODPLAIN
- t101 EXISTING SPECIMEN TREE WITH CRITICAL ROOT ZONE
- X t101 EXISTING SPECIMEN TREE FOR REMOVAL WITH CRITICAL ROOT ZONE
- Specimen Tree Signage
- TPF PROPOSED TREE PROTECTION FENCE (SEE DETAIL & SPECIFICATIONS)
- RP PROPOSED ROOT PRUNING (SEE DETAIL & SPECIFICATIONS)

EROSION & SEDIMENT LEGEND

- PROPERTY BOUNDARY
- EXISTING CONTOURS (0.5')
- PROPOSED CONTOURS (0.5')
- PROPOSED BANKFULL BENCH
- PROPOSED BANKFULL
- PERENNIAL STREAM
- TEMPORARY ACCESS PATH
- STOCKPILE AREA

EROSION/SEDIMENT CONTROL LEGEND

TITLE	SYMBOL	TITLE	SYMBOL
SANDBAG DIKE	○○○○	SILT FENCE WITH WIRE SUPPORT (SUPER SILT FENCE)	—SSF—
WASH RACK		FILTER BAG	□FB
TEMP. STABILIZED CONSTRUCTION ENTRANCE	—SCE—	DEWATERING PUMP	⊙
SILT FENCE ON PAVEMENT	—SFOP—		

NOTE:
BEARINGS AND DISTANCES ARE DERIVED FROM PUBLICLY-AVAILABLE PLATS, AND DO NOT REPRESENT A LAND SURVEY.

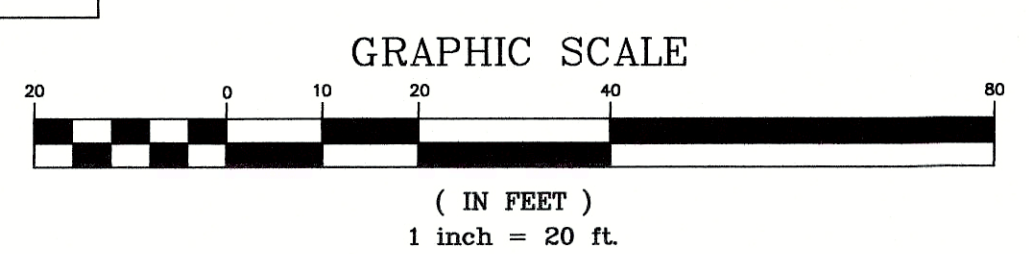

General Information Table

Layer Category	Layer Name	Value
Zone	Zoning (Zone)	R-O-S
Zone	Aviation Policy Area (APA)	College Park
Administrative	Tax Grid (TMG)	33-F2
Administrative	WSSC Grid (Sheet 20)	209NE05
Administrative	Policy Analysis Zone (PAZ)	N/A
Administrative	Planning Area (Plan Area)	67
Administrative	Election District (ED)	21, Berwyn
Administrative	Councilmanic District (CD)	3
Administrative	General Plan 2002 Tier (Tier)	Rural
Administrative	Traffic Analysis Zone (COG) (TAZ-COG)	903
Administrative	PG Traffic Analysis Zone (TAZ-PG)	682

Prince George's County Planning Department, M-NCPPC
Environmental Planning Section
TREE CONSERVATION PLAN APPROVAL
TCP2-143-90-02

Approved by	Date	DRD #	Reason for Revision
00 Diana Wood	11/2/1990	N/A	N/A
01 Diana Wood	10/25/2011	N/A	N/A
02 <i>Man Julia</i>	5/16/2019	N/A	N/A
03			
04			
05			
06			

QUALIFIED PROFESSIONAL CERTIFICATION
THIS PLAN COMPLIES WITH THE CURRENT REQUIREMENTS OF PRINCE GEORGE'S CODE AND THE ENVIRONMENTAL TECHNICAL MANUAL.

SIGNED: *Michael J. Klebasko* DATE: **4-5-19**

MICHAEL J. KLEBASKO
WETLAND STUDIES AND SOLUTIONS, INC.
1131 BENFIELD BOULEVARD, SUITE L
MILLERSVILLE, MD 21108
PH: (410) 672-5990 FAX: (410) 672-5993
E-MAIL: MKLEBASKO@WETLANDS.COM

Wetland
Solutions and Solutions, Inc.
a DAVEY company

1131 Benfield Boulevard • Suite L
Millersville, Maryland 21108
Phone: 410-672-5990 • Fax: 410-672-5993
www.wetlands.com

OUTFALL 55 RESTORATION
TYPE 2 TREE CONSERVATION PLAN -- TCP2

ANACOSTIA RIVER WATERSHED
Prince Georges County, Maryland
WSSJ Project Number: MD1487.01

REVISIONS

No.	Date	Description	Rev. By	App. By

Horizontal Datum:
Vertical Datum:
Boundary and Topo Source:
SHELADIA ASSOCIATES
PG ATLAS DIGITAL DATA

Design	Draft	Approved
CK	CK	---

Sheet #
TCP2-1

Computer File Name:
L:_Maryland\Projects\MD01000a\MD01400\MD1487.01\CADD\05-ENR\Outfall 55\TCP\MD1487_01_TCP_55_revisions\3.dwg

\\Marland\Projects\MD01000s\MD01400\MD1487.01\CADD\05-ENVR\Outfall 55\TCP\MD1487_01_TCP_55_revisions\3.dwg TCP2-2 Plotted By: Owen, Kara, 4/5/2019 11:45 AM

- DEBRIS FROM THE TREE REMOVAL OR PRUNING THAT OCCURS WITHIN 35 FEET OF THE WOODLAND EDGE MAY BE REMOVED AND PROPERLY DISPOSED OF BY RECYCLING, CHIPPING OR OTHER ACCEPTABLE METHODS. ALL DEBRIS THAT IS MORE THAN 35 FEET FROM THE WOODLAND EDGE SHALL BE CUT UP TO ALLOW CONTACT WITH THE GROUND, THUS ENCOURAGING DECOMPOSITION. THE SMALLER MATERIALS SHALL BE PLACED INTO BRUSH PILES THAT WILL SERVE AS WILDLIFE HABITAT.

TYPE 1 (TEMPORARY) TREE PROTECTION FENCE DETAIL
FOR WOODLAND PRESERVATION AREAS

DEBRIS FROM THE TREE REMOVAL OR PRUNING THAT OCCURS WITHIN 35 FEET OF THE WOODLAND EDGE MAY BE REMOVED AND PROPERLY DISPOSED OF BY RECYCLING, CHIPPING OR OTHER ACCEPTABLE METHODS. ALL DEBRIS THAT IS MORE THAN 35 FEET FROM THE WOODLAND EDGE SHALL BE CUT UP TO ALLOW CONTACT WITH THE GROUND, THUS ENCOURAGING DECOMPOSITION. THE SMALLER MATERIALS SHALL BE PLACED INTO BRUSH PILES THAT WILL SERVE AS WILDLIFE HABITAT.

TYPE 1 (TEMPORARY) TREE PROTECTION FENCE DETAIL
FOR WOODLAND PRESERVATION AREAS

NOTE: All trees located within or immediately adjacent to the LOD were surveyed. The surveyed locations are depicted on the plan.

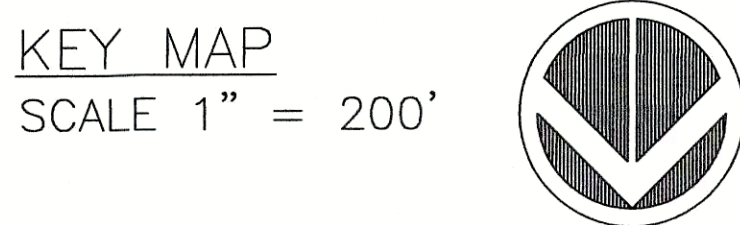

Michael J. Kle

Copyright © 2019 Wetland Studies and Solutions, Inc.

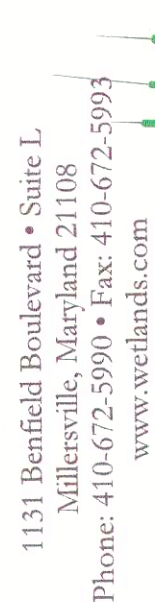

DATE: October 11 2018
SCALE: 1" = 20'

TCP2-2

Computer File Name:
L:_Maryland Projects\MD01000\MD01400\MD1487.01\CADD\05-ENV\05-01-55(TC
MD1487_01_TCP_55_revisions\5.dwg