

**Finch, Kim**

---

**From:** Justin K. Frye <jfrye@woodlawnllc.com>  
**Sent:** Monday, December 17, 2012 1:28 PM  
**To:** Finch, Kim  
**Cc:** Brown, Joe D.; 'Hylton, Lorenzo (DPW&T)'  
**Subject:** The Bequest (Robert's) at Fairwood TCPII 156-04-02  
**Attachments:** Pages from TCPII 156-04-02 Bequest 092412.pdf

Kim,

As discussed, there are two existing trees on Lot 13 that were saved during the initial stages of clearing at the above referenced property. At the direction of Mr. Brown & Mr. Hylton, I respectfully request authorization to remove the two referenced trees.

The Tulip Poplar, closest to the road, has died and has started dropping large limbs. The White Oak is too close to the house under construction and has poor branching structure. There are no limbs on the road side and all of the limbs are overhanging the house. In the future, the tree will pose a significant risk to the home.

Please find attached Sheet 3 of 4 for TCPII 156-04-02 which outlines the referenced trees with a red cloud. The trees are labeled as 'Non-Credited Preservation Area'. Please review and let me know if you have any questions or require any additional information.

Justin K. Frye

*Project Manager*

**Woodlawn Development Group**

11700 Plaza America Drive, Suite 310

Reston, Virginia 20190

o. 703.649.5100 f. 703-649-6070



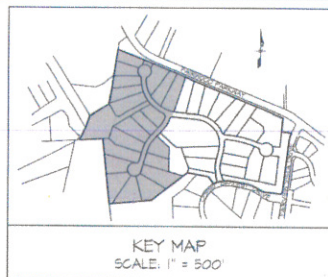

d. 301.284.8980 m. 410.980.7092





| Individual Lot and Parcel<br>Woodland Conservation Calculations |                  |                      |                            |
|---|------------------|----------------------|----------------------------|
| Woodland Percentages  | Woodland (Acres) | Non-Woodland (Acres) | Woodland Percent (Percent) |
| Lot 12  | 0.20             | 0.31                 | 0.39                       |
| Lot 13  | 0.26             | 0.29                 | 0.47                       |
| Lot 14  | 0.00             | 0.06                 | 0.00                       |
| Parcel 10   | 0.36             | 0.01                 | 0.97                       |
| Parcel 12   | 0.00             | 0.26                 | 0.00                       |
| Lot 15  | 0.00             | 0.00                 | 0.00                       |
| Lot 17  | 0.00             | 0.09                 | 0.00                       |
| Lot 18  | 0.00             | 0.00                 | 0.00                       |
| Lot 19  | 0.00             | 0.00                 | 0.00                       |
| Parcel 17   | 0.00             | 0.00                 | 0.00                       |
| Lot 20  | 1.52             | 0.12                 | 0.86                       |
| Lot 21  | 0.00             | 0.00                 | 0.00                       |
| Lot 22  | 0.41             | 0.37                 | 0.52                       |
| Lot 23  | 0.00             | 0.00                 | 0.00                       |
| Lot 24  | 0.00             | 0.12                 | 0.00                       |
| Lot 25  | 0.00             | 0.14                 | 0.00                       |
| Lot 26  | 0.00             | 0.00                 | 0.00                       |
| Lot 27  | 0.00             | 0.00                 | 0.00                       |
| Lot 28  | 0.40             | 0.08                 | 0.83                       |
| Lot 29  | 0.00             | 0.00                 | 0.00                       |
| Lot 30  | 0.00             | 0.00                 | 0.00                       |
| Lot 31  | 0.00             | 0.00                 | 0.00                       |
| Lot 32  | 0.00             | 0.00                 | 0.00                       |
| Lot 33  | 0.00             | 0.00                 | 0.00                       |
| Lot 34  | 0.00             | 0.00                 | 0.00                       |
| Lot 35  | 0.00             | 0.00                 | 0.00                       |
| Parcel 19   | 0.00             | 0.00                 | 0.00                       |
| Parcel 20   | 0.00             | 0.00                 | 0.00                       |

**LEGEND**

|   |                                    |
|---|------------------------------------|
|  | TEMPORARY TREE PROTECTION FENCE    |
|  | WOODLAND PRESERVATION              |
|  | WOODLAND DISTURBANCE               |
|  | NON-CREDITED WOODLAND PRESERVATION |
|  | TREE PROTECTION SIGN               |

[illegible]

| M. SICPP<br>NATIONAL RESOURCE INVENTORY FORGEI STAND-ON-LINEATION<br>TECH 156-04 |                    |         |
|--|--------------------|---------|
| WATER<br>APPROVAL  | APPROVAL<br>DATE   | DATE    |
| 01   | K. PING            | 4/2/05  |
| 02   | K. PING            | 1/16/07 |
| 03   | <i>[Signature]</i> | 1/29/11 |
| 04   |                    |         |
| 05   |                    |         |
| 06   |                    |         |

**Qualified Professional Certification**  
This plan complies with the current requirements of Sections 29 and 30 of the Maryland and Deltic Conservation Trust Act.

*K. R. Foster*

K. R. Foster  
Attention: Little E. Foster, P.A.  
4400 National Drive, Suite 200  
Burrville, Maryland 20866  
PH (703) 421-4024 Fax (501) 421-4026  
E-mail: [lfoster@delticpa.com](mailto:lfoster@delticpa.com)

801  
JAN 16 2007  
STATE OF MARYLAND  
DEPT. OF THE TREASURY  
TAX DIVISION

**GENERAL NOTES**

1. Temporary tree protection fence (TPF) and tree protection signage (TPS) are to prevent intrusions into woodland preservation areas during grading and construction.
2. See details 1 & 2 on sheet 4 of 4 for TPF/TPS details.
3. Sediment control features will be within the limits of the site.

at Home  
Defers You Dig  
Call

**"MISS UTILITY"**  
Service Protection Center



**CALL TOLL FREE**  
1-800-257-7777

**GLW**GUTSCHELT LITTLE & WEBER, P.A.  
CIVIL ENGINEERS, LAND SURVEYORS, LAND PLANNERS, LANDSCAPE ARCHITECTS  
3000 NATIONAL DRIVE - SUITE 250 - BAYVIEWVILLE OFFICE PARK  
DURHAMVILLE, OHIO 43015  
TEL 301-621-8324 FAX 301-621-1829 TEL/VX 301-621-2334 / AT 301-621-1098  
MAIL ADDRESS: 4700 SUTTON DRIVE - DOWNSIDE, OHIO 43015-2146 DEC TSZ DISK RLG CRI KJ

[illegible]

PREPARED FOR:  
ROUSE - FAIRWOOD  
DEVELOPMENT LIMITED PARTNERSHIP  
10275 PATUXENT PARKWAY  
COLUMBIA, MD 21045  
ATTN: MR. ALBERT F. EDWARDS, P.E.  
TEL: (410) 992-6027

TYPE II TREE CONSERVATION PLAN

**ROBERTS PROPERTY**  
LOTS 1-36 AND PARCELS 'A' - 'H'; BLOCK 'A'

|                   |                              |                            |
|-------------------|------------------------------|----------------------------|
| SCALE<br>1" = 50' | ZONING<br>RE/MXC             | C. L. R. FILE No.<br>03105 |
| DATE<br>DEC. 2004 | TAX MAP - GRID<br>46 - A3/A4 | SHEET<br>3 OF 4            |