

DETAILED LOD PLAN

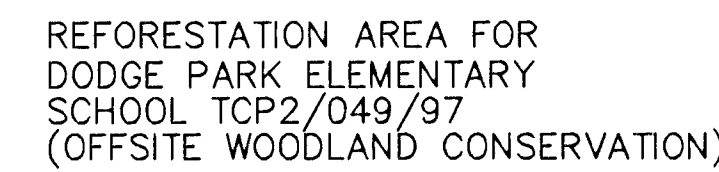

SIGN (APPROX. 50 U.C.)

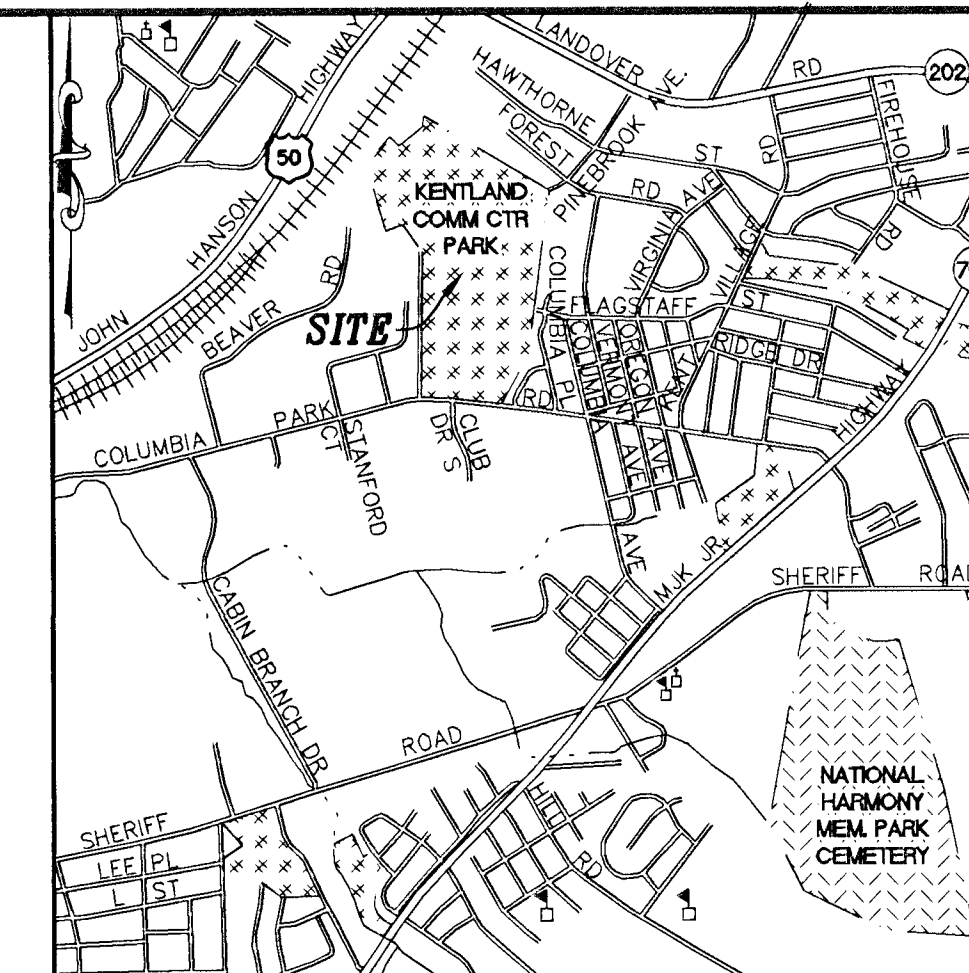

VICINITY MAP
SCALE: 1" = 2,000'±
(WSSC GRID: 203 NE 6)
PRINCE GEORGE'S COUNTY
ADC MAP PAGE: 5530
GRID: H-4
(LATEST EDITION)

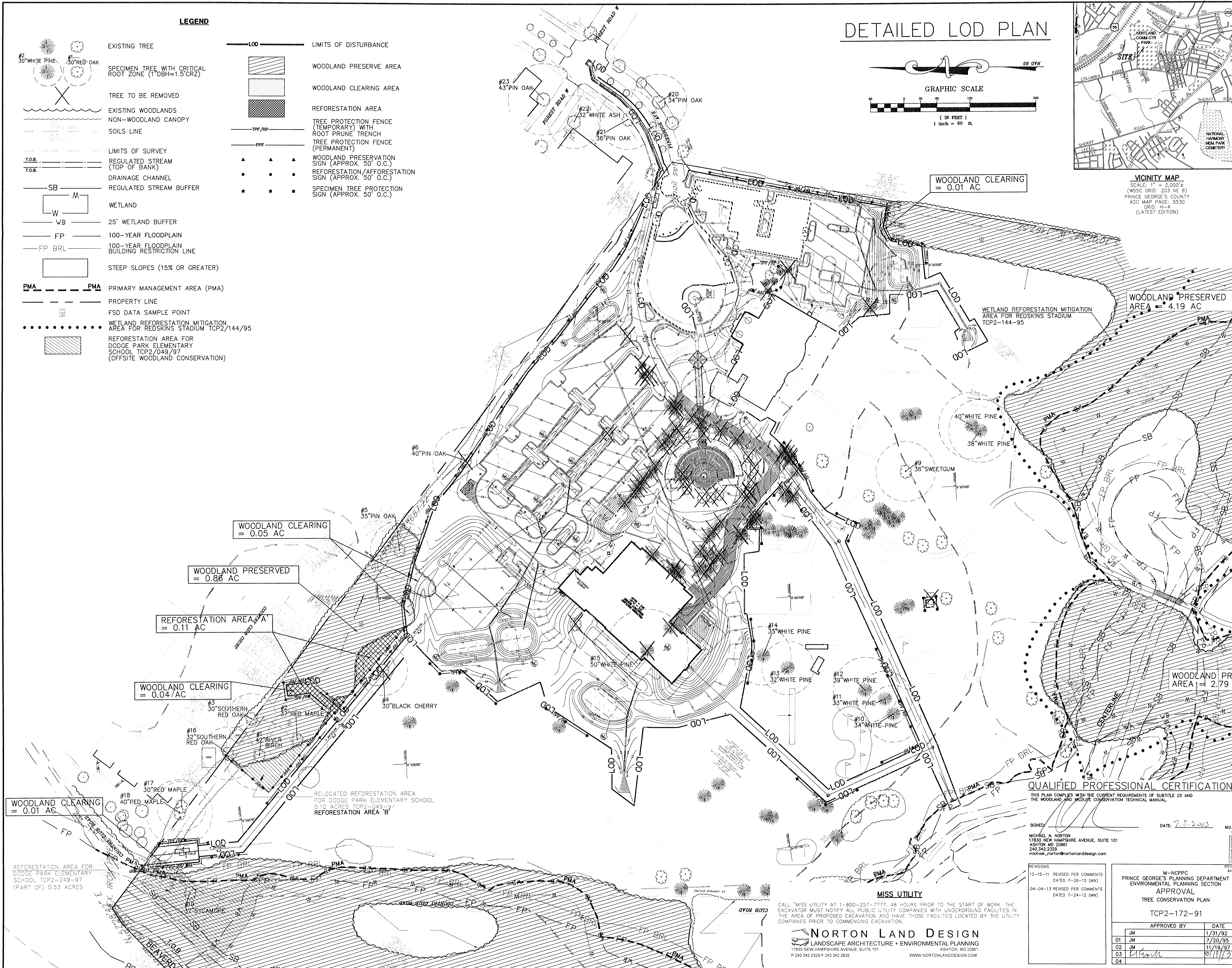

REVISIONS	DESCRIPTION
-----------	-------------

REV#	DA#
------	-----

ADTEK

P.O. Box 727, 5 South
Main Street



OWNER / DEVELOPER:

SHEET TITLE: TYPE 2 TREE

JUL 10

THIS DRAWING
INDICATED IN
IF IT IS SIGN

DATE:
04/04/

SCALE:
1:200

AS SH
DRAWN BY: MES
CHECKED BY:

MAN

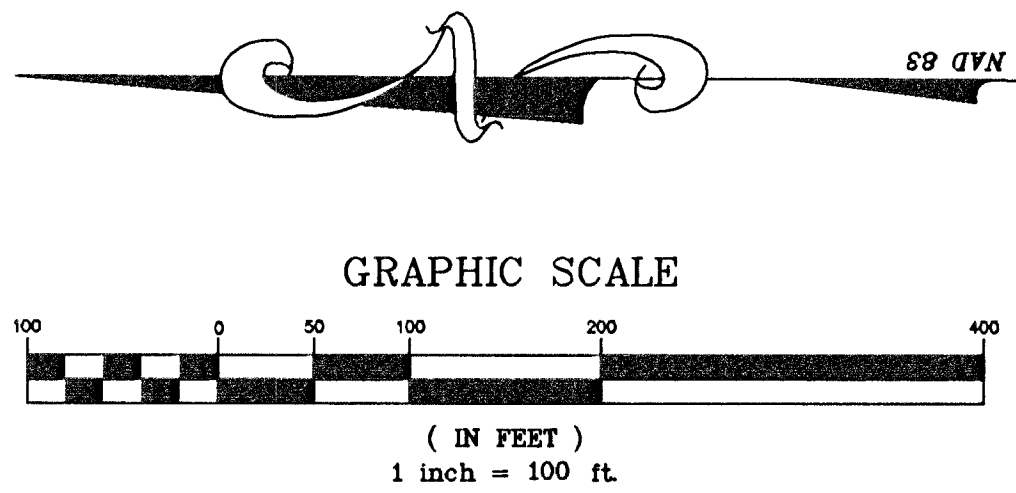

LEGEND

	EXISTING TREE
	EXISTING SPECIMEN TREE >30" DBH WITH CRITICAL ROOT ZONE
	TREE TO BE REMOVED
	EXISTING WOODLANDS
	NON-WOODLAND CANOPY
	LIMITS OF DISTURBANCE
	LIMITS OF SURVEY
	PROPERTY BOUNDARY
	STREAM
	DRAINAGE CHANNEL
	REGULATED STREAM BUFFER
	WETLAND
	25' WETLAND BUFFER
	PRIMARY MANAGEMENT AREA (PMA)
	100-YEAR FLOODPLAIN
	100-YEAR FLOODPLAIN BUILDING RESTRICTION LINE
	WETLAND REFORESTATION MITIGATION AREA FOR REDSKINS STADIUM TCP2-144-95
	REFORESTATION AREA FOR DODGE PARK ELEMENTARY SCHOOL TCP2-049-97 (OFFSITE WOODLAND CONSERVATION)
	WOODLAND PRESERVE AREA
	WOODLAND CLEARING AREA
	REFORESTATION AREA

OFFSITE WOODLAND CONSERVATION SUMMARY TABLE (ACRES)

WOODLAND CONSERVATION BANK IDENTIFIER	WOODLAND CONSERVATION CREDITS TOTAL (ACRES)	OFF-SITE PRESERVATION (ACRES) 2:1	OFF-SITE AFFORESTATION (ACRES) 1:1	PRESERVATION AREA AVAILABLE (ACRES)	AFFORESTATION AREA AVAILABLE (ACRES)	RECORDATION INFORMATION (LIBER/FOLIO)	BENEFITING TCP2	BENEFITING PROPERTY	REVIEWER	APPROVAL DATE
TCP2-172-91	0.63	0.00	0.63	0.00	0.00	2912/482	TCP2-049-97	DODGE PARK E.S.	JOHN MARKOVICH	11/18/97
TCP2-172-91	7.85	0.00	7.85	0.00	0.00	---	TCP2-144-95	REDSKINS STADIUM	JOHN MARKOVICH	11/18/97

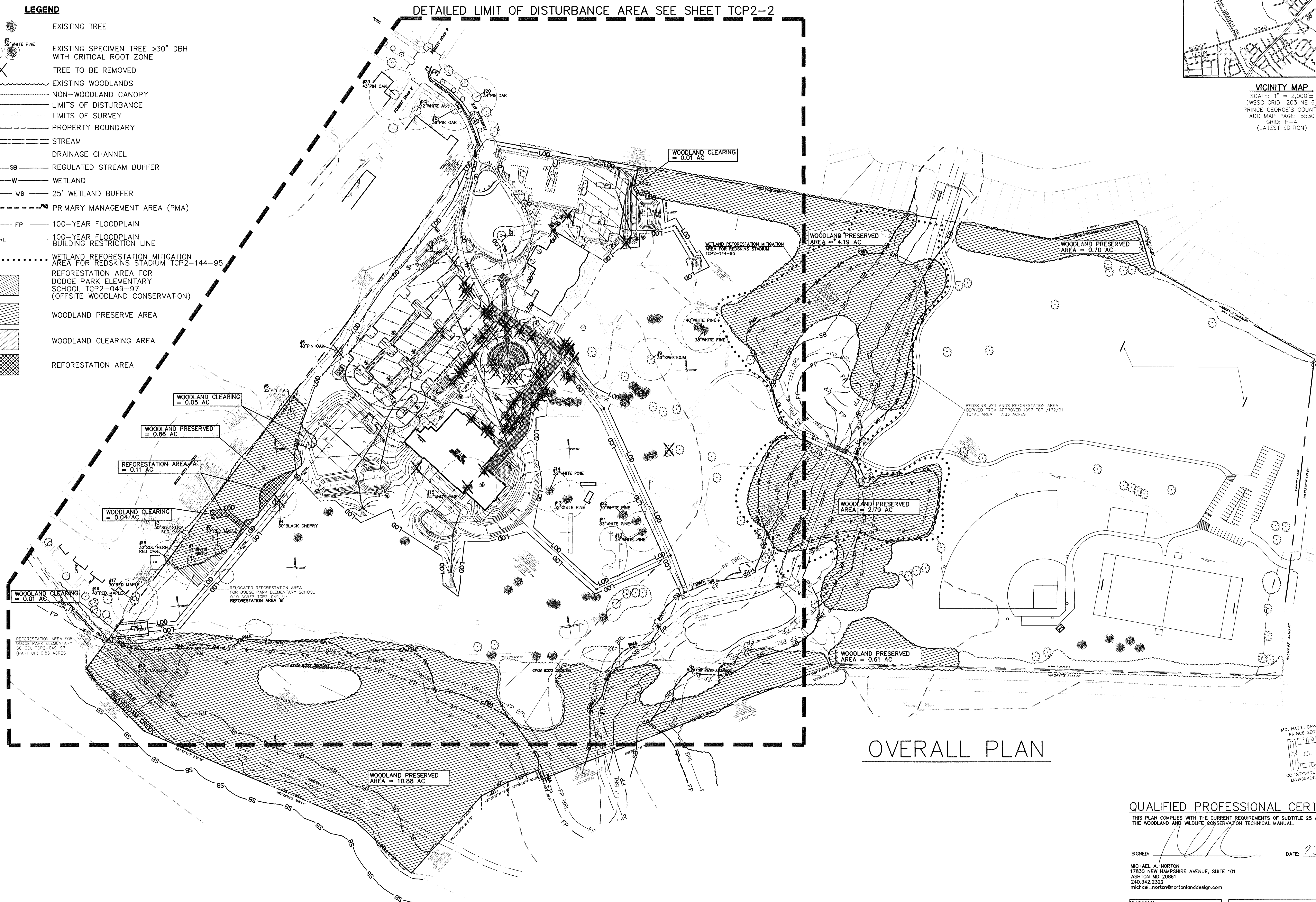
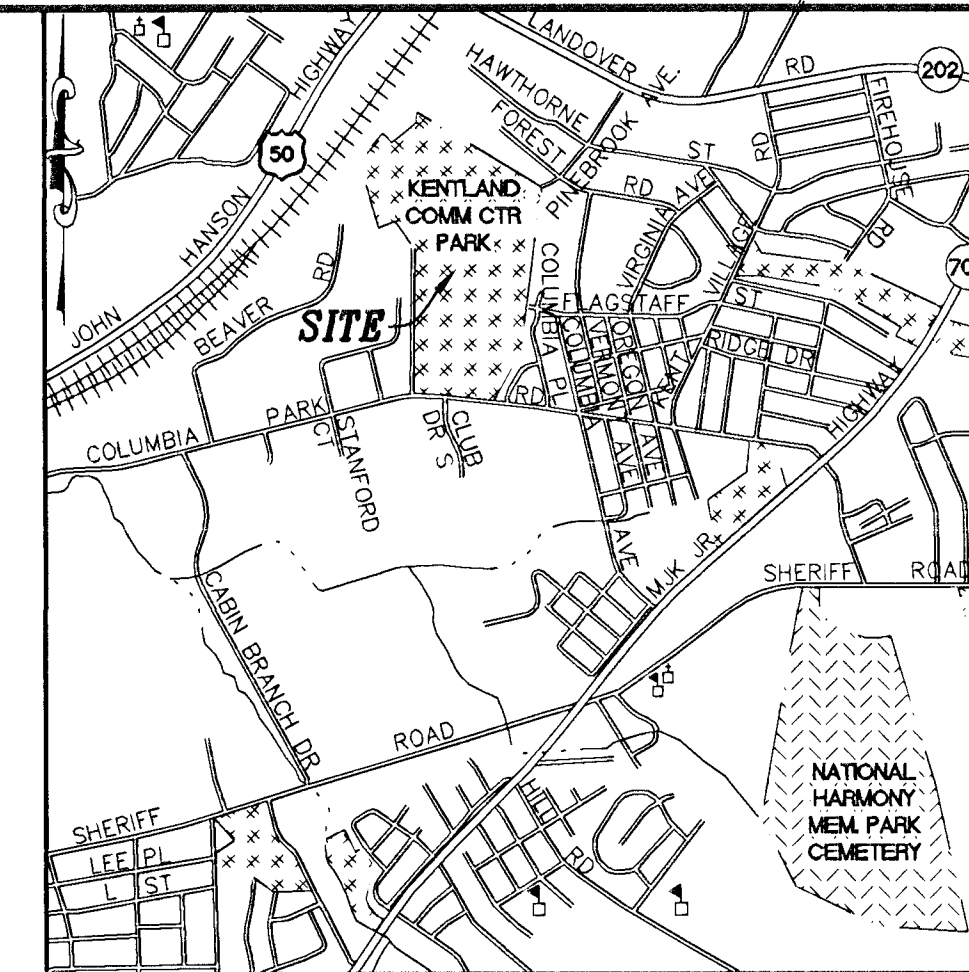

WOODLAND CONSERVATION SUMMARY TABLE (ACRES)

SHEET	GROSS TRACT AREA	100-YEAR FLOOD PLAIN (FP)	NET TRACT AREA (NTA)	EXISTING WOODLAND (NTA)	EXISTING WOODLAND (FP)	WOODLAND CLEARED (C-NTA)	WOODLAND CLEARED (C-FP)	WOODLAND PRESERVE (WPA)	WOODLAND REFOREST (WRA)	WOODLAND RETAINED/NOT CREDITED (WR-NC)	WOODLAND RETAINED/ASSUMED CLEARED (WR-AC)
TOTAL	80.90	12.11	68.79	14.25	9.04	0.11	0.00	14.14	0.11	—	—

OFFSITE MITIGATION AND GENERAL NOTES:

- THE REDSKINS WETLAND REFORESTATION MITIGATION IS DERIVED FROM THE M-NOPPC PG COUNTY PLANNING DEPARTMENT 1997 APPROVED TCP2/172/91 PLAN TITLED "AMENDMENT TO TCP2/61/94 AND TCP2/59/97 FOR DODGE PARK ELEMENTARY SCHOOL #2" AND FIELD VERIFICATION BY MICHAEL NORTON IN APRIL 2010. THE MITIGATION AREA WAS LEFT TO REGENERATE NATURALLY AND APPEARS HEALTHY. THE AREA TOTALS 7.85 ACRES.
- THE DODGE PARK REFORESTATION MITIGATION AREAS WERE DERIVED FROM THE M-NOPPC PG COUNTY PLANNING DEPARTMENT 1997 APPROVED TCP2/172/91 PLAN TITLED "AMENDMENT TO TCP2/61/94 AND TCP2/59/97 FOR DODGE PARK ELEMENTARY SCHOOL #2." THE 0.53 ACRE AREA WAS LEFT TO REGENERATE NATURALLY AND APPEARS HEALTHY. THE 0.10 ACRE AREA IS UNDETECTABLE IN THE FIELD.
- THE PROPERTY (29.59 ACRES) TO THE SOUTH OF THE SITE AND ACROSS COLUMBIA PARK ROAD HAS BEEN SEPARATED AS TCP2/026/92.

MISS UTILITY

CALL "MISS UTILITY AT 1-800-257-7777, 48 HOURS PRIOR TO THE START OF WORK. THE EXCAVATOR MUST NOTIFY ALL PUBLIC UTILITY COMPANIES WITH UNDERGROUND FACILITIES IN THE AREA OF PROPOSED EXCAVATION AND HAVE THOSE FACILITIES LOCATED BY THE UTILITY COMPANIES PRIOR TO COMMENCING EXCAVATION.

NORTON LAND DESIGN

LANDSCAPE ARCHITECTURE + ENVIRONMENTAL PLANNING

17830 NEW HAMPSHIRE AVENUE, SUITE 101 ASHTON, MD 20881
P 240.342.2329 F 240.342.2632 WWW.NORTONLANDDESIGN.COM

QUALIFIED PROFESSIONAL CERTIFICATION

THIS PLAN COMPLIES WITH THE CURRENT REQUIREMENTS OF SUBTITLE 25 AND THE WOODLAND AND WILDLIFE CONSERVATION TECHNICAL MANUAL.

SIGNED: DATE: 7/3/2010

MICHAEL A. NORTON
17830 NEW HAMPSHIRE AVENUE, SUITE 101
ASHTON, MD 20881
240.342.2329
michael_norton@nortonlanddesign.com

REVISIONS

12-15-11	REVISED PER COMMENTS	DATED 7-26-10 (MN)
04-04-13	REVISED PER COMMENTS	DATED 7-24-12 (MN)

M-NOPPC
PRINCE GEORGE'S PLANNING DEPARTMENT
ENVIRONMENTAL PLANNING SECTION
APPROVAL
TREE CONSERVATION PLAN
TCP2-172-91

APPROVED BY	DATE
JM	1/31/92
01 JM	7/20/95
02 JM	11/19/97
03 JM	8/19/12
04	

DRAWN BY: MES
CHECKED BY: MAN

DATE: 04/04/13
SCALE: AS SHOWN
DRAWING NO: TCP2-1
SHEET 1 OF 3
PROJECT JOB NUMBER: 070114

ADTEK

CIVIL/STRUCTURAL/SPECIALTY ENGINEERING

17830 NEW HAMPSHIRE AVENUE, SUITE 101
ASHTON, MARYLAND 20881
P 240.342.2329 F 240.342.2632
WWW.ADTENGINEERS.COM

FWM

FREDERICK WARD ASSOCIATES

ARCHITECTS | ENGINEERS | PLANNERS | SURVEYORS

P.O. Box 727, 5 South Main Street
Bel Air, Maryland 21034-0727
410-838-7900
410-838-1243 fax
WWW.FREDERICKWARD.COM

M-NOPPC
Park Planning and Development Division
6600 Kenilworth Avenue
Riverdale, MD 20737

TYPE 2 TREE CONSERVATION PLAN

KENTLAND COMMUNITY CENTER
LOCATED AT COLUMBIA PARK
ASHTON, MARYLAND
13TH ELECTION DISTRICT PRINCE GEORGE'S COUNTY, MD

STANDARD TYPE 2 TREE CONSERVATION PLAN NOTES

- THIS PLAN IS SUBMITTED TO FULFILL THE WOODLAND CONSERVATION REQUIREMENTS FOR THE SEDIMENT CONTROL PERMIT. IF THE SEDIMENT CONTROL PERMIT EXPIRES, THEN THIS TOPZ ALSO EXPIRES AND IS NO LONGER VALID.
- CUTTING OR CLEARING OF WOODLAND NOT IN CONFORMANCE WITH THIS PLAN OR WITHOUT THE EXPRESSED WRITTEN CONSENT OF THE PLANNING DIRECTOR OR DESIGNEE SHALL BE SUBJECT TO A \$9.00 PER SQUARE FOOT MITIGATION FEE.
- A PRE-CONSTRUCTION MEETING IS REQUIRED PRIOR TO THE ISSUANCE OF GRADING PERMITS. THE DEPARTMENT OF PUBLIC WORKS AND TRANSPORTATION OR THE DEPARTMENT OF ENVIRONMENTAL RESOURCES, AS APPROPRIATE, SHALL BE CONTACTED PRIOR TO THE START OF ANY WORK ON THE SITE TO CONDUCT A PRE-CONSTRUCTION MEETING WHERE IMPLEMENTATION OF WOODLAND CONSERVATION MEASURES SHOWN ON THIS PLAN WILL BE DISCUSSED IN DETAIL.
- THE DEVELOPER OR BUILDER OF THE LOTS OR PARCELS SHOWN ON THIS PLAN SHALL NOTIFY FUTURE BUYERS OF ANY WOODLAND CONSERVATION AREAS THROUGH THE PROVISION OF A COPY OF THIS PLAN AT THE TIME OF CONTRACT SIGNING. FUTURE CONTRACT OWNERS ARE ALSO SUBJECT TO THIS REQUIREMENT.
- THE OWNERS OF THE PROPERTY SUBJECT TO THIS TREE CONSERVATION PLAN ARE SOLELY RESPONSIBLE FOR CONFORMANCE TO THE REQUIREMENTS CONTAINED HEREIN.
- THE PROPERTY IS WITHIN THE DEVELOPED TIER AND IS ZONED ROS.
- THE SITE IS NOT ADJACENT TO A ROADWAY DESIGNATED AS SCENIC, HISTORIC, A PARKWAY OR A SCENIC BYWAY.
- THE SITE IS NOT ADJACENT TO A ROADWAY CLASSIFIED AS ARTERIAL OR HIGHWAY.
- THIS PLAN IS NOT GRANDFATHERED UNDER CB-27-2010, SECTION 25-117(g).

TREE PRESERVATION AND RETENTION NOTES

- ALL WOODLANDS DESIGNATED ON THIS PLAN FOR PRESERVATION ARE THE RESPONSIBILITY OF THE PROPERTY OWNER. THE WOODLAND AREAS ARE TO REMAIN IN A NATURAL STATE. THIS INCLUDES THE CANOPY TREES AND UNDERSTORY VEGETATION. A REVISED TREE CONSERVATION PLAN IS REQUIRED PRIOR TO ANY REMOVAL OF CANOPY TREES THAT ARE NOT SPECIFICALLY IDENTIFIED TO BE CLEARED ON THE APPROVED TOPZ.
- TREE AND WOODLAND CONSERVATION METHODS SUCH AS ROOT PRUNING SHALL BE CONDUCTED AS NOTED ON THIS PLAN.
- ALL TEMPORARY TREE PROTECTION FENCING REQUIRED BY THIS PLAN SHALL BE INSTALLED PRIOR TO COMMENCEMENT OF CLEARING AND GRADING OF THE SITE AND SHALL REMAIN IN PLACE UNTIL THE BOND IS RELEASED FOR THE PROJECT. FAILURE TO INSTALL AND MAINTAIN TEMPORARY OR PERMANENT TREE PROTECTIVE DEVICES IS A VIOLATION OF THIS TOPZ.
- WOODLAND PRESERVATION AREAS SHALL BE POSTED WITH SIGNAGE AS SHOWN ON THE PLANS AT THE SAME TIME AS THE TEMPORARY TPF IS INSTALLED. THESE SIGNS MUST REMAIN IN PERPETUITY.
- THE DEVELOPER AND/OR BUILDER IS RESPONSIBLE FOR THE COMPLETE PRESERVATION OF ALL FORESTED AREAS SHOWN ON THE APPROVED PLAN TO REMAIN UNDISTURBED. ONLY TREES OR PARTS THEREOF DESIGNATED BY THE COUNTY AS DEAD, DYING OR HAZARDOUS MAY BE REMOVED.
- A TREE IS CONSIDERED HAZARDOUS IF A CONDITION IS PRESENT WHICH LEADS A CERTIFIED ARBORIST OR LICENSED TREE EXPERT TO BELIEVE THAT THE TREE OR A PORTION OF THE TREE HAS A POTENTIAL TO FALL AND STRIKE A PERSON, A BUILDING OR OTHER HIGH USE AREA AND RESULT IN PERSONAL INJURY OR PROPERTY DAMAGE.
- DURING THE INITIAL STAGES OF CLEARING AND GRADING, IF HAZARDOUS TREES ARE PRESENT, OR TREES ARE PRESENT THAT ARE NOT HAZARDOUS BUT ARE LEANING INTO THE DISTURBED AREA, THE PERMITTEE SHALL REMOVE OR REMOVE OR A LICENSED TREE EXPERT MUST CERTIFY THAT THE TREE OR THE PORTION THEREIN IN QUESTION HAS A POTENTIAL TO FALL AND STRIKE A PERSON, PARKING AREA OR OTHER HIGH USE AREA AND MAY RESULT IN PERSONAL INJURY OR PROPERTY DAMAGE. IF THE TREE OR PORTIONS THEREOF ARE IN IMMINENT DANGER OF STRIKING A STRUCTURE, PARKING AREA OR OTHER HIGH USE AREA AND MAY RESULT IN PERSONAL INJURY OR PROPERTY DAMAGE THEN THE CERTIFICATION IS NOT REQUIRED AND THE PERMITTEE SHALL TAKE CORRECTIVE ACTION IMMEDIATELY. THE CONDITION OF THE AREA SHALL BE FULLY DOCUMENTED THROUGH PHOTOGRAPHS PRIOR TO CORRECTIVE ACTION BEING TAKEN. THE CORRECTIVE ACTION SHALL BE SUBMITTED TO THE INSPECTOR FOR DOCUMENTATION OF THE DAMAGE.

IF CORRECTIVE PRUNING MAY ALLEVIATE A HAZARDOUS CONDITION, THE CERTIFIED ARBORIST OR A LICENSED TREE EXPERT MAY PROCEED WITHOUT FURTHER AUTHORIZATION. THE PRUNING MUST BE DONE IN ACCORDANCE WITH THE APPROPRIATE STANDARDS, THE APPROPRIATE ANSI A-300 PRUNING STANDARDS. THE CONDITION OF THE AREA SHALL BE FULLY DOCUMENTED THROUGH PHOTOGRAPHS PRIOR TO CORRECTIVE ACTION BEING TAKEN. THE PHOTOS SHALL BE SUBMITTED TO THE INSPECTOR FOR DOCUMENTATION OF THE DAMAGE.

DEBRIS FROM THE TREE REMOVAL OR PRUNING THAT OCCURS WITHIN 35 FEET OF THE WOODLAND EDGE MAY BE REMOVED AND PROPERLY DISPOSED OF BY RECYCLING, CHIPPING OR OTHER ACCEPTABLE METHOD. ALL DEBRIS MUST BE REMOVED WITHIN 35 FEET FROM THE WOODLAND EDGE SHALL BE CUT UP TO ALLOW CONTACT WITH THE GROUND, THUS ENCOURAGING DECOMPOSITION. THE SMALLER MATERIALS SHALL BE PLACED INTO BRUSH PILES THAT WILL SERVE AS MULCH.

TREE WORK TO BE COMPLETED WITHIN A ROAD RIGHT-OF-WAY REQUIRES A PERMIT FROM THE MARYLAND DEPARTMENT OF NATURAL RESOURCES UNLESS THE TREE REMOVAL IS SHOWN WITHIN THE APPROVED LIMITS OF DISTURBANCE ON A TOPZ. THE WORK IS REQUIRED TO BE CONDUCTED BY A LICENSED TREE EXPERT.

AFFORESTATION AND REFORESTATION NOTES

- ALL AFFORESTATION AND REFORESTATION BONDS, BASED ON SQUARE FOOTAGE, SHALL BE SUBMITTED TO THE COUNTY PRIOR TO THE ISSUANCE OF ANY PERMITS. THESE BONDS WILL BE RETAINED AS SURETY UNTIL ALL REQUIRED ACTIVITIES HAVE BEEN SATISFIED OR THE REQUIRED TIMEFRAME FOR MAINTENANCE HAS PASSED, WHICHEVER IS LONGER.
- THE PLANTING OF AFFORESTATION OR REFORESTATION AREAS SHALL BE COMPLETED PRIOR TO THE ISSUANCE OF THE MOST BUILDING PERMIT IS TO OCCUR FROM NOVEMBER THROUGH MAY ONLY. NO PLANTING SHALL BE DONE WHILE GROUND IS FROZEN. PLANTING WITH LARGER CALIPER STOCK OR CONTAINERIZED STOCK MAY BE DONE AT ANY TIME PROVIDED A DETAILED MAINTENANCE SCHEDULE IS PROVIDED.
- IF PLANTING CANNOT OCCUR DUE TO PLANTING CONDITIONS, THE DEVELOPER OR PROPERTY OWNER SHALL INSTALL THE FENCING AND SIGNAGE IN ACCORDANCE WITH THE APPROVED TYPE 2 TREE CONSERVATION PLAN. PLANTING SHALL THEN BE ACCOMPLISHED DURING THE NEXT PLANTING SEASON. IF PLANTING IS DELAYED BEYOND THE TRANSFER OF THE PROPERTY TITLE TO THE HOMEOWNER, THE DEVELOPER OR BUILDER SHALL OBTAIN A SIGNED STATEMENT FROM THE PURCHASER INDICATING THAT THEY UNDERSTAND THAT THE REFORESTATION AREA IS LOCATED ON THEIR PROPERTY AND THAT REFORESTATION WILL OCCUR DURING THE NEXT PLANTING SEASON. A COPY OF THAT DOCUMENT SHALL BE PRESENTED TO THE GRADING INSPECTOR AND THE COUNTY.
- REFORESTATION AREAS SHALL NOT BE MOVED. THE MANAGEMENT OF THE COMING VEGETATION AROUND INDIVIDUAL TREES AND THE REMOVAL OF NOXIOUS, INVASIVE AND NON-NATIVE VEGETATION WITHIN THE REFORESTATION AREAS IS ACCEPTABLE.
- ALL REQUIRED TEMPORARY TREE PROTECTION FENCING SHALL BE INSTALLED PRIOR TO THE CLEARING AND GRADING OF THE SITE AND SHALL REMAIN IN PLACE UNTIL THE PERMANENT TREE PROTECTION FENCING IS INSTALLED WITH THE REQUIRED PLANTING. THE TEMPORARY FENCING IS NOT REQUIRED TO BE INSTALLED IF THE PERMANENT FENCING IS INSTALLED PRIOR TO CLEARING AND GRADING OF THE SITE. FAILURE TO INSTALL AND MAINTAIN TEMPORARY OR PERMANENT TREE PROTECTIVE FENCING IS A VIOLATION OF THIS TOPZ.
- AFFORESTATION/REFORESTATION AREAS SHALL BE POSTED WITH NOTIFICATION SIGNAGE, AS SHOWN ON THE PLANS, AT THE SAME TIME AS THE PERMANENT PROTECTION FENCING IS INSTALLED. THESE SIGNS SHALL REMAIN IN PERPETUITY.
- THE COUNTY INSPECTOR SHALL BE NOTIFIED PRIOR TO SOIL PREPARATION OR INITIATION OF ANY TREE PLANTINGS ON THIS SITE.
- AT THE TIME OF ISSUANCE OF THE FIRST PERMIT, THE FOLLOWING INFORMATION SHALL BE SUBMITTED TO THE M-NOPPC PLANNING DEPARTMENT REGARDING THE CONTRACTOR RESPONSIBLE FOR IMPLEMENTATION OF THIS PLAN:
CONTRACTOR NAME: ADDRESS: BUSINESS NAME: PHONE: RESULTS OF ANNUAL SURVIVAL CHECKS FOR EACH OF THE REQUIRED FOUR YEARS AFTER TREE PLANTING SHALL BE REPORTED TO THE M-NOPPC, PLANNING DEPARTMENT.
- FAILURE TO ESTABLISH THE AFFORESTATION OR REFORESTATION WITHIN THE PRESCRIBED TIME FRAME WILL RESULT IN THE FORFEITURE OF THE REFORESTATION BOND AND/OR A VIOLATION OF THIS PLAN INCLUDING THE ASSOCIATED \$9.00 PER SQUARE FOOT PENALTY UNLESS THE COUNTY INSPECTOR APPROVES A WRITTEN EXTENSION.

POST DEVELOPMENT NOTES

- IF THE DEVELOPER OR BUILDER NO LONGER HAS AN INTEREST IN THE PROPERTY AND THE NEW OWNER DESIRES TO REMOVE A HAZARDOUS TREE OR PORTION THEREOF, THE NEW OWNER SHALL OBTAIN A WRITTEN STATEMENT FROM A CERTIFIED ARBORIST OR LICENSED TREE EXPERT IDENTIFYING THE HAZARDOUS CONDITION AND THE PROPOSED CORRECTIVE MEASURES PRIOR TO HAVING THE TREE REMOVED. AFTER PROPER DOCUMENTATION HAS BEEN COMPLETED PER THE HANDOUT "GUIDANCE FOR PRINCE GEORGE'S COUNTY PROPERTY OWNERS, PRESERVATION OF WOODLAND CONSERVATION AREAS", THE ARBORIST OR TREE EXPERT MAY THEN REMOVE THE TREE. THE STUMP SHALL BE CUT AS CLOSE TO THE GROUND AS POSSIBLE AND LEFT IN PLACE. THE REMOVAL OR GRINDING OF THE STUMPS IN THE WOODLAND CONSERVATION AREA IS NOT PERMITTED.
- IF A TREE OR PORTIONS THEREOF ARE IN IMMINENT DANGER OF STRIKING A STRUCTURE, PARKING AREA OR OTHER HIGH USE AREA AND MAY RESULT IN PERSONAL INJURY OR PROPERTY DAMAGE THEN THE CERTIFICATION IS NOT REQUIRED AND THE PERMITTEE SHALL PROCEED WITH CORRECTIVE ACTION IMMEDIATELY. THE CONDITION OF THE AREA SHALL BE FULLY DOCUMENTED THROUGH PHOTOGRAPHS PRIOR TO CORRECTIVE ACTION BEING TAKEN. THE PHOTOS SHALL BE SUBMITTED TO THE INSPECTOR FOR DOCUMENTATION OF THE DAMAGE.
- TREE WORK TO BE COMPLETED WITHIN A ROAD RIGHT-OF-WAY REQUIRES A PERMIT FROM THE MARYLAND DEPARTMENT OF NATURAL RESOURCES UNLESS THE TREE REMOVAL IS SHOWN WITHIN THE APPROVED LIMITS OF DISTURBANCE ON A TOPZ. THE WORK IS REQUIRED TO BE CONDUCTED BY A LICENSED TREE EXPERT.
- THE REMOVAL OF NOXIOUS, INVASIVE AND NON-NATIVE PLANT SPECIES FROM ANY WOODLAND PRESERVATION AREA SHALL BE DONE WITH THE USE OF HAND-HELD EQUIPMENT ONLY (PRUNERS OR A CHAINSAW). THESE PLANTS MAY BE CUT NEAR THE GROUND, AND MATERIALS LESS THAN TWO INCHES DIAMETER MAY BE CUT BY HAND OR BY MACHINERY AND DISPOSED OF APPROPRIATELY. ALL MATERIAL FROM THESE NOXIOUS, INVASIVE AND NON-NATIVE PLANTS GREATER THAN TWO INCHES DIAMETER SHALL BE CUT OUT TO ALLOW CONTACT WITH THE GROUND, THUS ENCOURAGING DECOMPOSITION.
- THE USE OF BROADCAST SPRAYING OF HERBICIDES IS NOT PERMITTED. HOWEVER, THE USE OF HERBICIDES TO DISCOURAGE RE-SPROUTING OF INVASIVE, NOXIOUS OR NON-NATIVE PLANTS IS PERMITTED IF DONE AS AN APPLICATION OF THE CHEMICAL DIRECTLY TO THE CUT STUMP IMMEDIATELY FOLLOWING CUTTING OF PLANT TOPS. THE USE OF ANY HERBICIDE SHALL BE DONE IN ACCORDANCE WITH THE LABEL INSTRUCTIONS.
- THE USE OF CHAINSAWS IS EXTREMELY DANGEROUS AND SHOULD NOT BE CONDUCTED WITH POORLY MAINTAINED EQUIPMENT, WITHOUT SAFETY EQUIPMENT OR BY INDIVIDUALS NOT TRAINED IN THE USE OF THIS EQUIPMENT FOR THE PRUNING AND/OR CUTTING OF TREES.

PLANTING SPECIFICATION NOTES

- QUANTITY: (SEE PLANT SCHEDULE)
- TYPE: (SEE PLANT SCHEDULE)
- PLANT QUALITY STANDARDS: THE PLANTS SELECTED SHALL BE HEALTHY AND STURDY REPRESENTATIVES OF THEIR SPECIES. SEEDLINGS SHALL HAVE A MINIMUM HEIGHT OF 18". THE DIAMETER OF THE ROOT COLLAR (THE PART OF THE ROOT JUST BELOW GROUND LEVEL) SHALL BE AT LEAST 3/8". THE ROOTS SHALL BE WELL DEVELOPED AND AT LEAST 8" LONG, NO MORE THAN TWENTY-FIVE PERCENT (25%) OF THE ROOT SYSTEM (BOTH PRIMARY AND AUXILIARY/FIBROUS ROOTS) SHALL BE PRESENT. PLANTS THAT DO NOT HAVE AN ABUNDANCE OF WELL DEVELOPED TERMINAL BUDS ON THE LEADERS AND BRANCHES SHALL BE REJECTED. PLANTS SHALL BE SHIPPED BY THE NURSERY IMMEDIATELY AFTER LIFTING FROM THE FIELD OR REMOVAL FROM THE GREEN HOUSE, AND PLANTED IMMEDIATELY UPON RECEIPT BY THE LANDSCAPE CONTRACTOR. IF THE PLANTS CANNOT BE PLANTED IMMEDIATELY AFTER DELIVERY TO THE REFORESTATION SITE, THEY SHALL BE STORED IN THE SHADE WITH THEIR ROOT MASSES PROTECTED FROM DIRECT EXPOSURE TO SUN AND WIND BY THE USE OF STRAW, PEAT MOSS COFFER AND OTHER SUITABLE MATERIAL AND SHALL BE MAINTAINED THROUGH PERIODIC WATERING, UNTIL THE TIME OF PLANTING.
- PLANT HANDLING: THE QUANTITY OF SEEDLINGS TAKEN TO THE FIELD SHALL NOT EXCEED THE QUANTITY THAT CAN BE PLANTED IN A DAY. SEEDLINGS, ONCE REMOVED FROM THE NURSERY OR TEMPORARY STORAGE AREA SHALL BE PLANTED IMMEDIATELY.
- TIMING OF PLANTING: THE BEST TIME TO PLANT SEEDLINGS IS WHEN THEY ARE DORMANT, PRIOR TO SPRING BUDDING. THE MOST SUITABLE MONTHS FOR PLANTING ARE MARCH AND APRIL WHEN THE SOIL IS MOST, BUT MAY BE PLANTED FROM MARCH THROUGH NOVEMBER. NO PLANTING SHALL BE DONE WHILE GROUND IS FROZEN. PLANTING SHALL OCCUR WITHIN ONE GROWING SEASON OF THE ISSUANCE OF GRADING/BUILDING PERMITS AND/OR REACHING THE FINAL GRADING AND STABILIZATION OF PLANTING AREAS.
- SEEDLING PLANTING: TREE SEEDLINGS SHALL BE HAND PLANTED USING A DIBBLE BAR OR SHARP-SHOOTER SHOVEL. IT IS IMPORTANT THAT THE SEEDLING BE PLACED IN THE HOLE SUCH THAT THE ROOTS CAN SPREAD OUT NATURALLY. THEY SHOULD NOT BE SET, BALLED OR OR BENT. MOST SOIL SHOULD THEN BE PACKED FIRMLY AROUND THE ROOTS. SEEDLINGS SHOULD BE PLANTED AT A DEPTH WHERE THEIR ROOTS LIE JUST BELOW THE GROUND SURFACE. AIR POCKETS SHOULD NOT BE LEFT AFTER CLOSING THE HOLE, WHICH WOULD ALLOW THE ROOTS TO DRY OUT. SEE PLANTING DETAILS FOR FURTHER EXPLANATION. IF THE CONTRACTOR WISHES TO PLANT BY ANOTHER METHOD, THE PREPARER OF THIS TREE CONSERVATION PLAN MUST BE CONTACTED AND GIVE HIS APPROVAL BEFORE PLANTING MAY BEGIN.
- SPACING: SEE PLANT SCHEDULE AND/OR GRADING PLAN FOR SPACING REQUIREMENTS.
- SOIL: UPON THE COMPLETION OF ALL PLANTING OPERATIONS, A SOIL TEST SHALL BE CONDUCTED TO DETERMINE WHAT SOIL PREPARATION AND SOIL AMENDMENTS, IF ANY, ARE NECESSARY PRIOR TO EACH PLANTING SITE. SOIL SAMPLES SHALL BE TAKEN AT A RATE THAT PROVIDES ONE SOIL SAMPLE FOR EACH AREA THAT APPEARS TO HAVE A DIFFERENT SOIL TYPE (IF THE ENTIRE AREA IS HOMOGENEOUS, THEN ONLY ONE SAMPLE IS NECESSARY), AND SUBMITTED TO TESTING TO A PRIVATE COMPANY. THE COMPANY OF CHOICE SHALL MAKE RECOMMENDATIONS FOR IMPROVING THE EXISTING SOIL. THE SOIL WILL BE TESTED AND RECOMMENDED FOR CORRECTIONS OF SOIL TEXTURE, PH, MAGNESIUM, PHOSPHORUS, POTASSIUM, CALCIUM AND ORGANIC MATTER.
- SOIL IMPROVEMENT MEASURES: THE SOIL SHALL THEN BE IMPROVED ACCORDING TO THE RECOMMENDATIONS MADE BY THE TESTING COMPANY.
- FENCING AND SIGNAGE: FINAL PROTECTIVE FENCING SHALL BE PLACED ON THE VISIBLE AND/OR DEVELOPMENT SIDE OF PLANTING AREAS. THE FINAL PROTECTIVE FENCE SHALL BE INSTALLED UPON COMPLETION OF PLANTING OPERATIONS UNLESS IT WAS INSTALLED DURING THE INITIAL STAGES OF DEVELOPMENT. SIGNS SHALL BE POSTED PER THE SIGNAGE DETAIL ON THIS PLAN.
- PLANTING METHOD: CONSULT THE PLANTING DETAIL(S) SHOWN ON THIS PLAN.
- MULCHING: APPLY TWO-INCH THICK LAYER OF WOODCHIP OR SHREDDED HARDWOOD MULCH TO EACH PLANTING SITE. IF THE MINIMUM NUMBER HAS NOT BEEN PROVIDED, THE AREA MUST BE SUPPLEMENTED WITH ADDITIONAL SEEDLINGS TO REACH THE REQUIRED NUMBER AT TIME OF PLANTING.
- GROUND COVER ESTABLISHMENT: THE REMAINING UNDISTURBED AREA BETWEEN SEEDLING PLANTING SITES SHALL BE SEEDED AND STABILIZED WITH FOREST AND COMPANION SEED MIXES SHOWN IN THE PLANT LIST AT THE RATE SHOWN.
- MOWING: NO MOWING SHALL BE ALLOWED IN ANY PLANTING AREA.
- SURVIVAL CHECK FOR BOND RELEASE: THE SEEDLING PLANTING IS TO BE CHECKED AT THE END OF EACH YEAR FOR FOUR YEARS TO ASSURE THAT NO LESS THAN 100% OF THE ORIGINAL PLANTED QUANTITY SURVIVES. IF THE MINIMUM NUMBER HAS NOT BEEN PROVIDED, THE AREA MUST BE SUPPLEMENTED WITH ADDITIONAL SEEDLINGS TO REACH THE REQUIRED NUMBER AT TIME OF PLANTING.
- SOURCE OF SEEDLINGS: NURSERY NAME: ADDRESS: PHONE:

FOUR-YEAR MAINTENANCE PLAN FOR RE-AFFORESTATION AREAS

FIELD CHECK THE RE-AFFORESTATION AREA ACCORDING TO THE FOLLOWING SCHEDULE:

- YEAR 1: SITE PREPARATION AND TREE PLANTING SURVIVAL CHECK (ONCE ANNUALLY) (SEPTEMBER-NOVEMBER) (SEE NOTE 1) WATERING IS NEEDED (2 X MONTH) CONTROL OF UNDESIRABLE VEGETATION AS NEEDED (1 X IN JUNE AND 1 X IN SEPTEMBER/MINIMUM)
- YEAR 2-3: REINFORCEMENT PLANTING IF NEEDED (SEE NOTE 2) SURVIVAL CHECK (ONCE ANNUALLY) (SEPTEMBER-NOVEMBER) CONTROL OF UNDESIRABLE VEGETATION IF NEEDED (1 X IN MAY AND 1 X IN AUGUST/MINIMUM)
- YEAR 4: REINFORCEMENT PLANTING IF NEEDED (SEE NOTE 3) SURVIVAL CHECK (SEPTEMBER-NOVEMBER)

PROPOSED REFORESTATION PLANT MATERIALS

AREA 'A' 0.10 AC X 150 = 15 TREES REQUIRED	AREA 'B' 0.10 AC X 150 = 15 TREES REQUIRED	BOTANICAL NAME	COMMON NAME	SIZE	UNIT/ROOT	SPACING	FORM
4	3	ACER RUBRUM	RED MAPLE	1.5-2" CAL	B&B	RANDOMLY 20' O.C.	TREE
4	3	QUERCUS PRINUS	CHESTNUT OAK	1.5-2" CAL	B&B	RANDOMLY 20' O.C.	TREE
3	3	CARYA TOMENTOSA	MOCKERNUT HICKORY	1.5-2" CAL	B&B	RANDOMLY 20' O.C.	TREE
3	3	LIRIODENDRON TULIPIFERA	TULIP POPLAR	1.5-2" CAL	B&B	RANDOMLY 20' O.C.	TREE
3	3	NYSSA SYLVATICA	BLACK GUM	1.5-2" CAL	B&B	RANDOMLY 20' O.C.	TREE
2	2	AMELANCHIER CANADENSIS	SERVICEBERRY	18" HEIGHT	CONT.	RANDOMLY 32' O.C.	SHRUB
2	2	HAMMAMELIS VIRGINIANA	WITCH HAZEL	24" HEIGHT	CONT.	RANDOMLY 32' O.C.	SHRUB
2	1	LINDERA BENZOIN	SPICEBUSH	12" HEIGHT	CONT.	RANDOMLY 32' O.C.	SHRUB
17 TREES PROVIDED	15 TREES PROVIDED	SYLVIA FIELD AND FOREST MIX OR EARNEST NATIVE UPLAND AND MEADOW MIX: OR EQUIVALENT					
6 SHRUB PROVIDED	5 SHRUB PROVIDED	COMPANION SEED MIX OF 50% ANNUAL RYE GRASS AND 50% SHEEP FESCUE					
9 LBS	8 LBS	—	—	SEED	SEED	80 LBS. PER ACRE	SEED
4 LBS	4 LBS	—	—	SEED	SEED	8 LBS. PER 10,000 SF	SEED

NOTES:

- STABILIZE DISTURBED OR BARE AREAS WITH NATIVE UPLAND MIX AND COMPANION SEED MIX AS INDICATED.
- TREES ARE TO BE PROTECTED WITH INDIVIDUAL TREES SHELTERS PER DETAIL ON THIS SHEET OR APPROVED EQUAL.
- PLANTING STOCK MUST MEET THE STANDARDS SET BY THE AMERICAN NURSERY AND LANDSCAPE ASSOCIATION.
- NO CLEARING IS TO TAKE PLACE OUTSIDE OF THE LIMITS OF DISTURBANCE.
- TREES AND SHRUBS TO BE PLANTED OUTSIDE THE LOD ARE TO BE DIG. WITH HAND EQUIPMENT ONLY. NO MACHINERY IS TO BE USED OUTSIDE OF THE LOD. PLANTS ARE TO BE INSTALLED AND STABILIZED SAME DAY.

WOODLAND PRESERVATION AREA SIGN

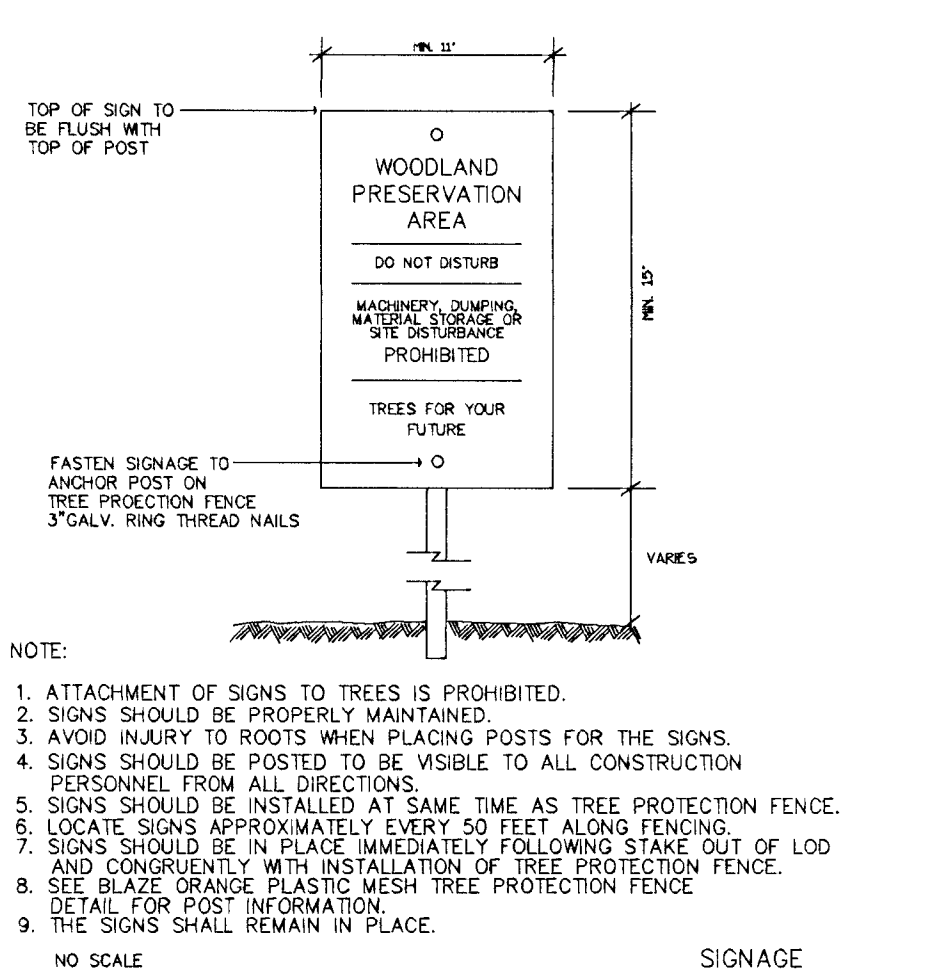

BLAZE ORANGE PLASTIC MESH

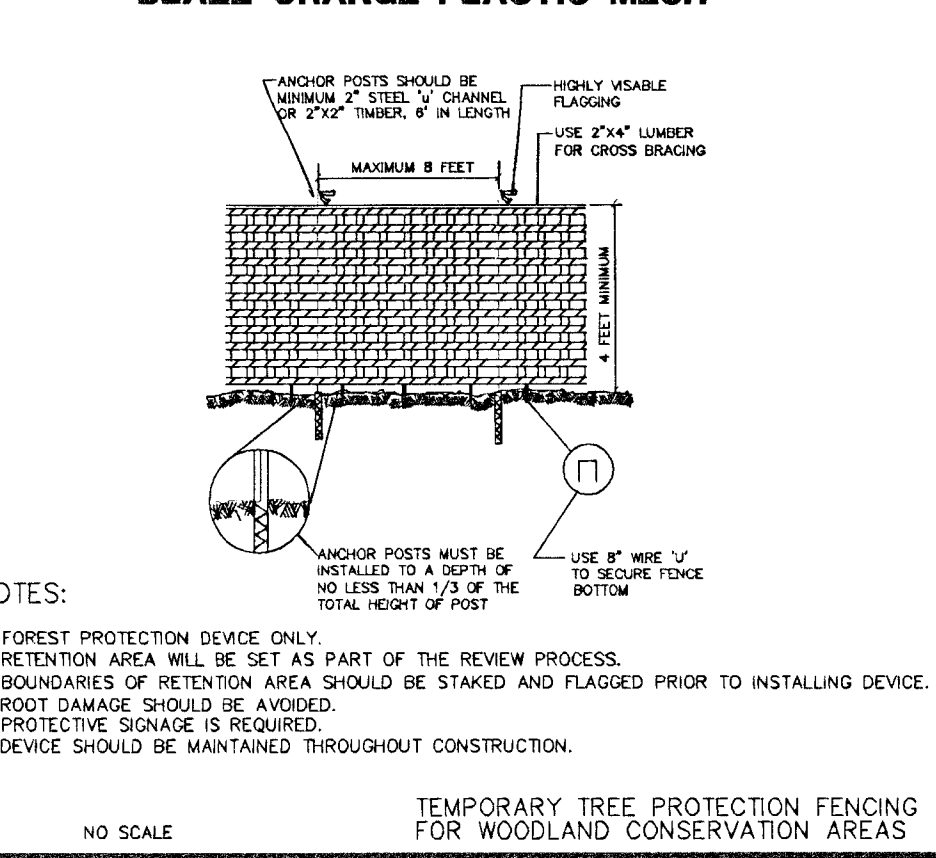

TREE PRUNING/CROWN REDUCTION

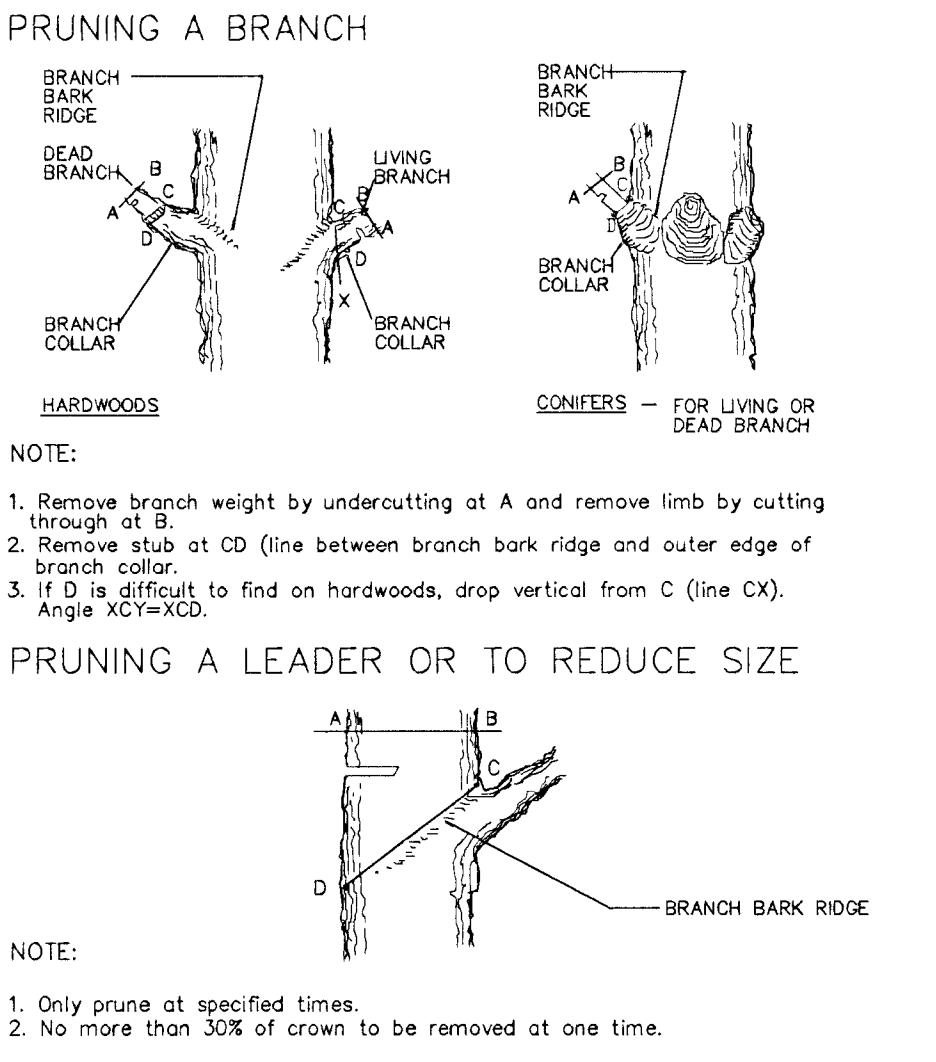

PRUNING A LEADER OR TO REDUCE SIZE

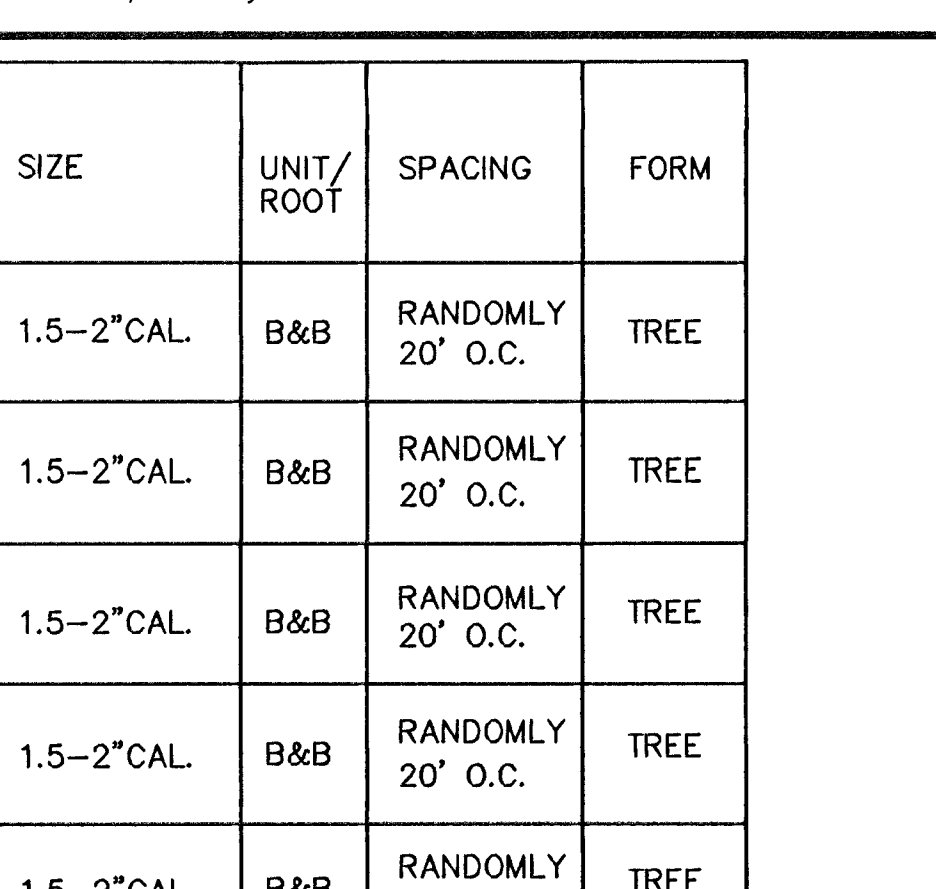

REFORESTATION AREA SIGN

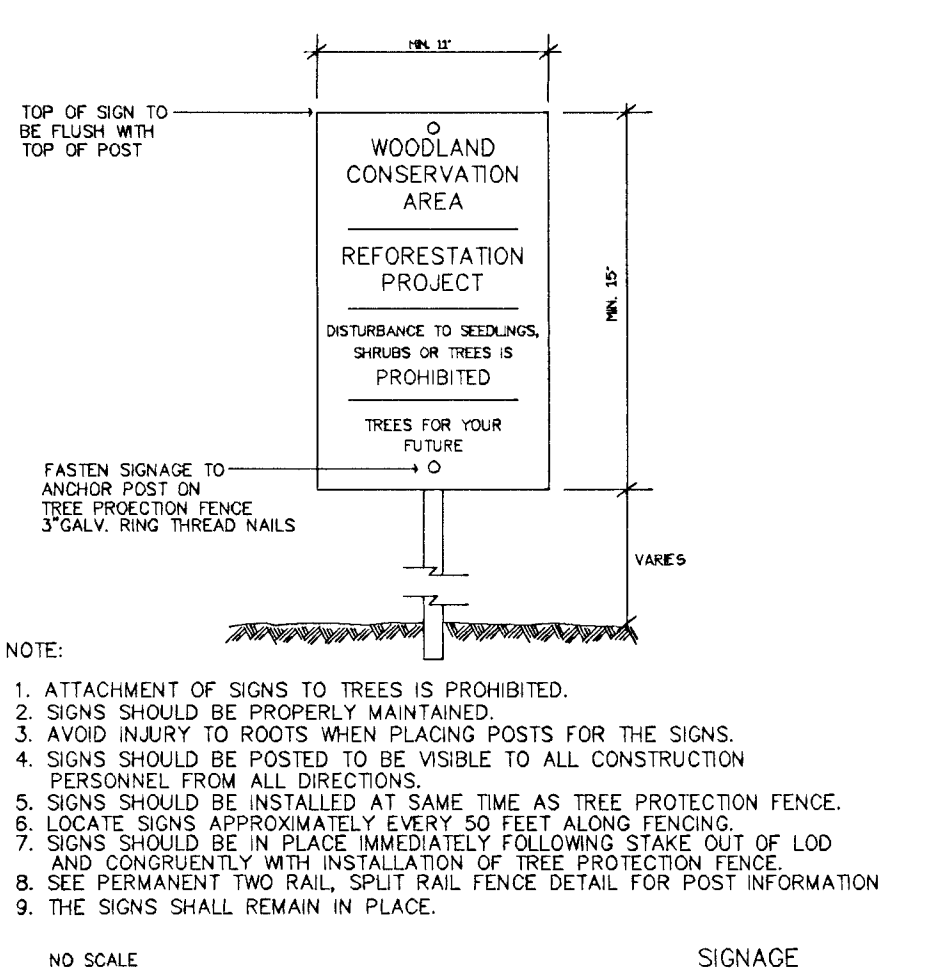

PERMANENT SPLIT RAIL TREE PROTECTION FENCE FOR REFORESTATION AREAS

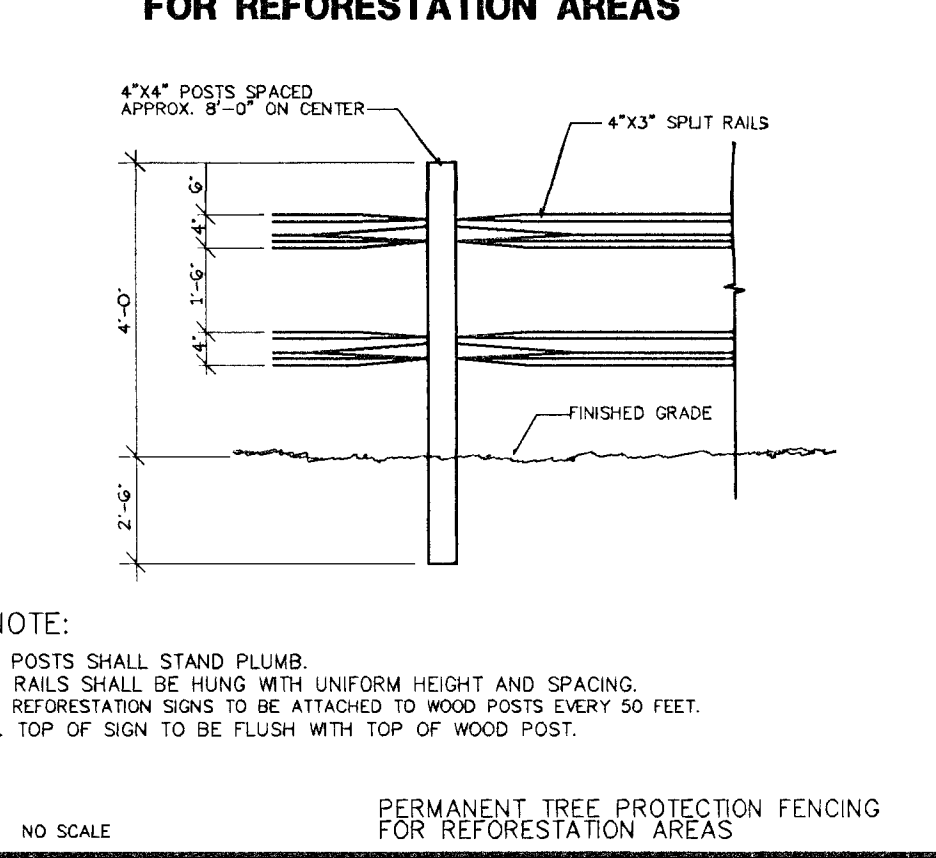

TYPE II TREE CONSERVATION PLAN NOTES FOR A PUBLIC OFF-SITE WOODLAND CONSERVATION BANK

- ANY FUTURE ACTIVITIES ON THIS PROPERTY THAT RESULT IN THE CLEARING OF WOODLAND WILL INITIATE ADDITIONAL WOODLAND CONSERVATION REQUIREMENTS FOR THIS PROPERTY. AT THAT TIME THE TOPZ SHALL BE REVISED TO CALCULATE THE REQUIREMENTS FOR THIS PROPERTY AND DEMONSTRATE HOW THOSE REQUIREMENTS ARE BEING SATISFIED IN ADDITION TO THE OFF-SITE MITIGATION AREAS ALREADY CREATED.
- OFF-SITE WOODLAND CONSERVATION MITIGATION AREAS CREATED FOR THE PURPOSE OF SATISFYING THE OFF-SITE WOODLAND CONSERVATION REQUIREMENT OF A BENEFITING PROPERTY MAY NOT BE USED TO SATISFY THE REQUIREMENTS FOR THIS PROPERTY IN THE FUTURE.
- OFF-SITE WOODLAND CONSERVATION MITIGATION BANKS MAY NOT ENCUMBER LANDS PREVIOUSLY PROTECTED OR ENCUMBERED BY PERMANENT PROTECTION INSTRUMENTS OR FOR ANOTHER ENVIRONMENTAL MITIGATION REQUIREMENT.
- EACH SIGNED COMMITMENT FOR A PORTION OF THE OFF-SITE BANK WILL REQUIRE THE SUBMITTAL OF A SIGNED PUBLIC TRANSFER CERTIFICATE TO THE ENVIRONMENTAL PLANNING SECTION. EACH TRANSFER CERTIFICATE SHALL CLEARLY CROSS-REFERENCE THE APPROPRIATE TOPZ AND PROJECT NAMES (BANKING PROPERTY AND BENEFITING PROPERTY).
- ALL OFF-SITE WOODLAND CONSERVATION AREAS ESTABLISHED ON EXISTING (PRESERVED) WOODLANDS SHALL BE CREDITED AT A RATE OF 2 ACRES OF EXISTING WOODLANDS FOR EVERY 1 ACRE OF OFF-SITE WOODLAND CONSERVATION MITIGATION REQUIRED. IN ACCORDANCE WITH NR ARTICLE 16-107(b)(2), OFF-SITE WOODLAND CONSERVATION AREAS ESTABLISHED AS AFFORESTATION AREAS OR AS NATURAL REGENERATION SHALL BE CREDITED AT A RATE OF 1 ACRE OF AFFORESTATION OR OVER 1 ACRE OF OFF-SITE MITIGATION REQUIRED, BUT MAY NOT BE TRANSFERRED UNTIL AFTER TWO GROWING SEASONS AND CERTIFICATION OF ADEQUATE SURVIVAL UNLESS AN AFFORESTATION BOND IS POSTED.
- THE TOPZ OFF-SITE WOODLAND CONSERVATION SUMMARY TABLE SHALL BE REVISED EACH TIME A TRANSFER CERTIFICATE IS REQUIRED TO IDENTIFY THE AREAS AFFECTED, THE BENEFITING PROPERTY NAME AND TOPZ NUMBER, AND THE RECDORATION NUMBERS.
- IF A TRANSFER CERTIFICATE IS PROVIDED AND IS LATER FOUND TO BE UNNECESSARY, A WRITTEN REQUEST SHALL BE SUBMITTED TO THE EPS TO EVALUATE THE TRANSFER CERTIFICATE RELEASE REQUEST. IF IT IS DETERMINED THAT THE TRANSFER CERTIFICATE MAY BE RELEASED, THE EPS WILL APPROPRIATE REVISIONS TO THE TOPZ.
- TIMBER HARVESTING ACTIVITIES ON THE SITE MAY OCCUR ONLY AFTER APPROVAL OF A FOREST MANAGEMENT OR STEWARDSHIP PLAN BY THE PRINCE GEORGE'S COUNTY FORESTRY BOARD AND AFTER APPROVAL OF A REVISED TOPZ.

SPECIMEN, CHAMPION AND HISTORIC TREE TABLE - 30"+

Tree #	COMMON NAME	SCIENTIFIC NAME	D.B.H. (INCHES)	RATING	COMMENTS	PROPOSED DISPOSITION
1	RIVER BIRCH	BETULA NIGRA	42	FAIR	75% STATE CHAMPION/BRUNK DAMAGE/HEART ROT/DEBRIS/ROOTS BROKEN SCAFFOLD/LIMBS	SAVE & PROTECT
2	RED MAPLE	ACER RUBRUM	37	GOOD	CONVEX/WEAK/ROOTS BROKEN/LEADERS/HEART ROT/DEBRIS	SAVE & PROTECT
3	SOUTHERN RED OAK	QUERCUS FALCATA	30	EXCELLENT	CUT LIMBS/DEBRIS	SAVE & PROTECT
4	BLACK CHERRY	PRUNUS SEROTINA	30	POOR	VINE/BRUNK/DAMA/BROKEN/LEADERS/HEART ROT/DEBRIS	TO BE REMOVED
5	PN OAK	QUERCUS PALUSTRIS	35	GOOD	VINE/BROKEN LIMBS/DEBRIS	SAVE & PROTECT
6	PN OAK	QUERCUS PALUSTRIS	40	GOOD	VINE/BROKEN LIMBS/DEBRIS/DEBRIS/ATTACHMENTS	TO BE REMOVED
7	VOID	VOID	VOID	VOID	VOID	VOID
8	VOID	VOID	VOID	VOID	VOID	VOID
9	SWEETGUM	LIQUIDAMBAR STYRACIFLUA	38	GOOD	EXPLODED/DAMAGED/GROLED/ROOTS/COOKS/BROKEN LIMBS	SAVE & PROTECT
10	WHITE PINE	PNUS STROBUS	34	GOOD	EXPLODED/DAMAGED/ROOT/ROD/BROKEN LIMBS	SAVE & PROTECT
11	WHITE PINE	PNUS STROBUS	33	EXCELLENT	EXPLODED/DAMAGED/ROOTS/BROKEN LIMBS	SAVE & PROTECT
12	WHITE PINE	PNUS STROBUS	39	GOOD	75% STATE CHAMPION/EXPLODED/DAMAGED/ROOTS/CUT LIMBS	SAVE & PROTECT
13	WHITE PINE	PNUS STROBUS	32	FAIR	EXPLODED/DAMAGED/GROLED/ROOTS/DEBRIS/BROKEN LIMBS	SAVE & PROTECT
14	WHITE PINE	PNUS STROBUS	35	FAIR	EXPLODED/DAMAGED/GROLED/ROOTS/WEAK	SAVE & PROTECT
15	WHITE PINE	PNUS STROBUS	50	GOOD	75% STATE CHAMPION/EXPLODED/DAMAGED/ROOTS/IRREGULAR TRUNK/SPLITS AT 6V/VINES/DEBRIS/BROKEN LIMBS	TO BE REMOVED
16	SOUTHERN RED OAK	QUERCUS FALCATA	32	FAIR	VINE/DEBRIS/DEBRIS/BROKEN LIMBS	SAVE & PROTECT
17	RED MAPLE	ACER RUBRUM	30	FAIR	VINE/HEAVY LEAN	SAVE & PROTECT
18	RED MAPLE	ACER RUBRUM	40	GOOD	VINE/BROKEN LIMBS	SAVE & PROTECT
19	SYCAMORE	PLATANUS OCCIDENTALIS	37	GOOD	VINE/SELF-CORRECTED/LEAN/CANYON/WEAK ATTACHMENTS	SAVE & PROTECT
20	PN OAK	QUERCUS PALUSTRIS	34	GOOD	EXPLODED/ROOTS/DEBRIS/BROKEN LIMBS	SAVE & PROTECT
21	PN OAK	QUERCUS PALUSTRIS	38	FAIR	EXPLODED/ROOTS/WEAK ATTACHMENTS/DEBRIS/BROKEN LIMBS	SAVE & PROTECT
22	WHITE ASH	FRAXINUS AMERICANA	32	FAIR	EXPLODED/ROOTS/BROKEN SCAFFOLD/DEBRIS/BROKEN LIMBS	SAVE & PROTECT
23	PN OAK	QUERCUS PALUSTRIS	43	FAIR	SPLITS AT 5' EXPLODED/GROLED/ROOTS/DEBRIS/BROKEN LIMBS	SAVE & PROTECT

NOTE:

- THIS PLAN IS APPROVED IN ACCORDANCE WITH THE FOLLOWING VARIANCE FROM THE STRICT REQUIREMENTS OF SUBTITLE 25 APPROVED BY THE PLANNING DIRECTOR ON 07/25/12:
 - THE REMOVAL OF THREE (3) SPECIMEN TREES (SECTION 25-122(b)(1)(c)): #ST-4, #ST-6, #ST-15.

Woodland Conservation Worksheet for Prince Georges County Government Projects

Property Description or Subdivision Name: TCPII-172-91-03 Kentlands Community Center

Zone:	R.O.S.	CONDITION
Gross Tract:	80.90	
Existing Woodland = WCT	23.29	or 28.79%
Woodland Cleared	0.11	
Total area of woodland cleared (subject to 1:1 replacement)	0.11	
Off-Site Mitigation Provided (if any)	0.00	
Off-Site Mitigation Provided (preservation)	0.00	
Woodland Conservation Requirement:	23.92	

Woodland Conservation Provided:	Woodland preserved	Afforestation	Reforestation	Priority Credit for Off-Site Mitigation	Current Credit for Off-Site Mitigation	Off-Site Mitigation provided (afforestation)	Off-Site Mitigation provided (preservation)	Area Mitigated by Woodland Conservation Fund	Total Woodland Conservation Provided
23.18	0.11	0.00	0.00	0.00	0.00	0.00	0.00	0.00	23.92

Prepared by: 23.292 Date: 2/3/12

License Number: 23.292

Revised 7/1/06

SPECIMEN TREE SIGN

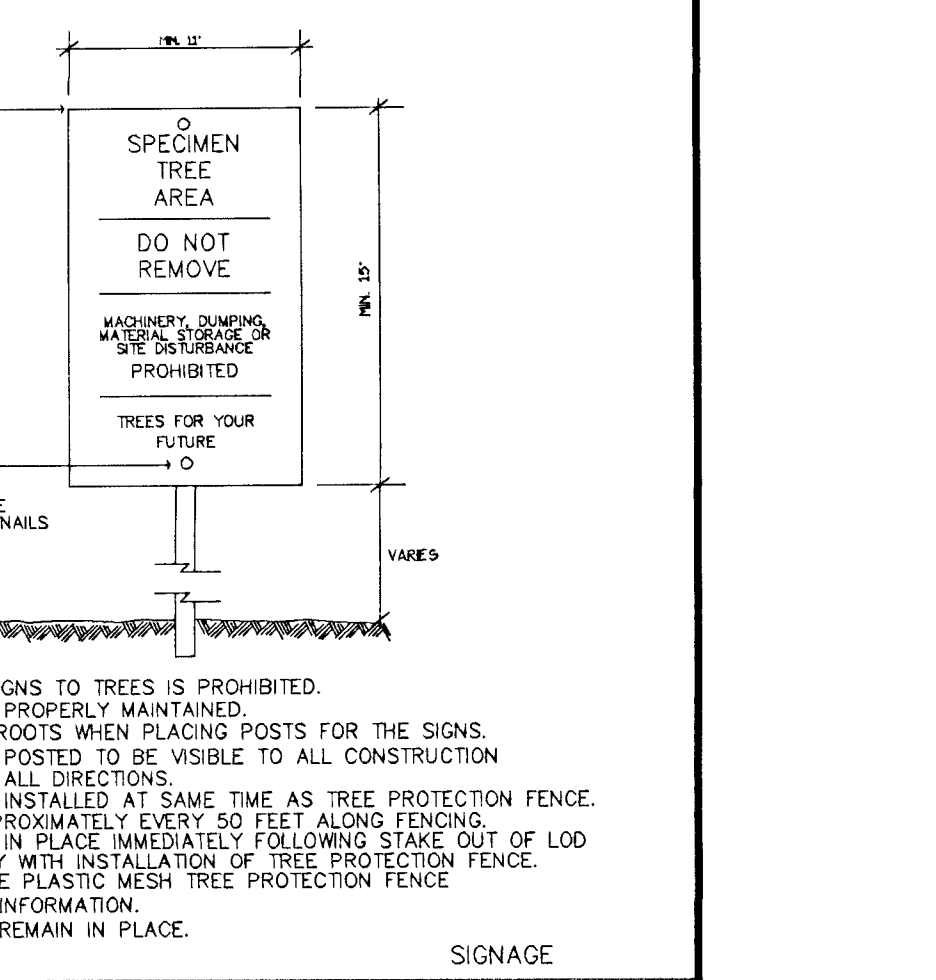

BIODEGRADABLE TREE SHELTER

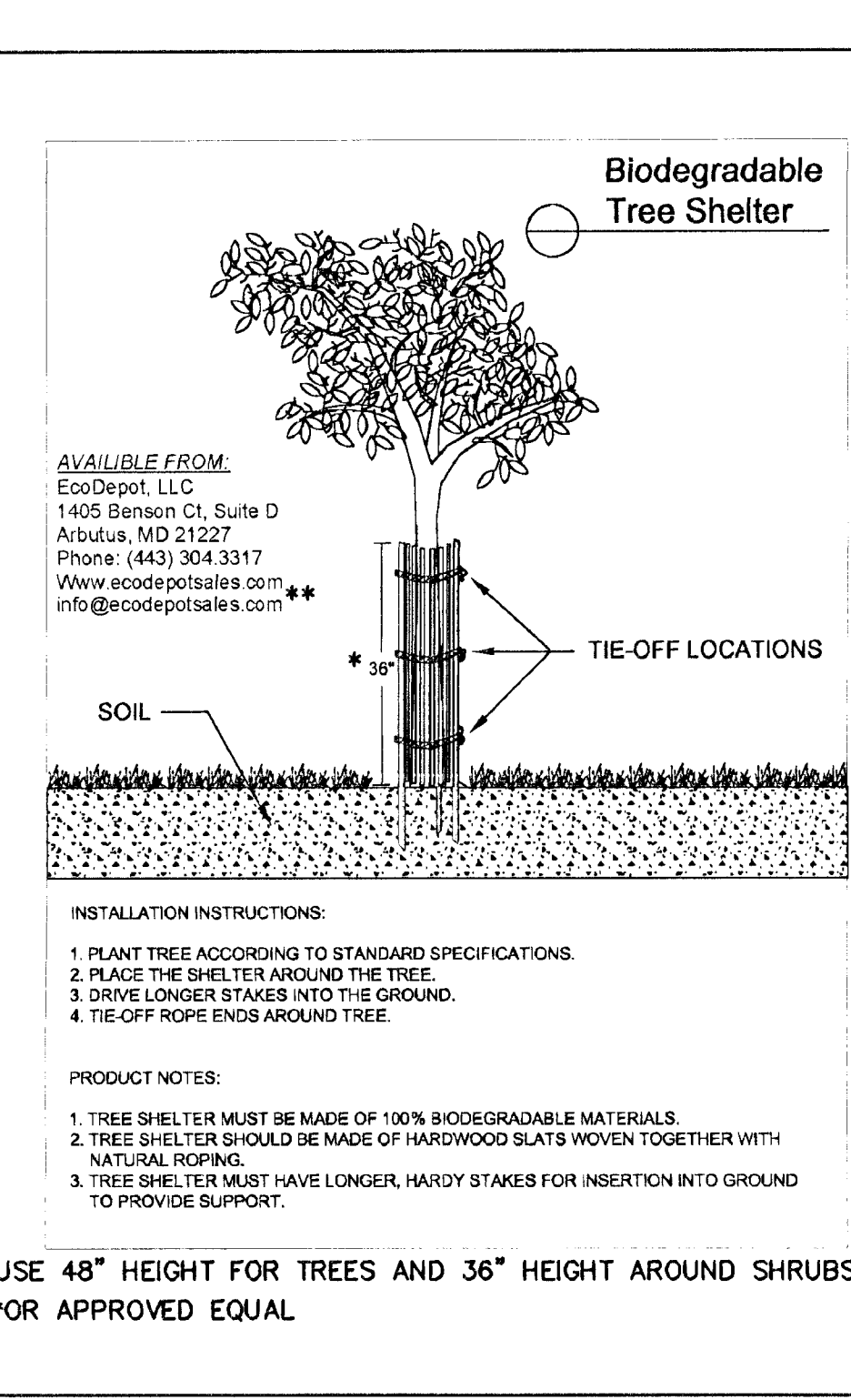

USE 48" HEIGHT FOR TREES AND 36" HEIGHT AROUND SHRUBS **OR APPROVED EQUAL

